

## ⚠ WARNING

- DO NOT use NKC-125MA with the angle grinder which can NOT be fitted correctly as instructed in the manual.
- NKC-125MA is only for grinding concrete and block. DO NOT use for grinding steel or other materials.
- NKC-125MA must be used with the Vacuum suitable for the concrete dust.
- NKC-125MA is only for 100-125mm Diamond Grinding Cup Wheels. DO NOT use with abrasive wheels.
- Always check NKC-125MA for damage, cracks, or deformation before use.
- DO NOT use NKC-125MA if it is cracked, damaged or bent as this could lead to injury.
- Be sure to wear the protective goggles, dust mask, protective foot wear, earplugs and other protective equipment when working.
- Keep NKC-125MA away from gasoline, solvents, and paraffin.
- Ensure the work piece is securely clamped before working.

## Explanation of the pictograms.

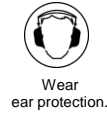

## SPECIFICATIONS

Model Code	NKC-125MA	
Suitable Tool	Ø100~125mm (h21mm) Diamond Grinding Cup Wheel	
Weight	470g (Main Unit with adaptor system)	
Work material	Concrete, Block.	
Suitable Angle Grinders	Makita / BOSCH / Dewalt / Milwaukee / Metabo / HiKOKI / FLEX 115-125mm class small angle grinder.	
※Based on the web as of 2022 Sep.		<div style="border: 1px dashed black; padding: 5px;">                 Some special angle grinders (ex. X-LOCK type) may not be installed. Please scan the QR code on the left to check compatibility.             </div>

## OVER VIEW

[a] Main Unit / [b] Offset Plate / [c] Milwaukee Plate / [d] Wrench / [e] Lock Nut / [f] Base Flange  
[g] Spacer T12 / [h] Spacer T10 / [i] Spacer T7 / [k] Joint / [m] Washer / [p] Hook

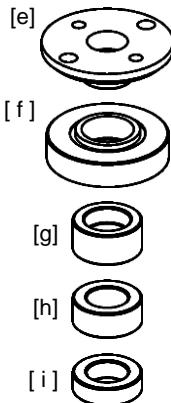
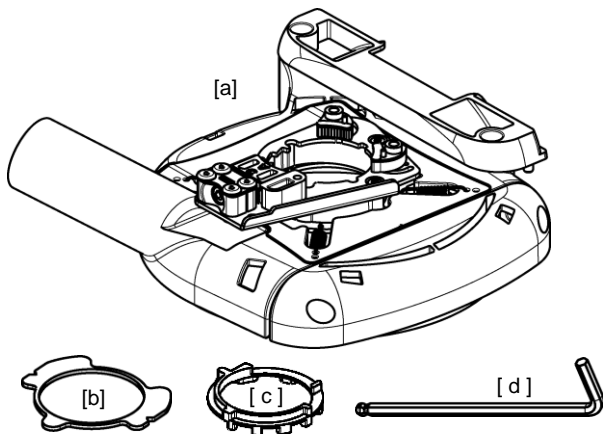

**Sold Separately**

**Sub Plate NKC-SPMA** is required separately for the "Large Flange" grinders on the right.

**metabo**  
WEPBA17-125 / WEBA17-125 / WEA17-125 / WEVA15-125 / WA13-125 / WEA11-125 type  
WPB13-125 / WB18LTBL11-125 / WVB18LTBL11-125 / WPB18LTBL11-125 type

**HiKOKI**  
G13SB4 / G13SE3 / G13BAWQZ / G13BY / G13YG type

"Large Flange" Grinder

## INSTALLATION

1. Detach the Guard from the grinder.

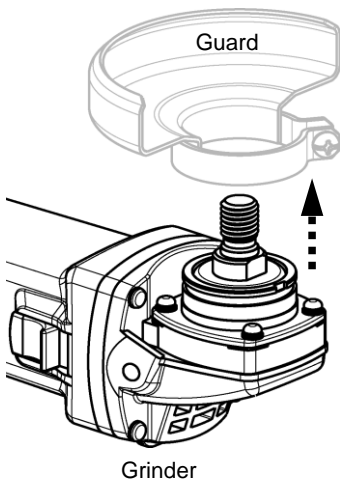

Check the Installation Guide.

Check the instruction video at this QR code.

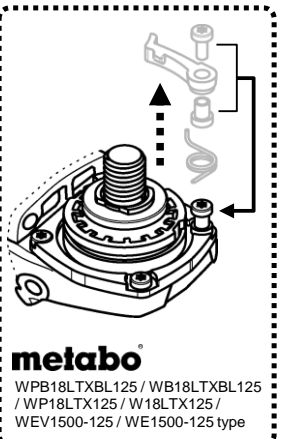
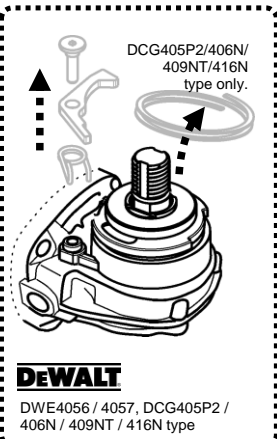
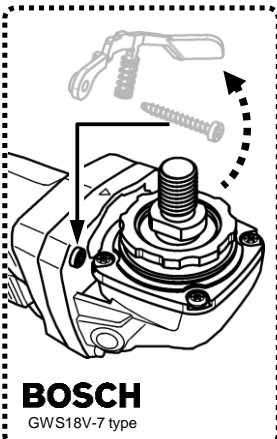
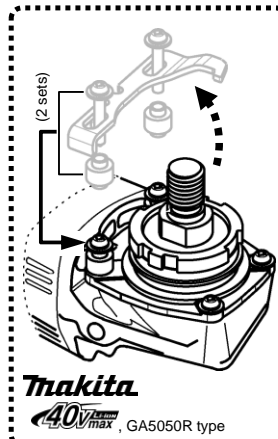

⚠ Above grinder needs its lever and related components detached.

2. Some Grinders need preparation for Upper Bracket and Lower Bracket at [a] Main Unit.

Refer to the Installation Guide.

(Factory default)

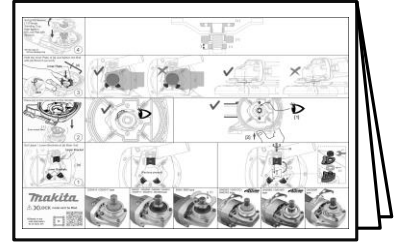
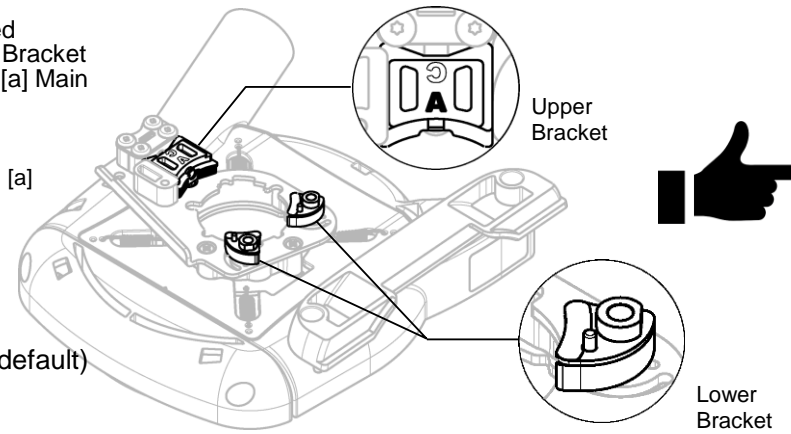

**Makita** 40V<sub>max</sub>, GA5050R type  
**FLEX** L1400 125 type

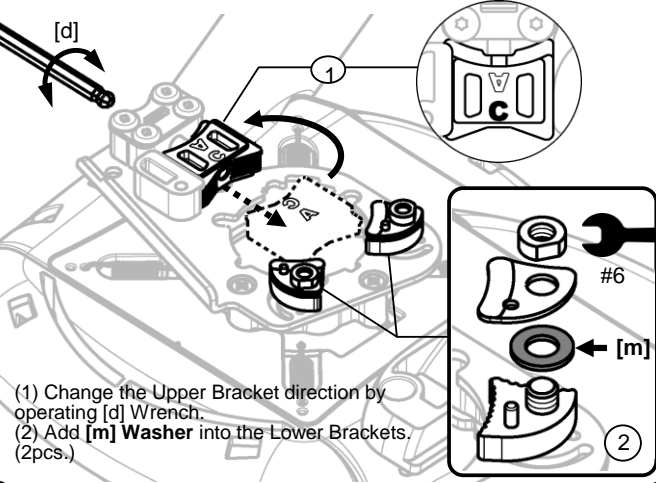

- (1) Change the Upper Bracket direction by operating [d] Wrench.
- (2) Add [m] Washer into the Lower Brackets. (2pcs.)

**FLEX** L1506VR / L9-11 125 / LE9-11 125 / L12-11 125 / L13-10 125-EC / LE14-7 125  
INOX / L15-11 125 / LE15-11 125 / L3406VRG / LB17-11 125 type

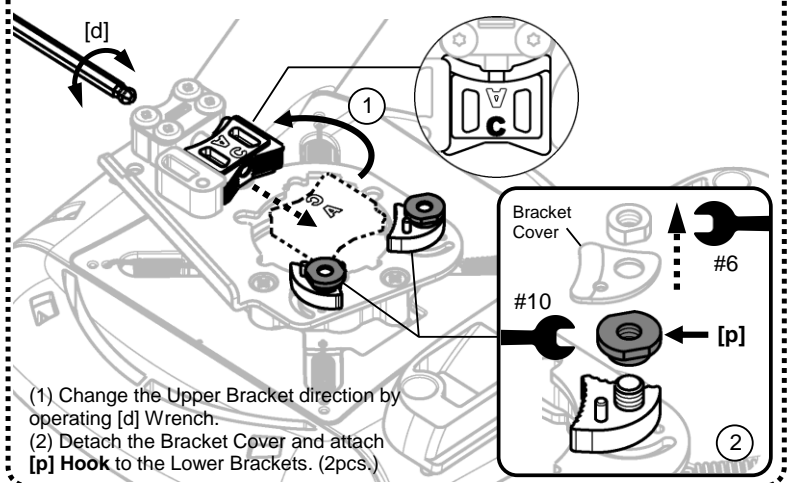

- (1) Change the Upper Bracket direction by operating [d] Wrench.
- (2) Detach the Bracket Cover and attach [p] Hook to the Lower Brackets. (2pcs.)

**Milwaukee** (OLD type) L3410FR / L3410VR type  
HD28AG-125 / AGV17-125 / AG8-125 / AG9-125 type

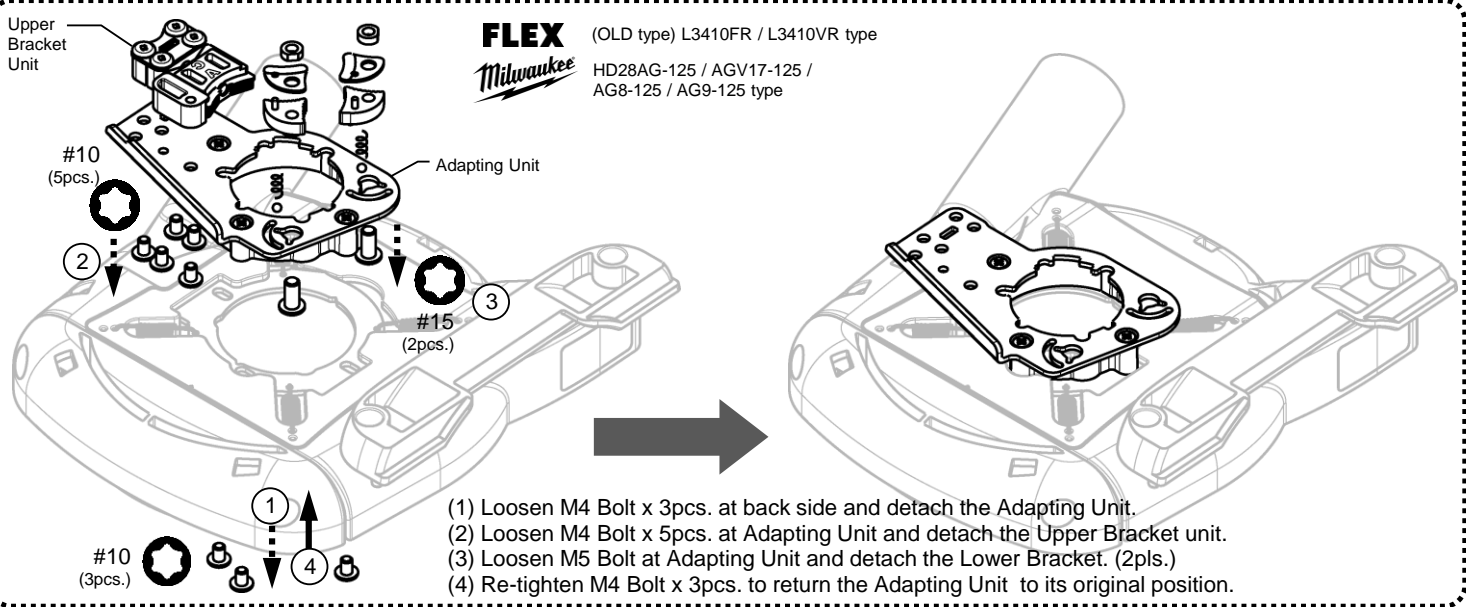

- (1) Loosen M4 Bolt x 3pcs. at back side and detach the Adapting Unit.
- (2) Loosen M4 Bolt x 5pcs. at Adapting Unit and detach the Upper Bracket unit.
- (3) Loosen M5 Bolt at Adapting Unit and detach the Lower Bracket. (2pls.)
- (4) Re-tighten M4 Bolt x 3pcs. to return the Adapting Unit to its original position.

3. Switch the Lower Brackets position when the gearcase size D of the Grinder is larger than 47mm.

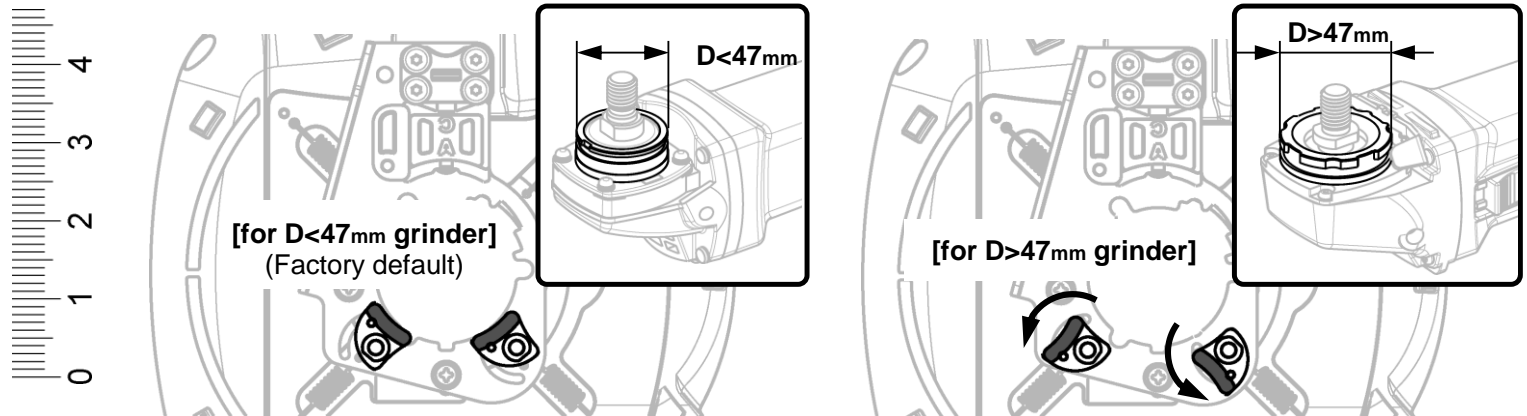

[for D < 47mm grinder]  
(Factory default)

[for D > 47mm grinder]

4. Place [a] Main Unit on gearcase of the Grinder.  
Some Grinders need [b] Offset Plate or [c] Milwaukee Plate preset on its gearcase.

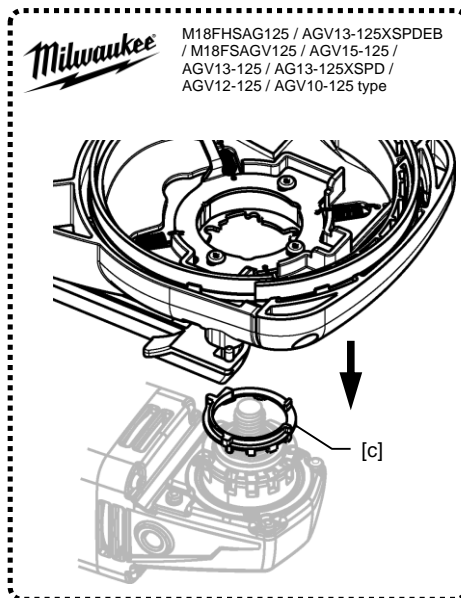
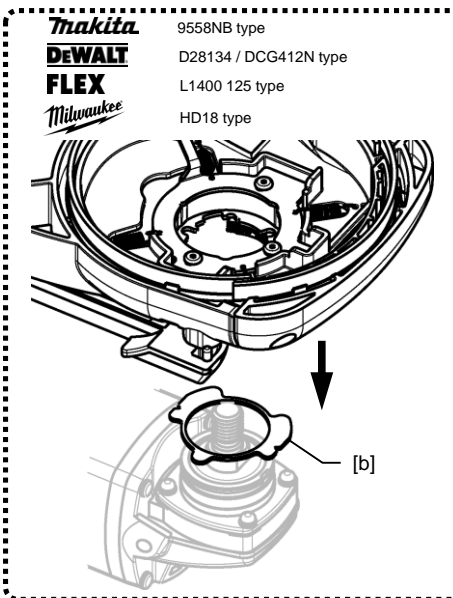
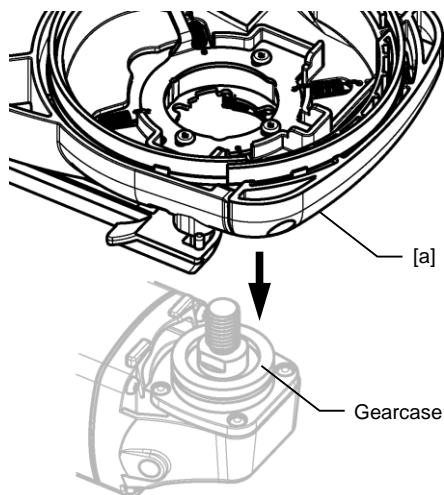

5. Align the center of [a] Main Unit and Spindle, then push [a] Main Unit upward until it stops.

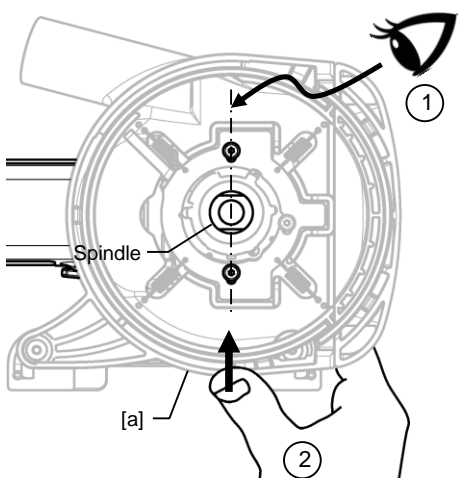

(For some Grinders, just match the shapes of the fitting area)

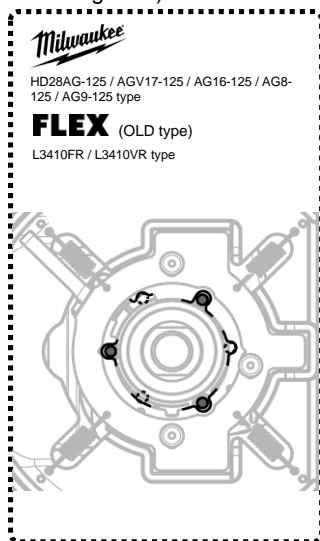
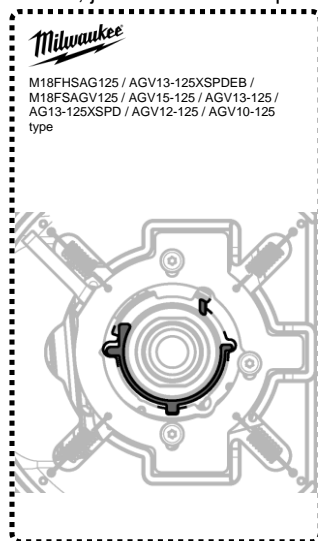
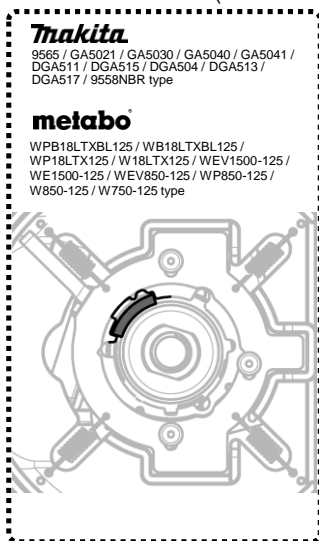

6. Hold the Inner Plate at [a] Main Unit and tighten the Bolt with [d] Wrench securely.

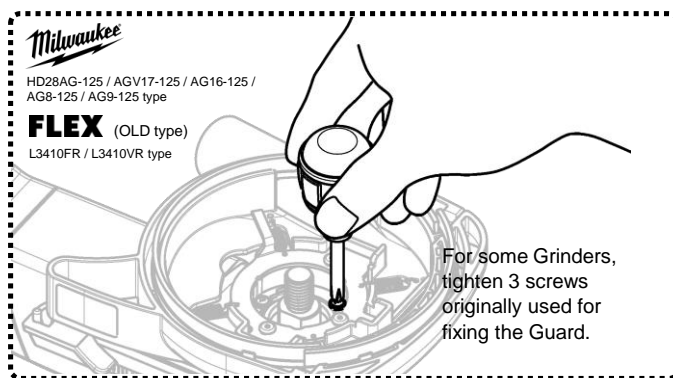
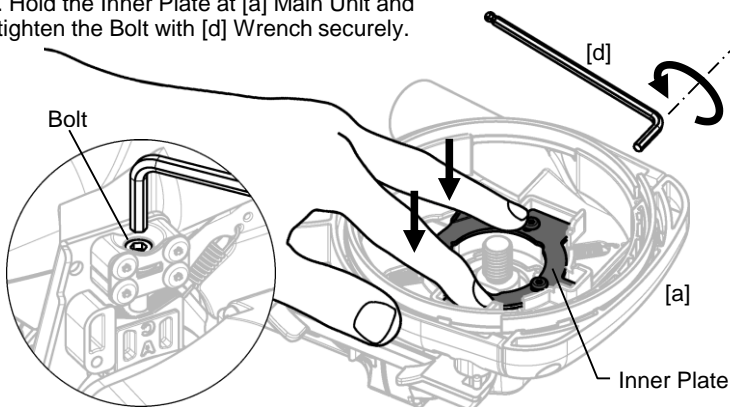

7. Set [g / h / i] Spacer, [f] Flange, Cup Wheel into the spindle then tighten [e] Lock Nut by Wrench.

※Use proper Spacer [g / h / i] to keep the bottom space 1~5mm under the Cup Wheel.

Refer to the Installation Guide.

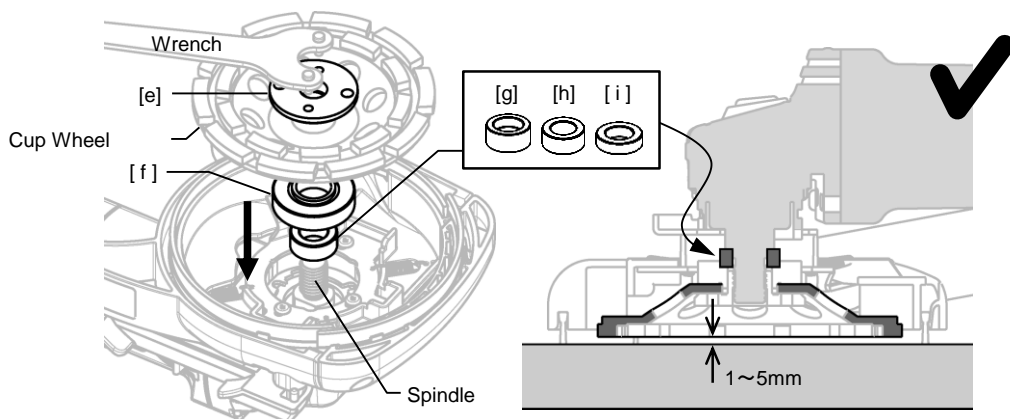
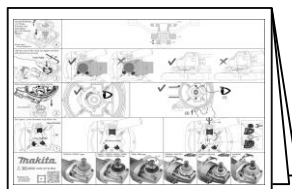

⚠ If [ f ] Flange is off center, loosen M4 Bolt x 3pcs. at back side and adjust the position of [ a ] Main Unit.  
 ※Re-tighten 3 screws securely after adjustment.

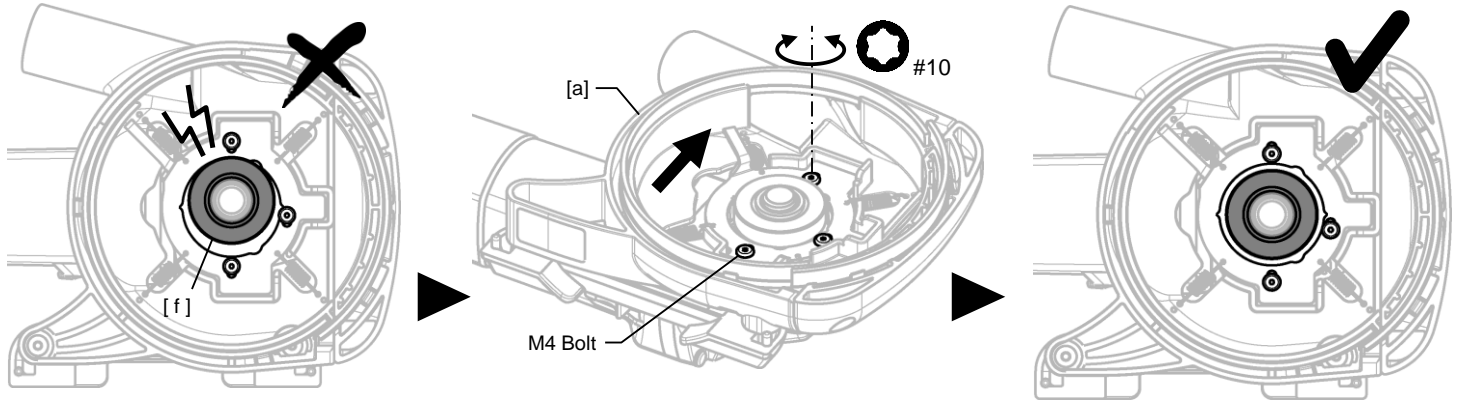

8. Hold [ a ] Main Unit and connect the Vacuum Hose into the Duct with [ k ] Joint.

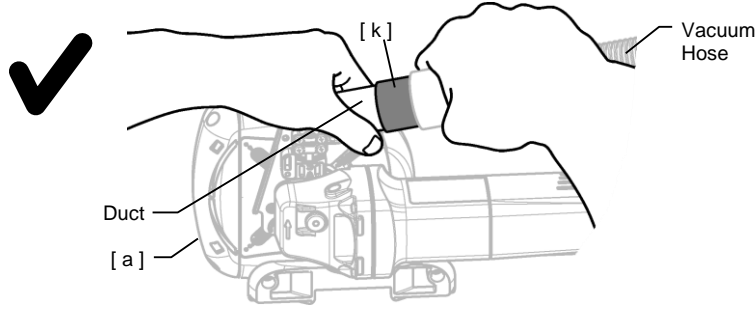

⚠ Do NOT hold the Grinder when connecting the Vacuum Hose.

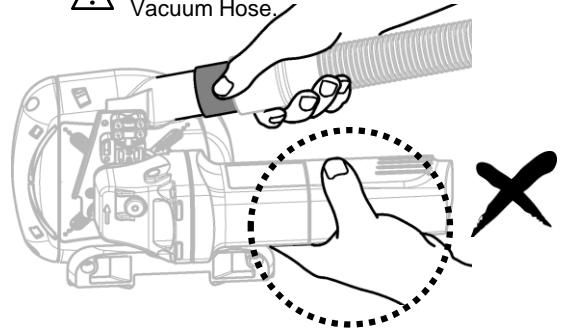

9. Attach the Handle to the Grinder.

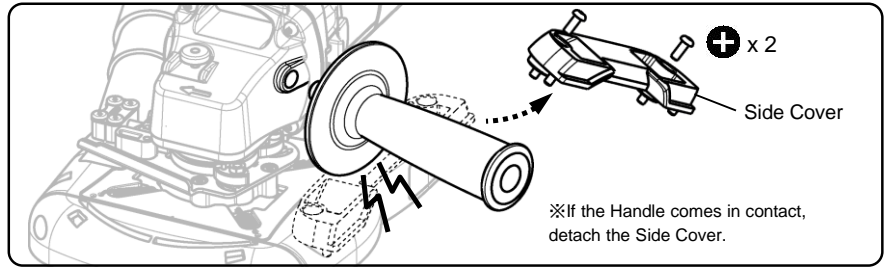
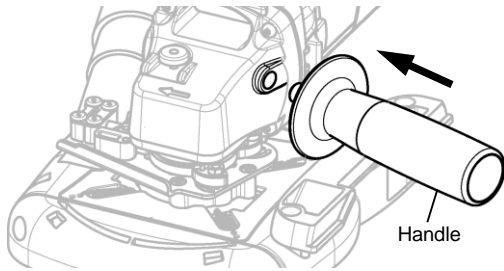

### SURFACE GRINDING

1. Securely hold the Grinder and Handle.
2. Turn on the switch of the vacuum and Grinder.
3. Place [ a ] Main Unit on material slowly, then move the Grinder toward the grinding direction.

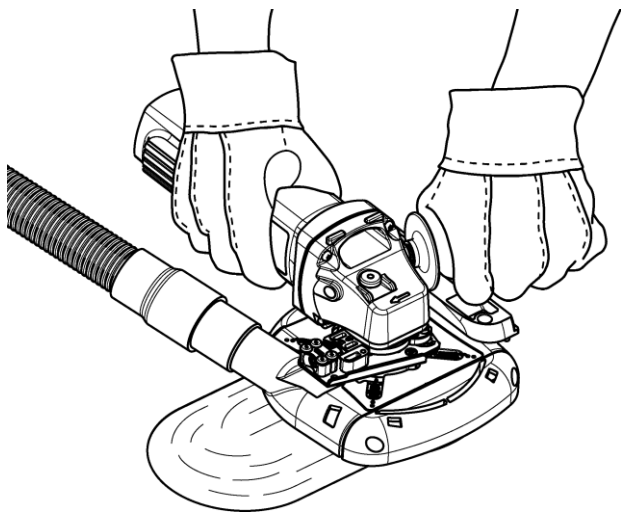

### CORNER GRINDING

1. Detach Front Cover and Side Cover, then replace their positions.
2. Hereafter same as "SURFACE GRINDING" on the left.

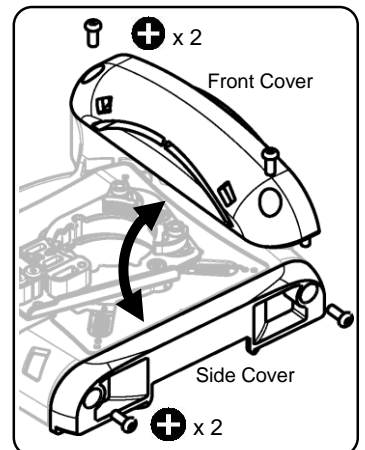
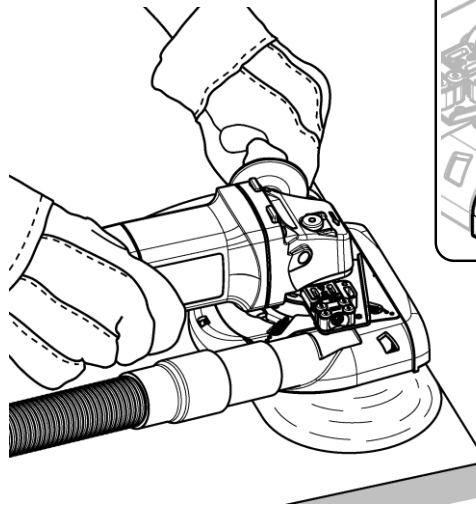

※100~115mm Cup Wheel doesn't need the Side Cover.  
 ※If the Handle comes in contact, detach the Front Cover.