

Makita

⚠ X-LOCK model can't be fitted.

※Based on the web information as of 2022 Jan.

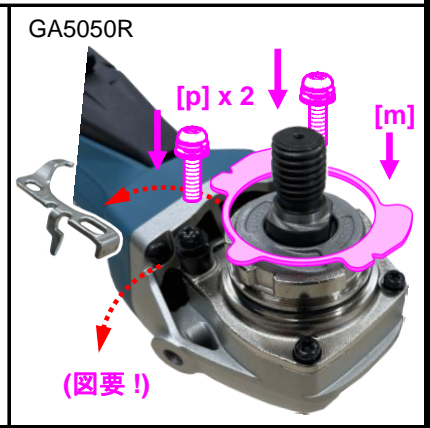

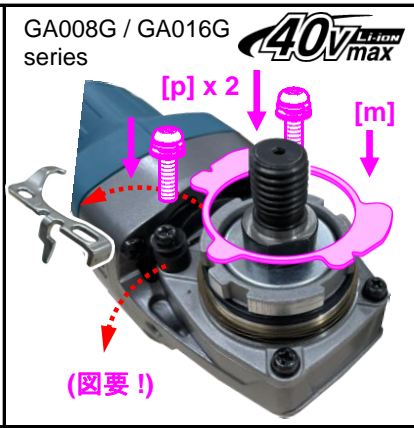
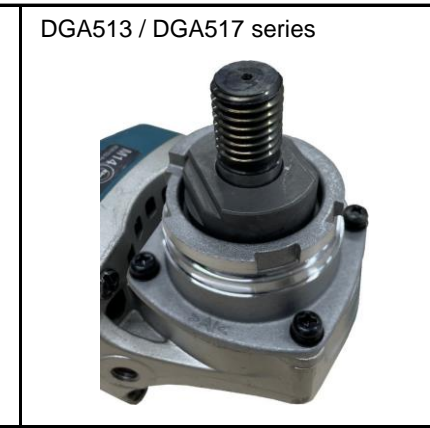
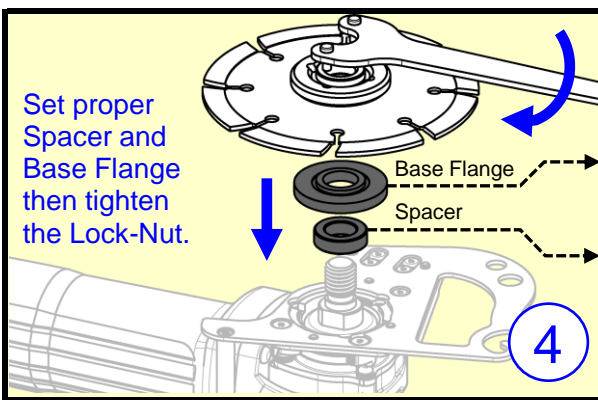

BOSCH

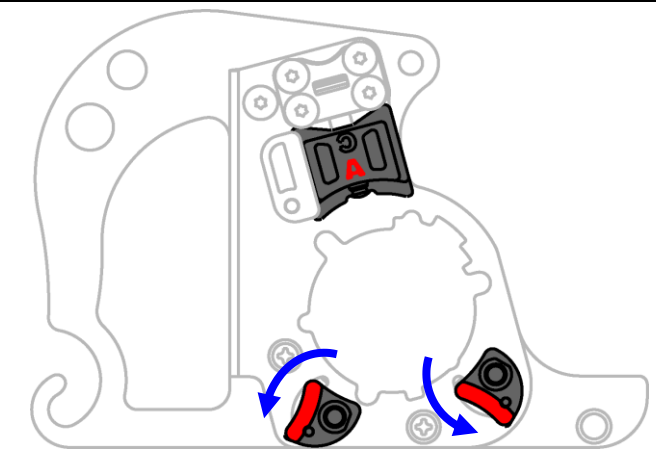
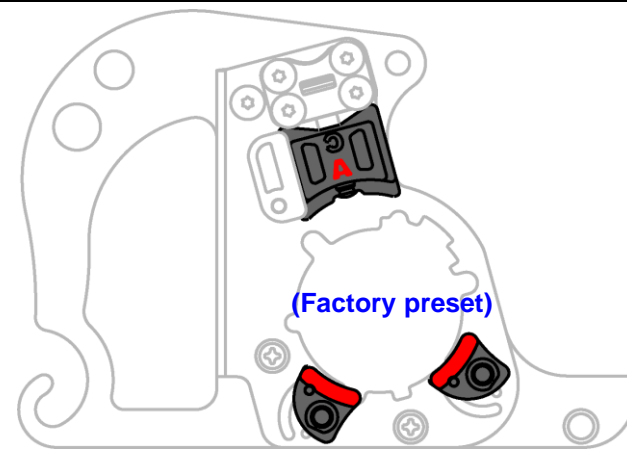
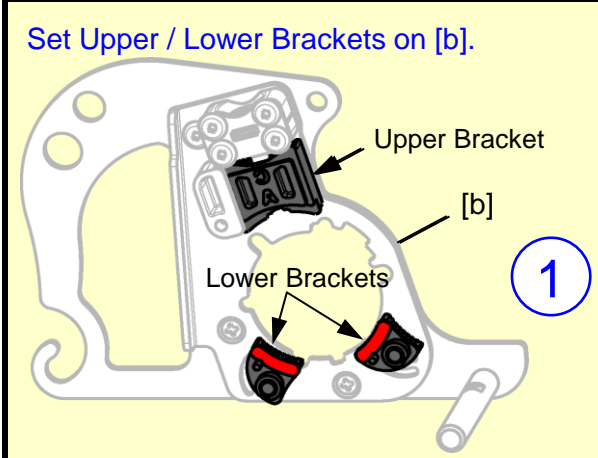
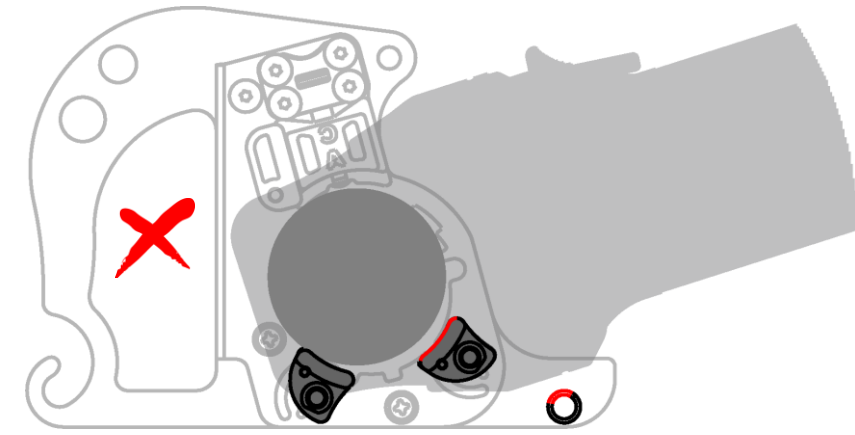
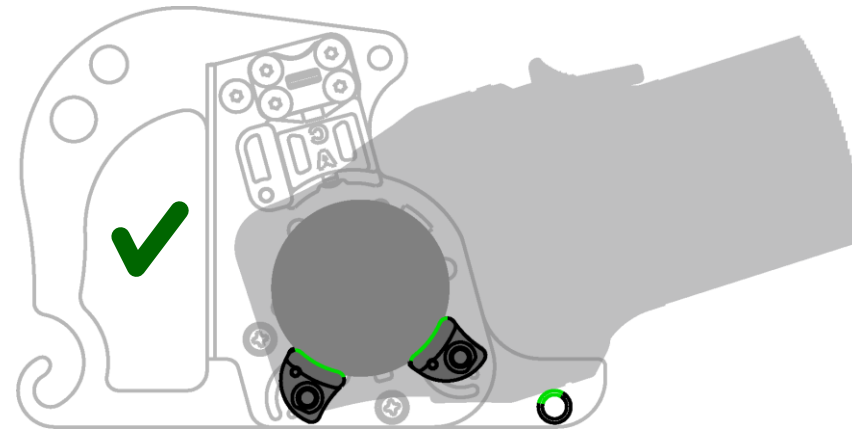
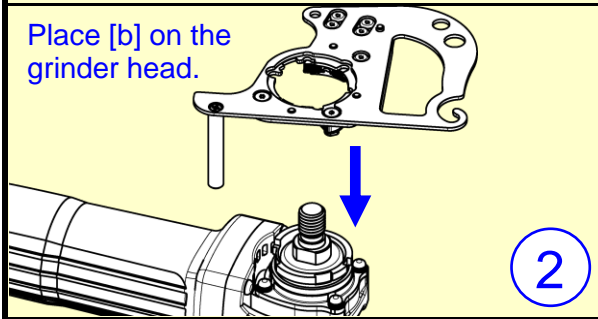
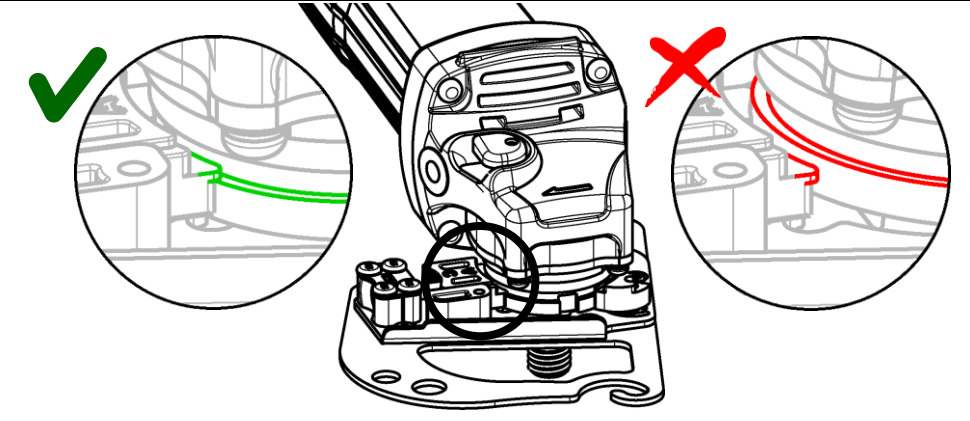
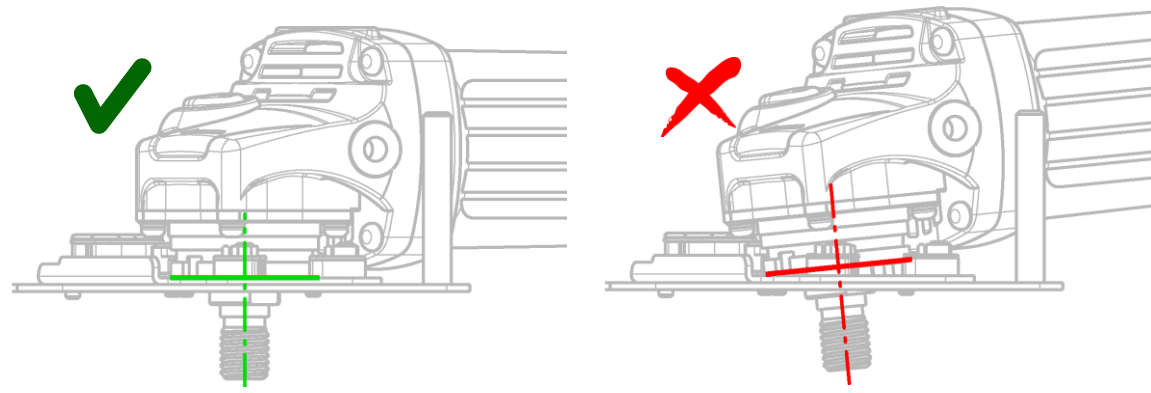
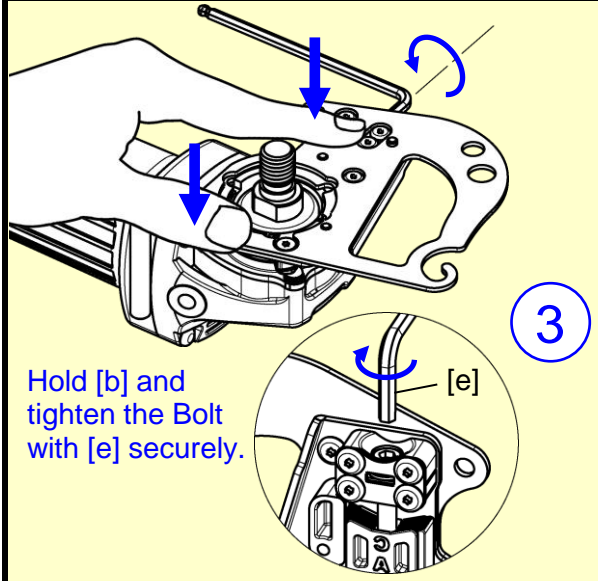
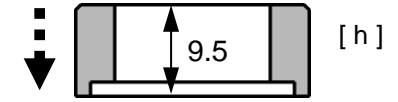
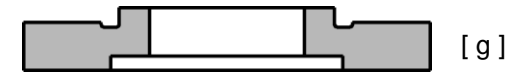

BOSCH

⚠ **XLOCK** model can't be fitted.

※Based on the web information as of 2022 Jan.



GWS7-125 / GWS750 / GWS880
GWS9-125S / GWS18-125V-LI series



GWS1000 / GWS11-125 series
GWS13-125CI series / GWS1400 /
GWS15-125CIEP series
GWS17-125CI series
GWS17-125 INOX / GWS18-125 series
GWS19-125CI series
GWS18V series



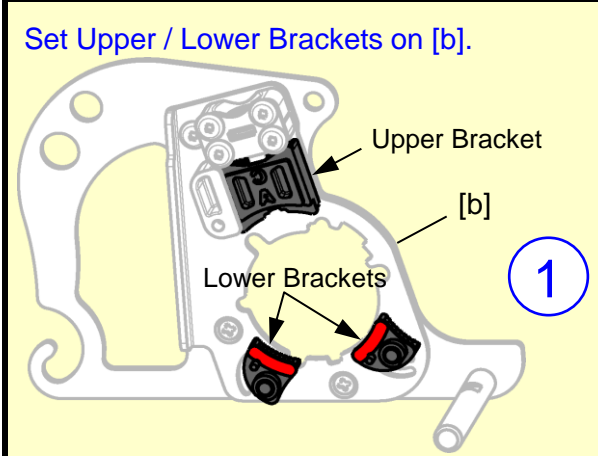
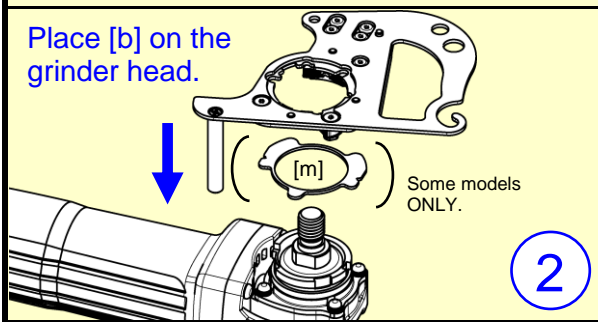
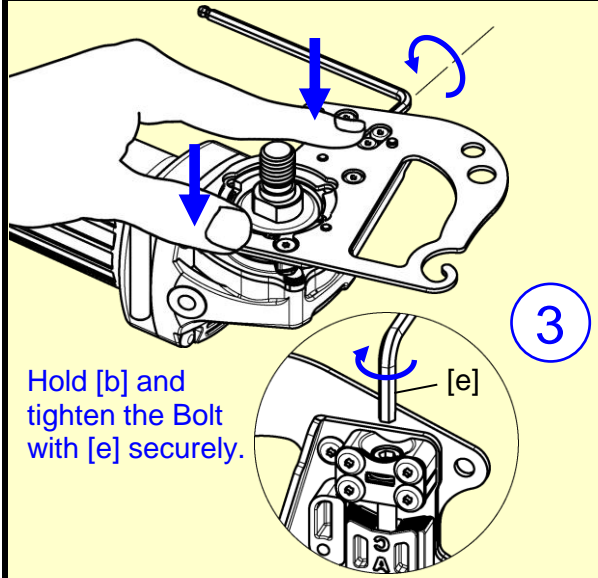
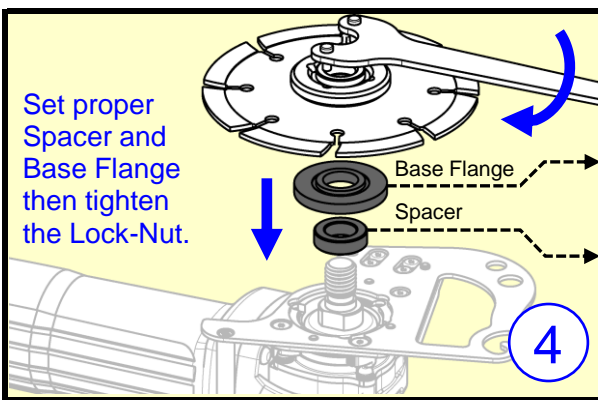

⚠ D28137 / DCG405FN can't be fitted.

※Based on the web information as of 2022 Jan.

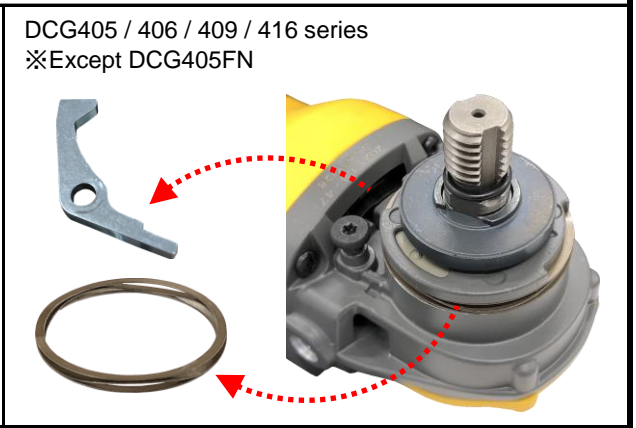
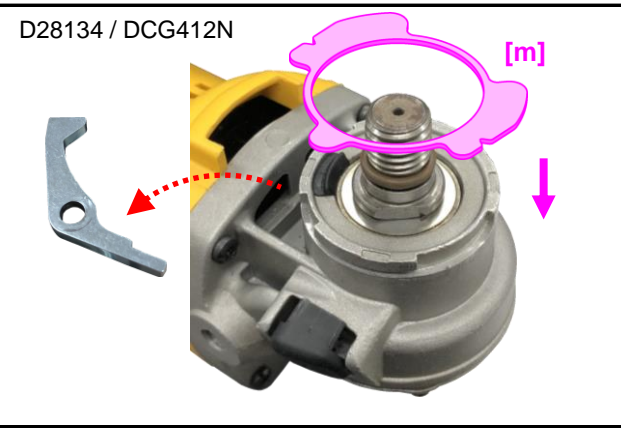
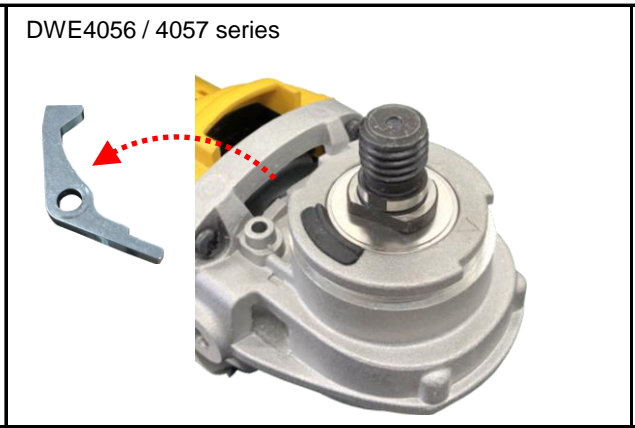
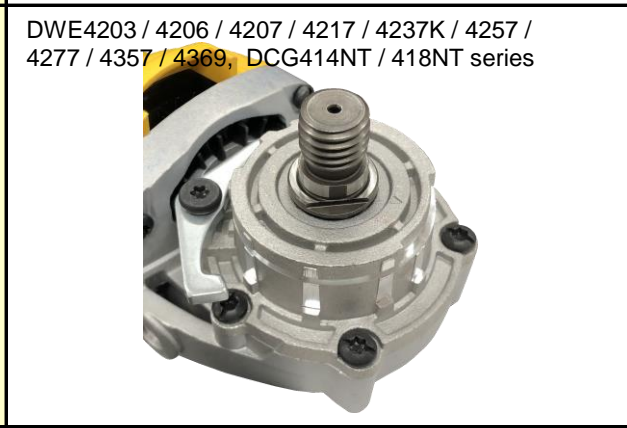
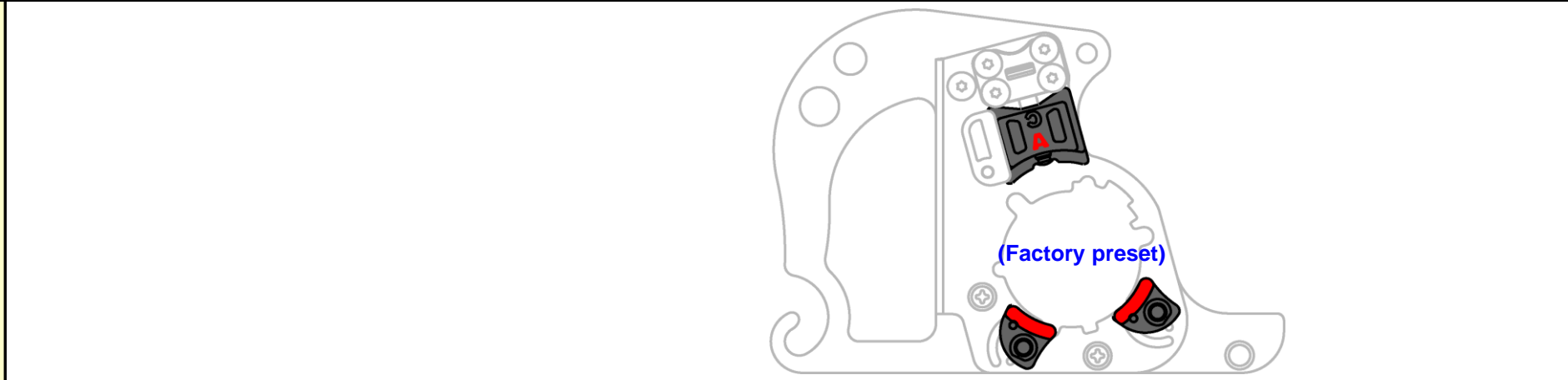
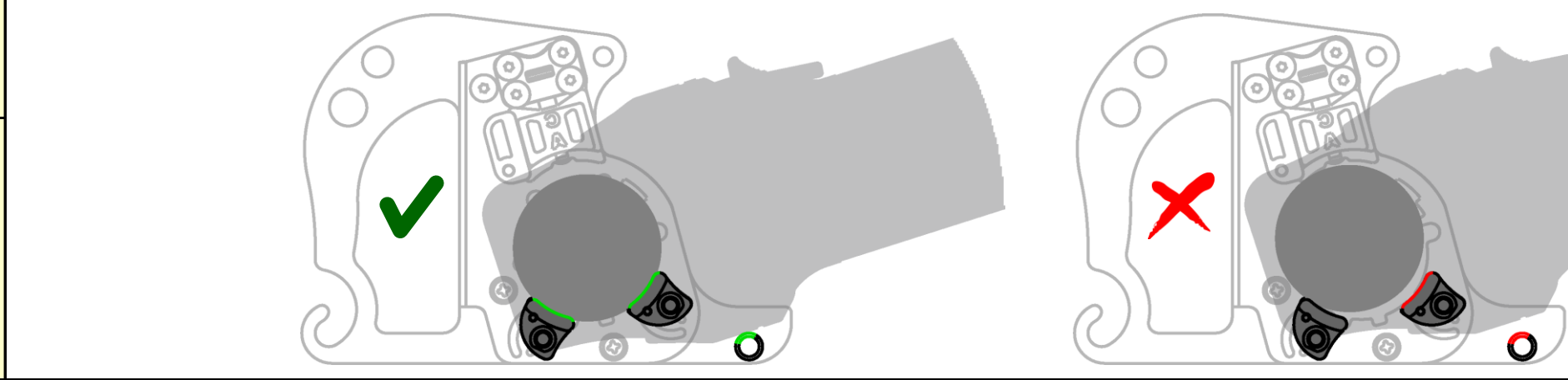
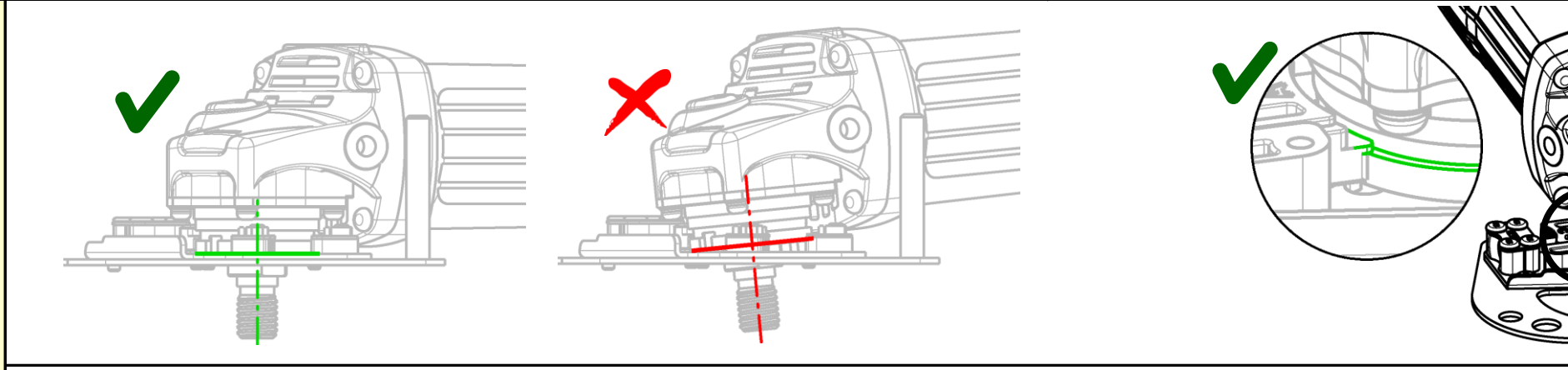
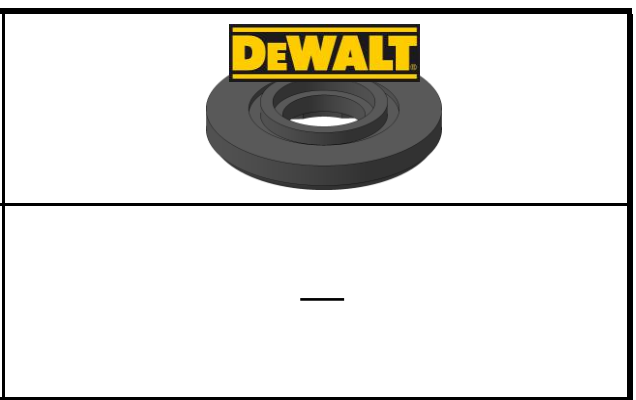
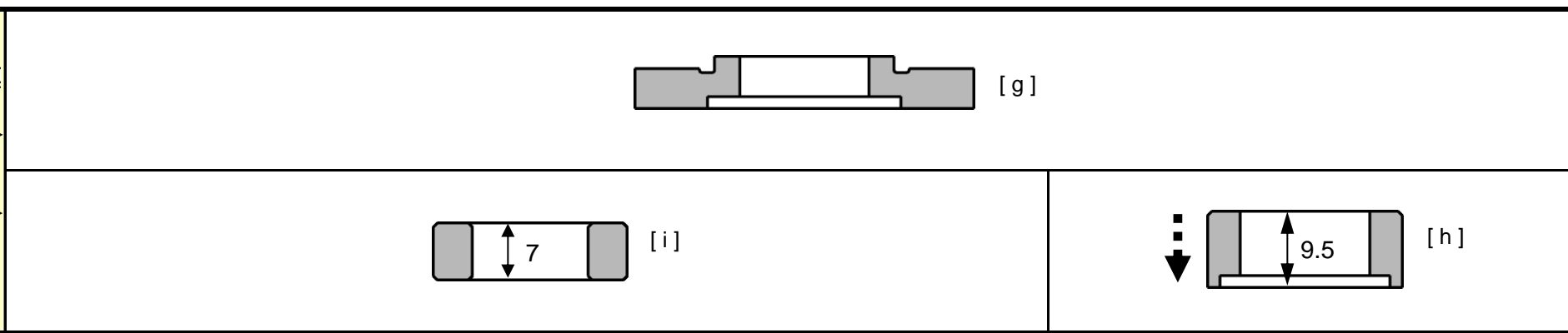

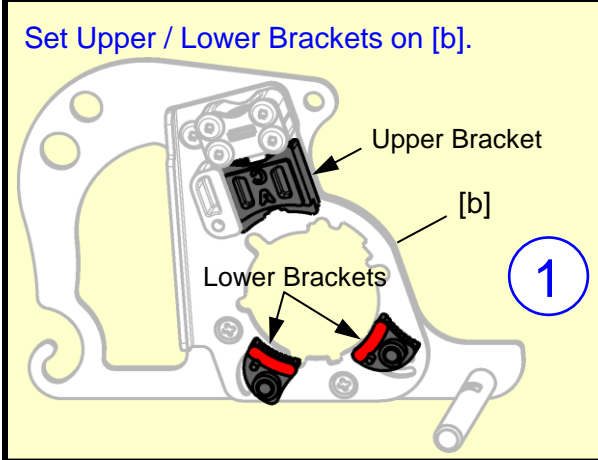
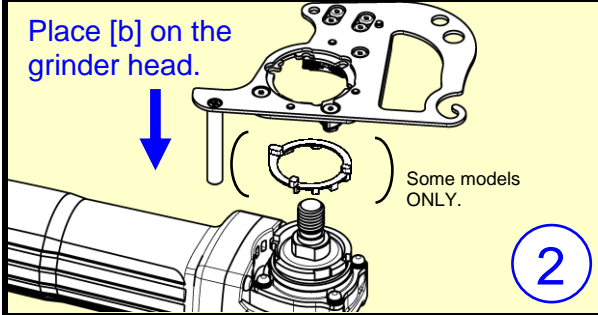
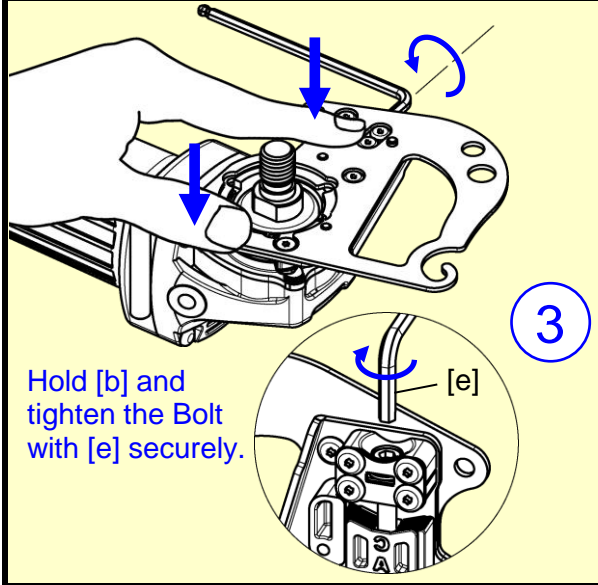
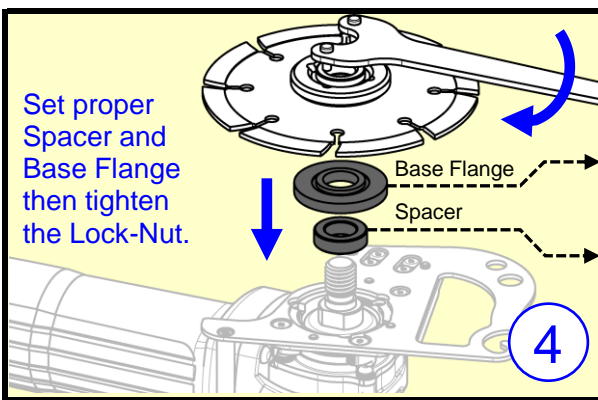

⚠️ AG10 / AGV10 series can't be fitted.

※Based on the web information as of 2022 Jan.

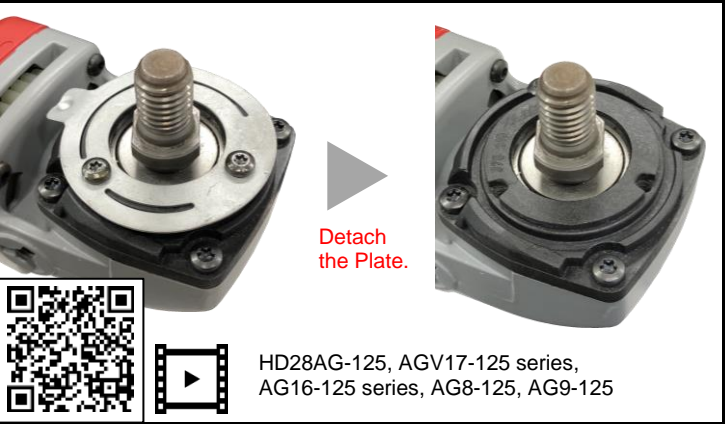
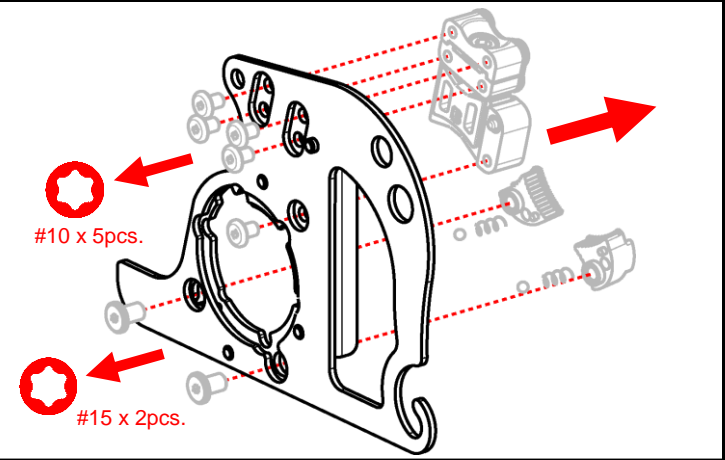
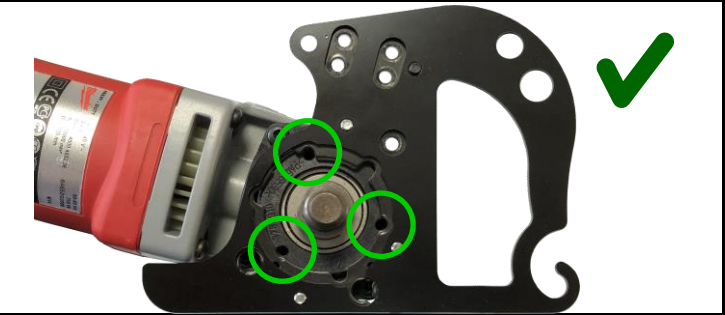
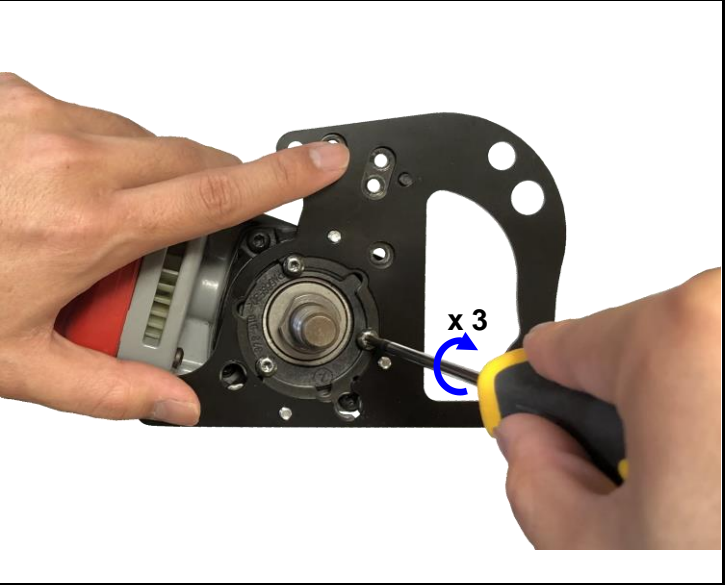
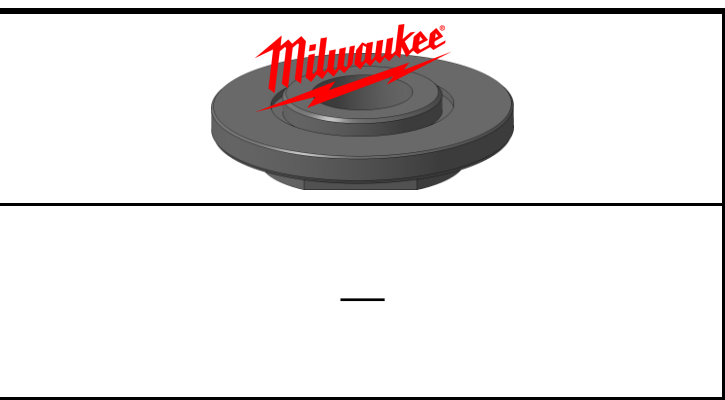
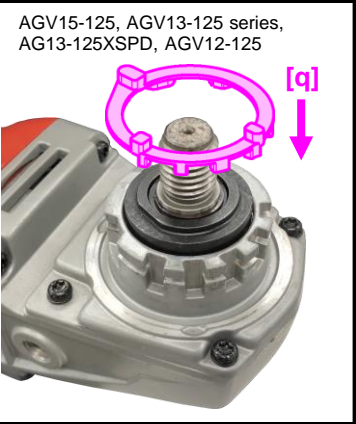
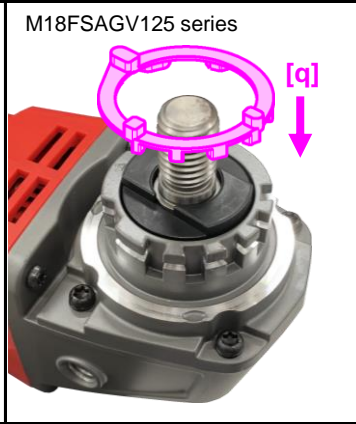
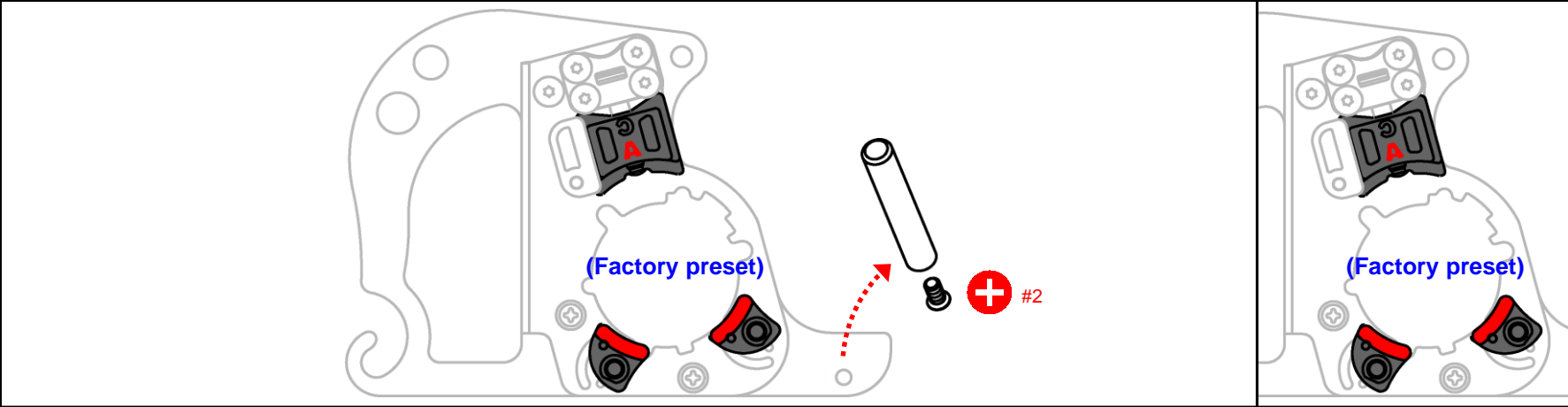
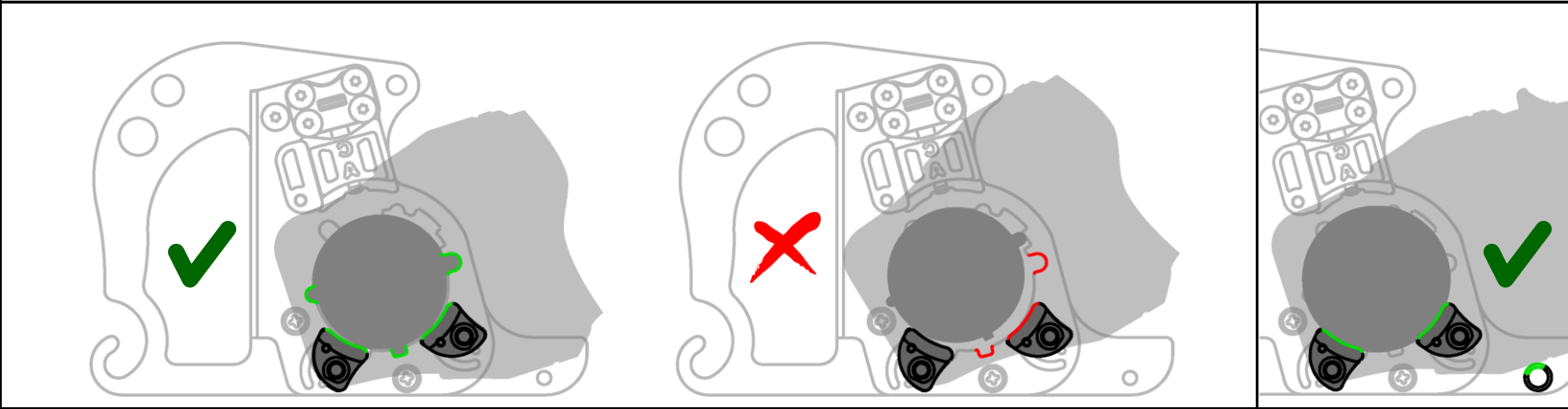
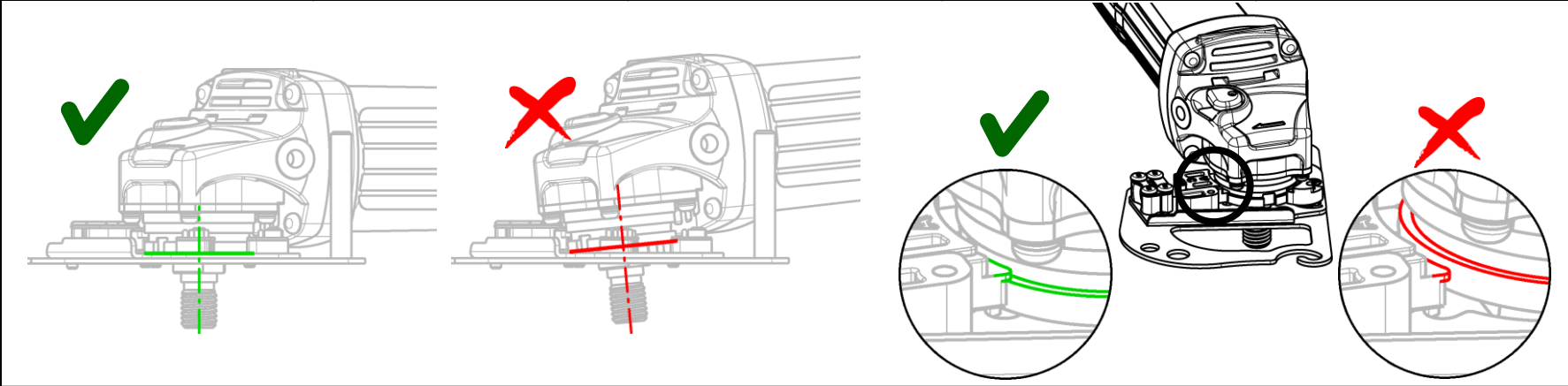
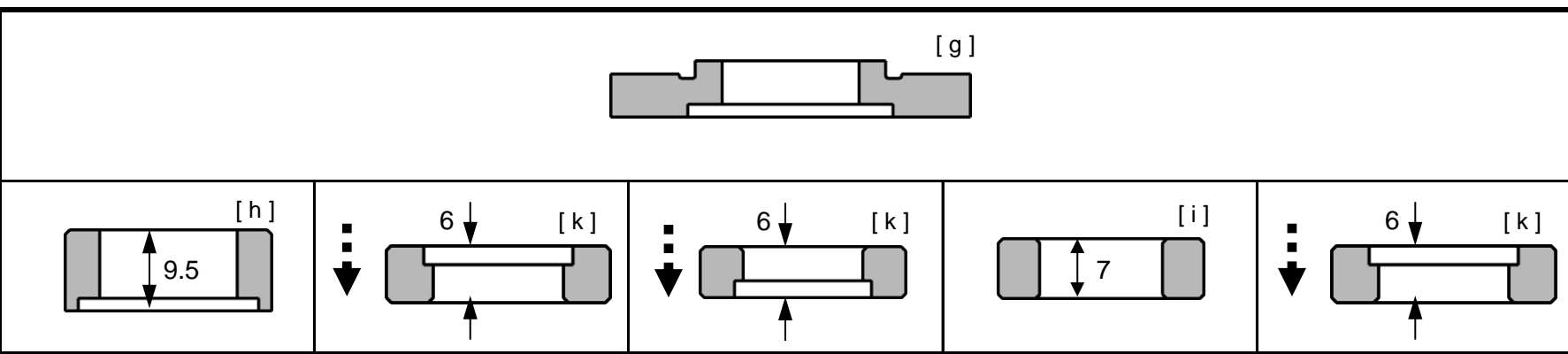

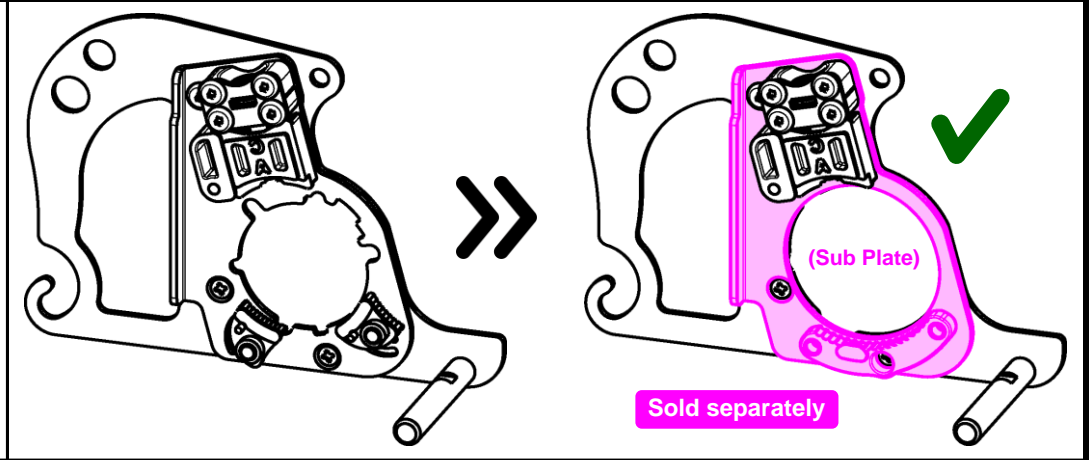
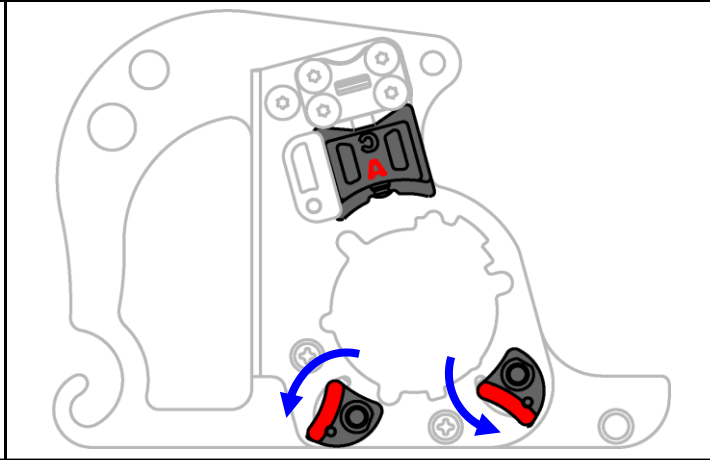
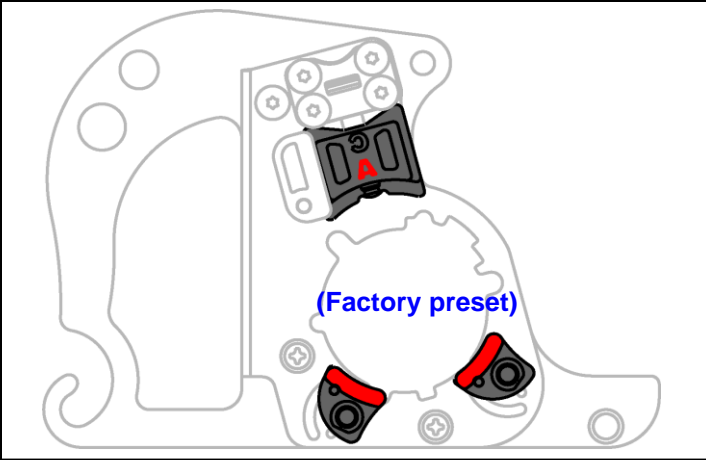
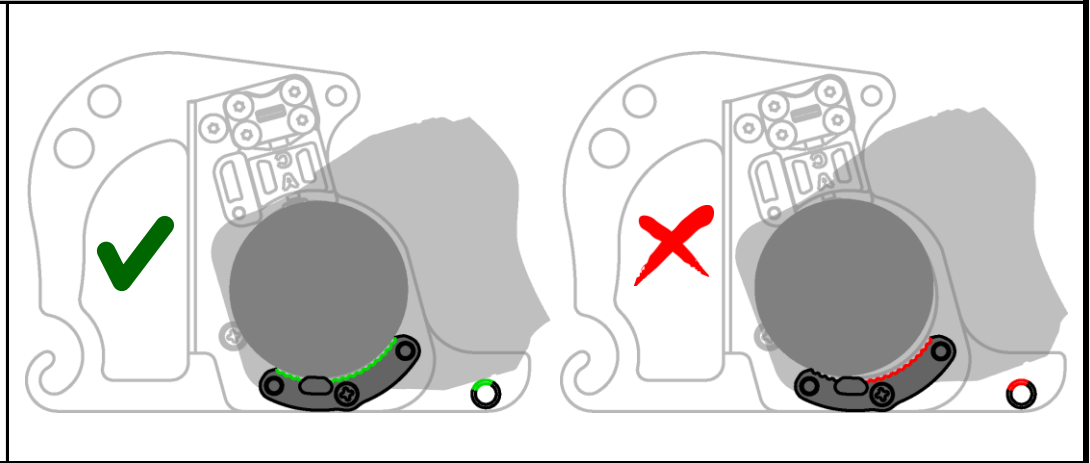
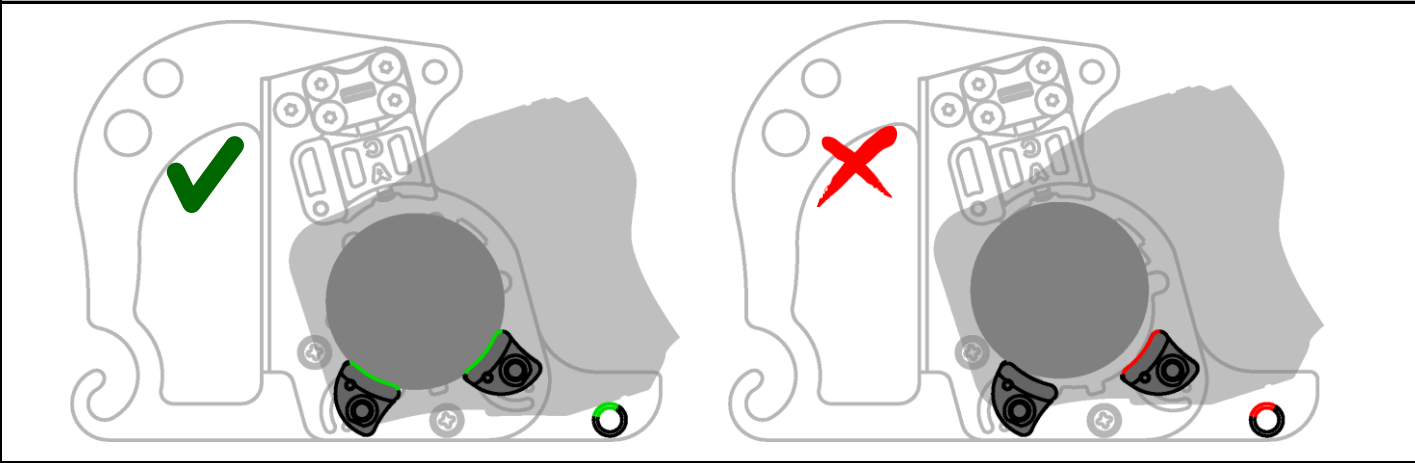
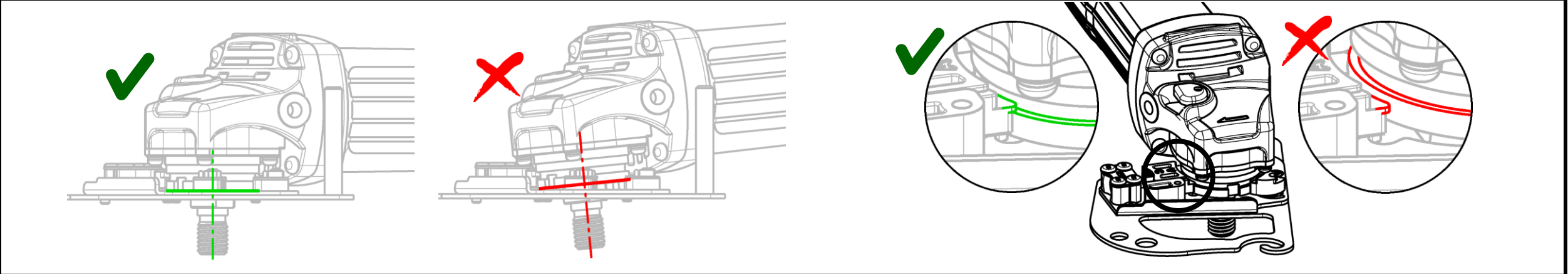
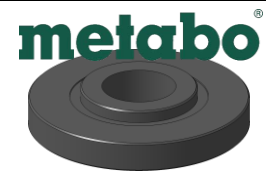
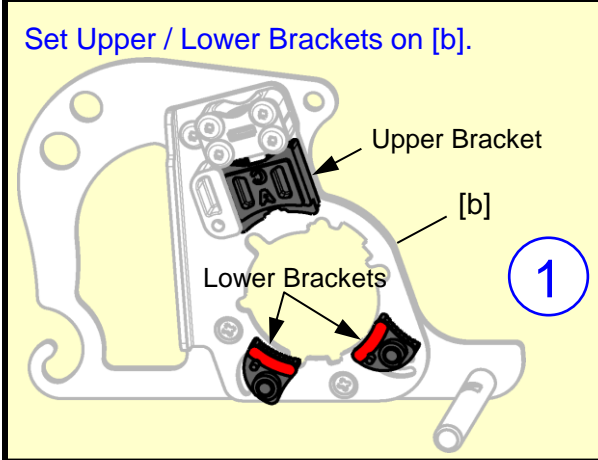
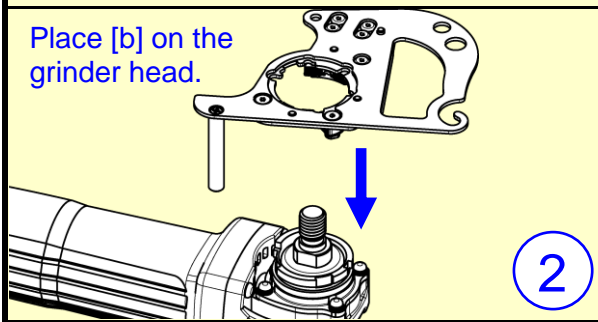
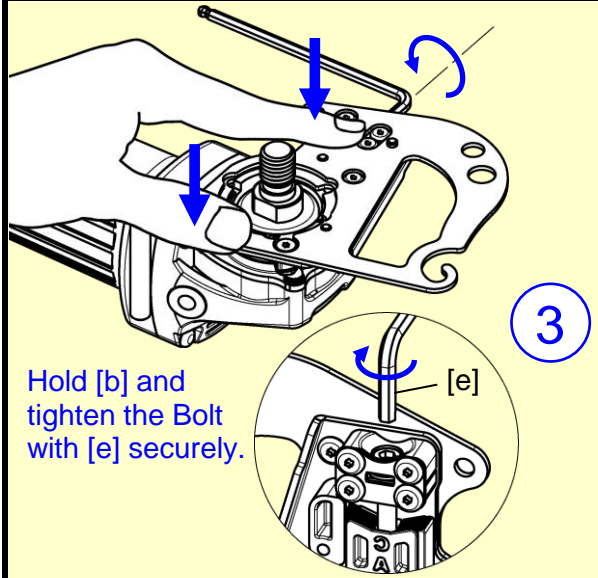
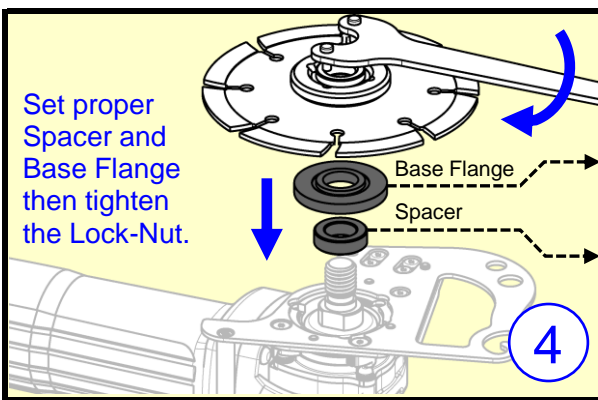

※Based on the web information as of 2022 Jan.

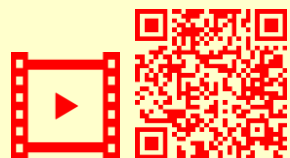

HIKOKI

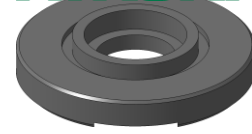

Set proper
Spacer and
Base Flange
then tighten
the Lock-Nut.

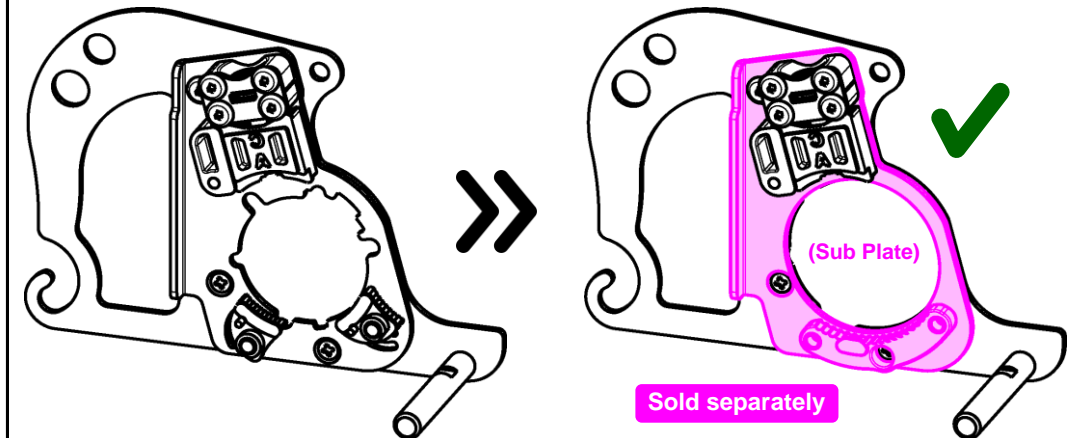
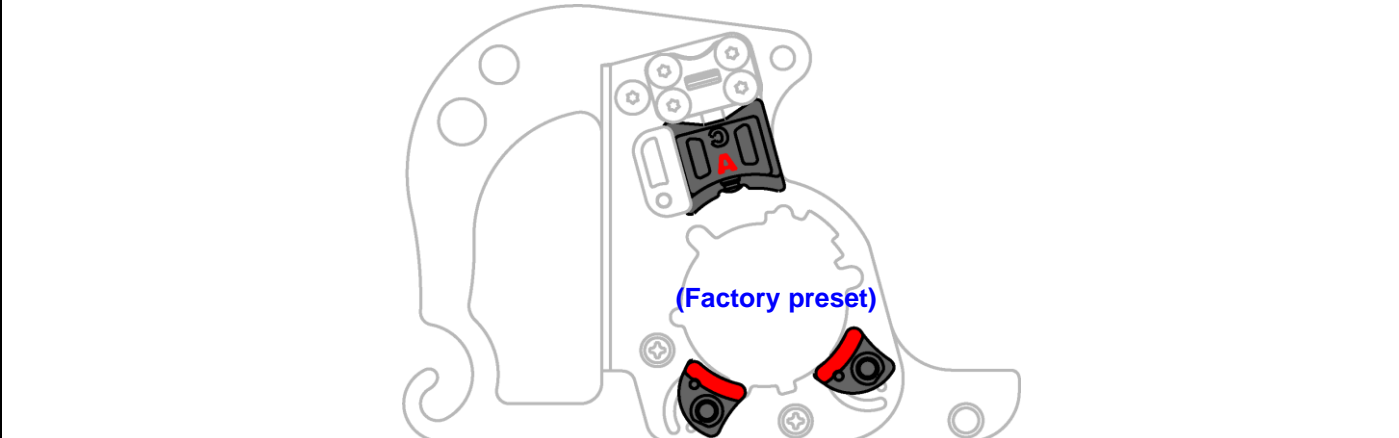
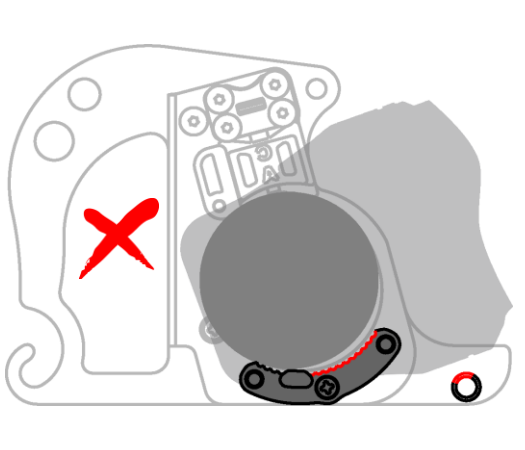
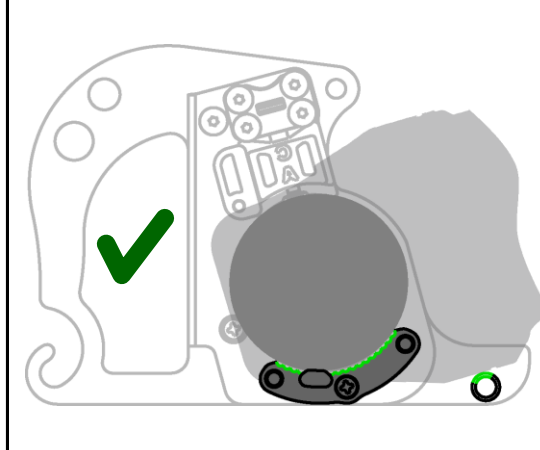
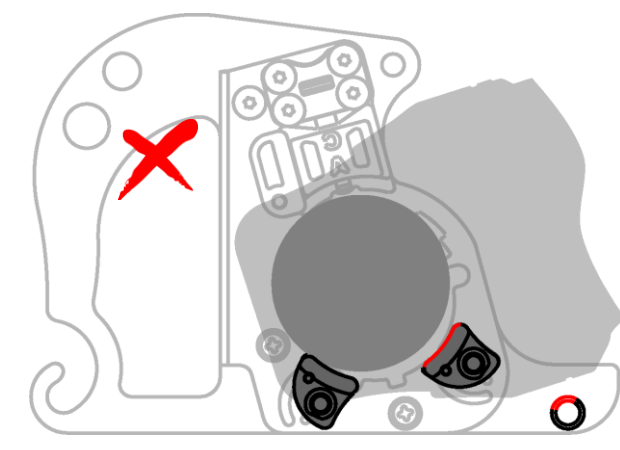
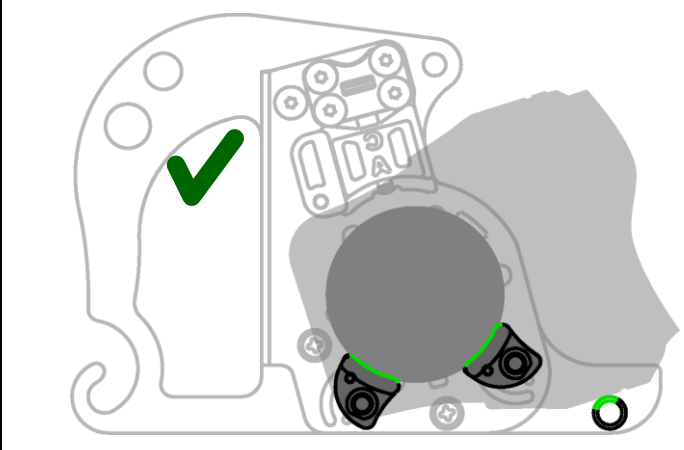
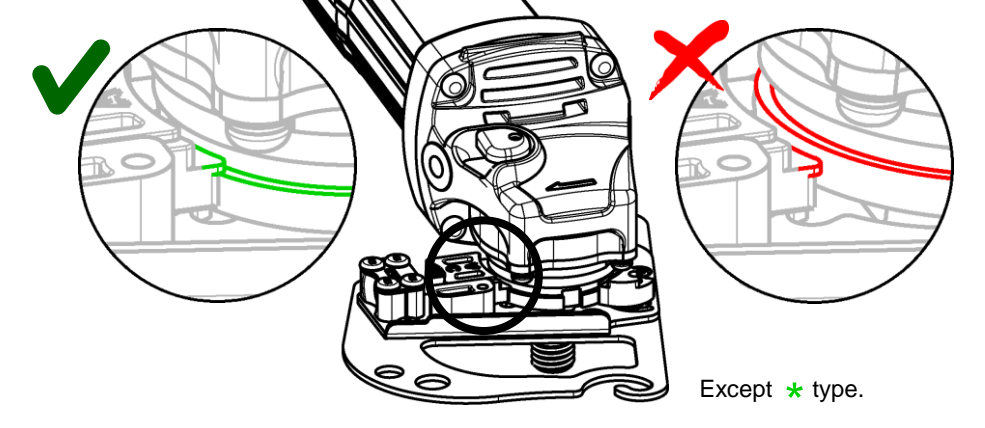
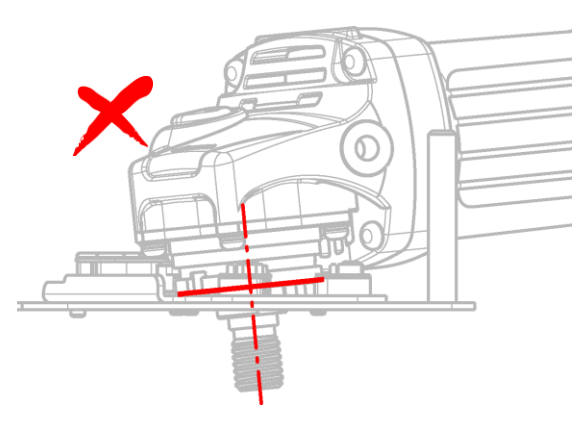
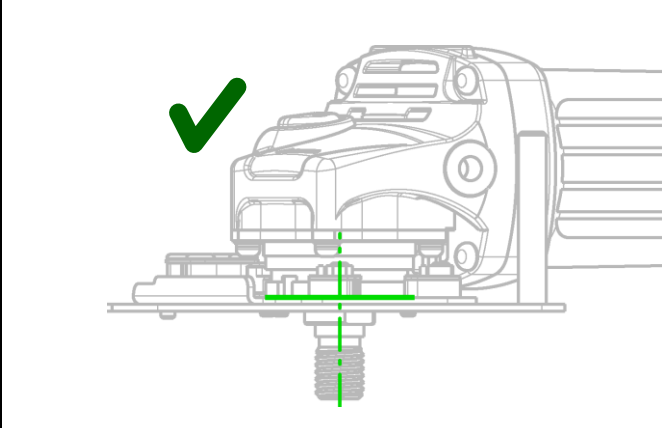
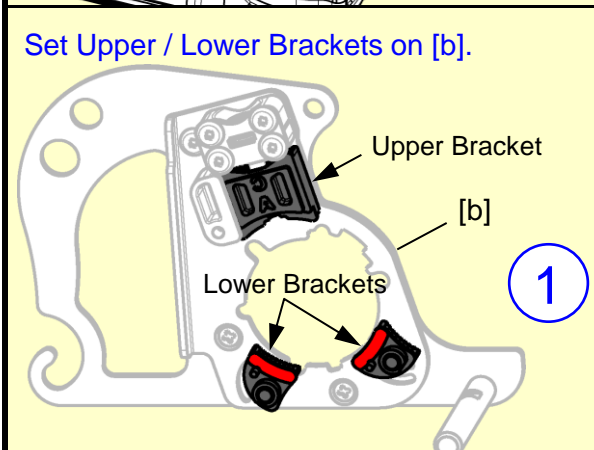
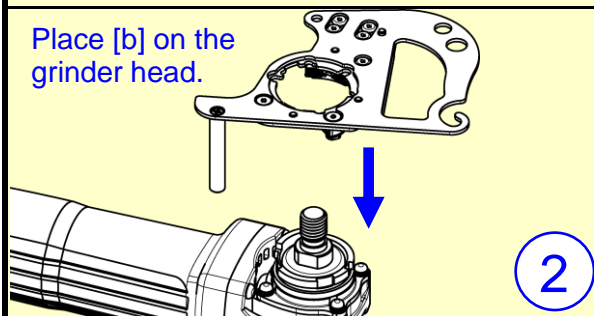
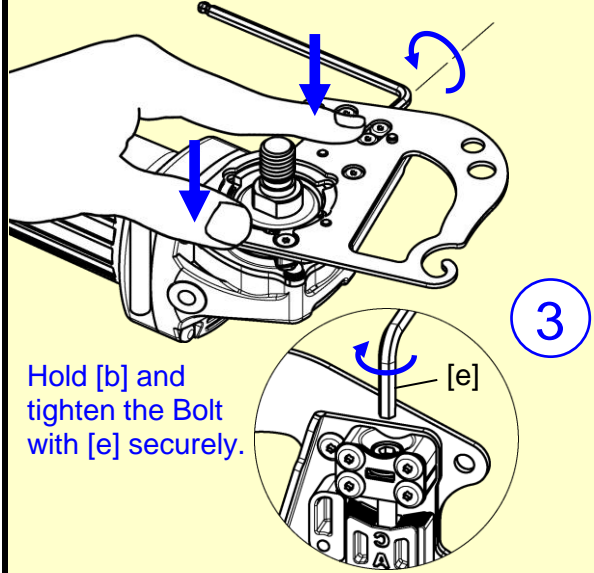
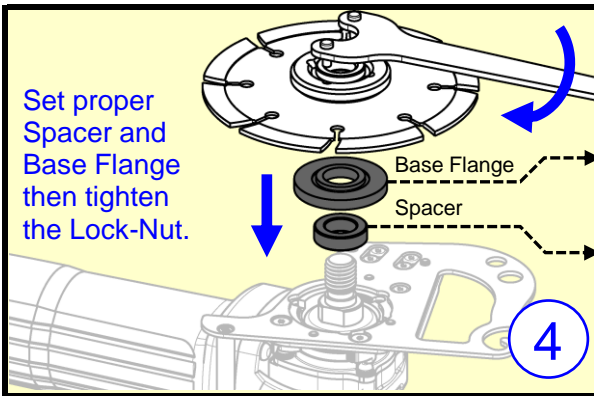

HIKOKI

※Based on the web information as of 2022 Jan.

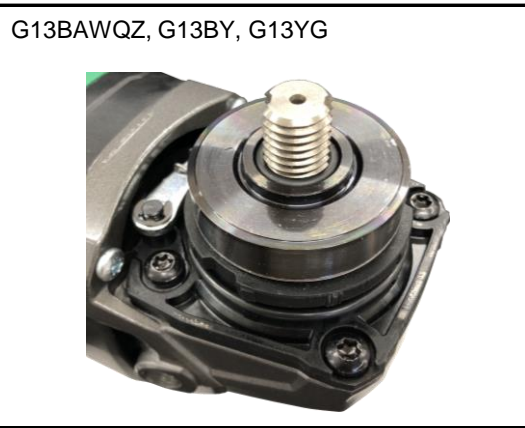

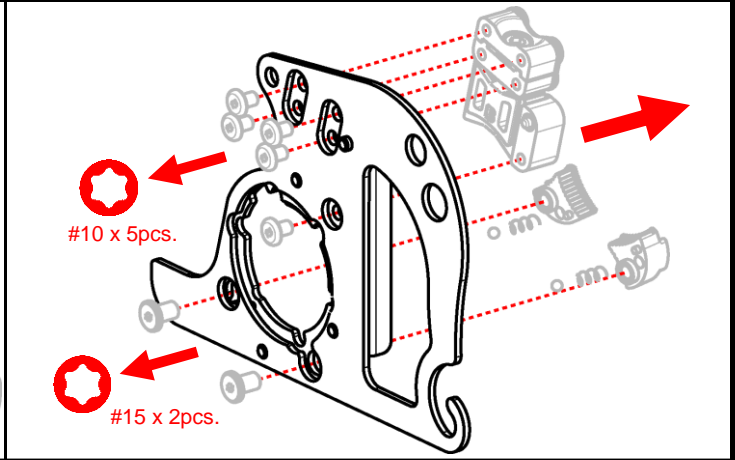
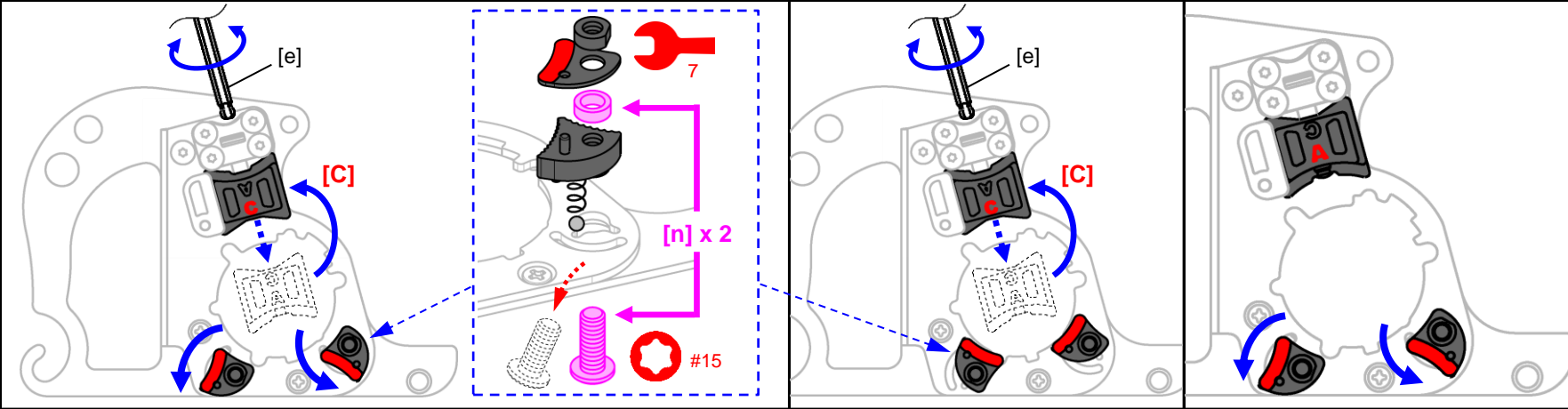
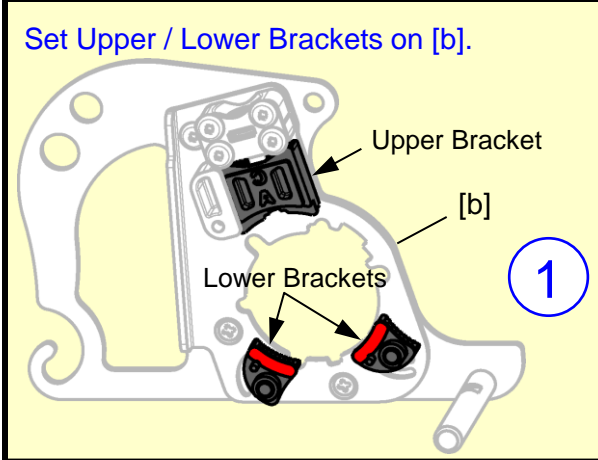
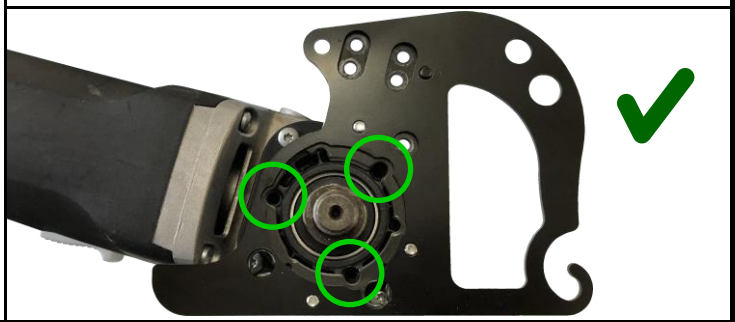
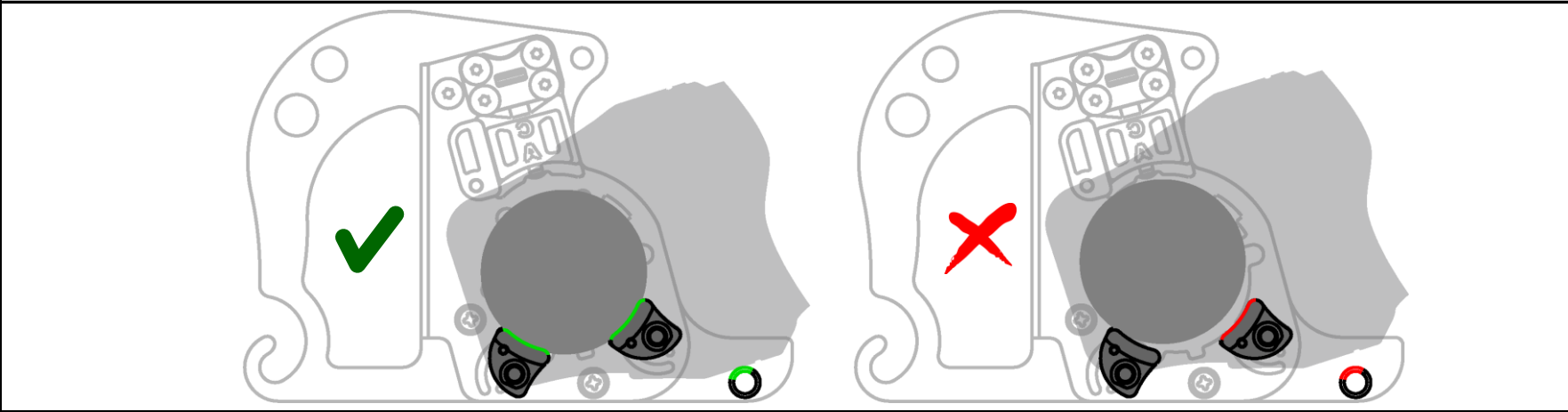
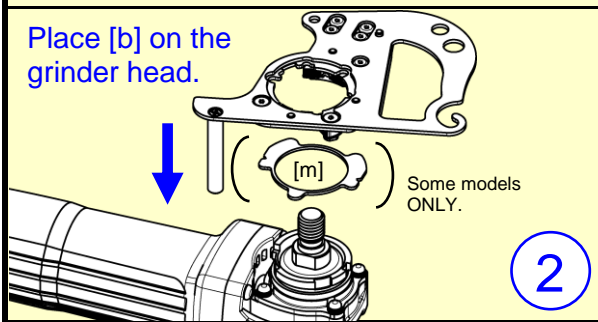
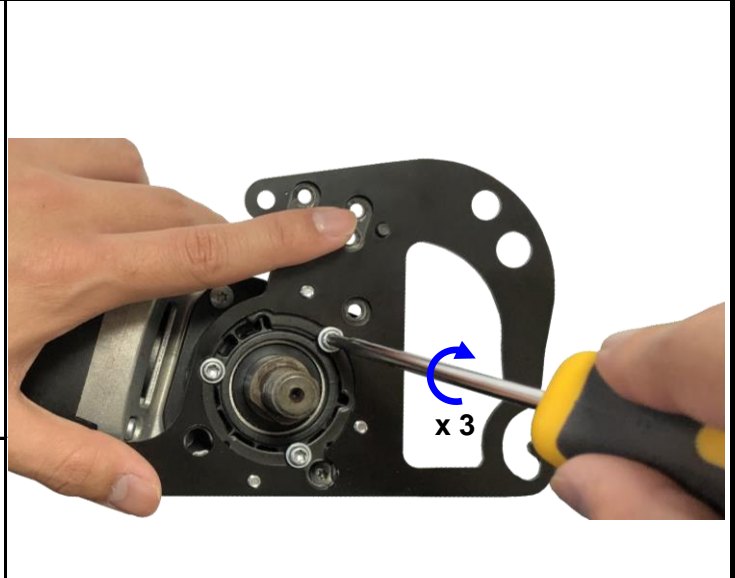
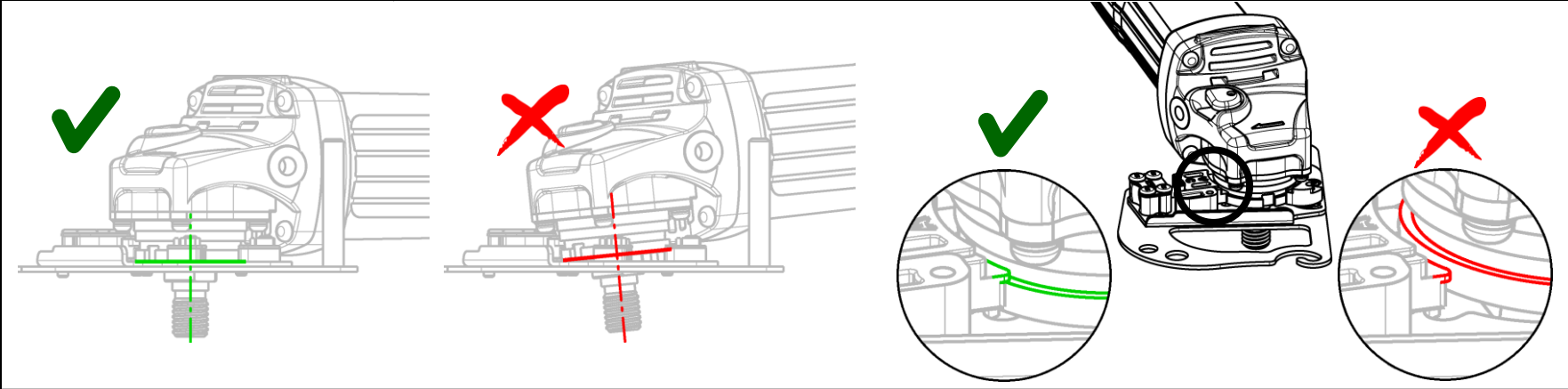
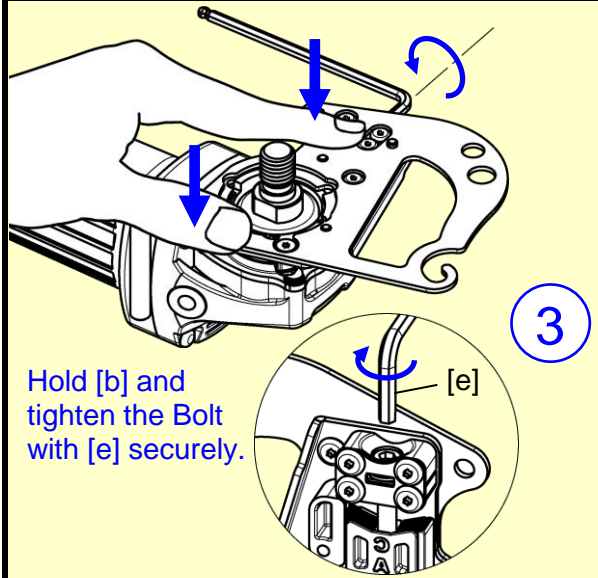
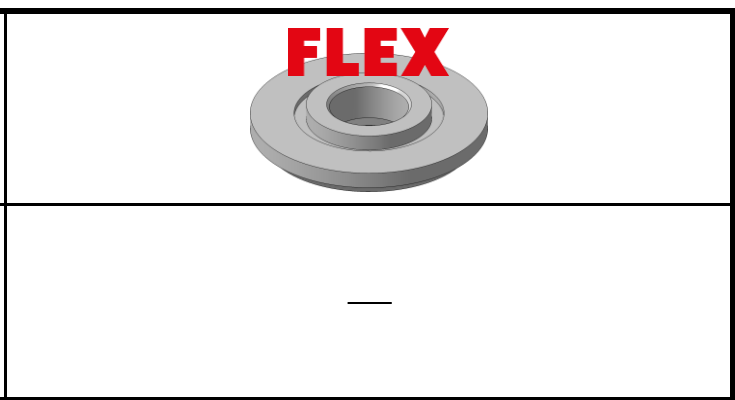
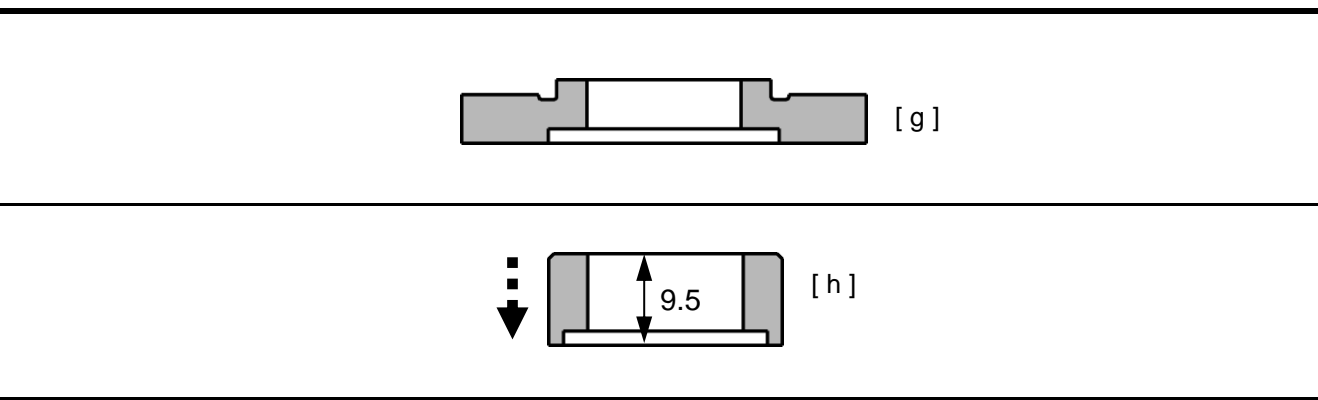
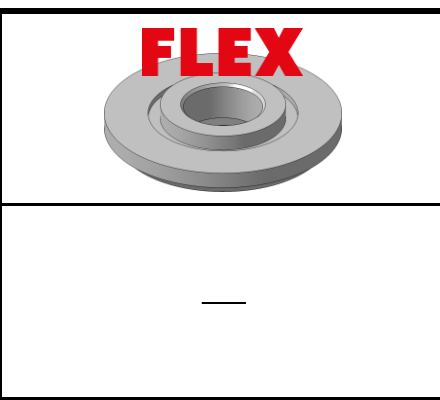
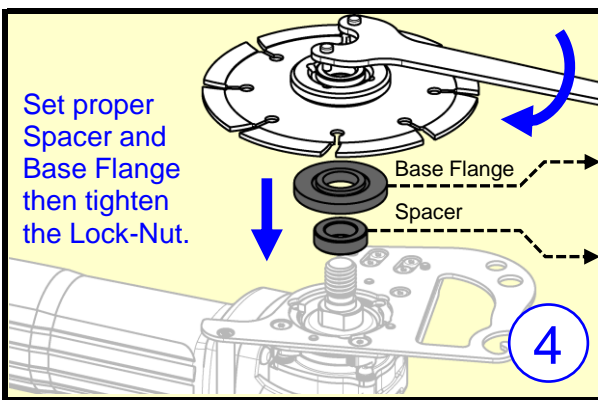

FLEX

※Based on the web information as of 2022 Jan.

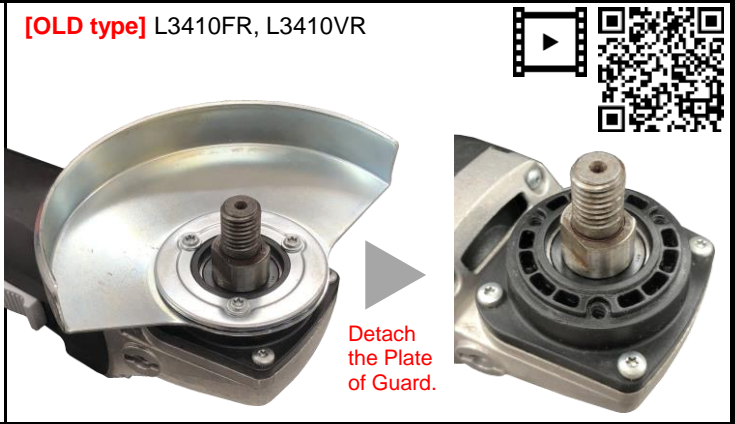
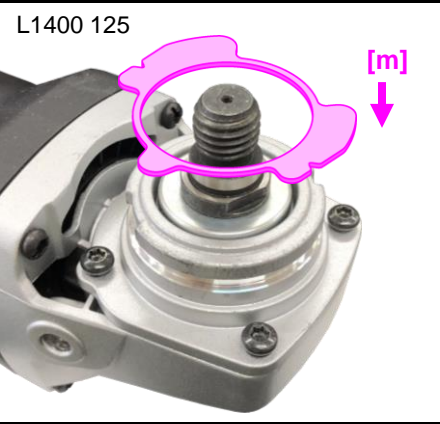

Head Office in Japan
NAKAYA CO.,LTD.
1313-92 Yanagisawa, Sanjo, Niigata, Japan
<https://nakaya-tools.com>
NAKAYA 
JAPAN ORIGINAL TOOLS

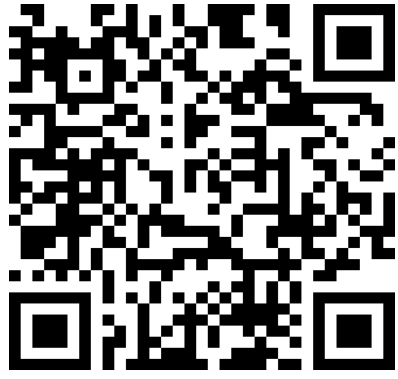

Check the
instruction
video.

