

[n] Washer for **Trakita** 40V_{max}, GA5050R type / **FLEX** L1400 125 type.

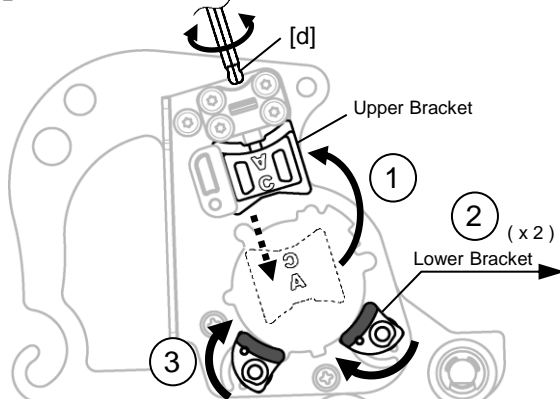

1. Change the Upper Bracket direction by operating [d] Wrench.
2. Add [n] Washer (this part) into the Lower Bracket. (2pcs.)
3. Turn the Lower Bracket clockwise until it stops. (2pcs.)

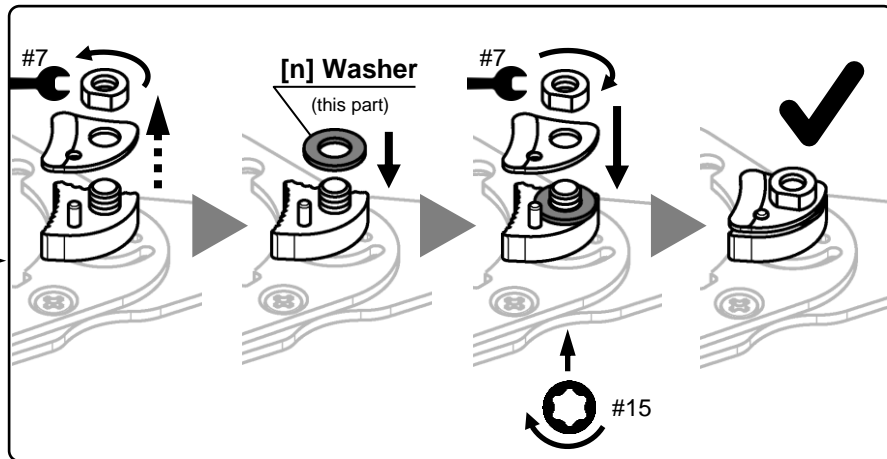

⚠ **Trakita**

40V_{max}, GA5050R type
need its lever detached.

