

Installation Guide



Makita



Set [h] / [i], [g] or Original Flange, and Blade into the Spindle. Then tighten the Lock Nut by Wrench.

4

Hold [b] and tighten the Bolt with [d] securely.

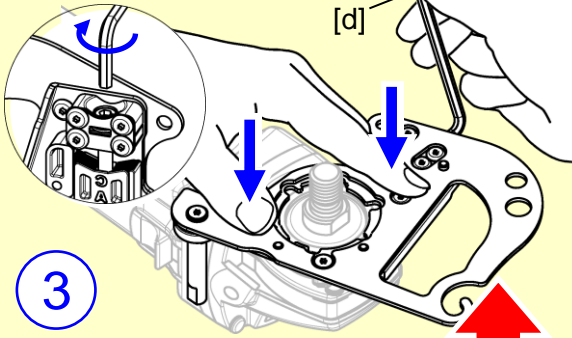

3

Place [b] on gearcase of the grinder.

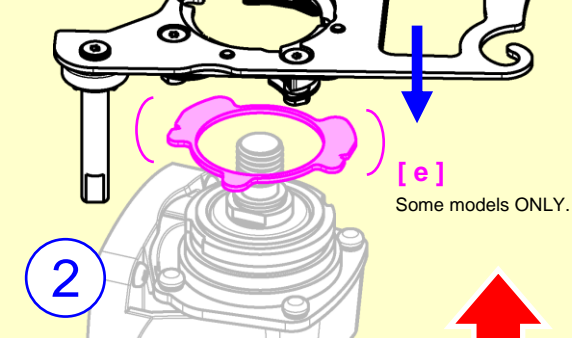

2

Set Upper / Lower Brackets on [b].

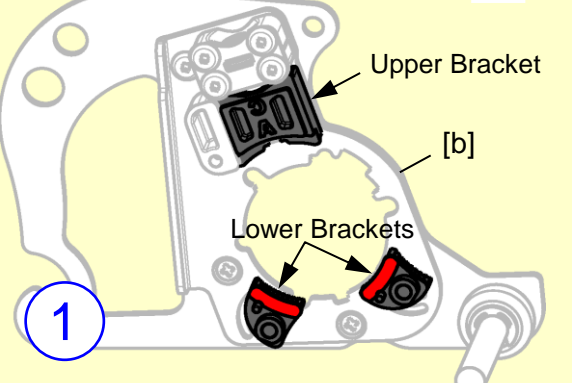

1

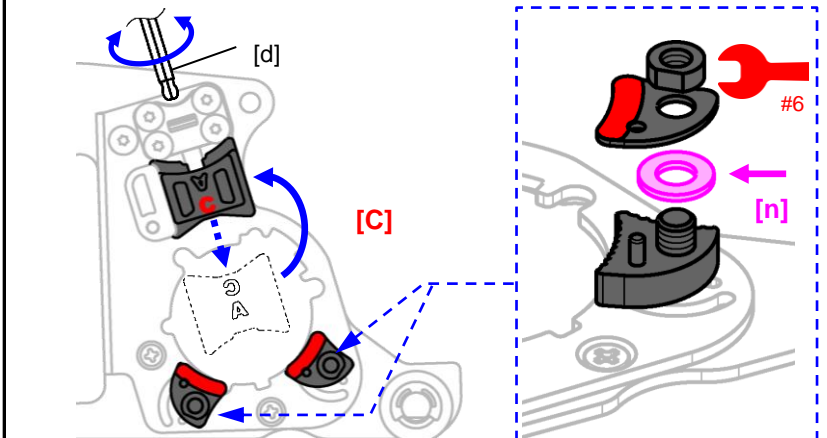
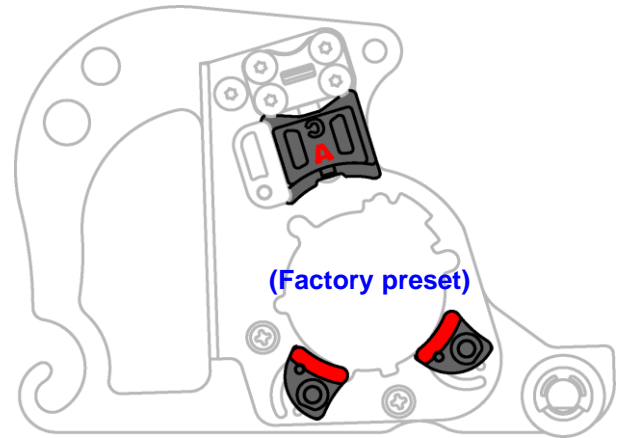
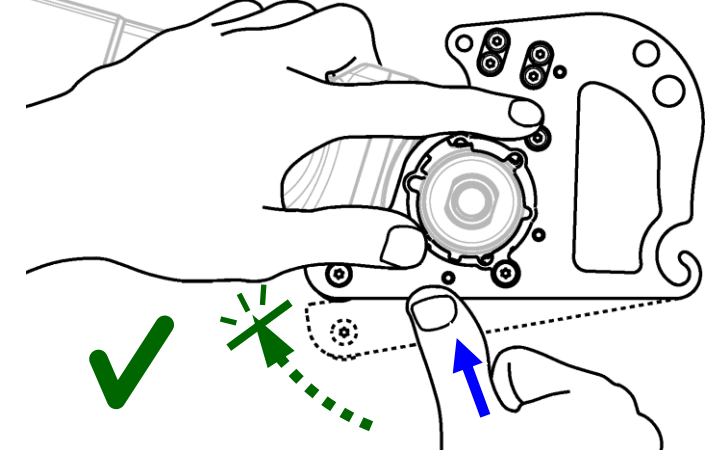
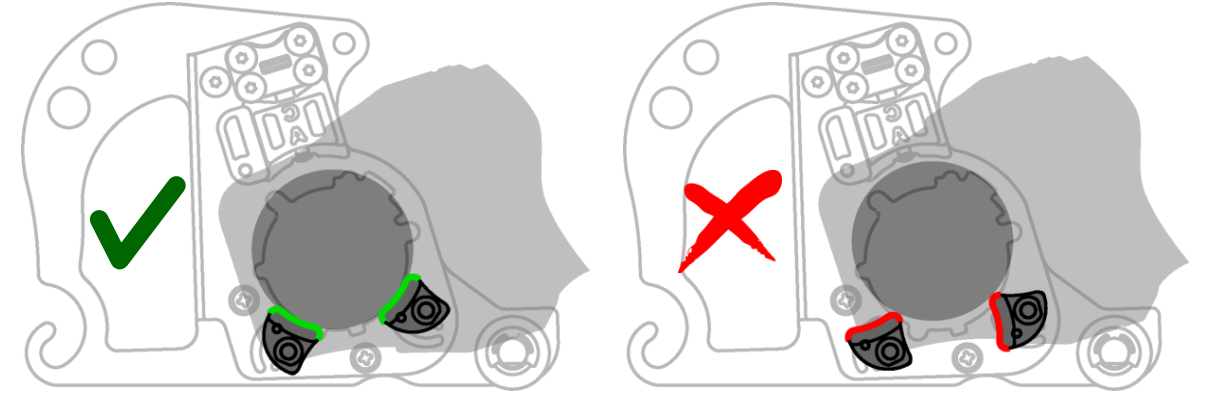
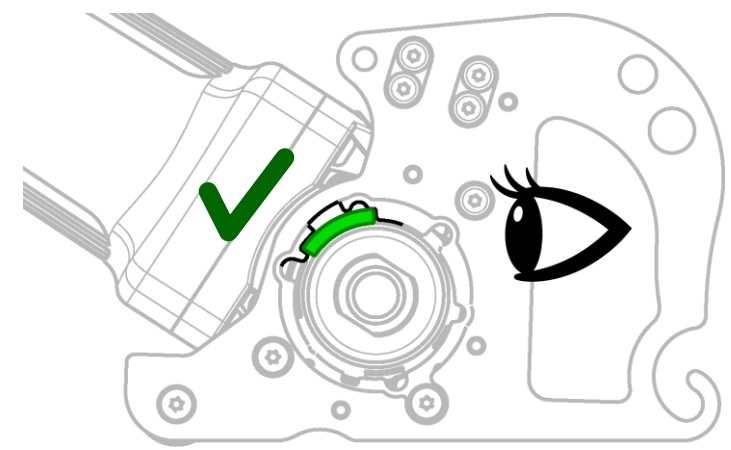
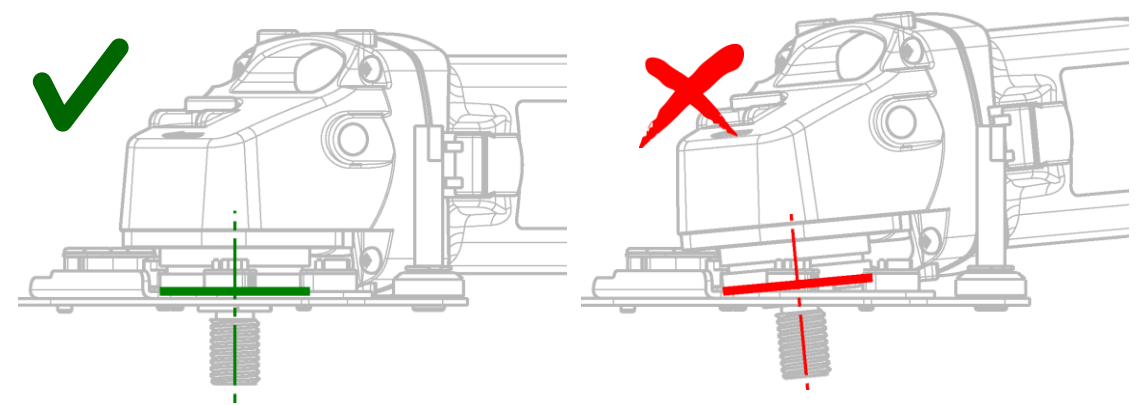

XAG011 / XAG016 / XAG020 etc.

9564 / GA4530 / GA5010 etc.

GA4542 / GA5042 etc.

9557NB etc.

GAG01 / GAG03 / GAG07 etc.

GA4553 / GA5052 / GA5053 etc.

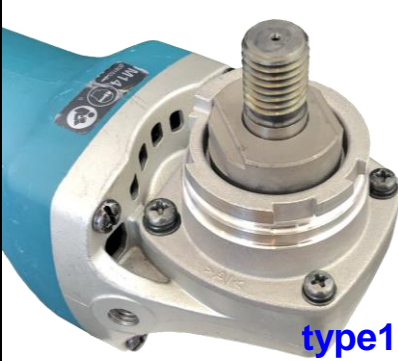

type1

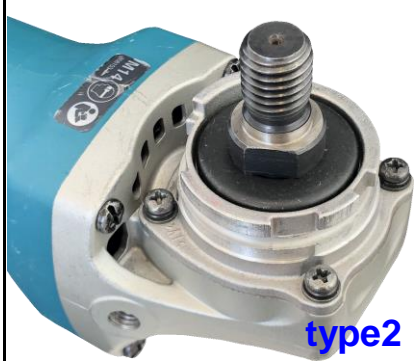

type2

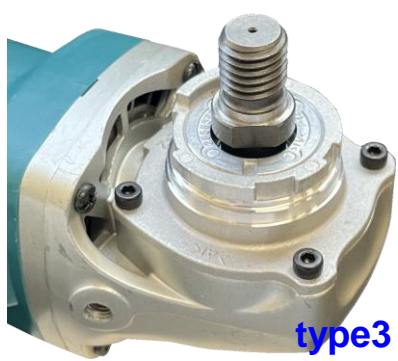

type3

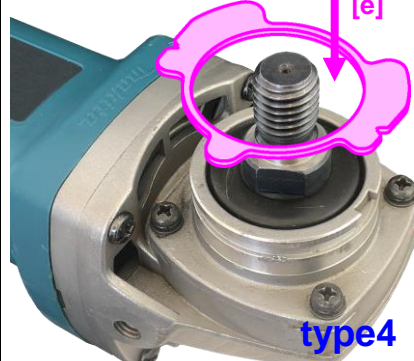

type4

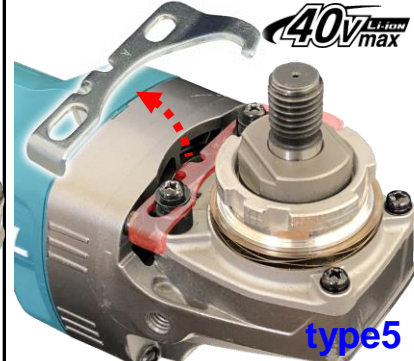

type5

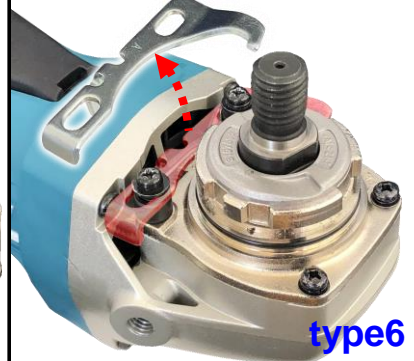

type6

Makita

XLOCK model can't be fitted.

※Based on the web information as of 2022 Jan.

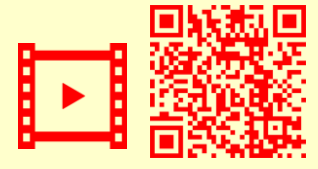

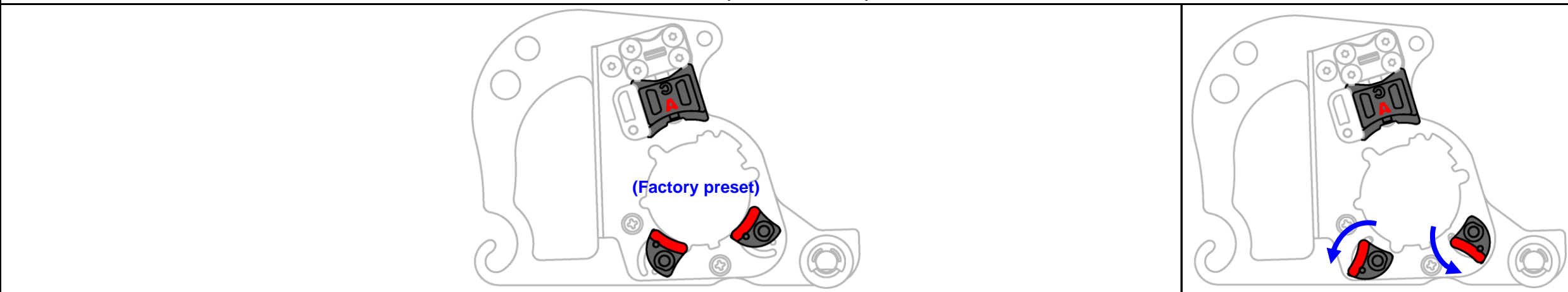
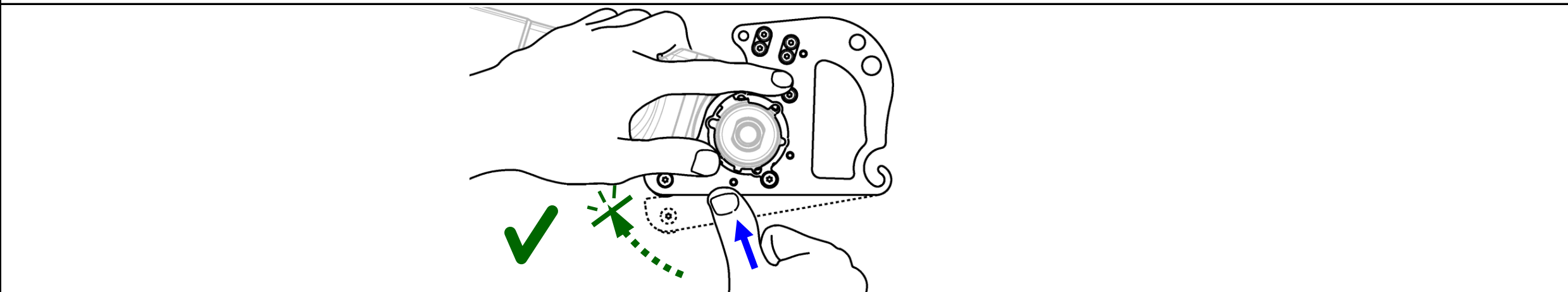
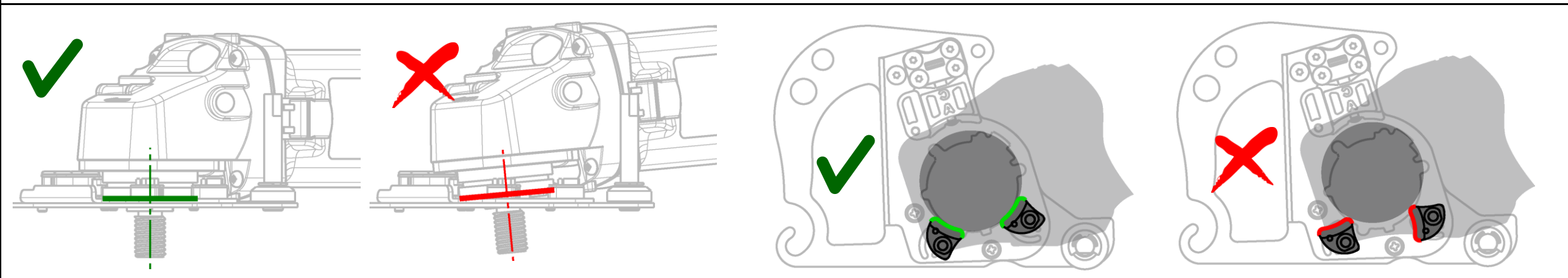
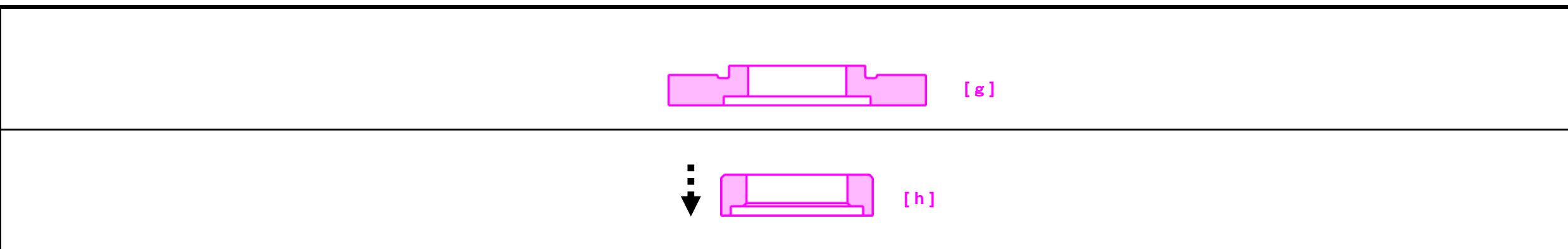
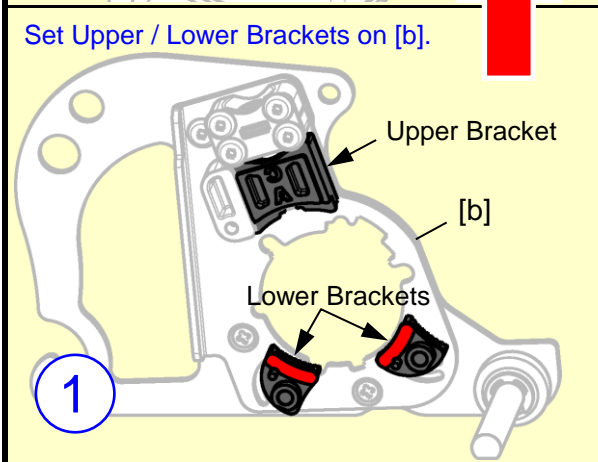
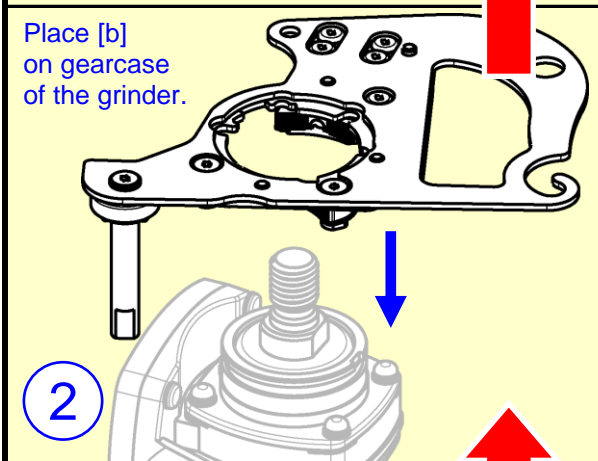
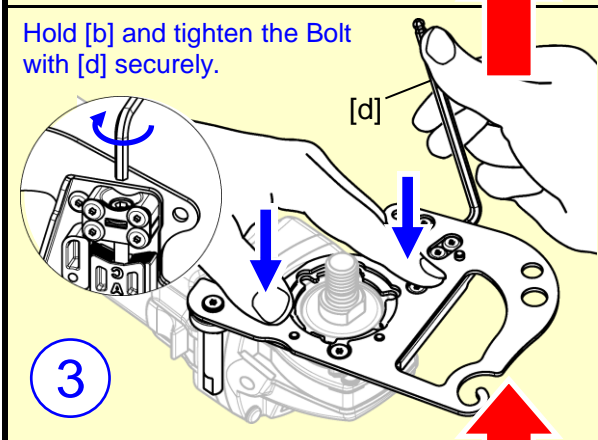
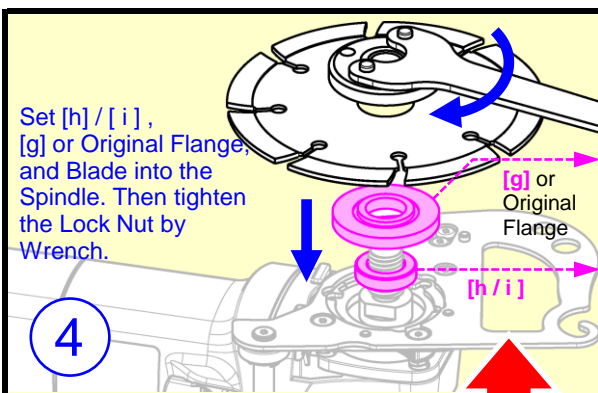

BOSCH

⚠️ **XLOCK** model can't be fitted.

※Based on the web information as of 2022 Jan.

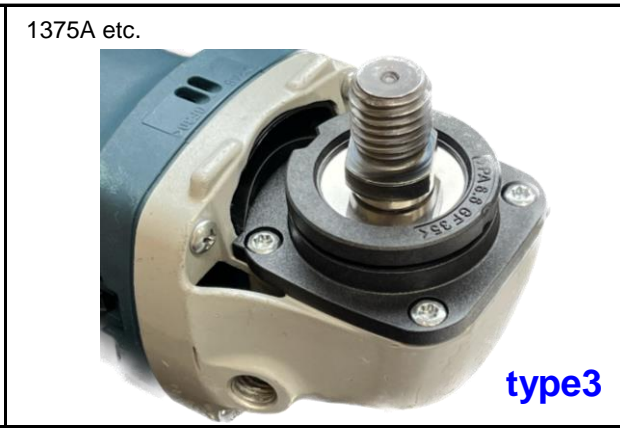
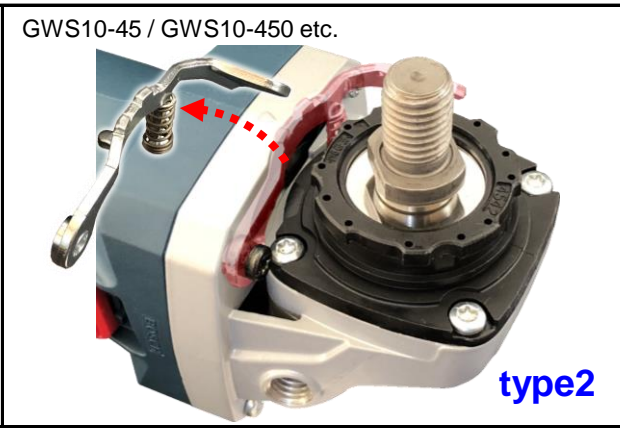
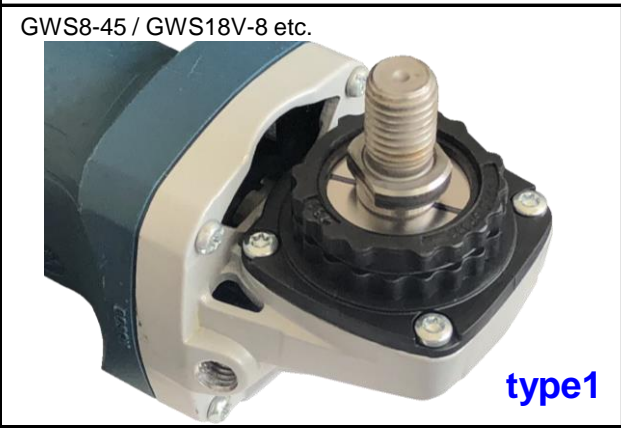

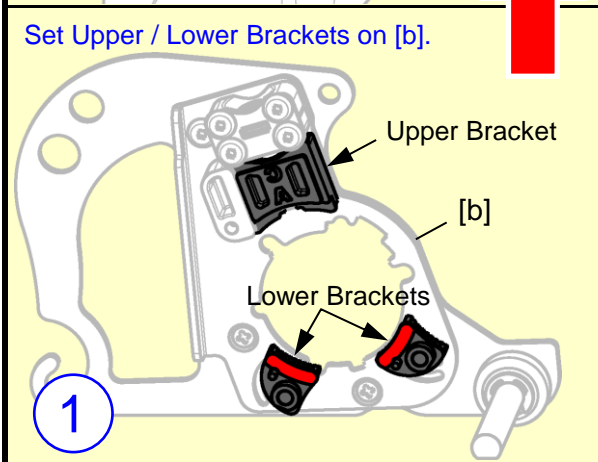
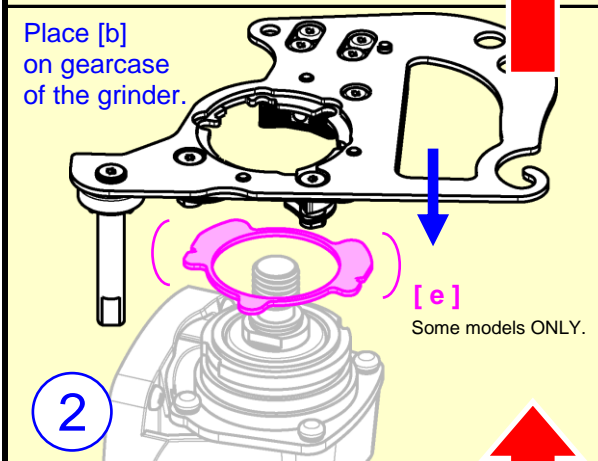
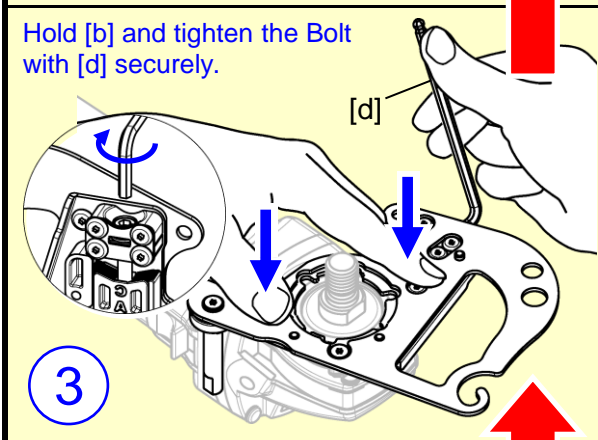
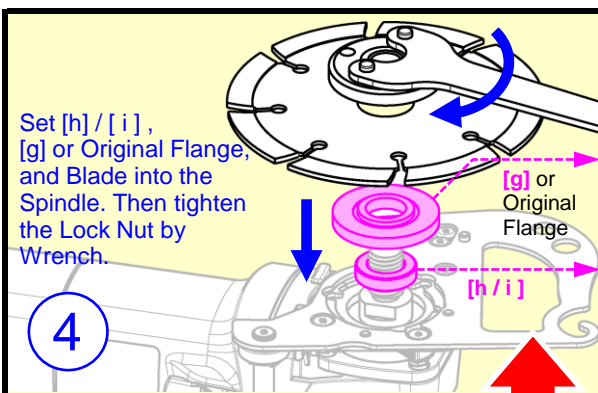

⚠ D28115 / D28114 / D28066 / D28131 / D28065 / D28140 type can't be fitted.

※Based on the web information as of 2022 Jan.

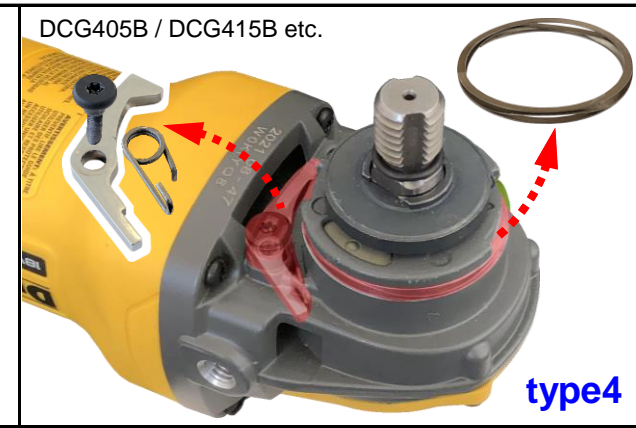
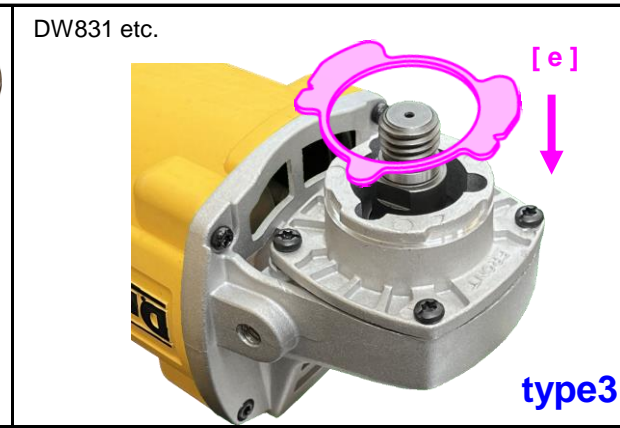
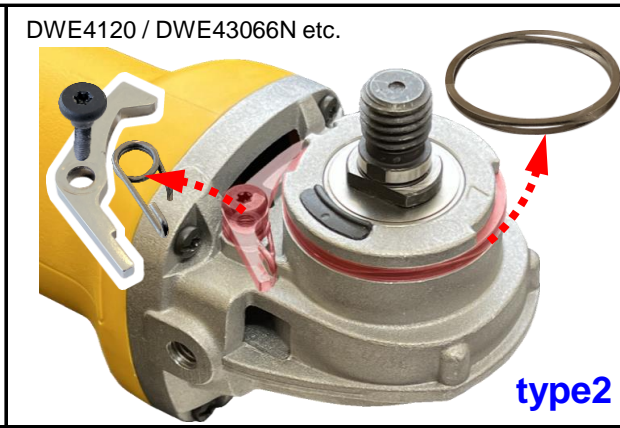
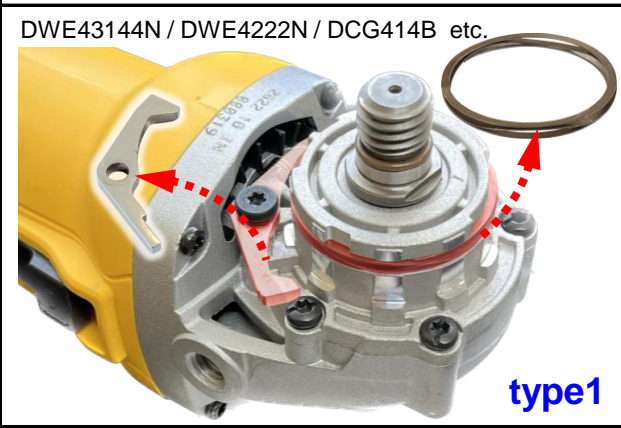
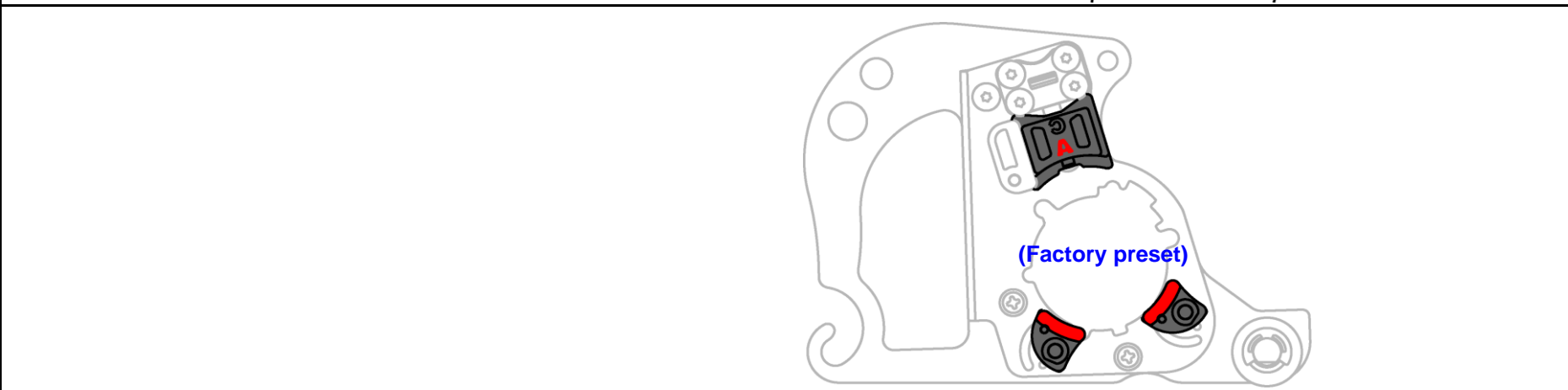
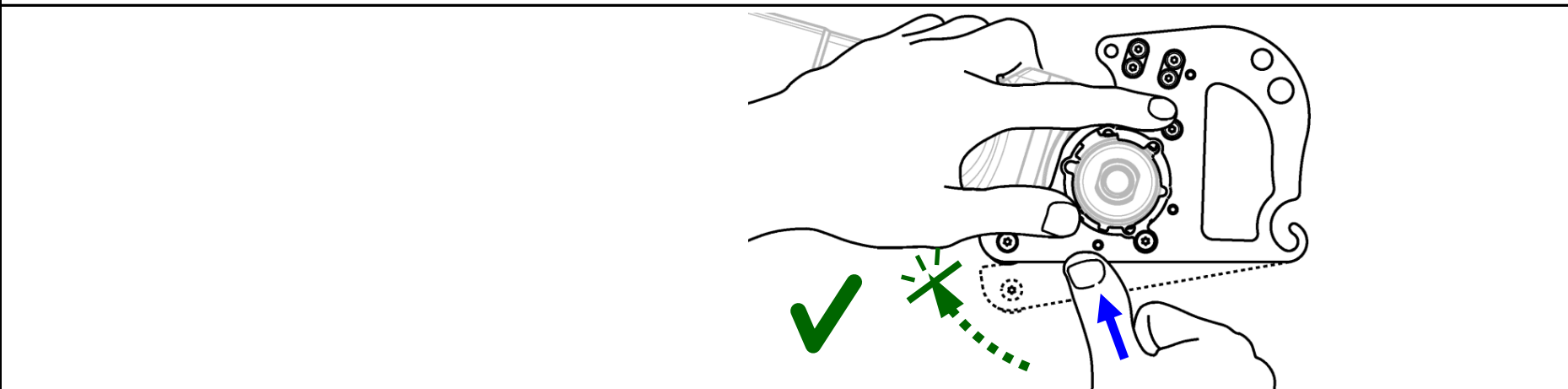
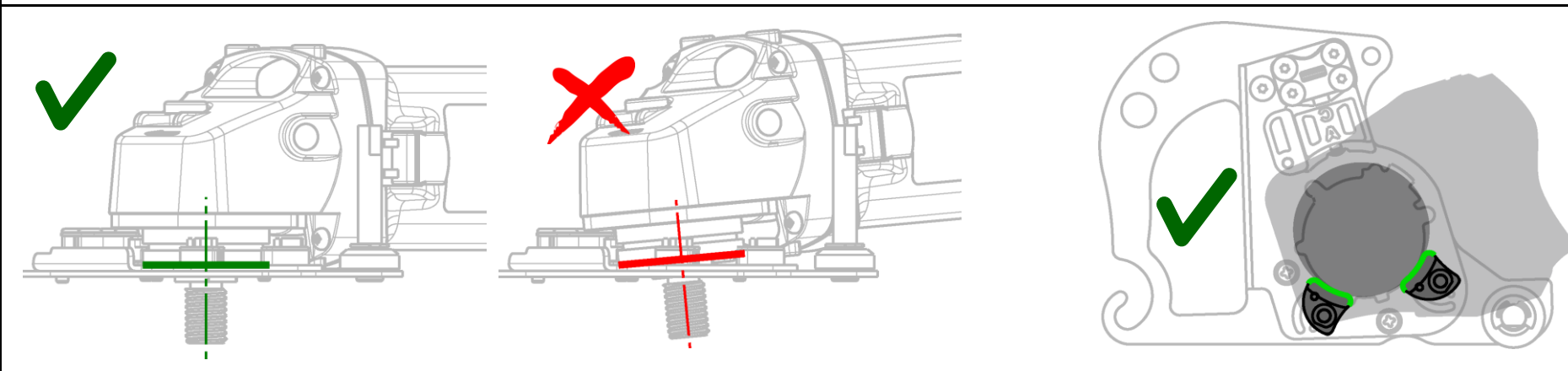
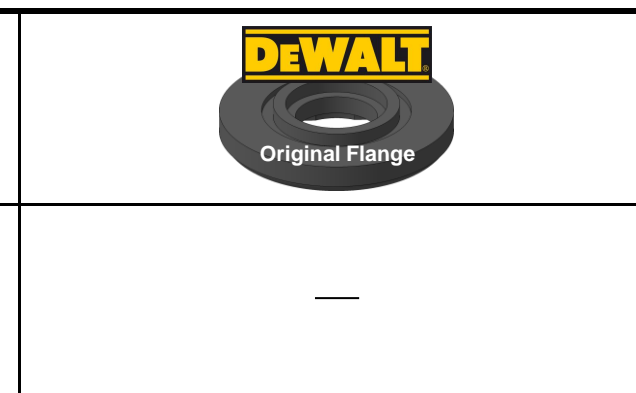
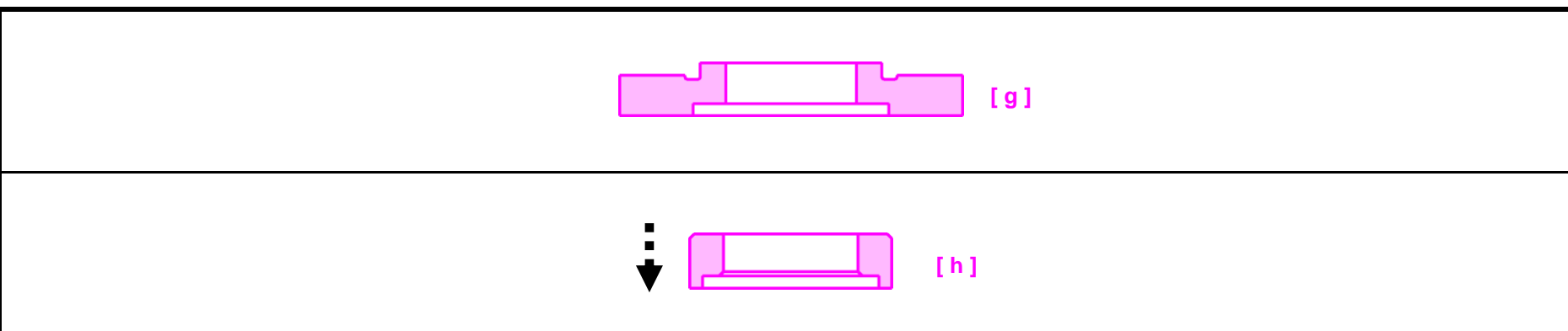

4

Set [h] / [i], [g] or Original Flange, and Blade into the Spindle. Then tighten the Lock Nut by Wrench.

3

Hold [b] and tighten the Bolt with [d] securely.

2

Place [b] on gearcase of the grinder.

[e/f] Some models ONLY.

1

Set Upper / Lower Brackets on [b].

Upper Bracket

Lower Brackets

[b]

[g]

[h]

[i]

[h]

Sold separately

Milwaukee Spacer N400401

Original Flange

(Factory preset)

#15

Milwaukee

6130-33 / 2680 / 6140 type can't be fitted.

Based on the web information as of 2022 Jan.

2980 / 2981 / 6143 etc.

[e]

type1

6121 / 6141 / 6142 etc.

[e]

type2

2888 / 2889 etc.

[e]

type3

6146 / 6147 etc.

[f]

type4

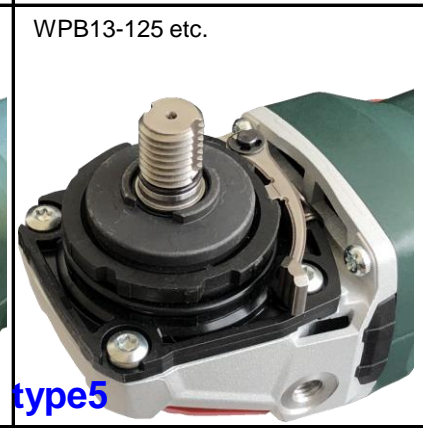
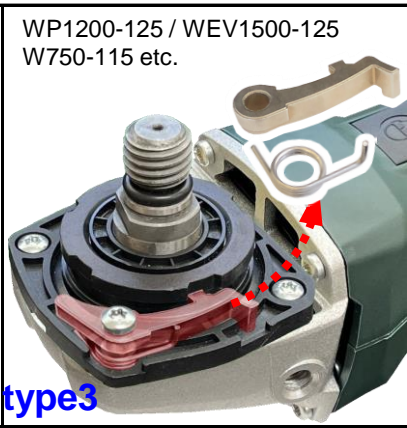
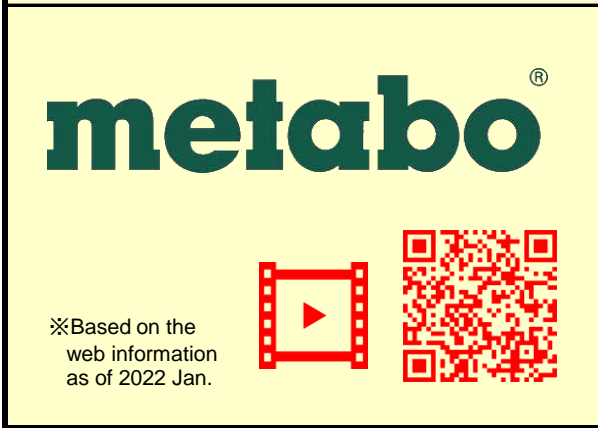
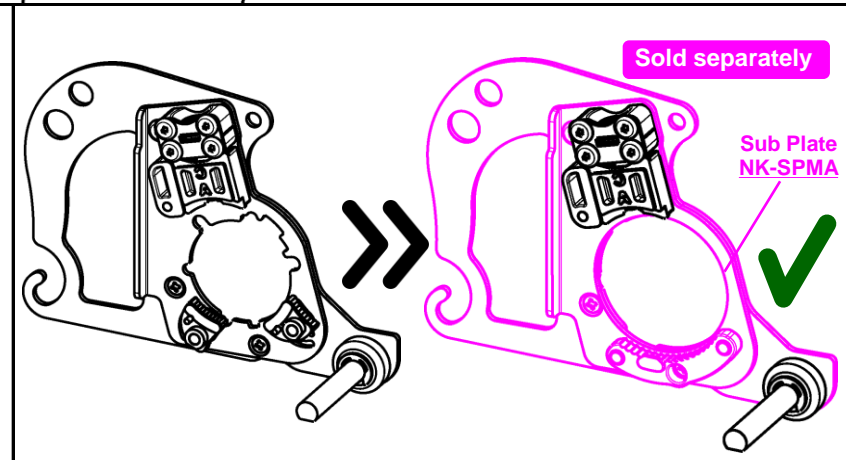
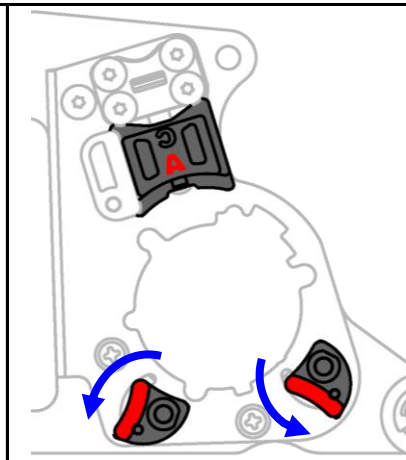
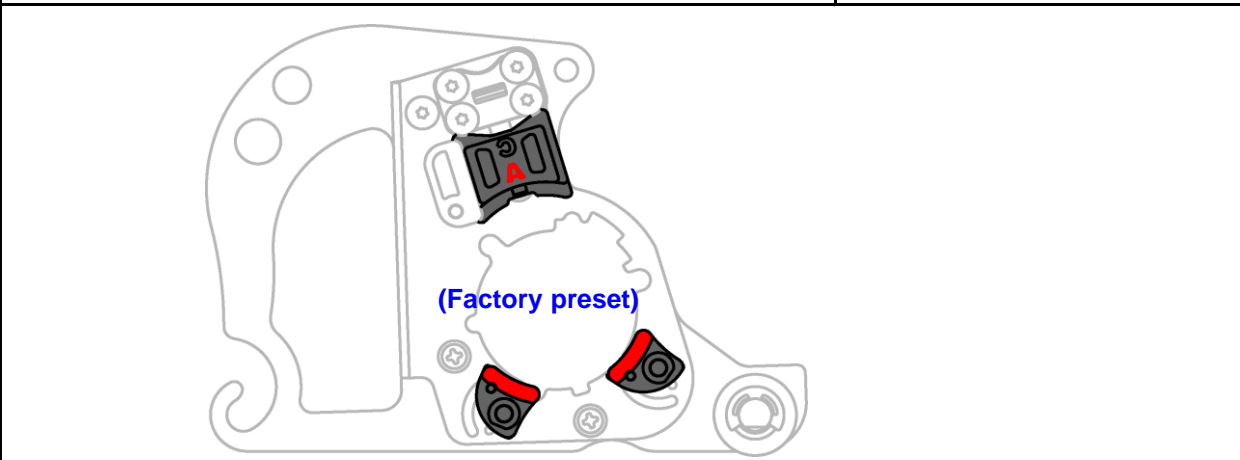
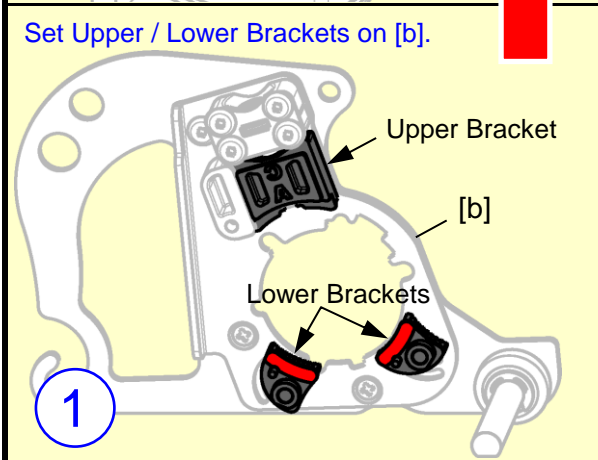
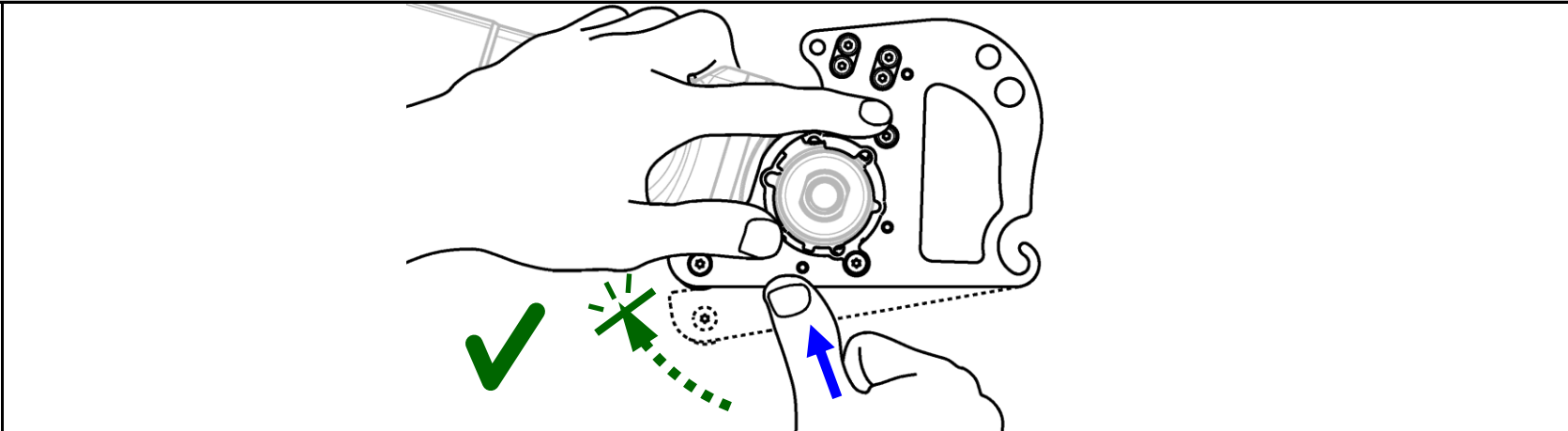
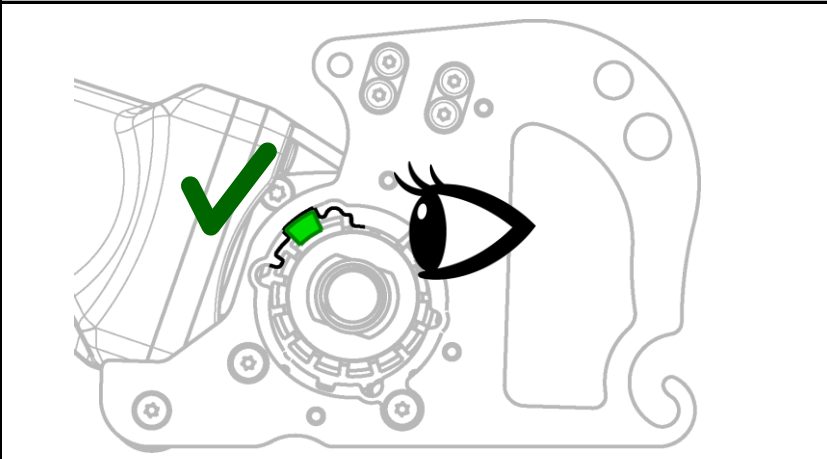
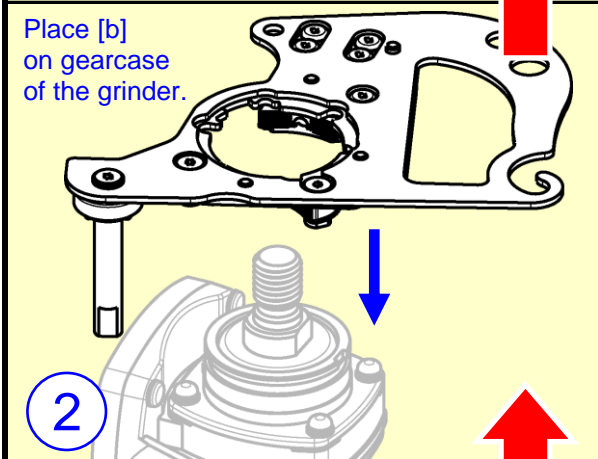
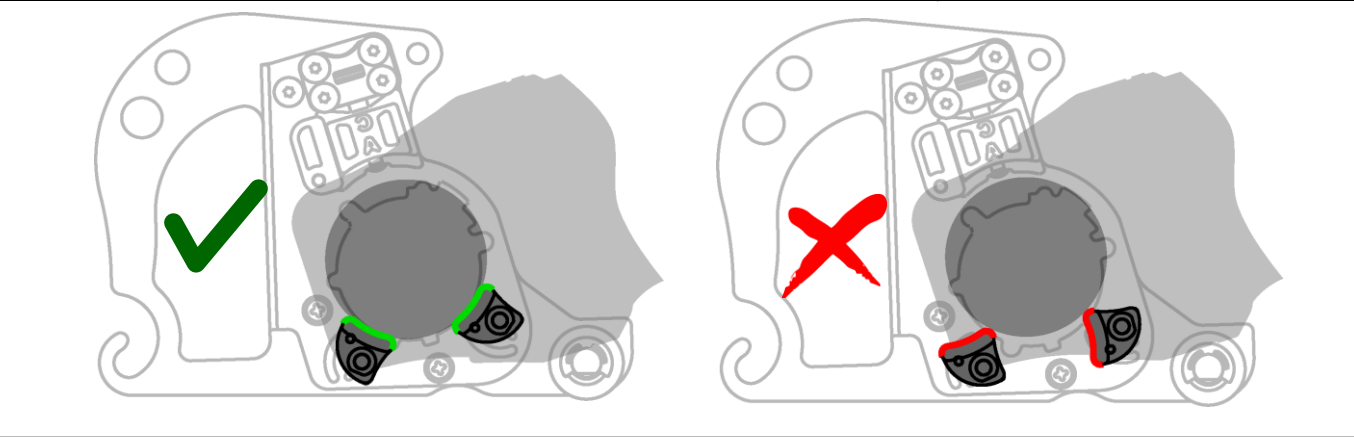
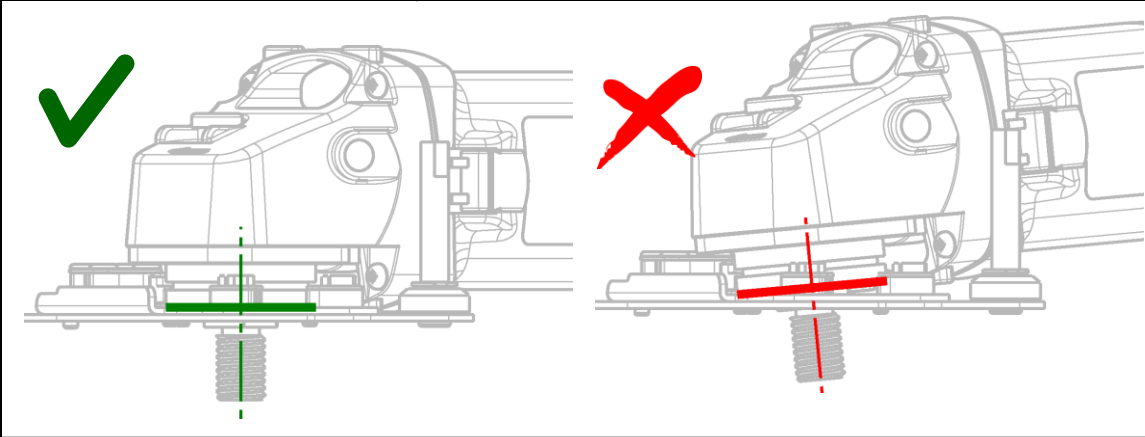
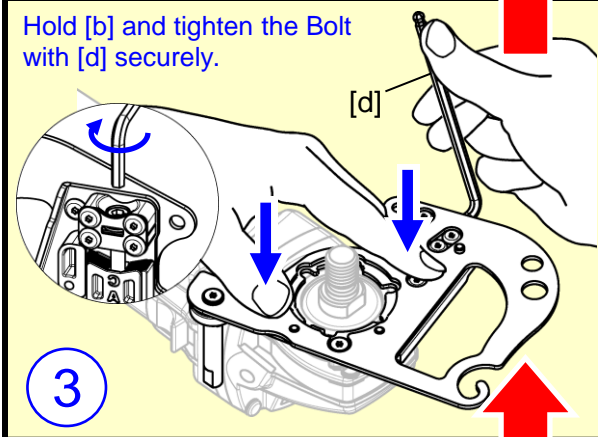
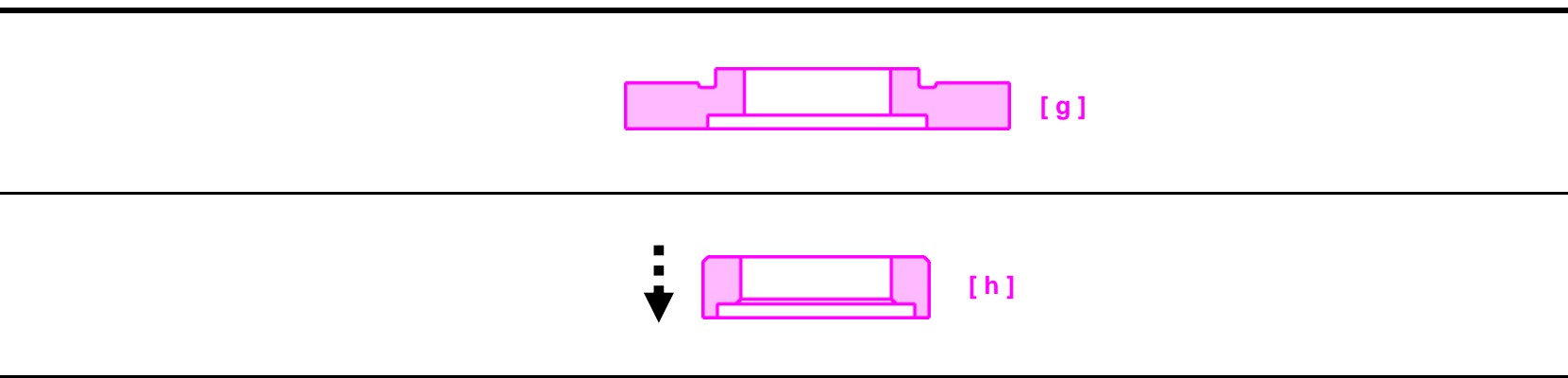
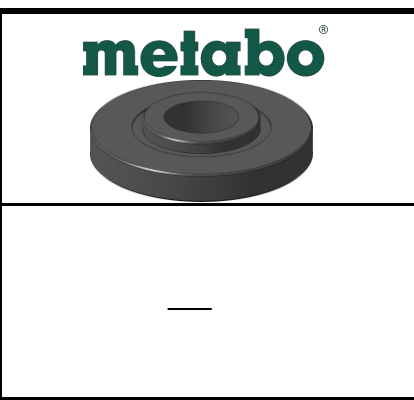
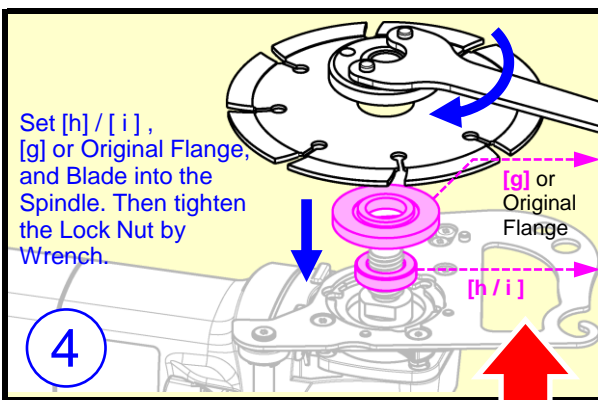

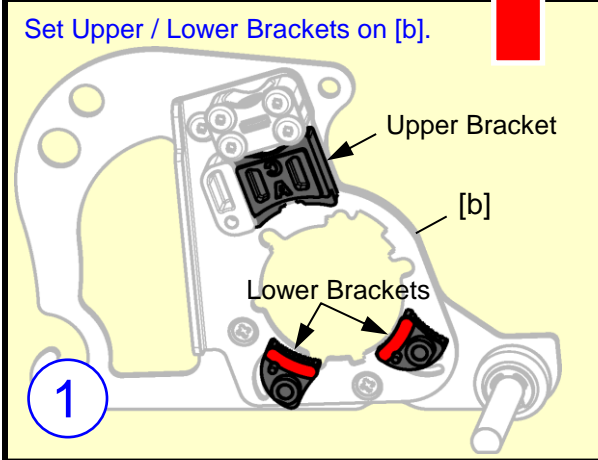
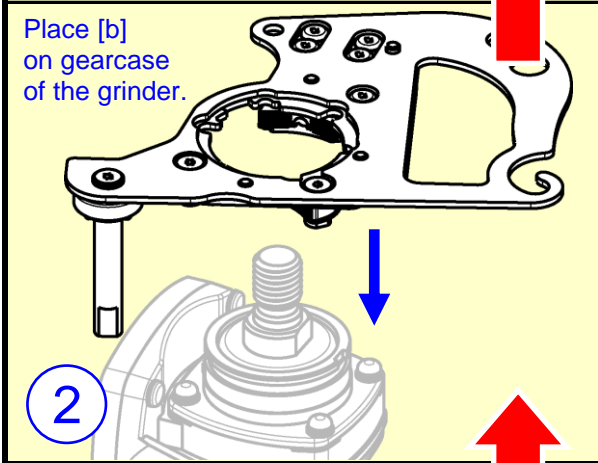
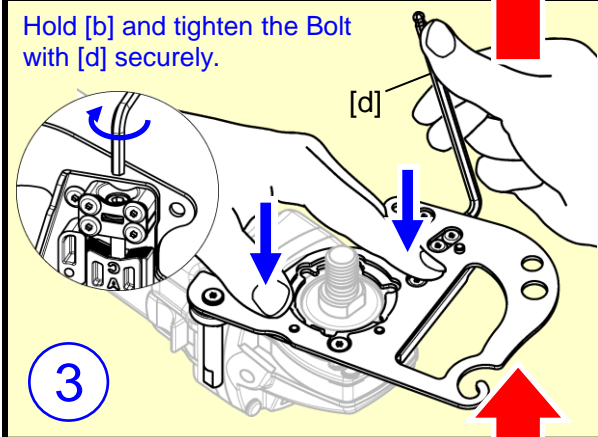
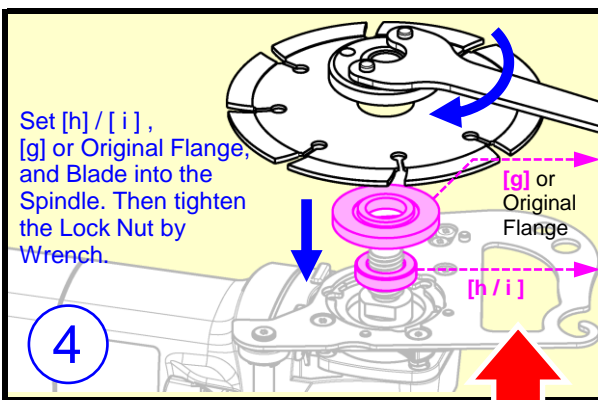

metabo HPT

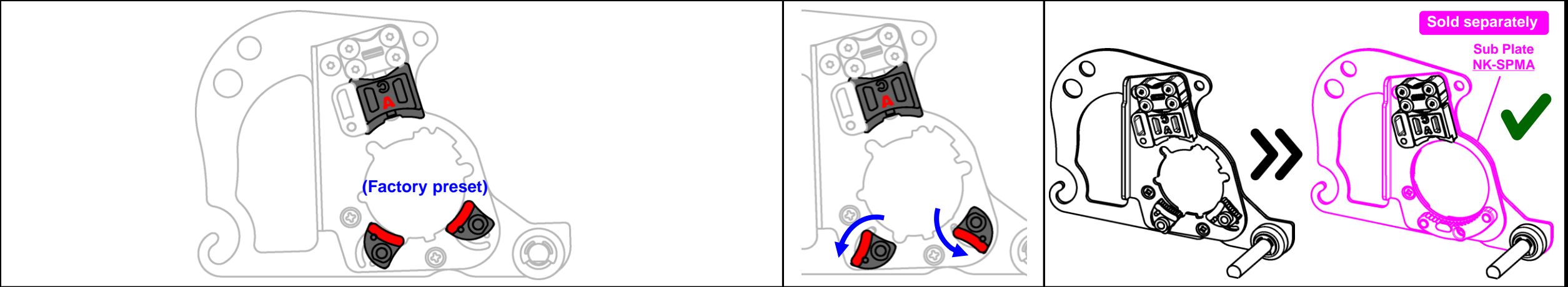
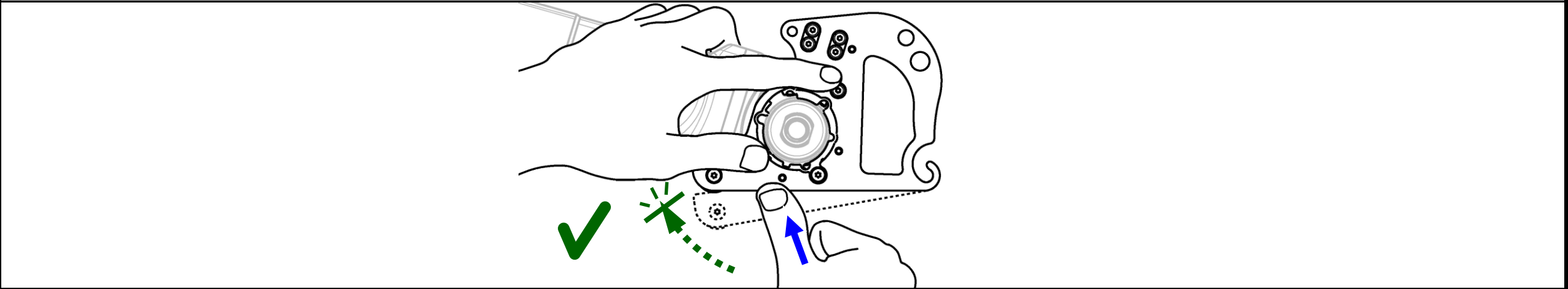
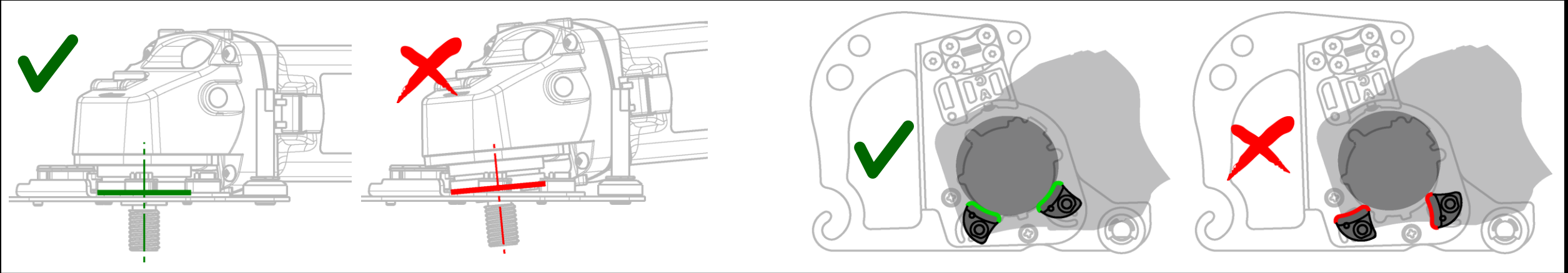

metabo HPT

※Based on the web information as of 2022 Jan.

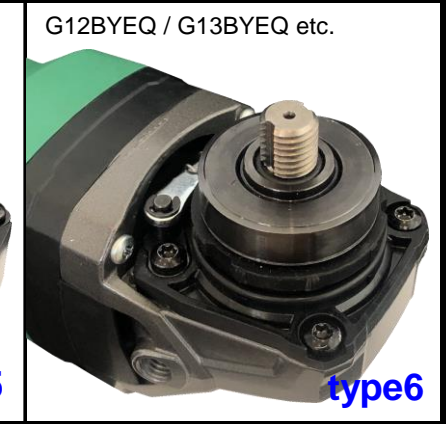
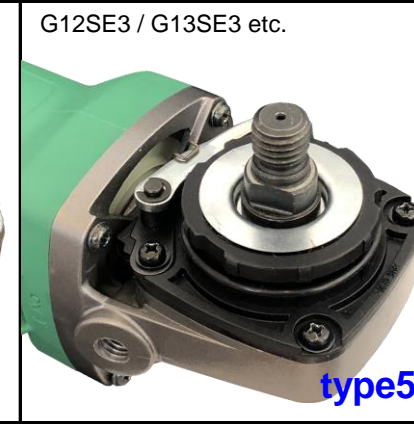



Check the
instruction
video.

