

⚠ WARNING

- DO NOT use NK-125MA with the angle grinder which can NOT be fitted correctly as instructed in this manual.
- NK-125MA is only for cutting concrete, block, and tile. DO NOT use for cutting steel or other materials.
- NK-125MA must be used with the Vacuum suitable for the concrete dust.
- NK-125MA is only for 115-125mm Diamond cutting blades. DO NOT use with abrasive wheels or tipped saw blades.
- Always check NK-125MA for damage, cracks, or deformation before use.
- DO NOT use NK-125MA if it is cracked, damaged or bent as this could lead to injury.
- Be sure to wear the protective goggles, dust mask, protective foot wear, earplugs and other protective equipment when working.
- Keep NK-125MA away from gasoline, solvents, and paraffin.
- Ensure the cutting material securely clamped before cutting.

Explanation of the pictograms.

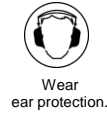

SPECIFICATIONS

| | |
|-------------------------|--|
| Model Code | NK-125MA |
| Suitable Blade | 115-125mm T1.5-2.2mm Diamond Blades. |
| Cut Depth | 5-25mm (125mm Blade) 5-20mm (115mm Blade) |
| Weight | 690g (Main Unit with adaptor system) |
| Work material | Concrete, Block, and Tile. |
| Suitable Angle Grinders | Makita / BOSCH / Dewalt / Milwaukee / Metabo / Metabo HPT(HiKOKI) 115-125mm class small angle grinder. |

※Based on the web as of 2022 Sep.

Some special angle grinders (ex. X-LOCK type) may not be installed. Please scan the QR code on the left to check compatibility.

OVER VIEW

[a] Main Unit / [b] Adapting Unit / [c] Bolt / [d] Wrench / [e] Offset Plate / [f] Milwaukee Plate
[g] Base Flange / [h] Spacer T6.5 / [i] Spacer T3.3 / [m] Joint / [n] Washer

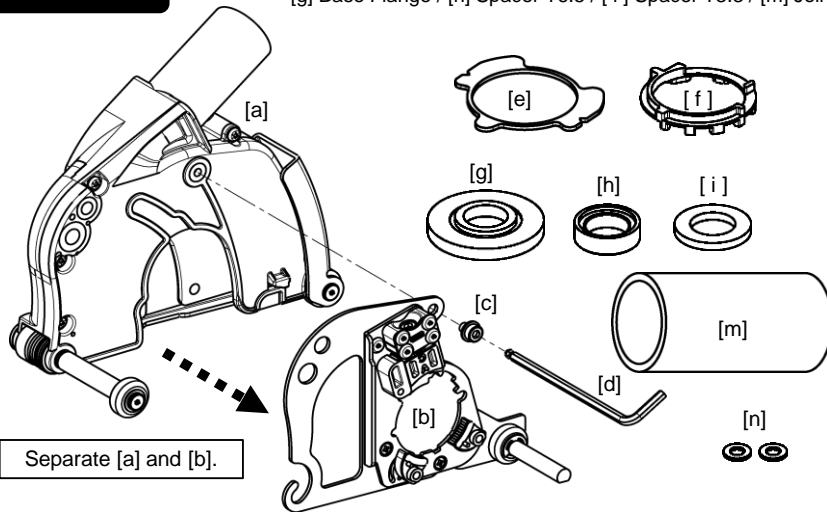

Sold Separately

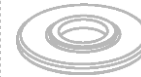

Milwaukee
Spacer
N400401



6146 / 6147 etc.

Sold Separately

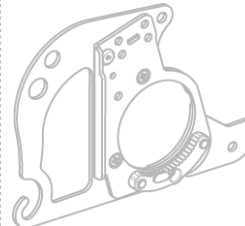

metabo

WPB13-125
WEPBA17-125 / WEPBA19-125 etc.
metabo HPT
G12SE3 / G13SE3
G12BYEQ / G13BYEQ etc.

Sub Plate NK-SPMA
is required separately
for the "Large Flange"
grinders on the right.

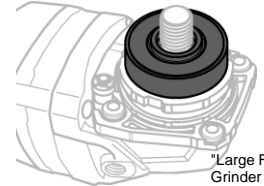

"Large Flange"
Grinder

INSTALLATION



Check the
Installation Guide.

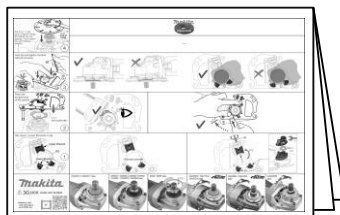

Check the instruction
video at this QR code.



1. Detach the Guard from the grinder.

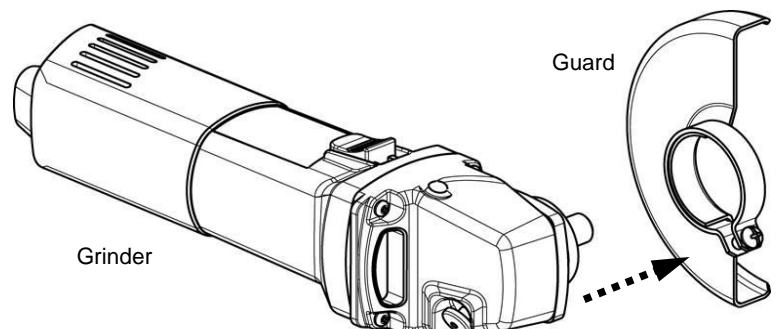

2. Some grinders need its lever and related components detached.

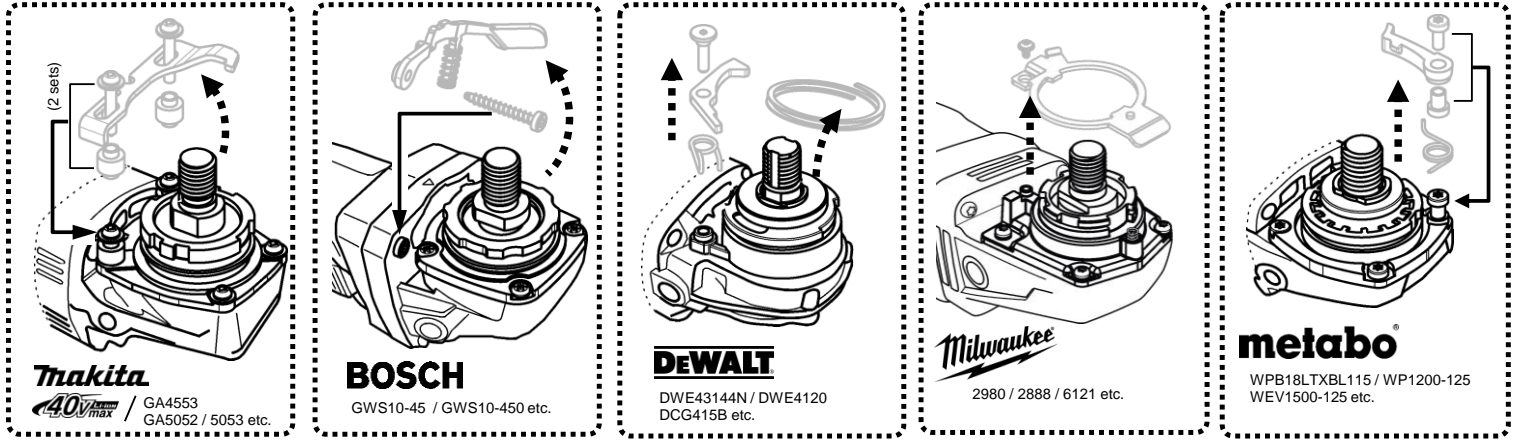

3. Some grinders need preparation for [b] Adapting Unit.

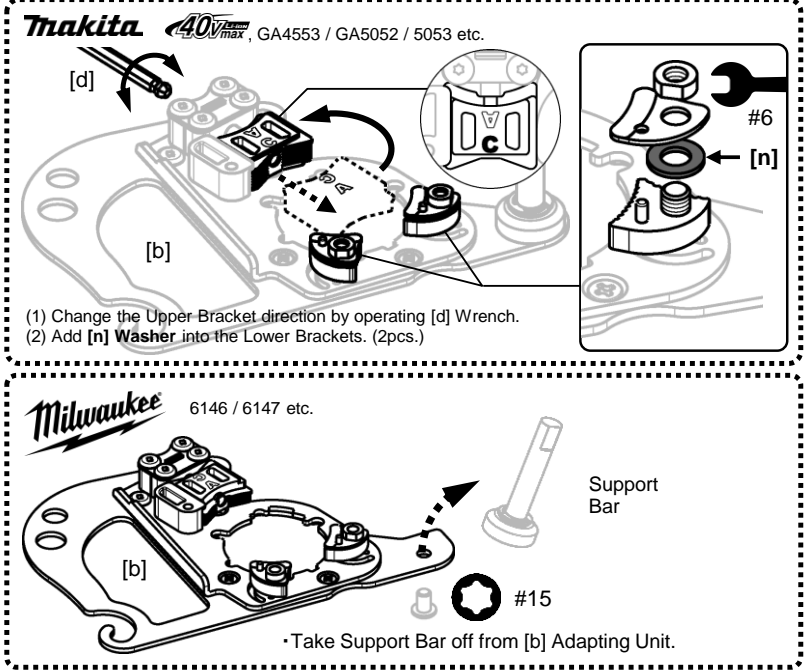
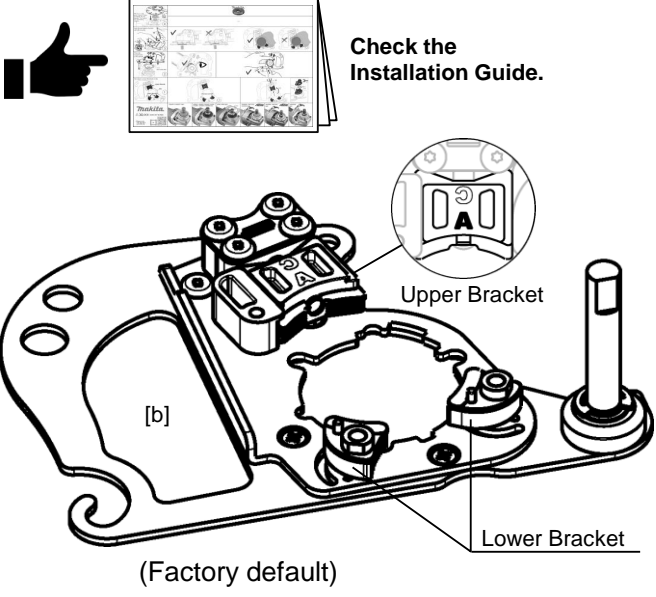

4. Switch the Lower Brackets position when the gearcase size D of the angle grinder is larger than 47mm.

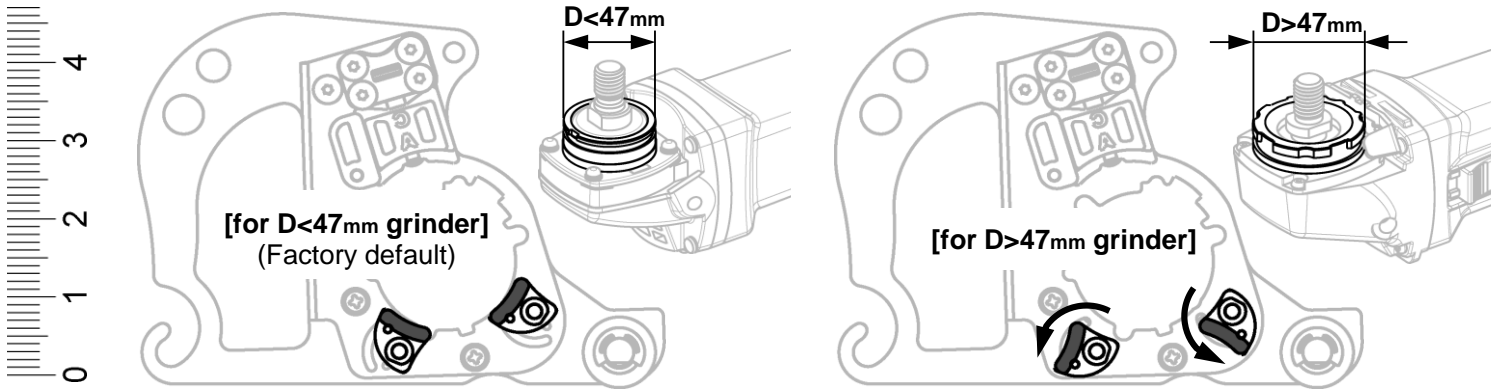

5. Place [b] Adapting Unit on gearcase of the grinder.

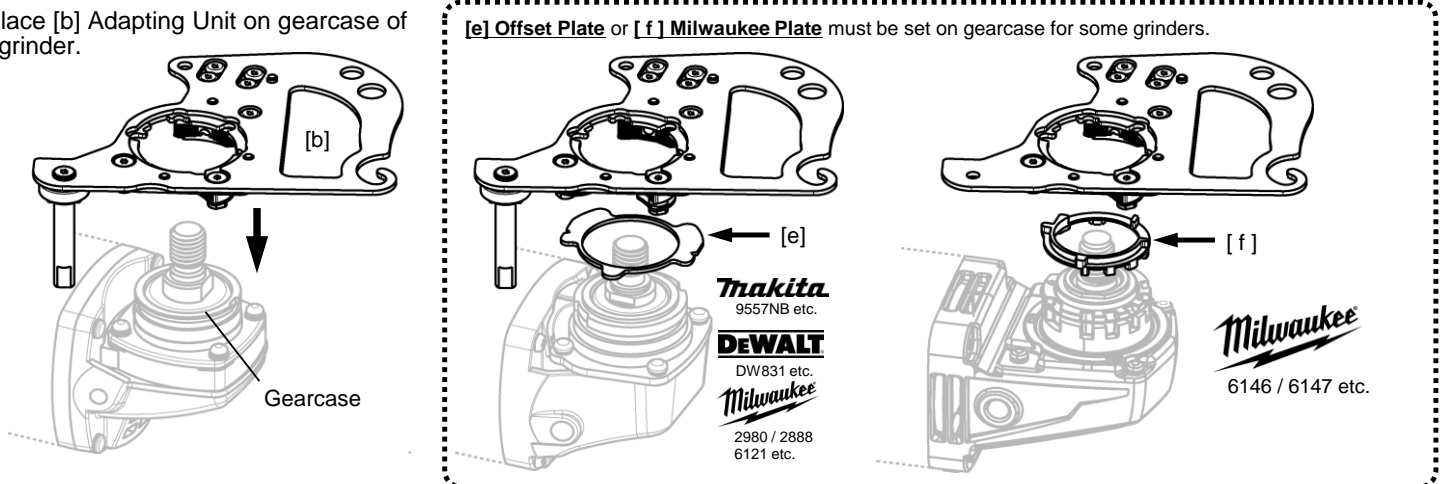

6. Hold [b] Adapting Unit and push its dent at bottom until it stops.

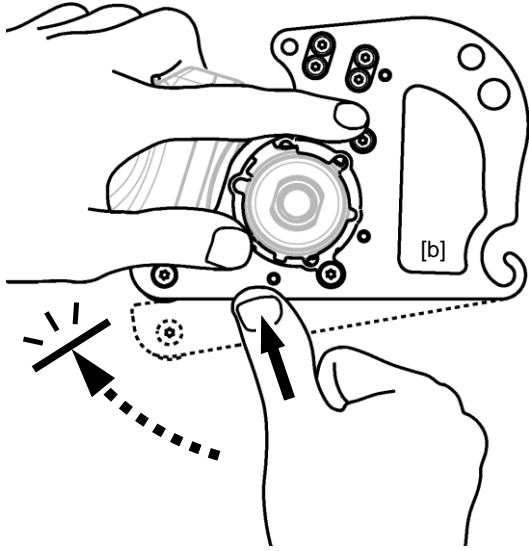

For some grinders, match the shape of grinder's gearcase with the center hole of [b] Adapting Unit then hold it from the top.

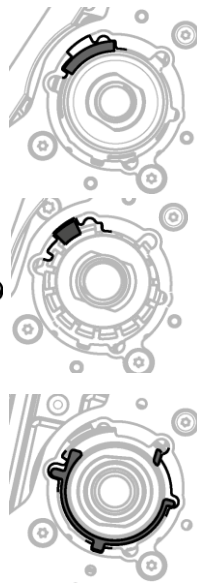
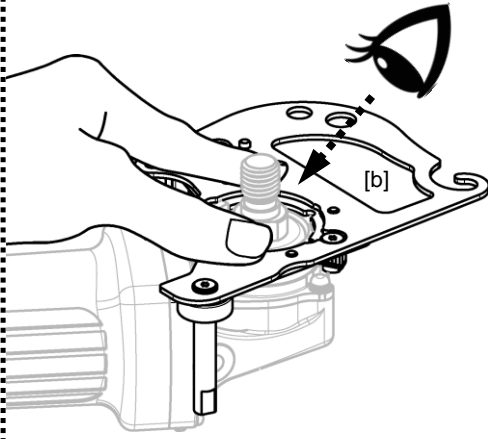

Makita

XAG011
9564
GA4542 etc.

metabo

WPB18LTXBL115
WP850-125
WP1200-125 etc.

Milwaukee

6146 / 6147 etc.

7. Keep holding [b] Adapting Unit and tighten the Bolt with [d] Wrench securely.

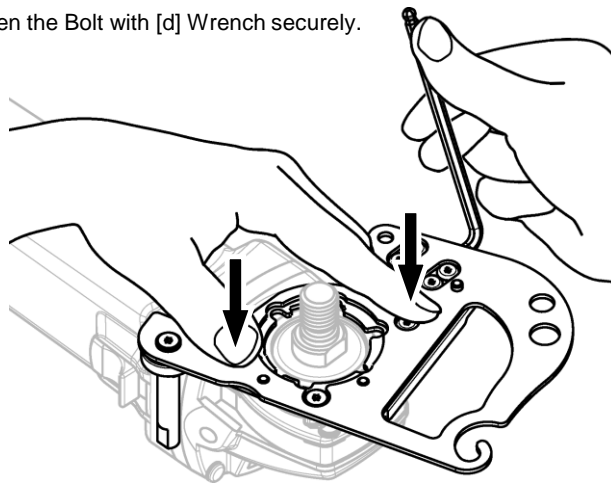
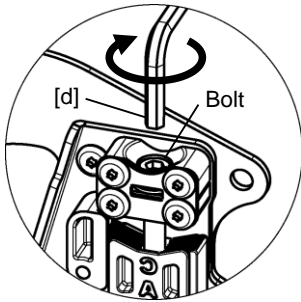

8. Set [h] / [i] Spacer, [g] Base Flange or Original Flange, and Blade into the Spindle then tighten the Lock Nut by Wrench.

9. Hang the Shaft of [a] Main Unit into the Hook of [b] Adapting Unit.

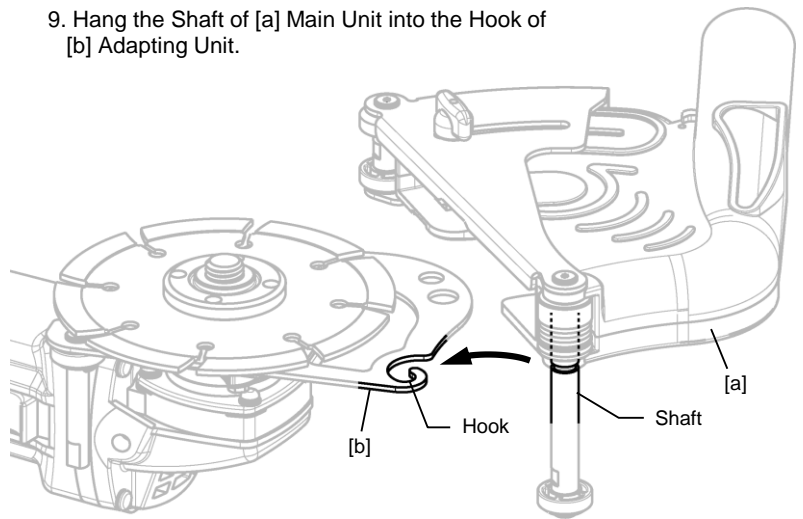
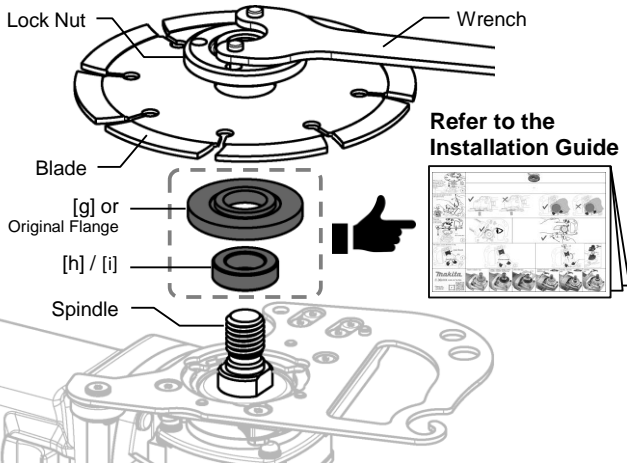

10. Rotate [a] Main Unit toward [b] Adapting Unit with Shaft as axis.

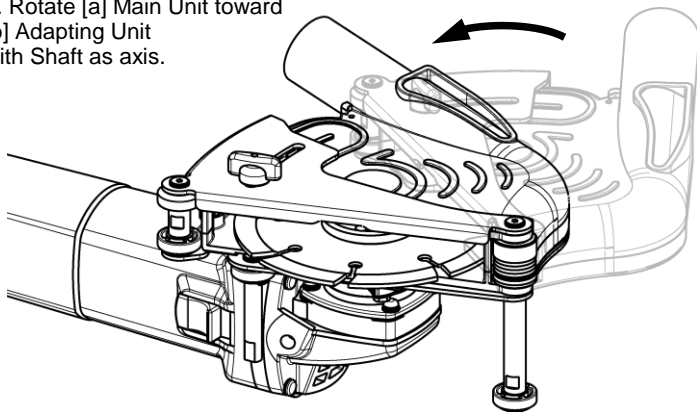

11. Tighten [c] Bolt with [d] Wrench. Make sure that the rear end of [b] Adapting Unit is securely hooked.

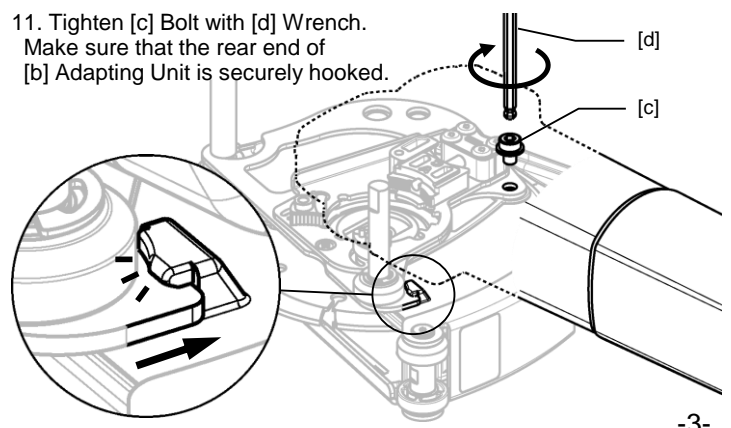

12. Hold [a] Main Unit and connect the Vacuum Hose into the Duct with [m] Joint.

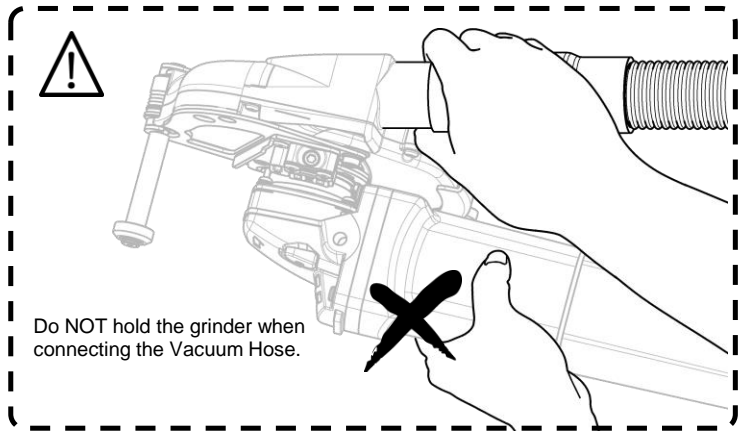
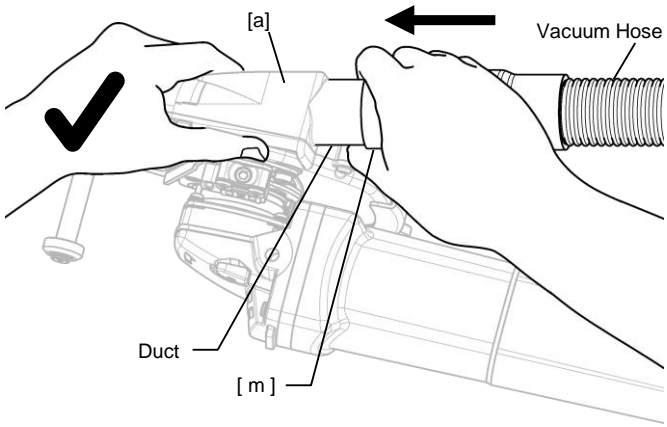

13. Adjust the position of Guide Ring at Front Roller with that of Blade.

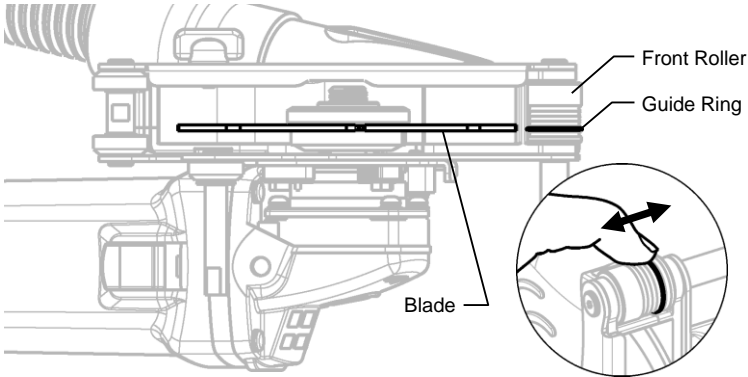

14. Attach the Handle into M8 / M10 port.

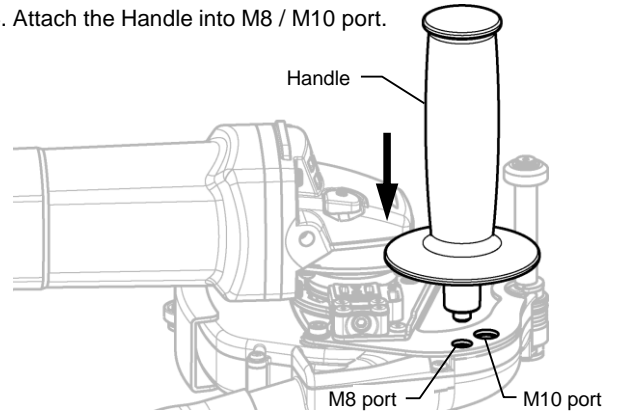

CUTTING

1. Release the Thumb Screw and adjust the position of Base to the required cut depth.
2. The Scale shows the approximate cut depth when the Base Line is aligned with the Guide Mark.

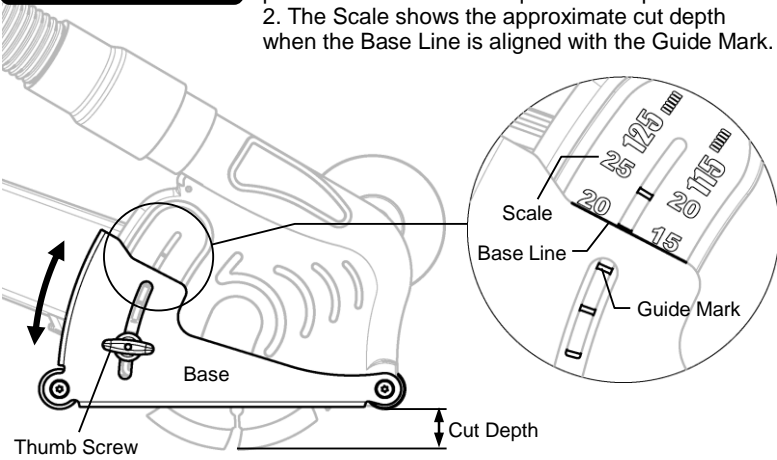

3. Securely hold the angle grinder and handle.
4. Turn on the switch of the vacuum and angle grinder.
5. Place the Front Roller on material, then slowly forward the angle grinder.

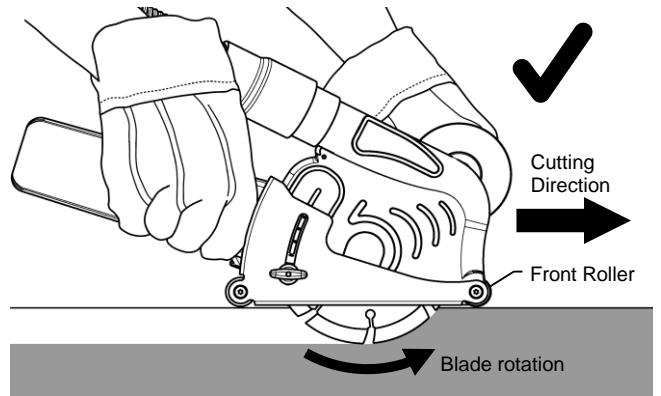

⚠ DO NOT lift or move backward the angle grinder as it leads to the scattering of the Dust.

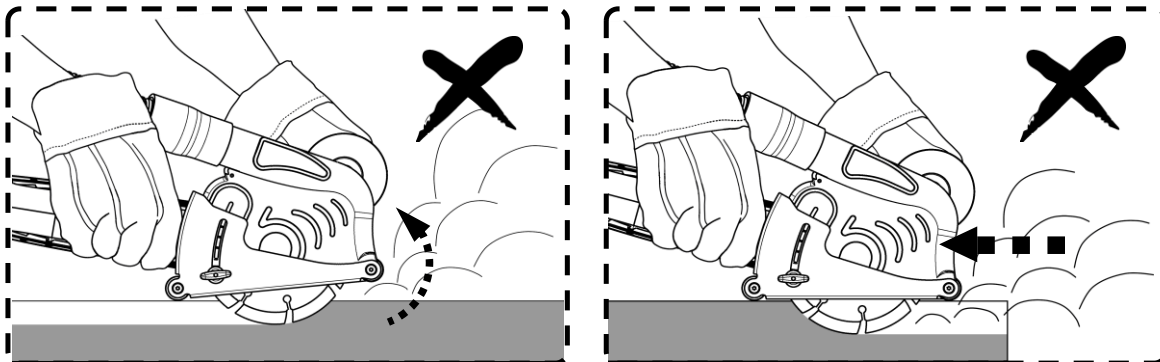

Head Office in Japan
NAKAYA CO.,LTD.
 1313-92 Yanagisawa, Sanjo, Niigata, Japan



18th-Apr 2023

Eto Naoya
 Managing Director