

# NK-125MA

장착 조건표를

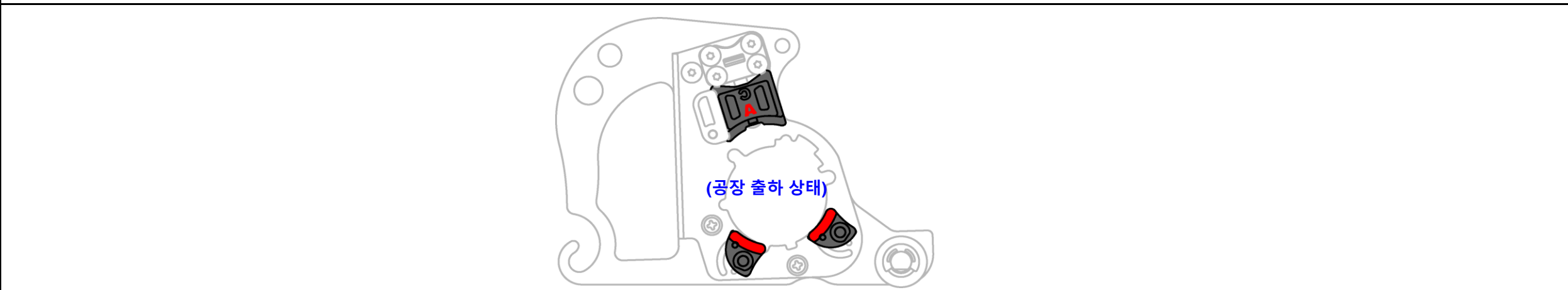

 **NAKAYA**  
JAPAN ORIGINAL TOOLS

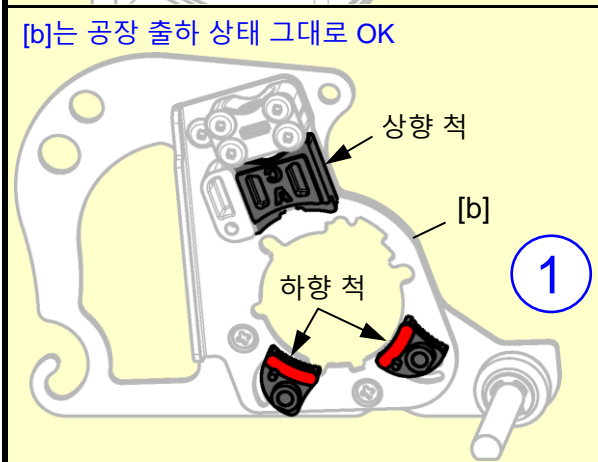
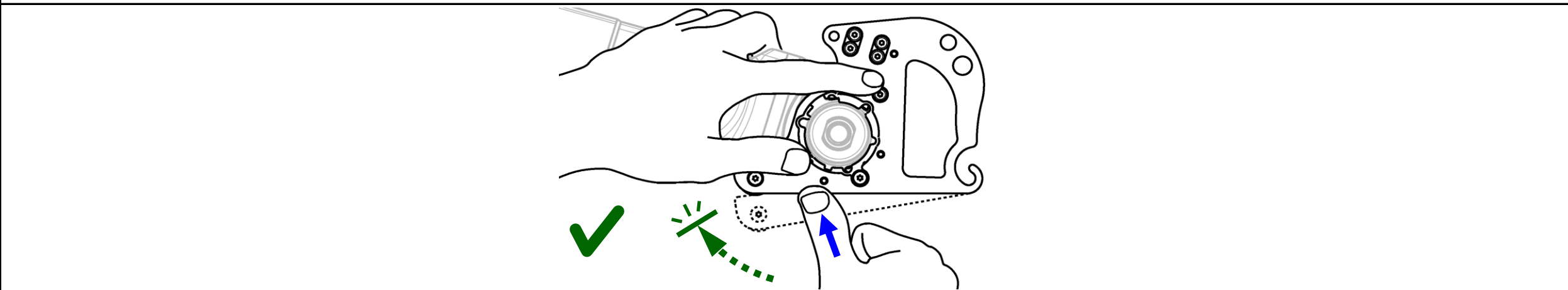
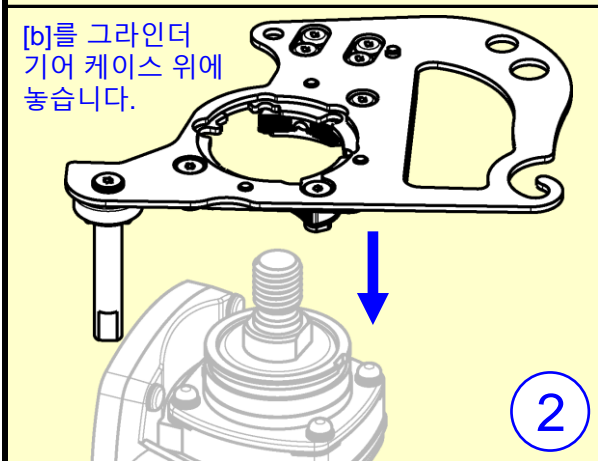
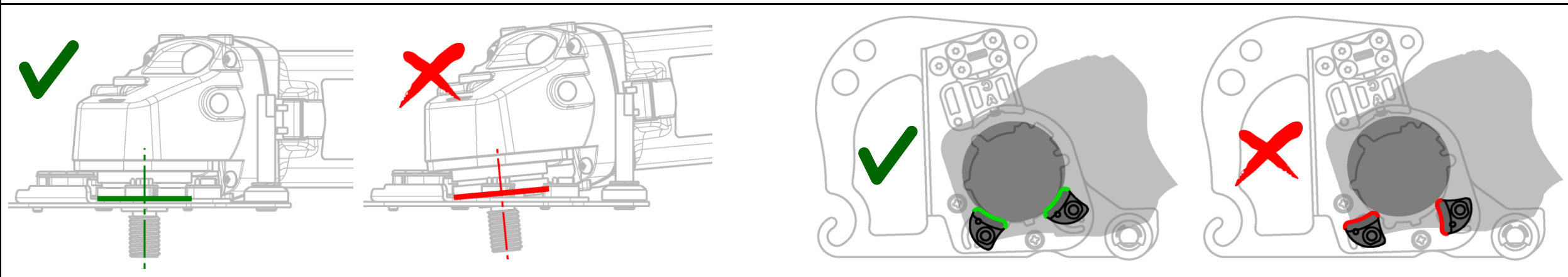
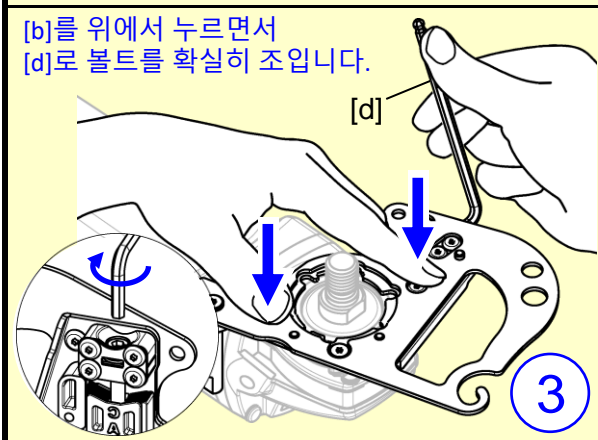
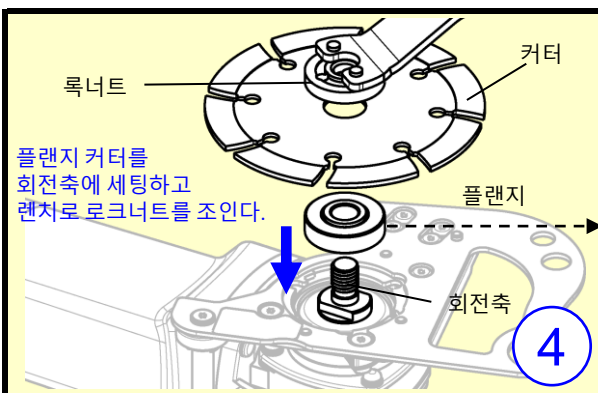

※ 2022년 11월 현재의 웹 정보에 근거한다.

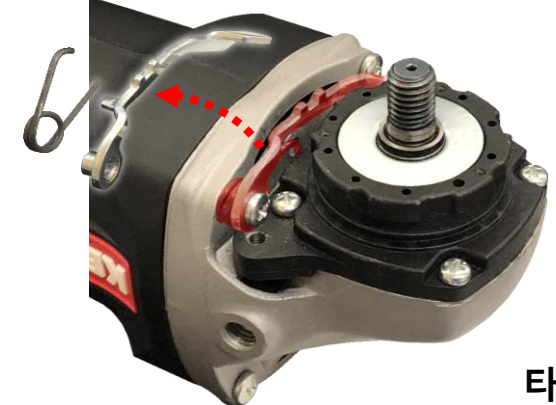

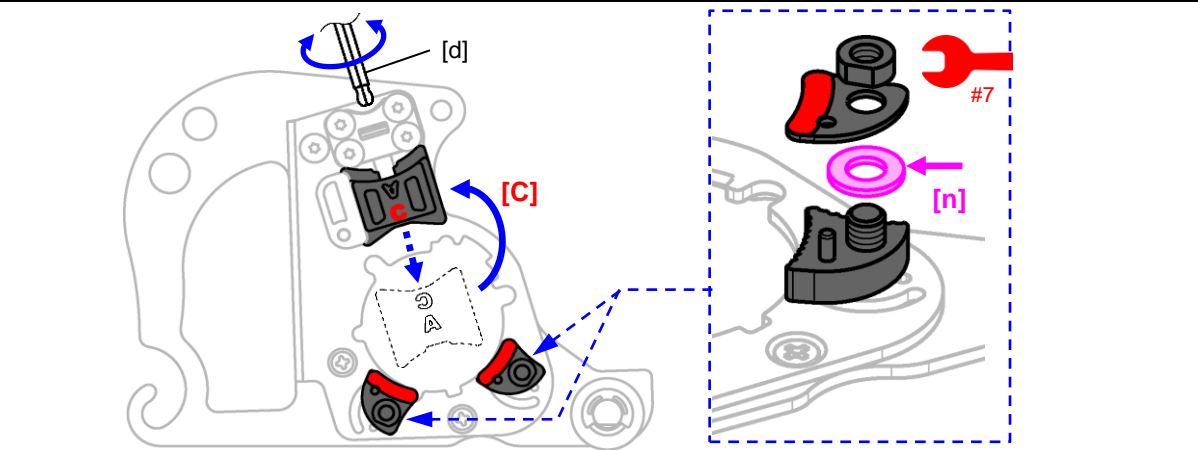
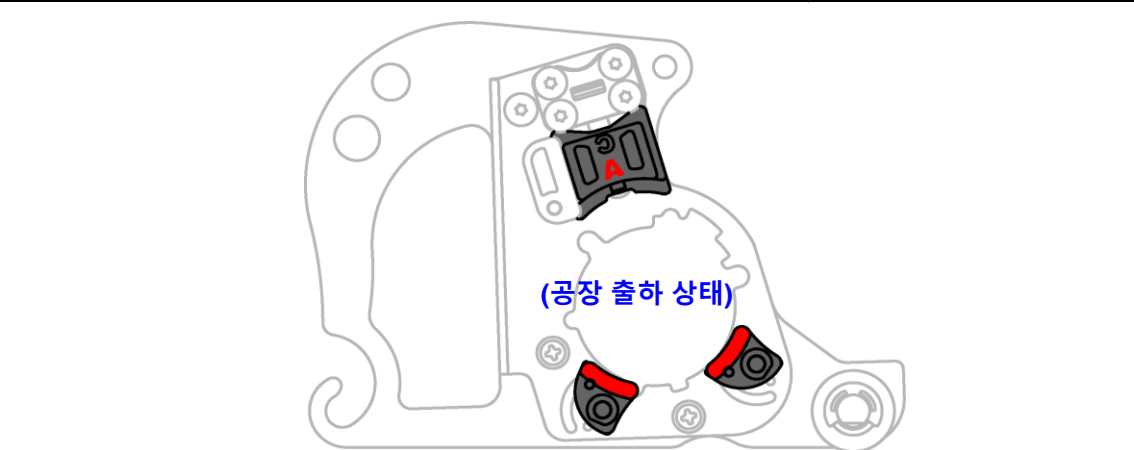
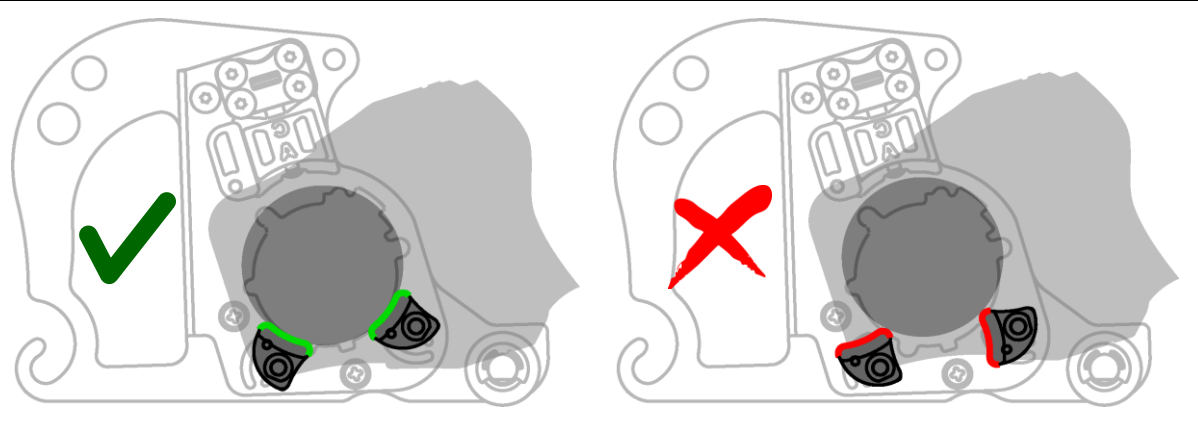
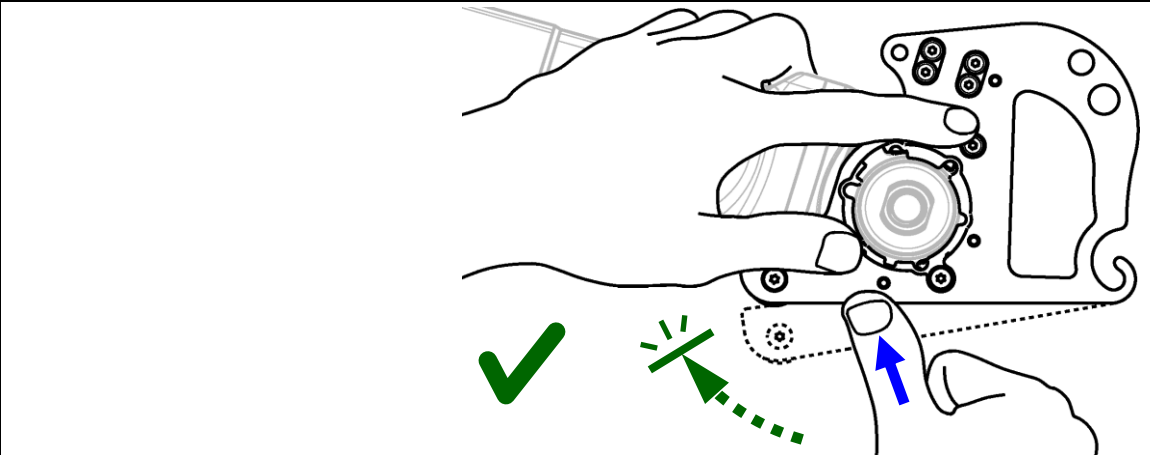
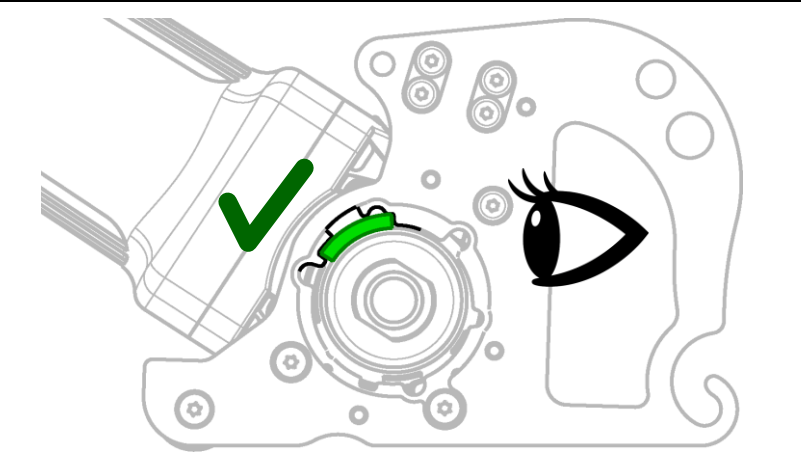
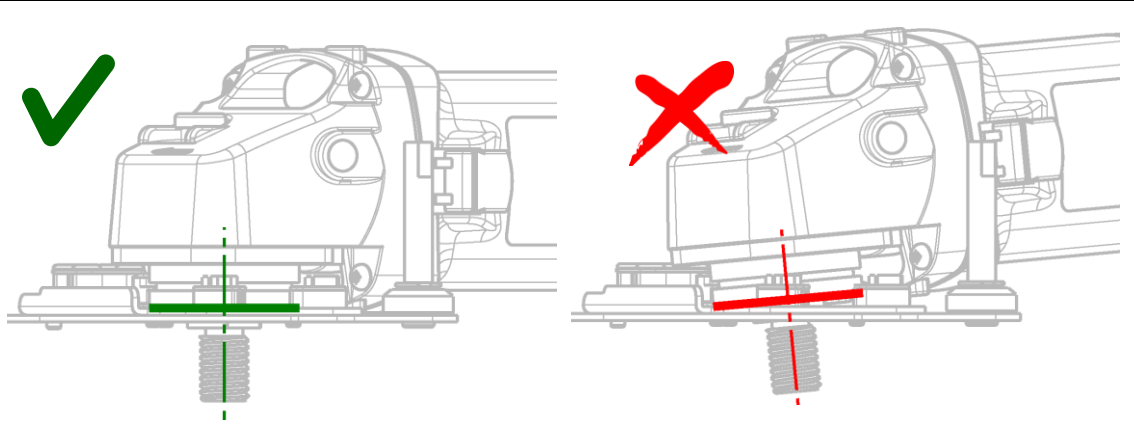
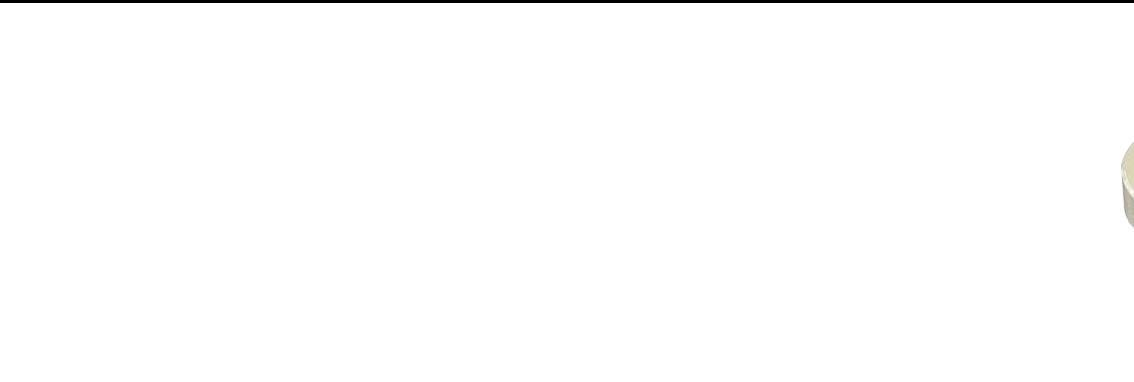
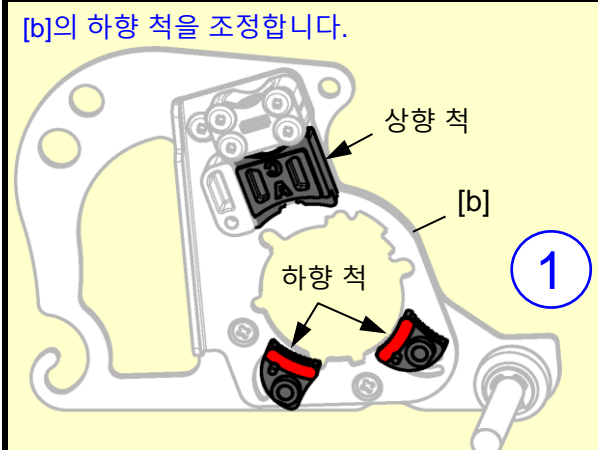
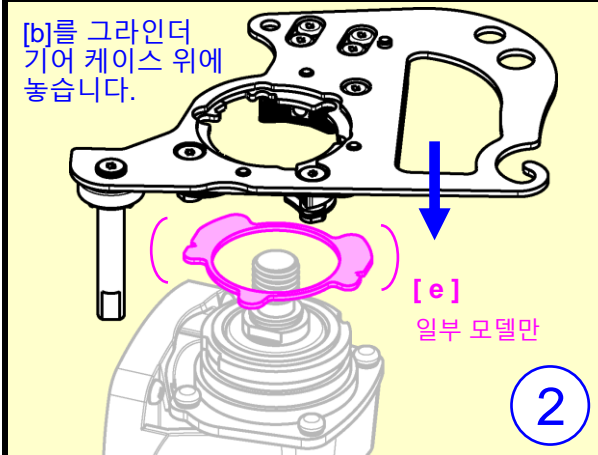
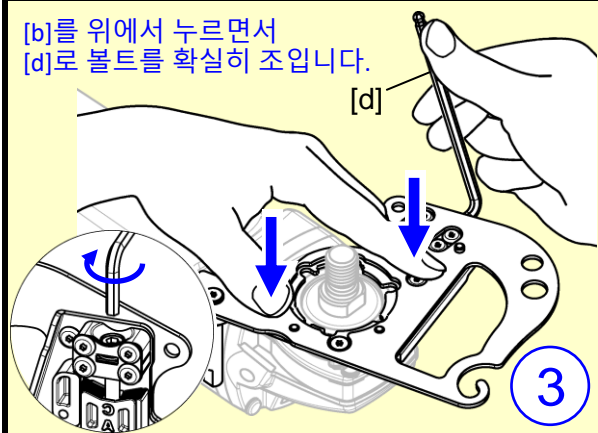
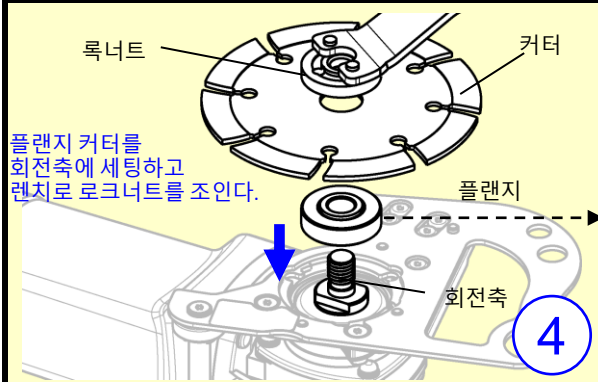

**Makita**

⚠️ XLOCK 모델은 장착할 수 없습니다.

※ 2022년 11월 현재의 웹 정보에 근거한다.

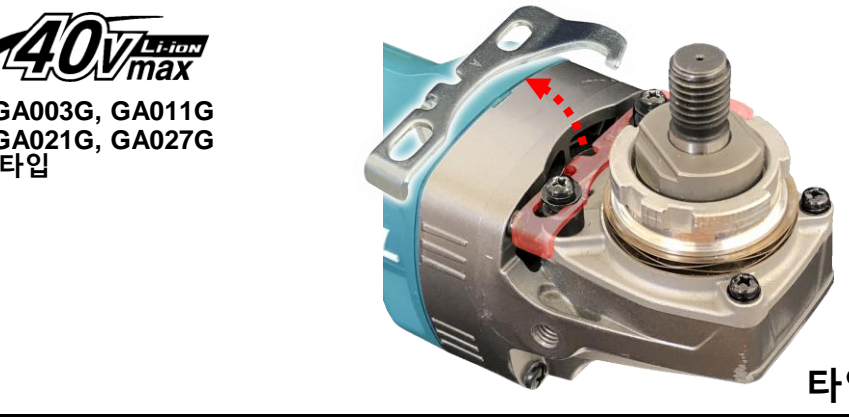
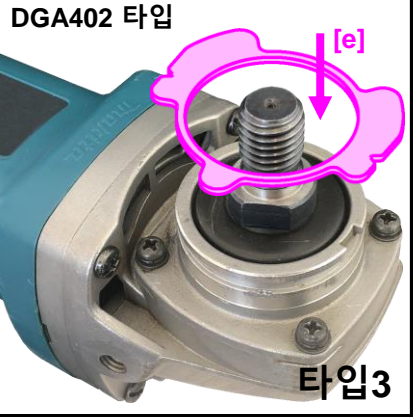

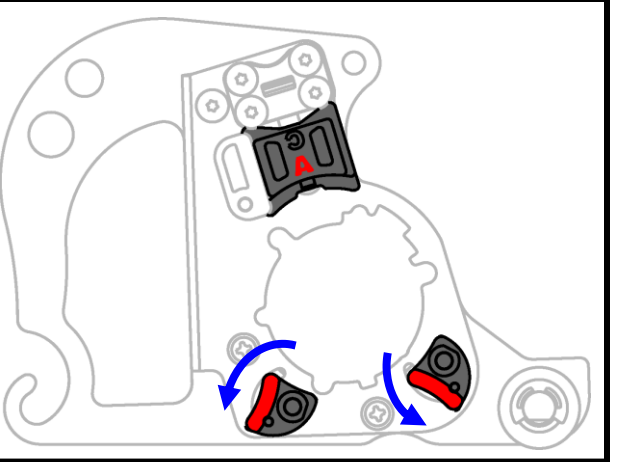
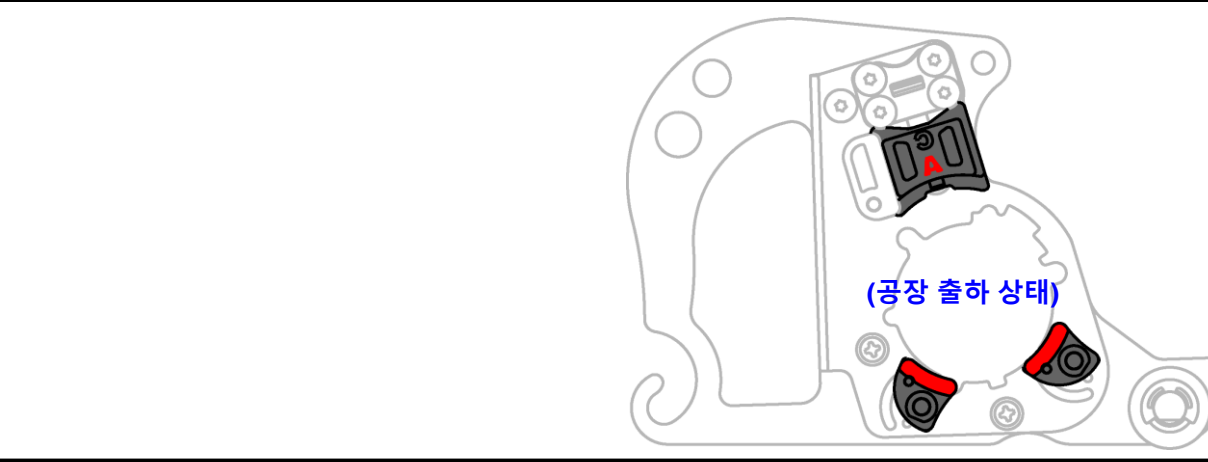
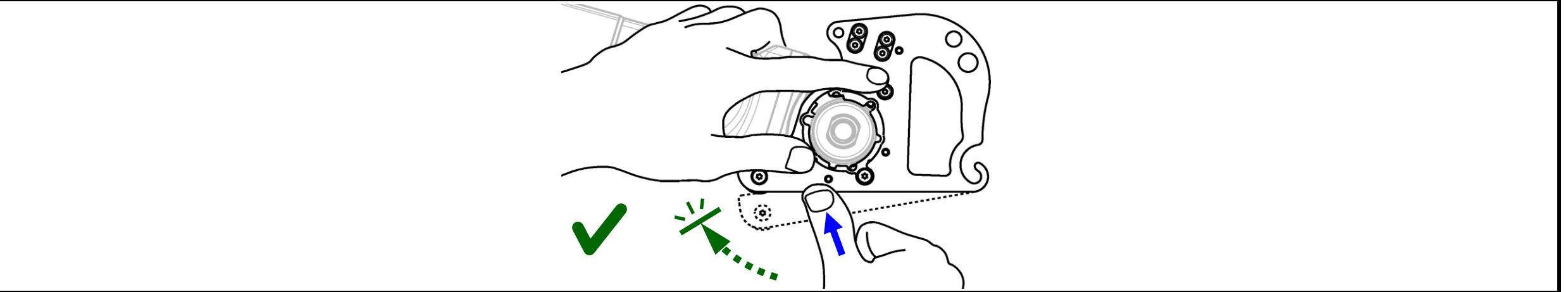
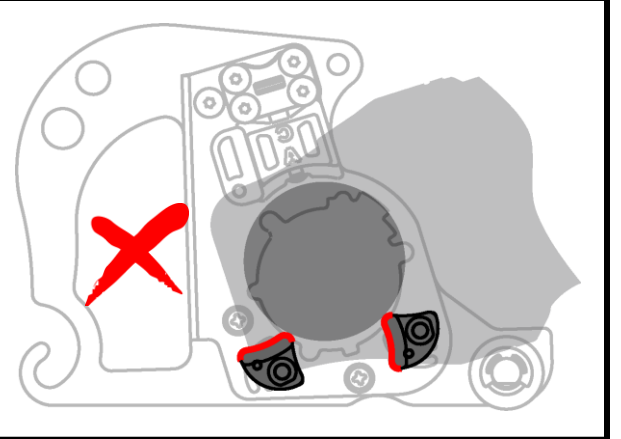
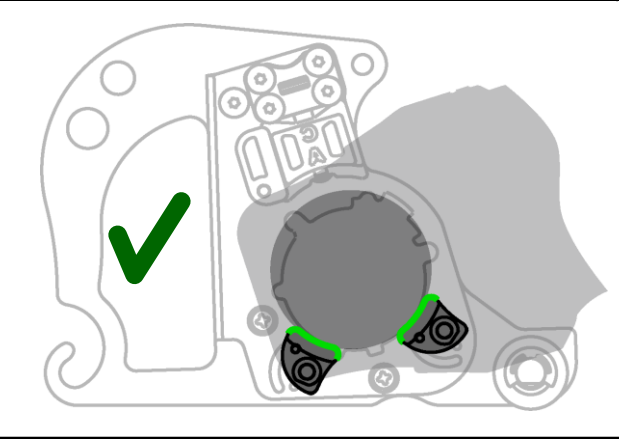
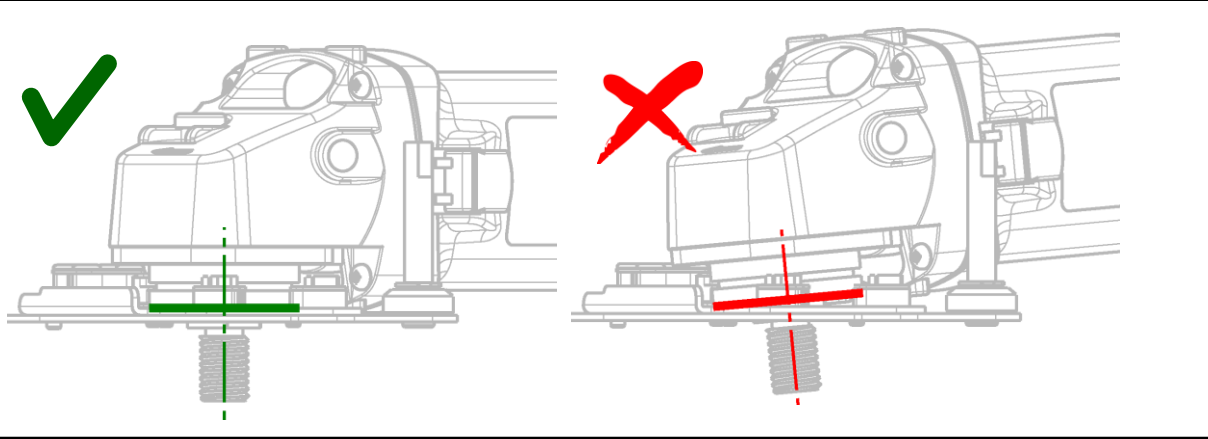
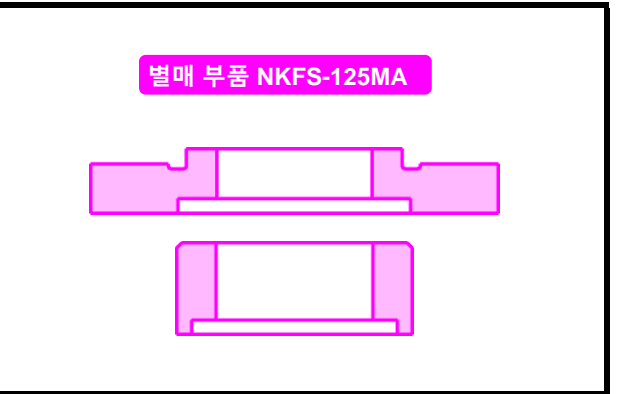
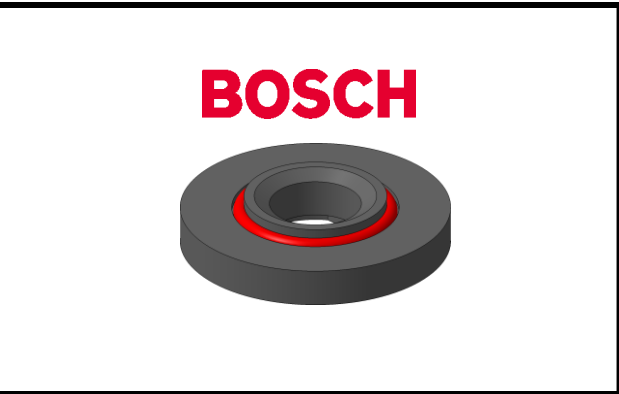
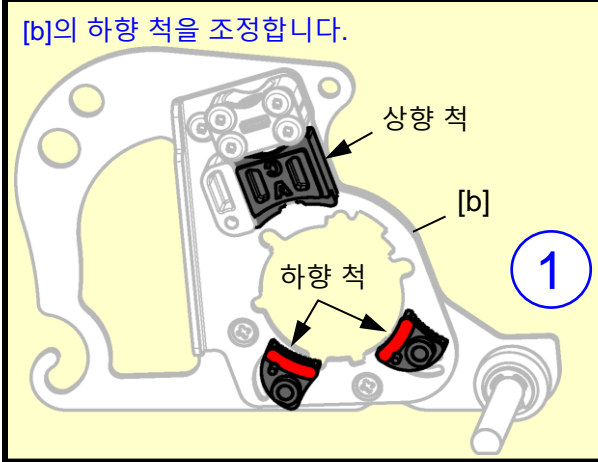
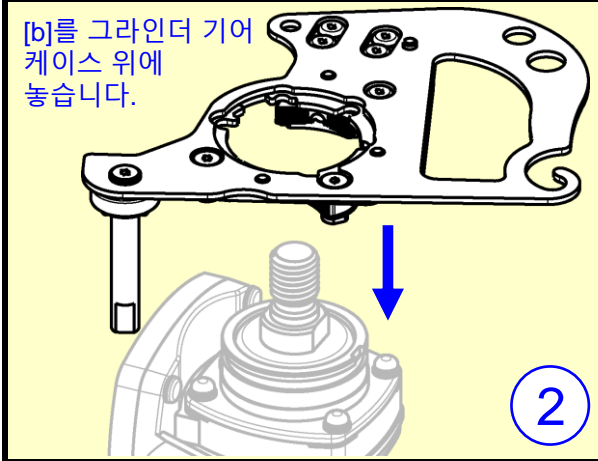
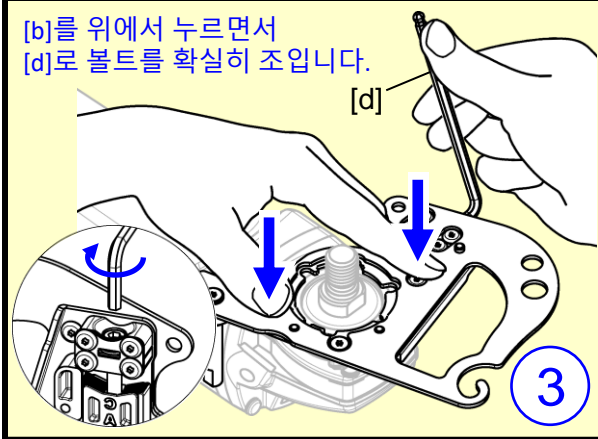
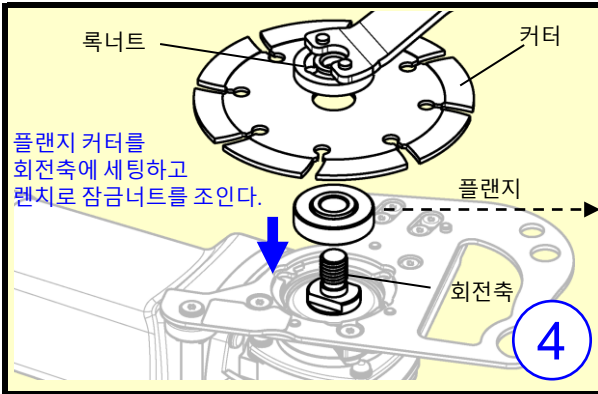

**BOSCH**

**XLOCK** 이모델은 장착이 불가능합니다.

※ 2022년 11월 현재의 웹 정보에 근거한다.

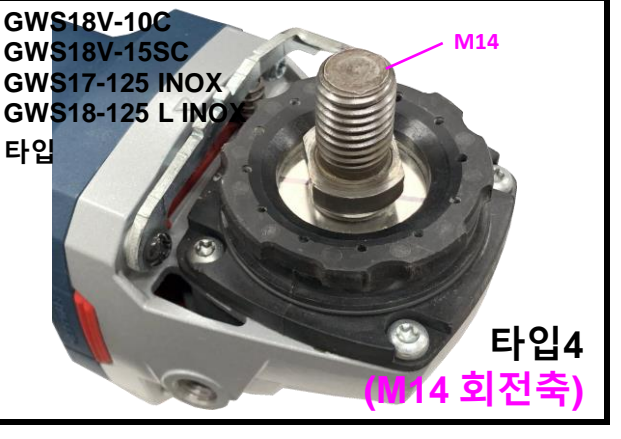
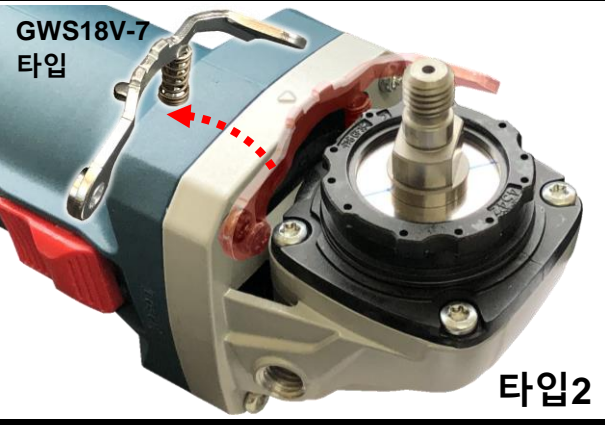
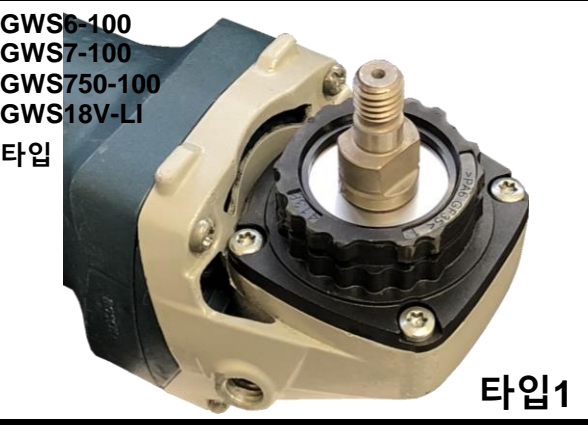

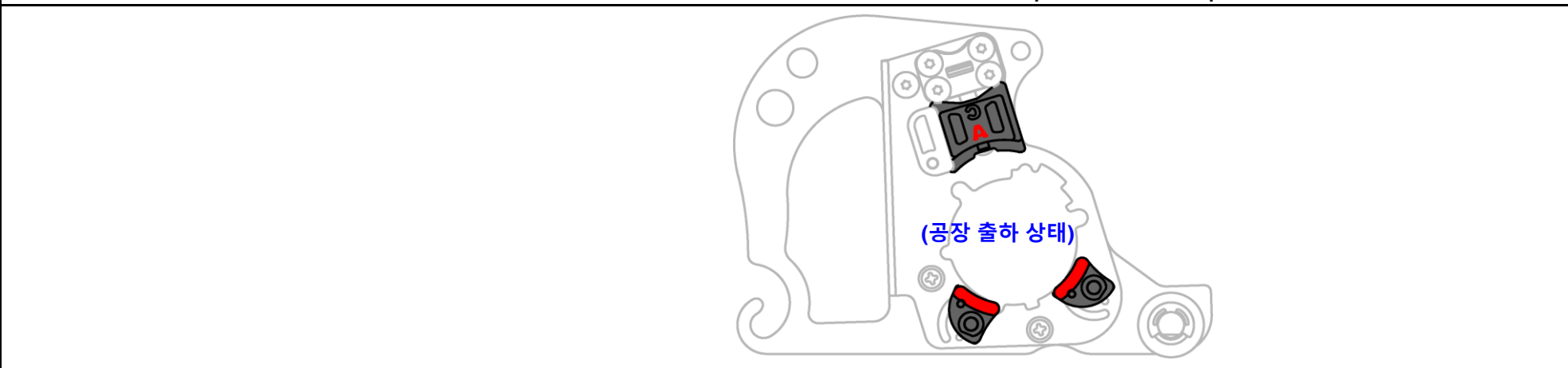
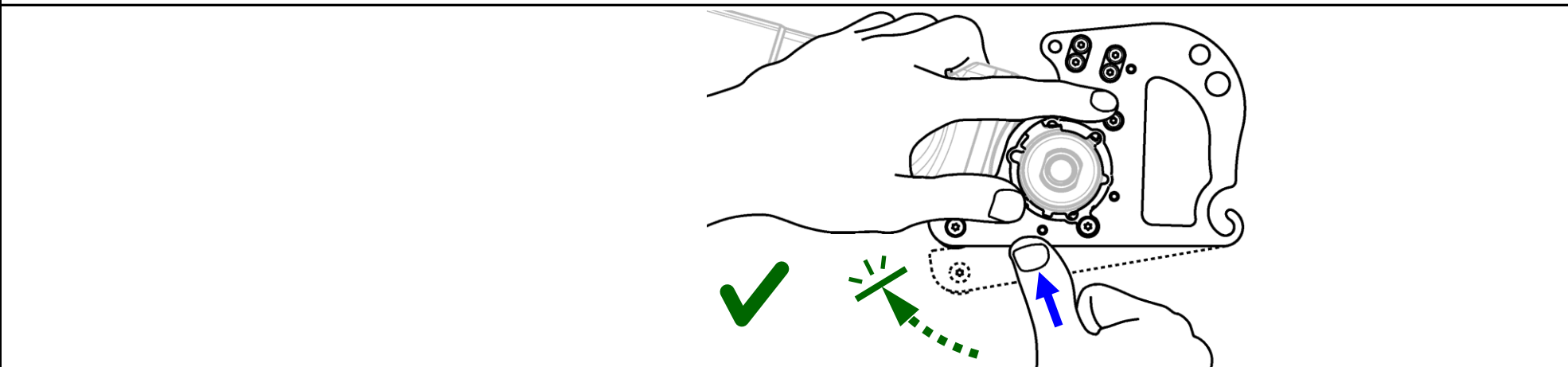
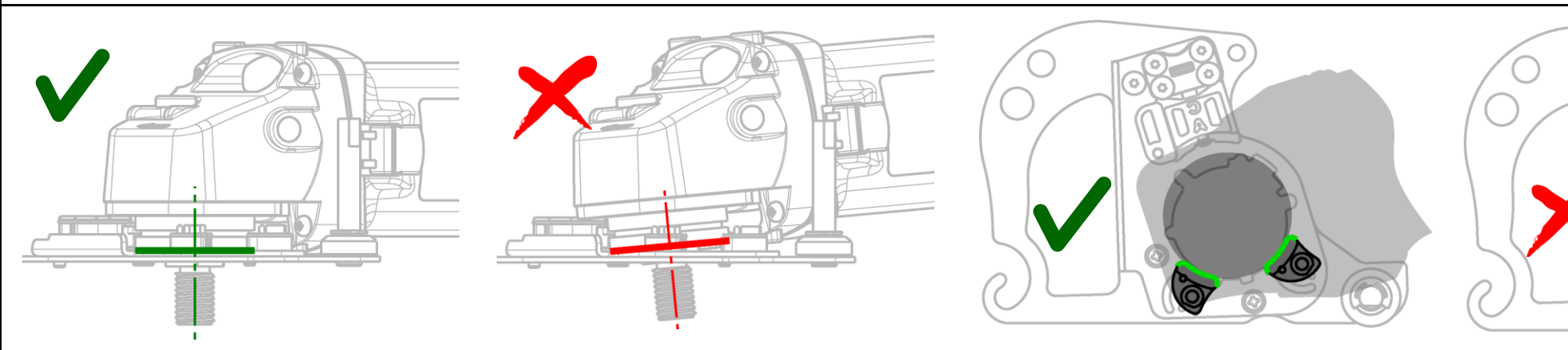
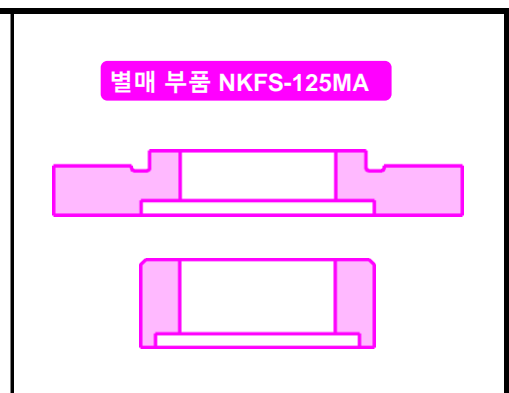
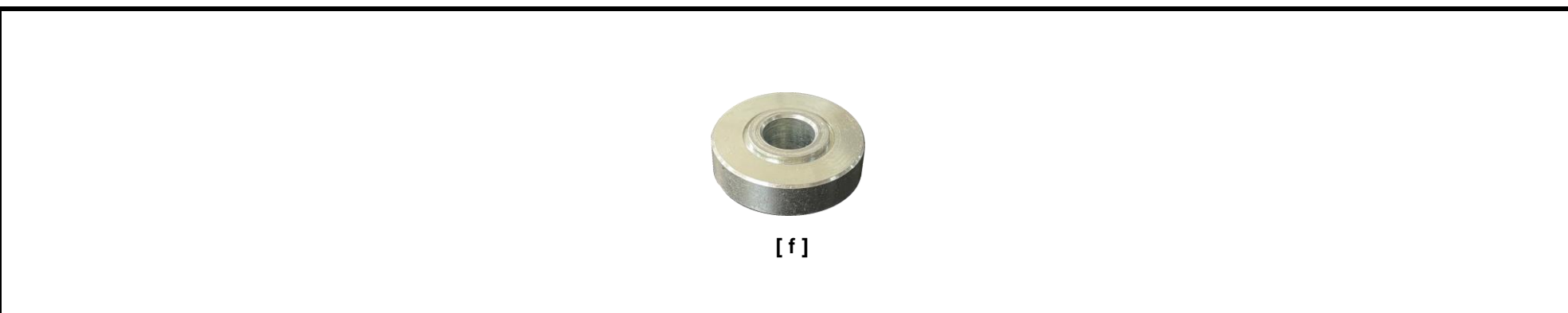
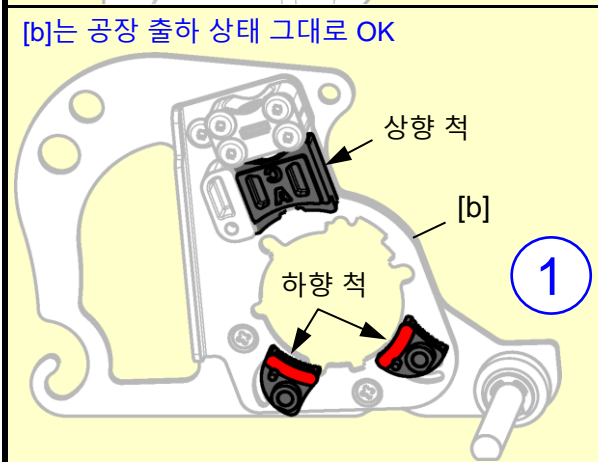
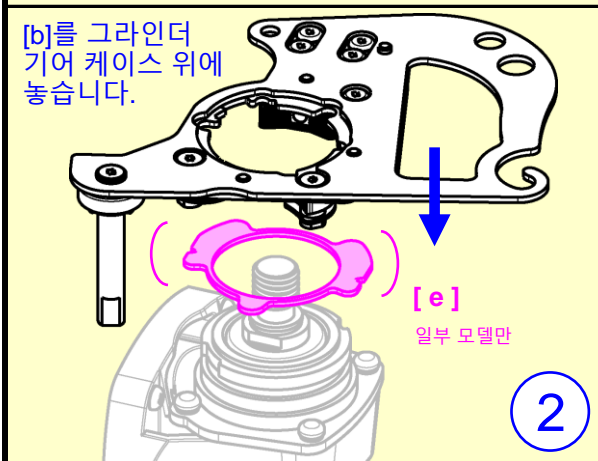
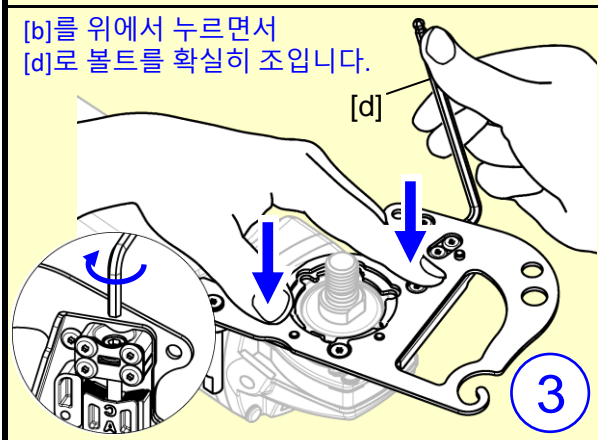
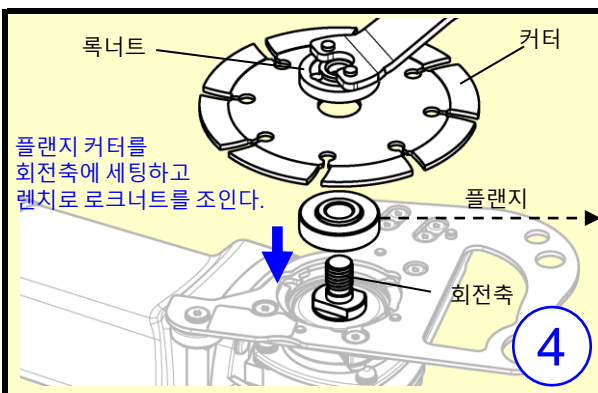

※ 2022년 11월 현재의 웹 정보에 근거한다.

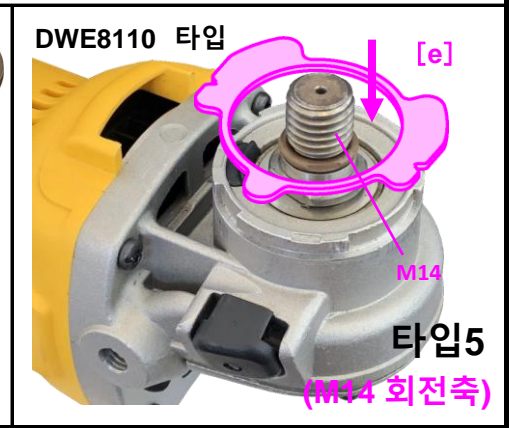
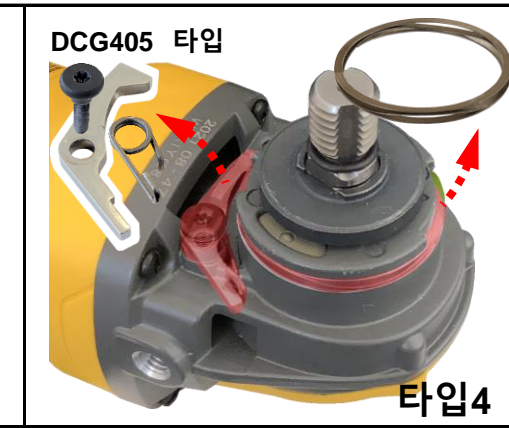
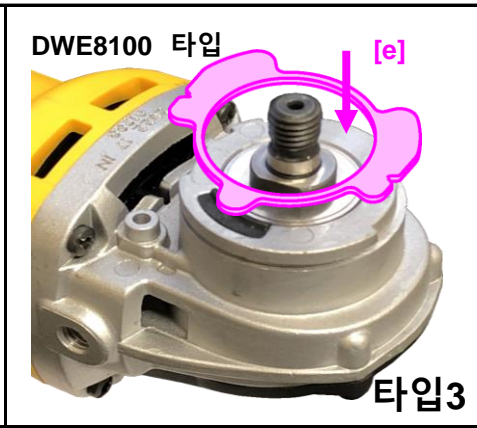
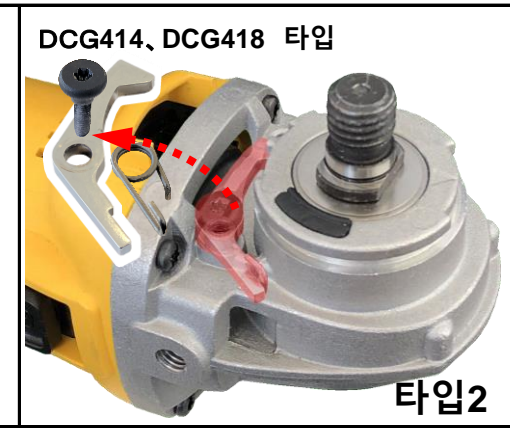

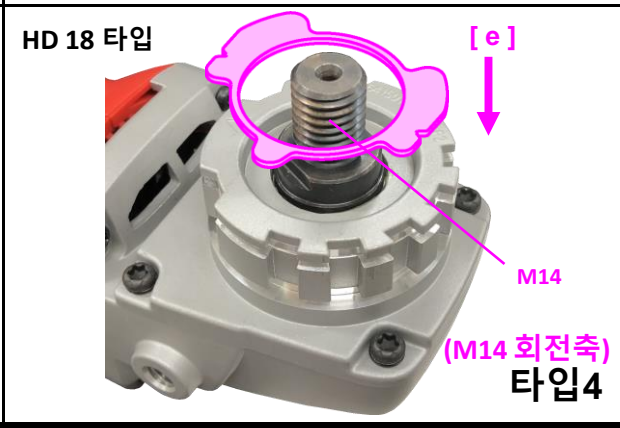
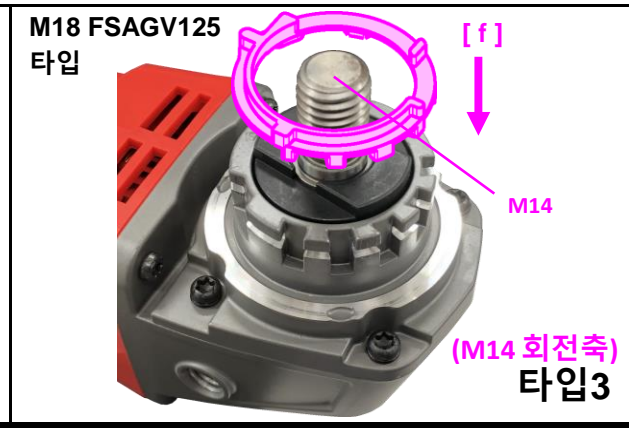
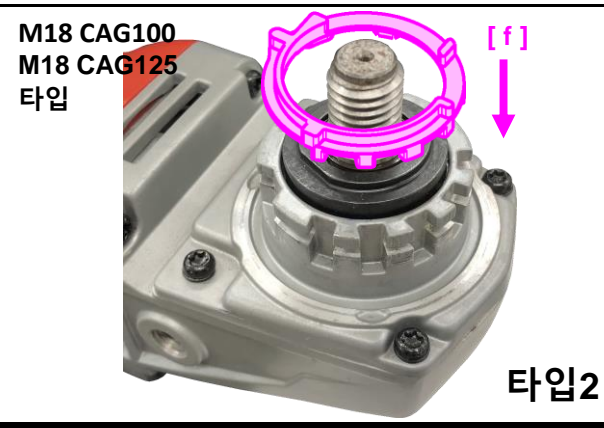
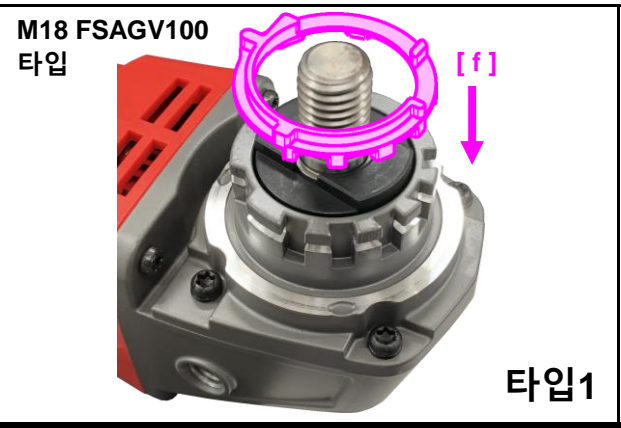
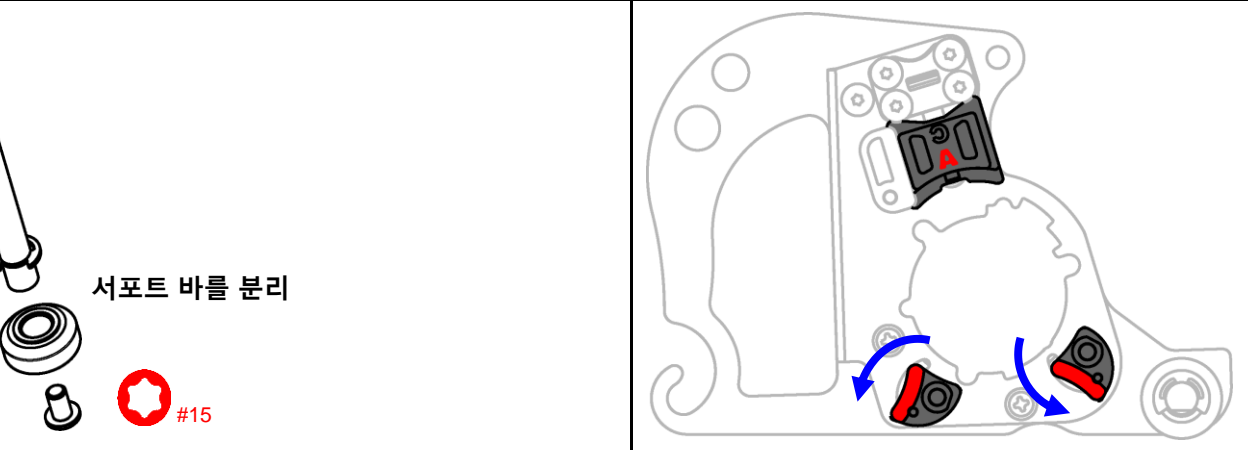
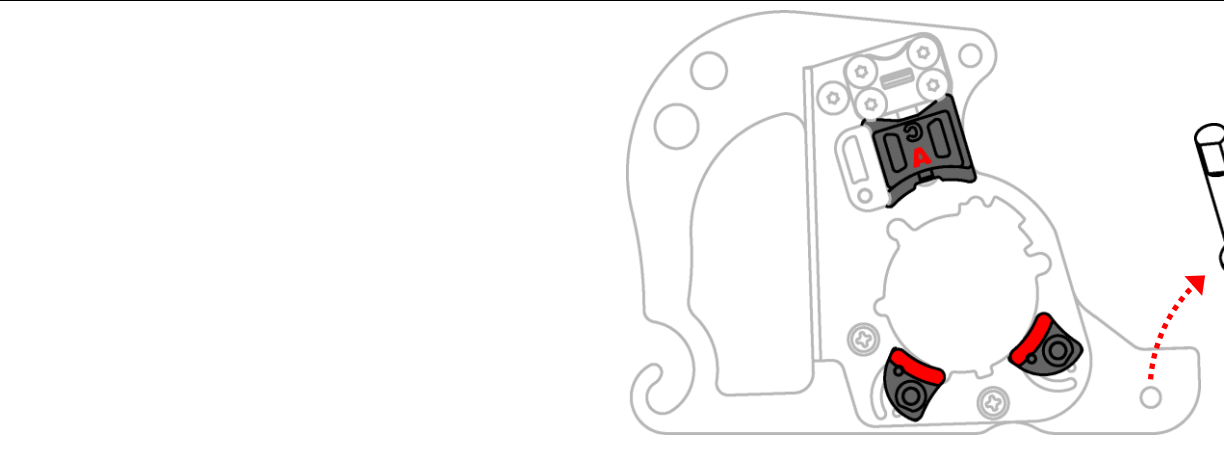
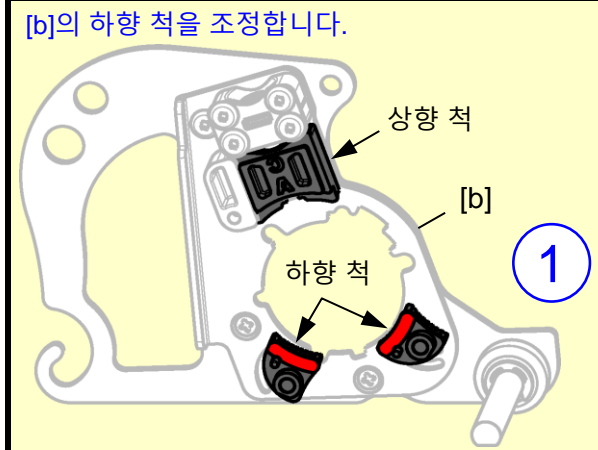
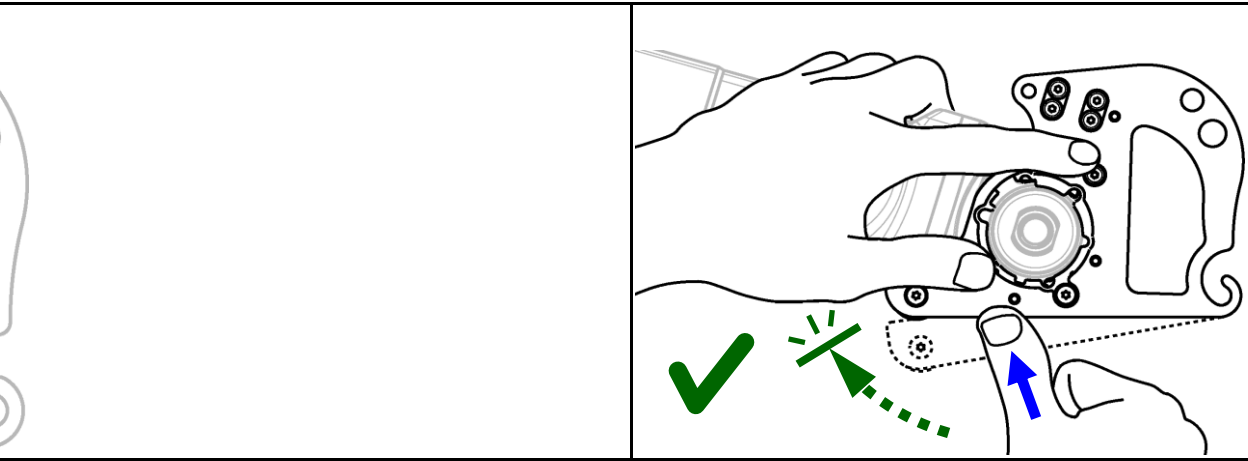
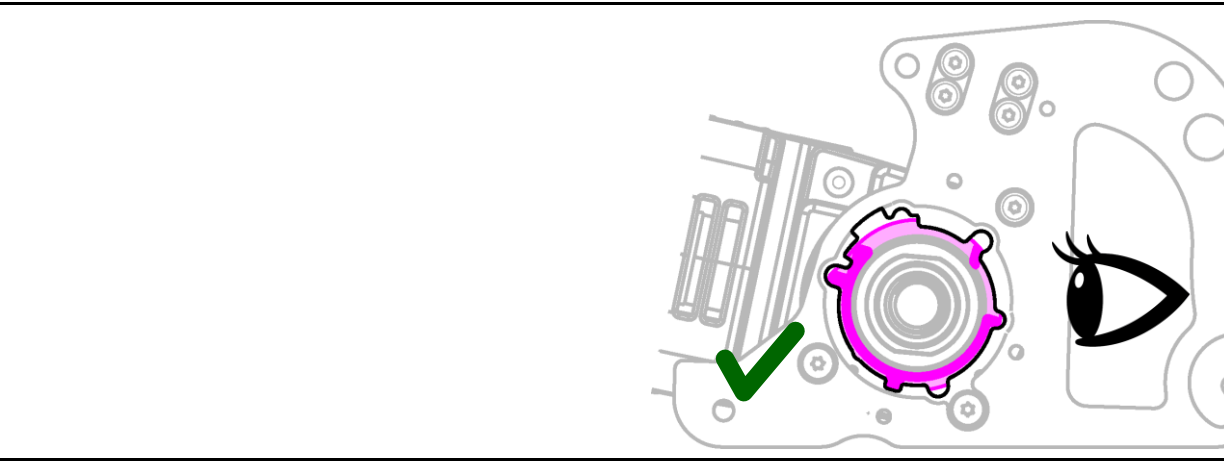
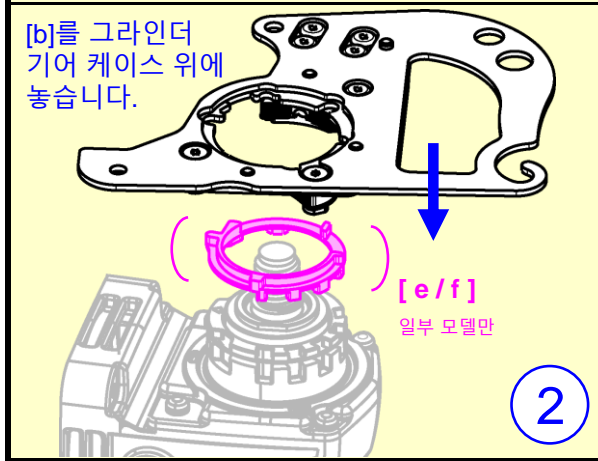
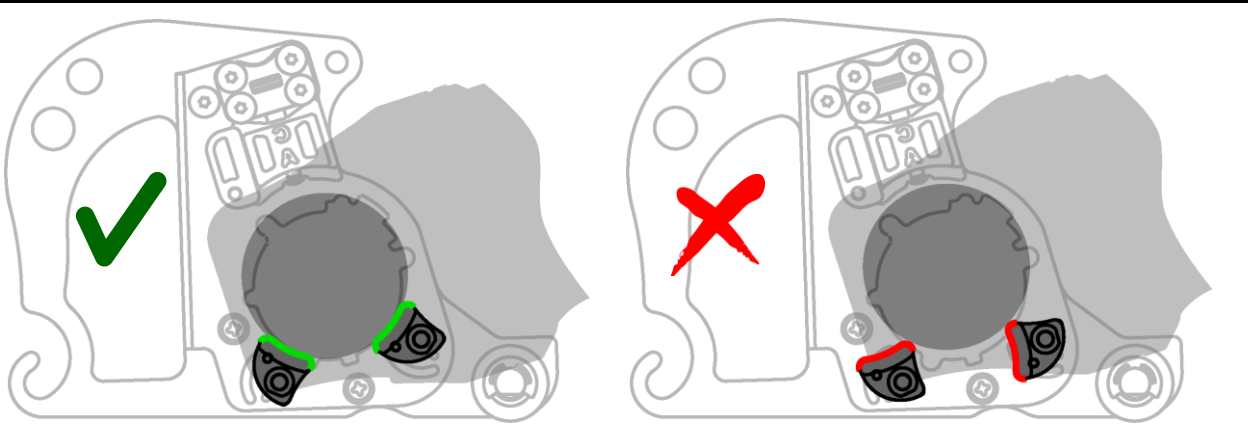
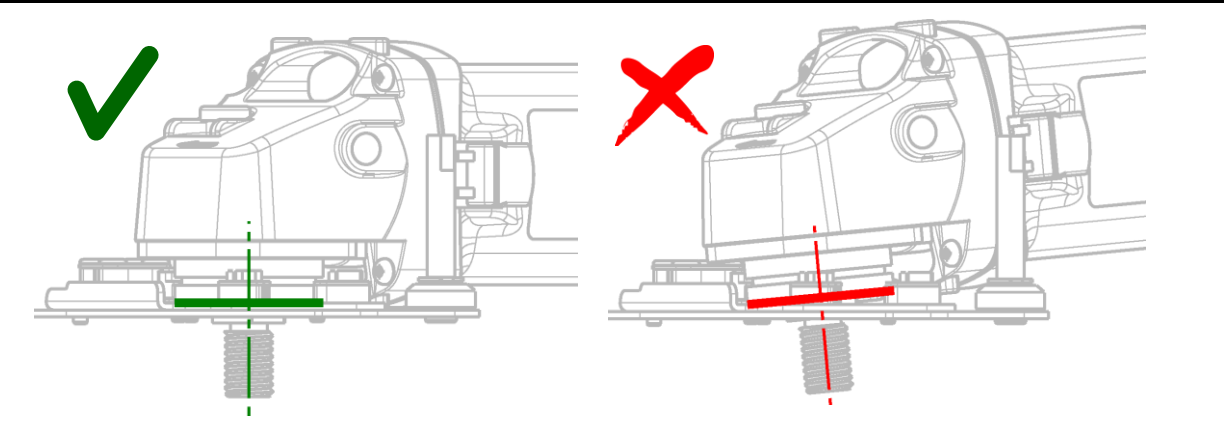
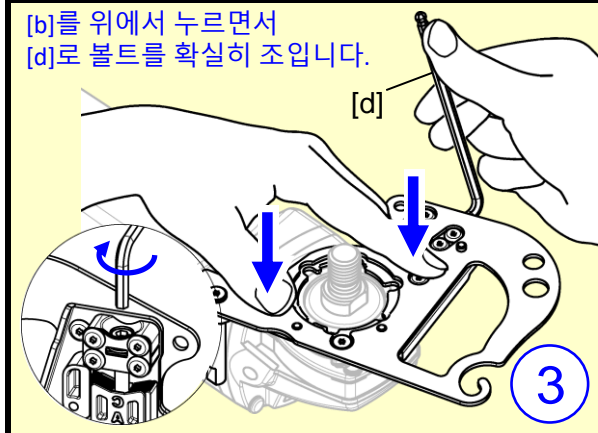
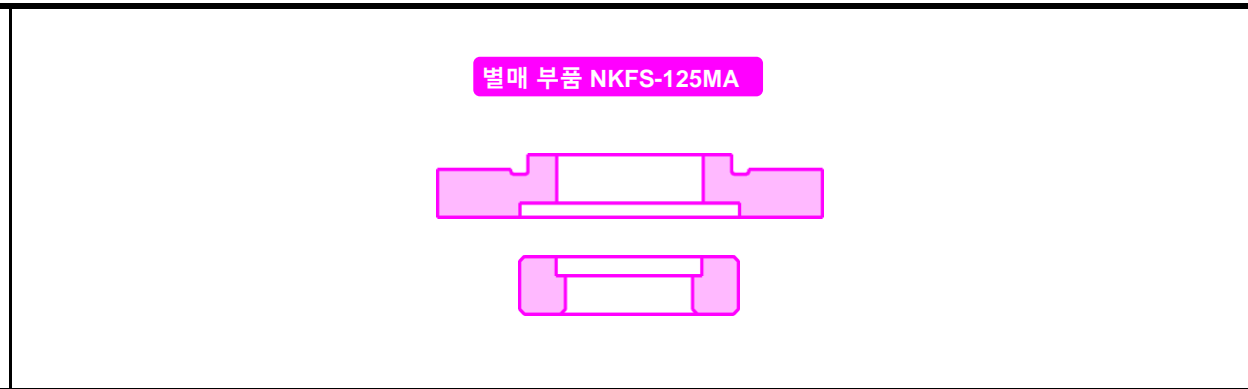
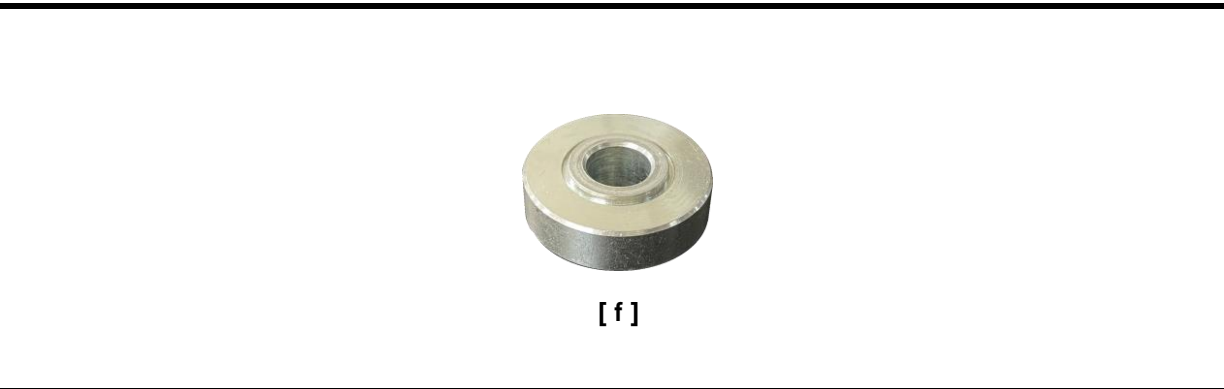
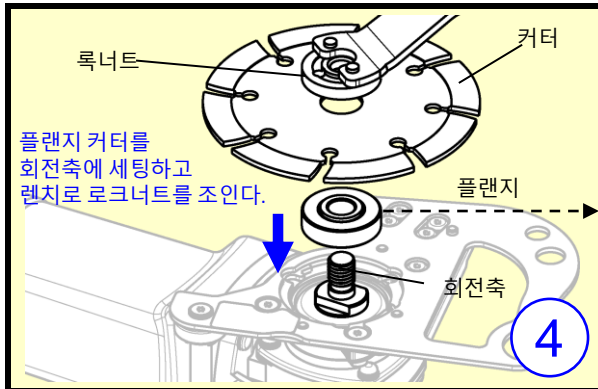

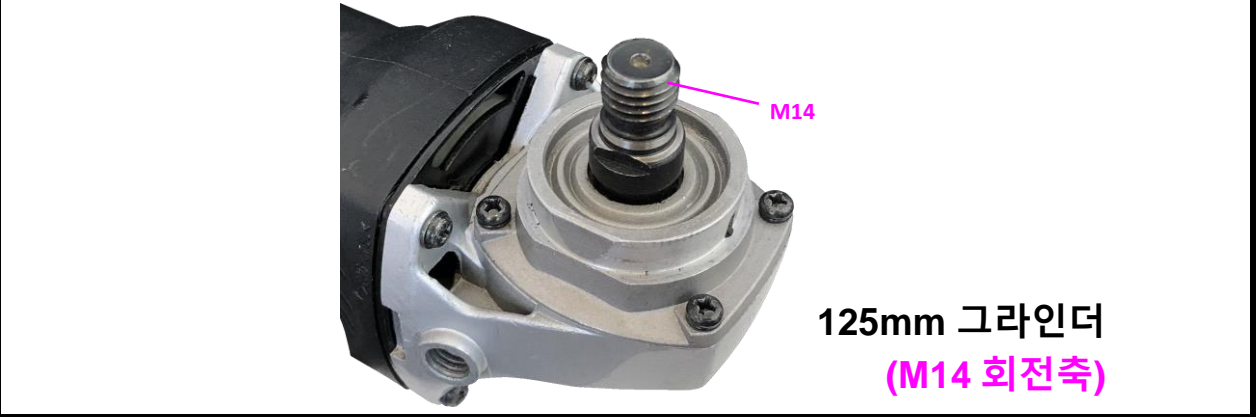
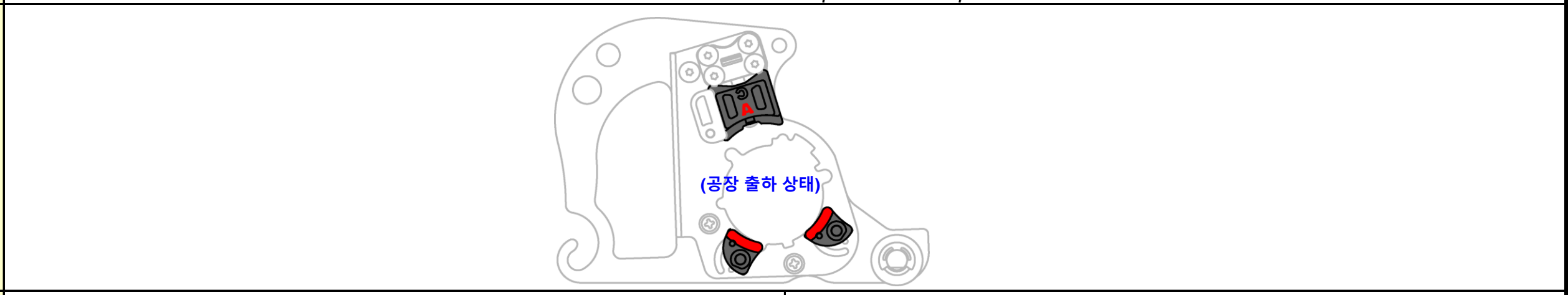
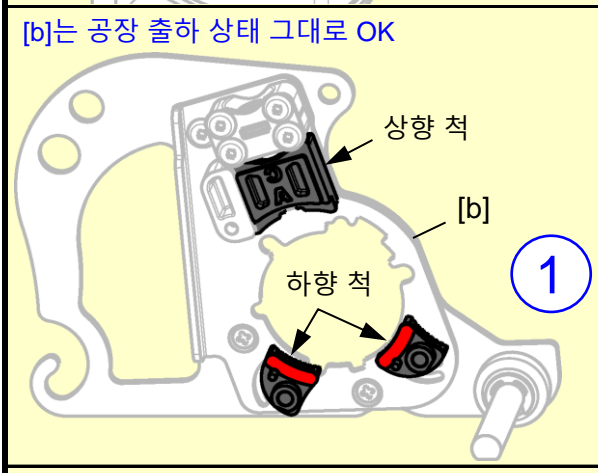
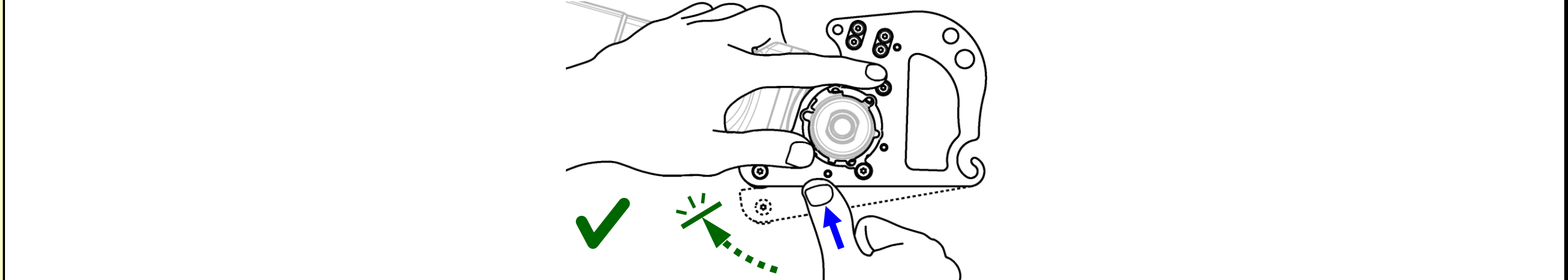
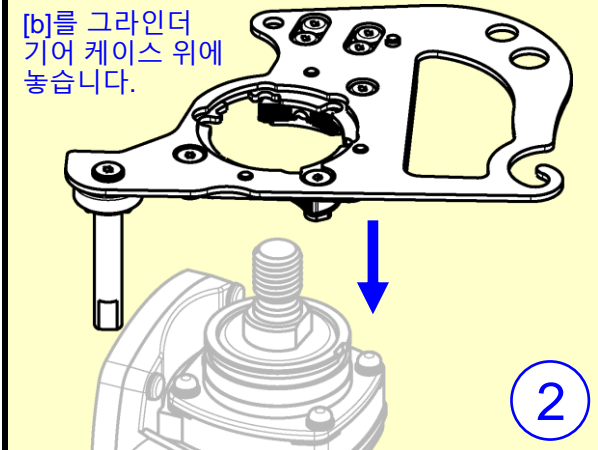
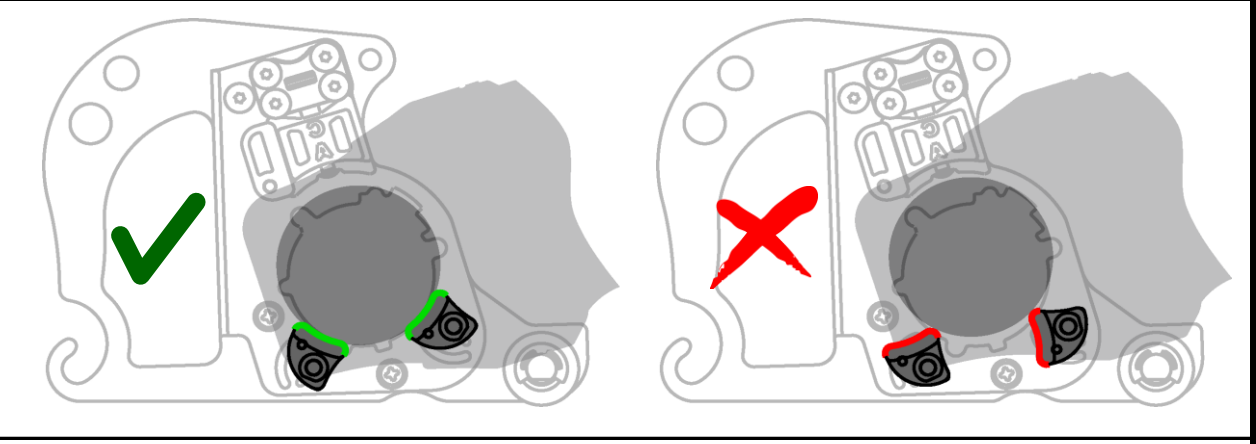
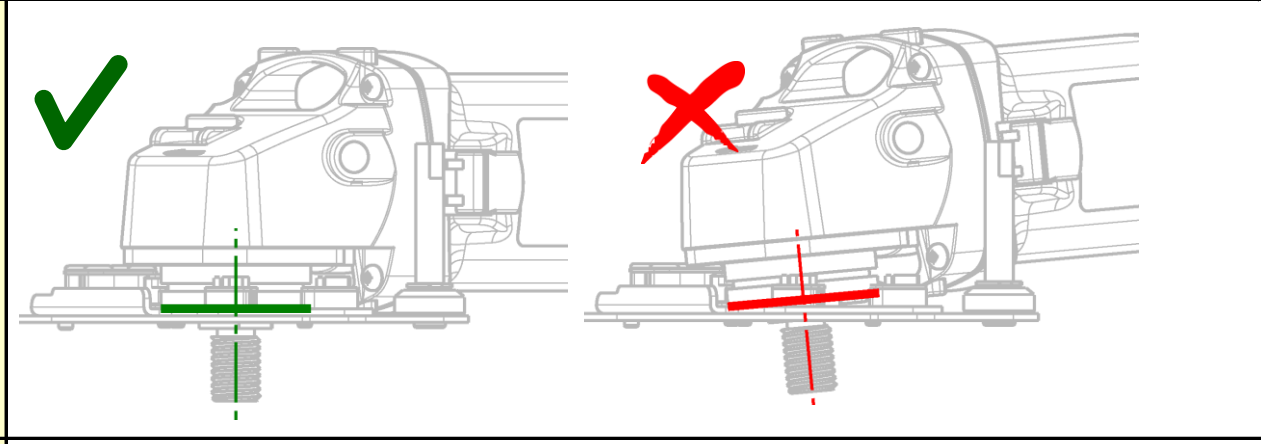
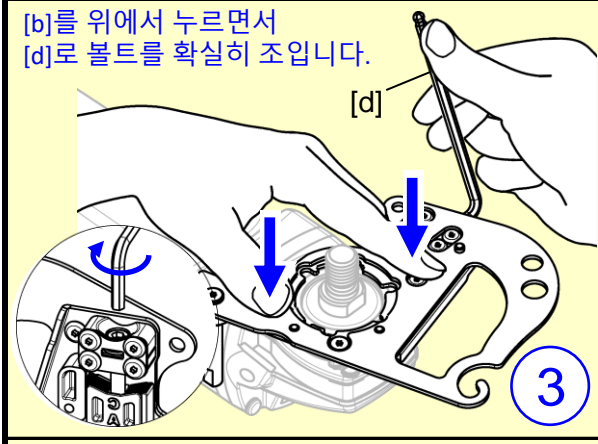
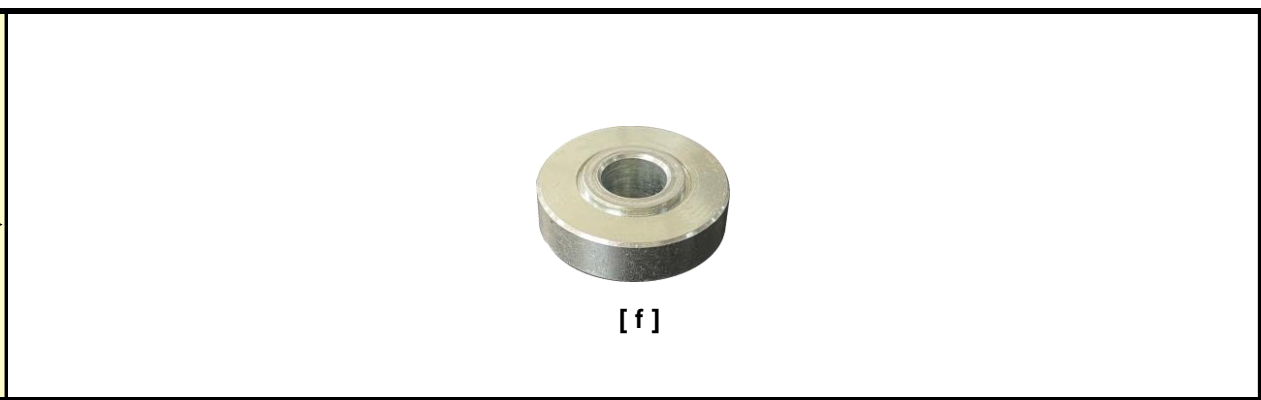
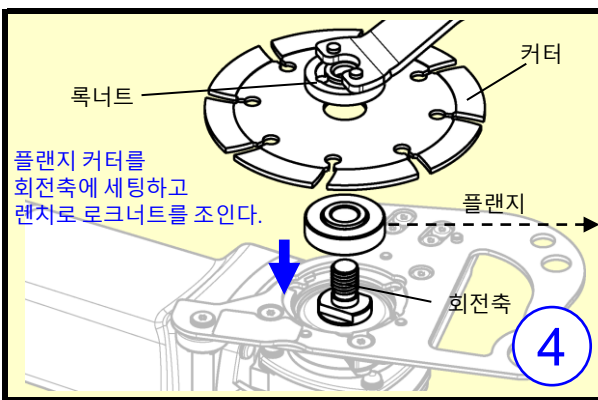

N300306

NAKAYA  
JAPAN ORIGINAL TOOLS



대응 기종 및 대응 칩단 부품에 대한 QR 코드를 읽어 확인해 주십시오.

