

Makita

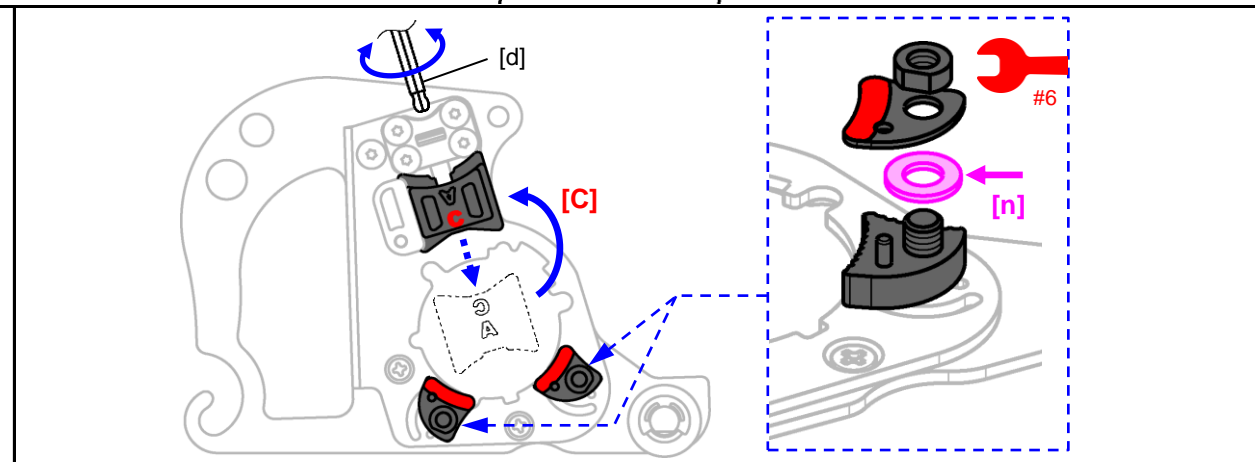
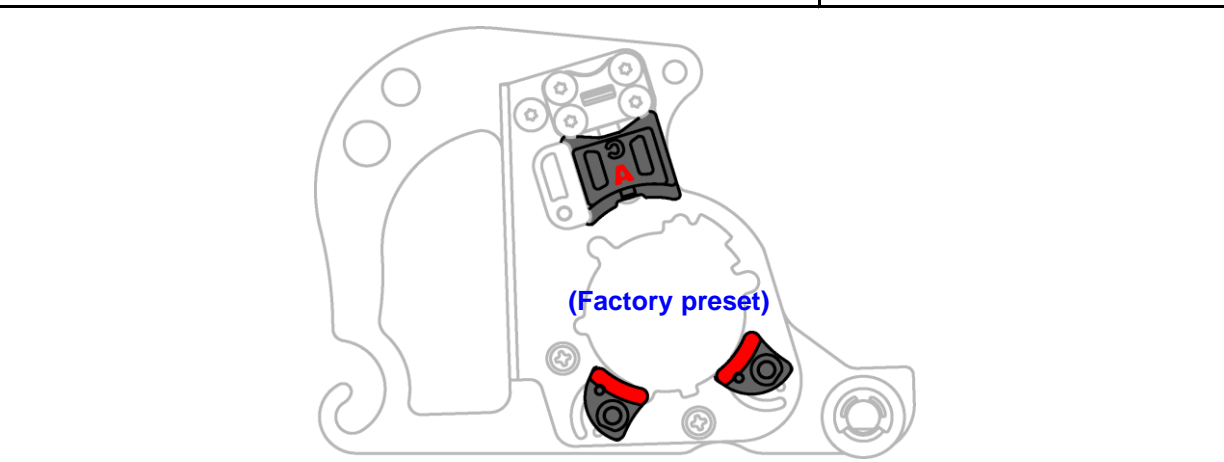
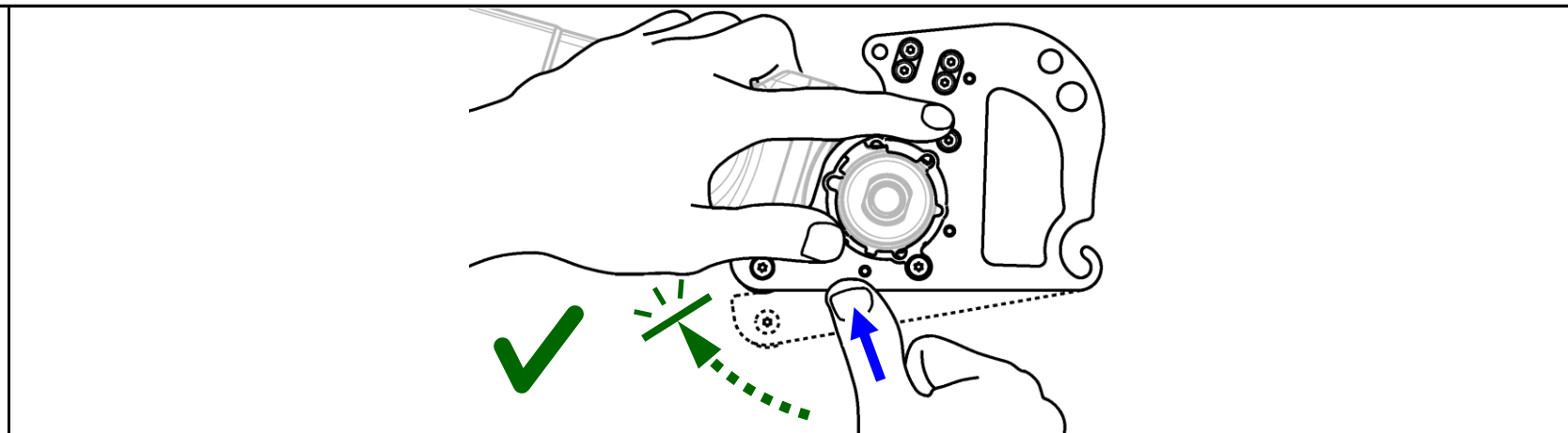
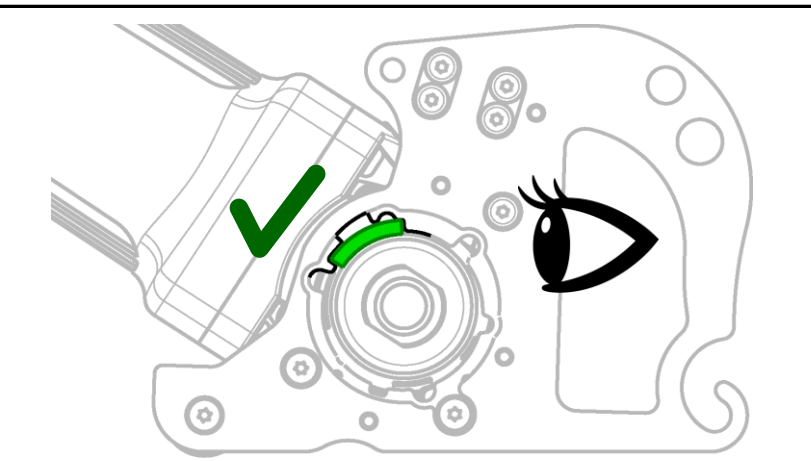
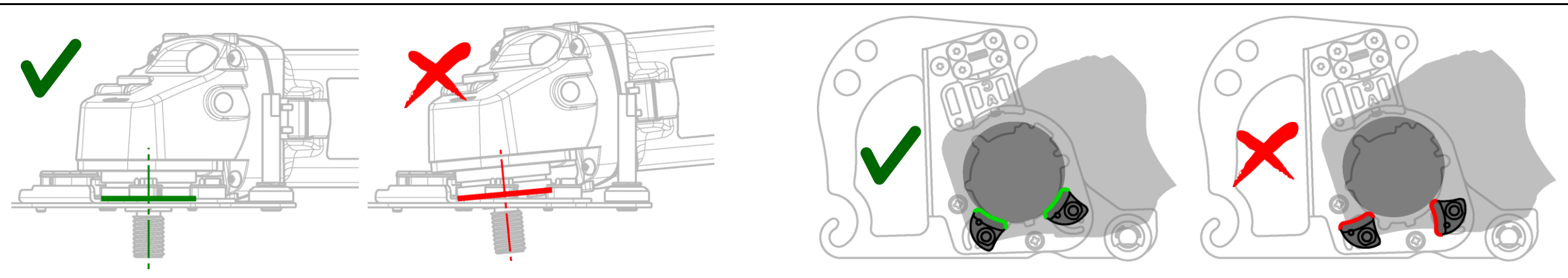
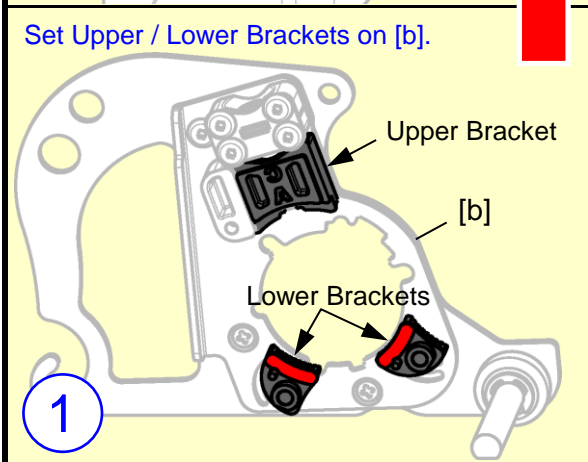
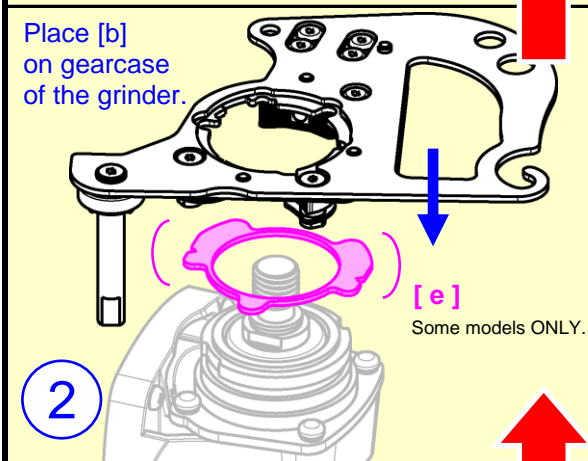
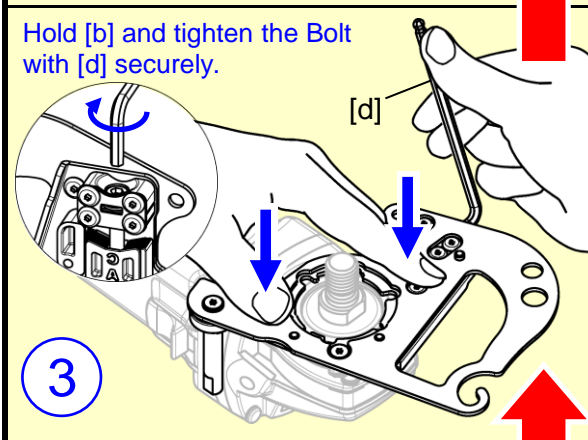
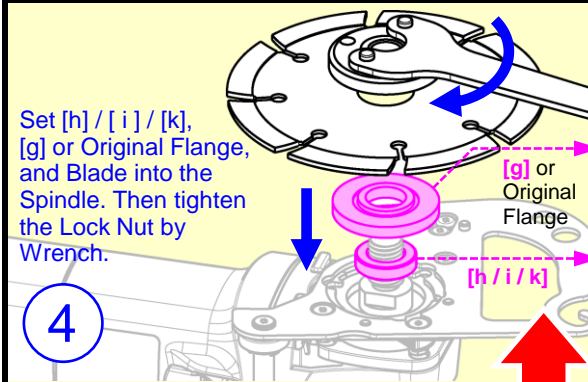

Makita

! XLOCK model can't be fitted.

※Based on the web information as of 2022 Jan.

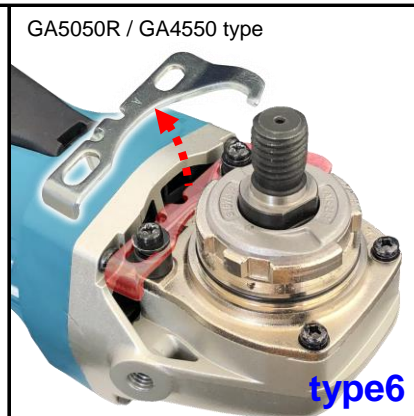
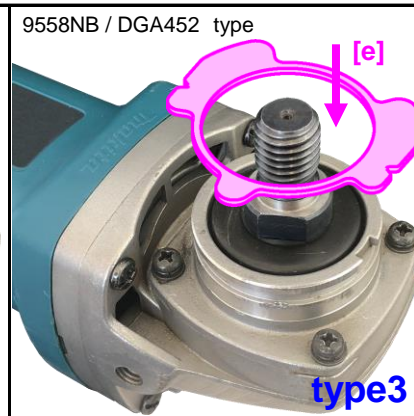
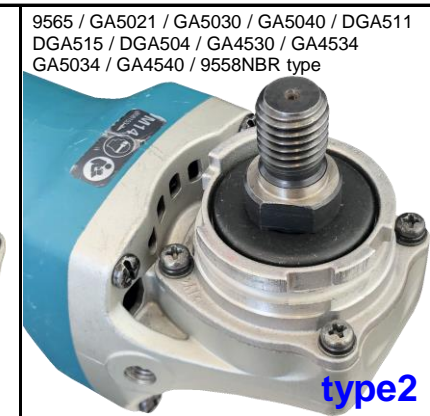
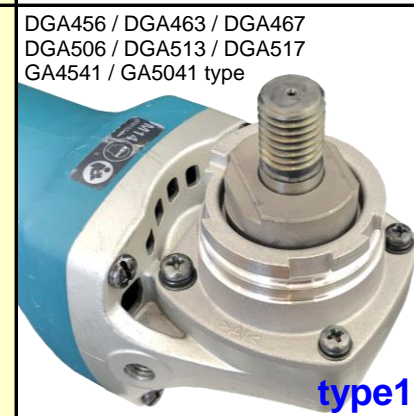
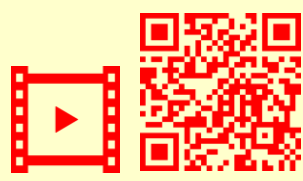

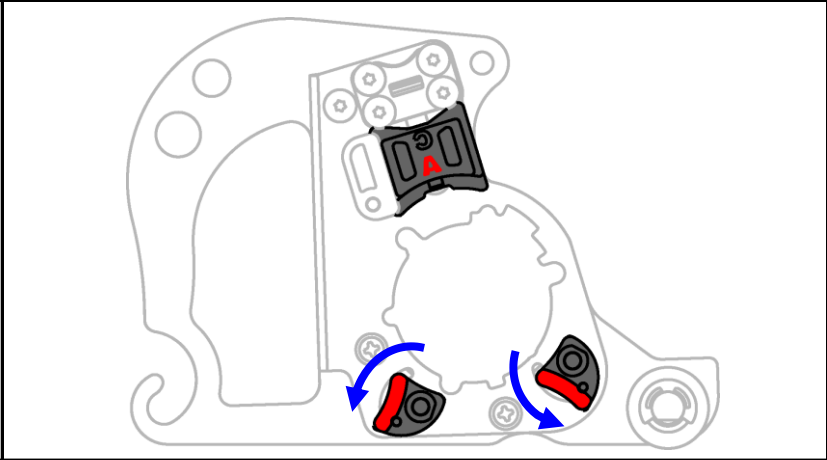
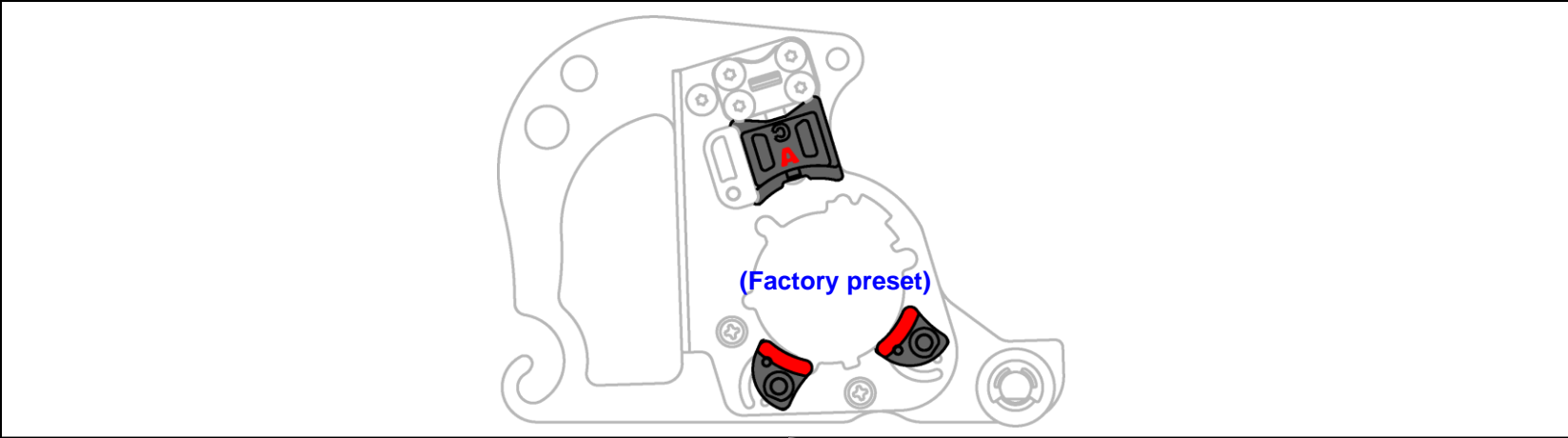
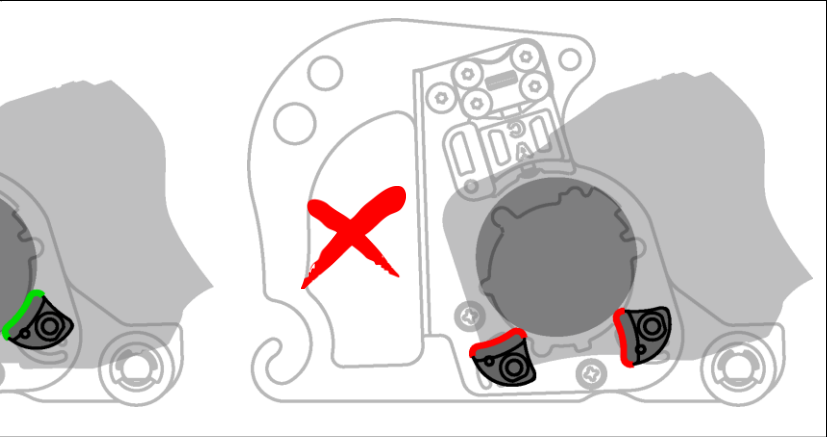
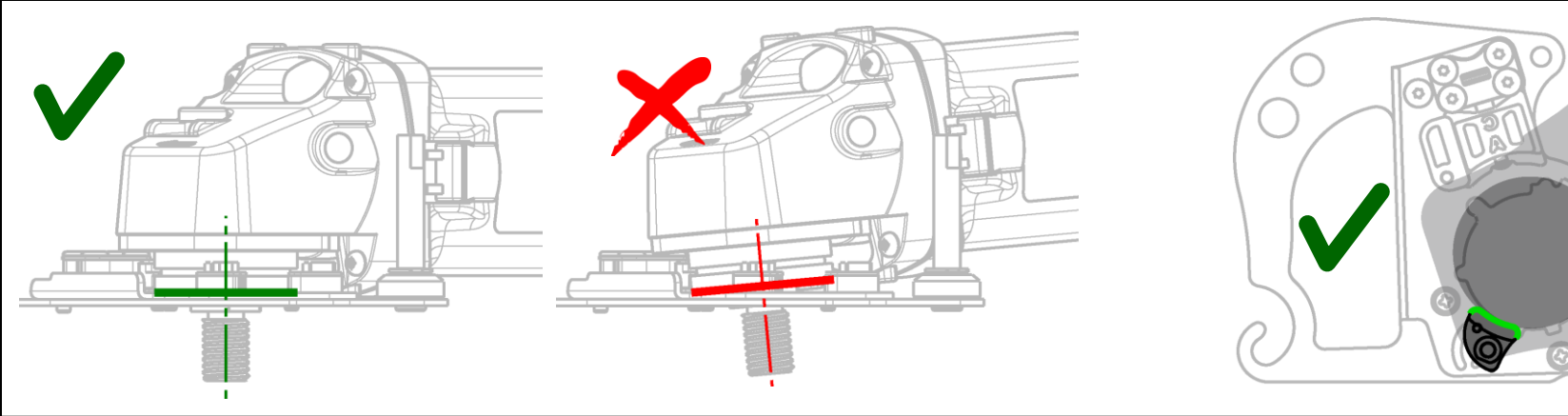
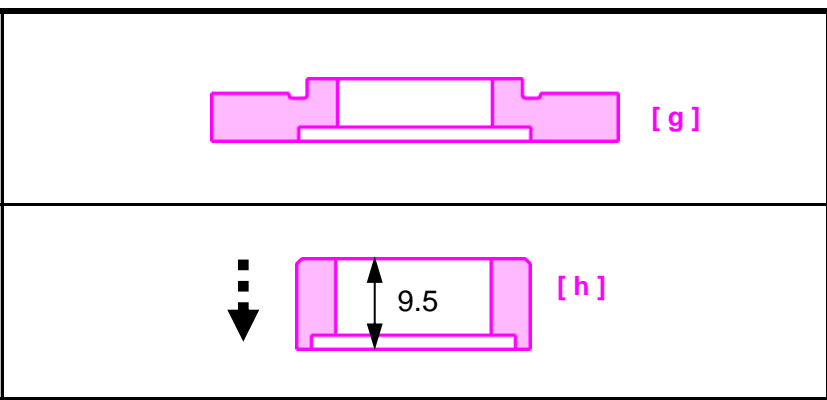
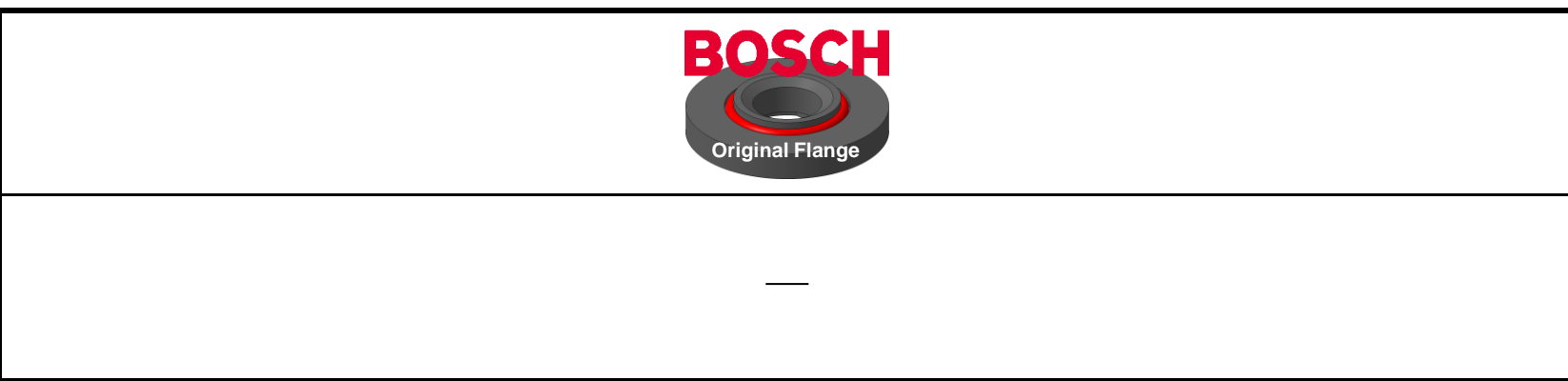
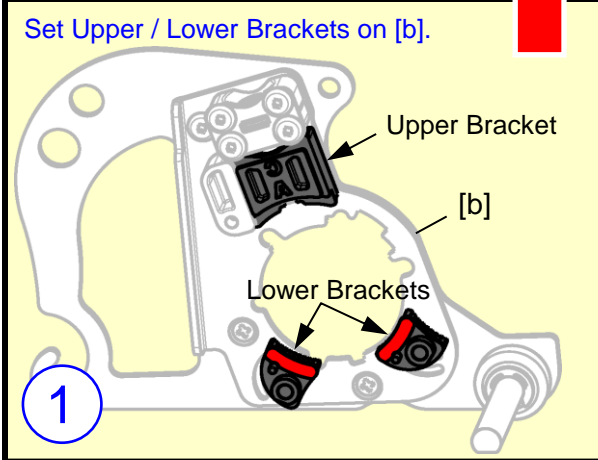
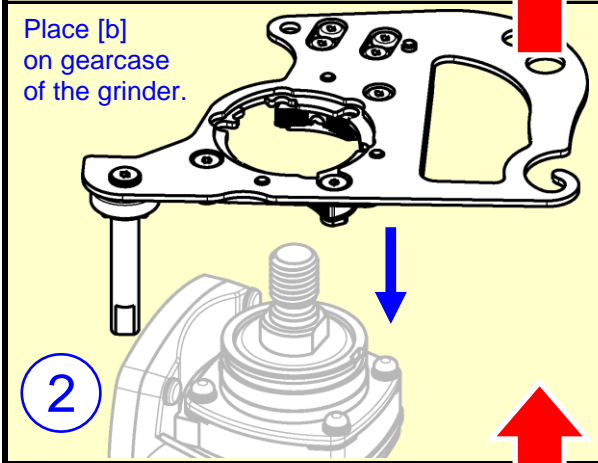
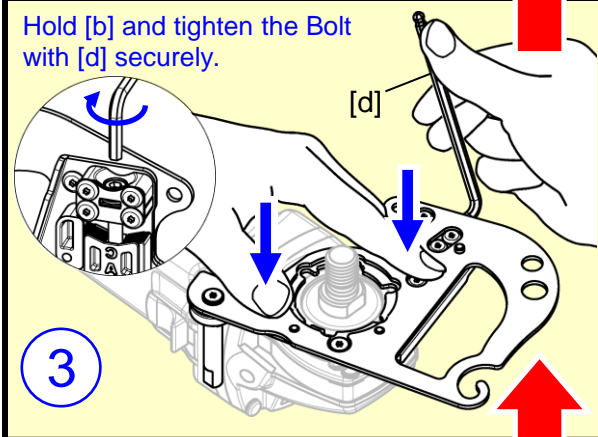
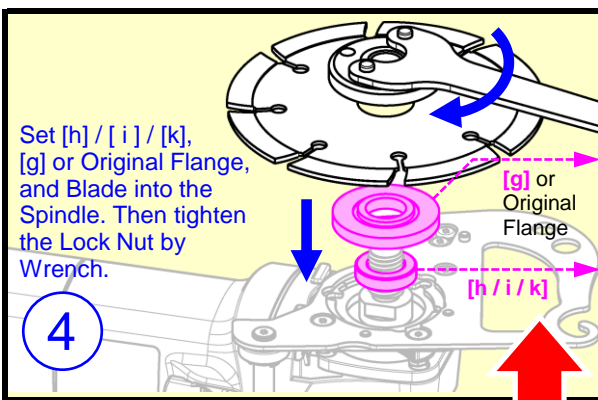

BOSCH

⚠ **XLOCK** model can't be fitted.

※Based on the web information as of 2022 Jan.

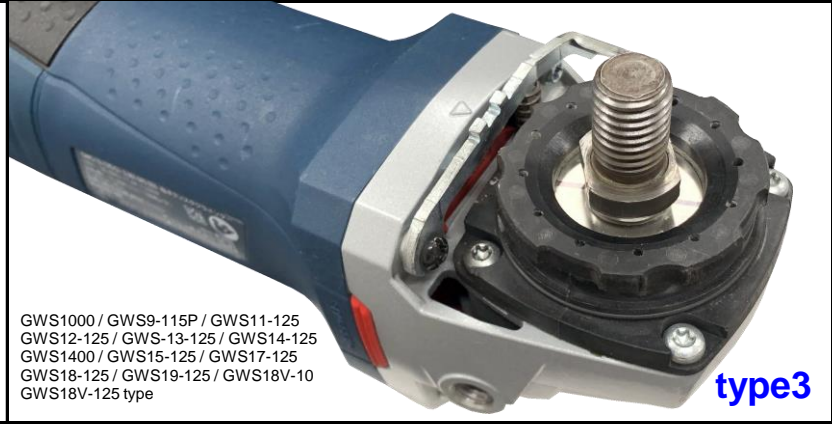
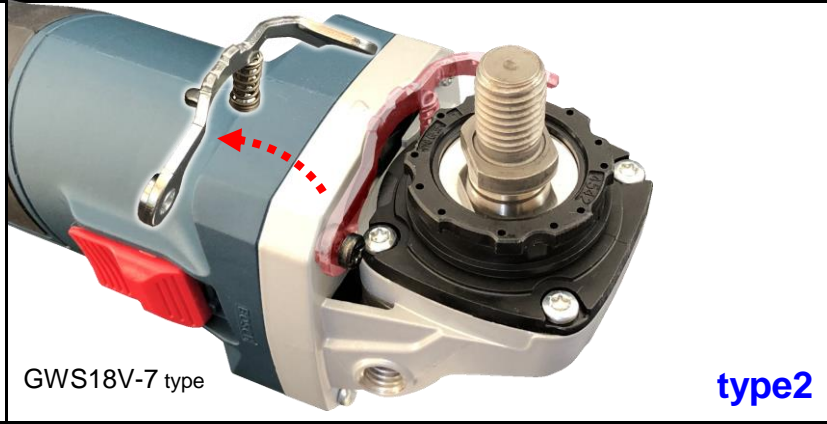

GWS7-115 / GWS7-125
GWS9-115S / GWS9-125S
GWS750 / GWS880 type

GWS18V-7 type

GWS1000 / GWS9-115P / GWS11-125
GWS12-125 / GWS-13-125 / GWS14-125
GWS1400 / GWS15-125 / GWS17-125
GWS18-125 / GWS19-125 / GWS18V-10
GWS18V-125 type

4 Set [h] / [i] / [k], [g] or Original Flange, and Blade into the Spindle. Then tighten the Lock Nut by Wrench.

3 Hold [b] and tighten the Bolt with [d] securely.

2 Place [b] on gearcase of the grinder.

[e] Some models ONLY.

1 Set Upper / Lower Brackets on [b].

Upper Bracket

Lower Brackets

[b]

⚠ D28137 / DCG405FN can't be fitted.

※Based on the web information as of 2022 Jan.

(Factory preset)

DWE4203 / 4206 / 4207 / 4217 / 4237K / 4257 / 4277 / 4357 / 4369, DCG414NT / 418NT type

type1

DWE4056 / 4057 type

type2

D28134 / DCG412N type

type3

DCG405 / 406 / 409 / 416 type

※Except DCG405FN

type4

4 Set [h] / [i] / [k], [g] or Original Flange, and Blade into the Spindle. Then tighten the Lock Nut by Wrench.



3 Hold [b] and tighten the Bolt with [d] securely.

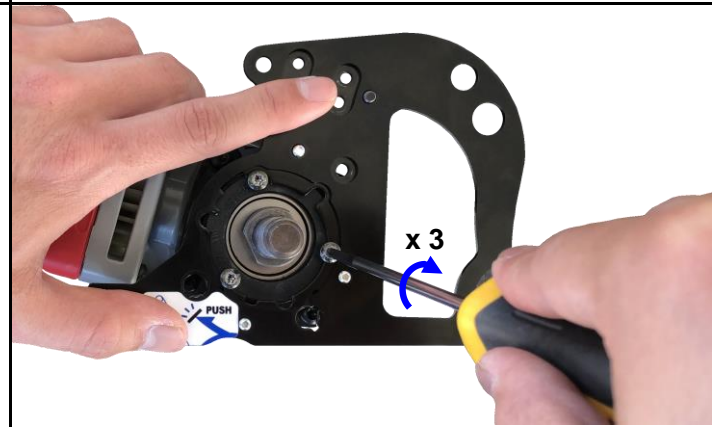

2 Place [b] on gearcase of the grinder.

[e/f] Some models ONLY.

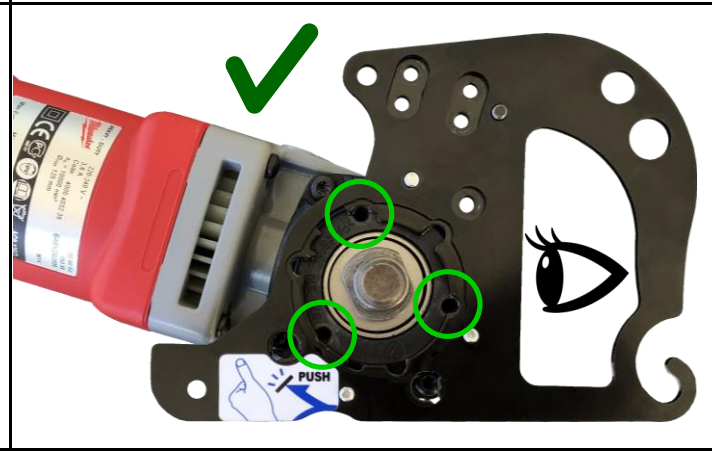

1 Set Upper / Lower Brackets on [b].

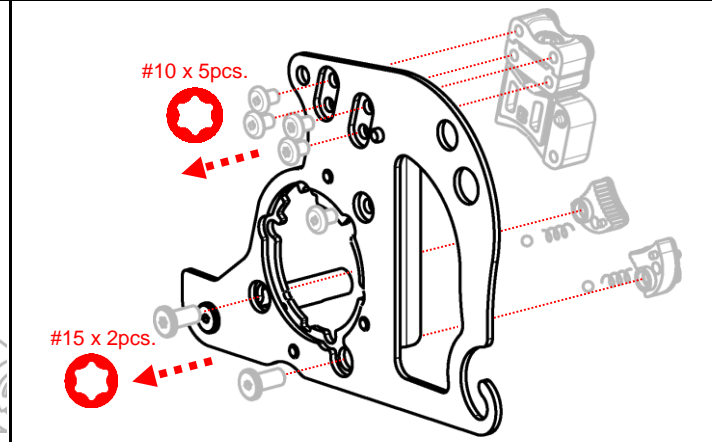

AGV10-125EK, AG10-125EK, AG800-125EK type can't be fitted.

※Based on the web information as of 2022 Jan.

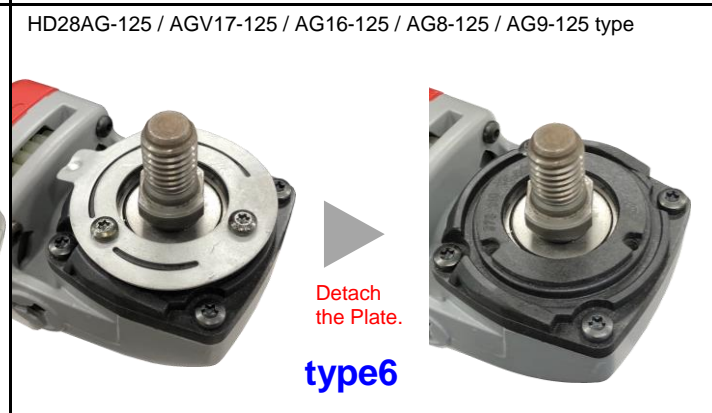
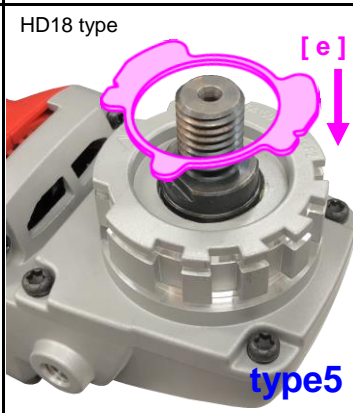
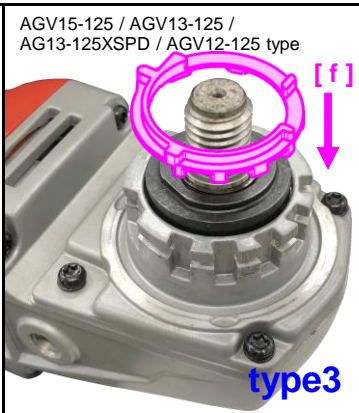
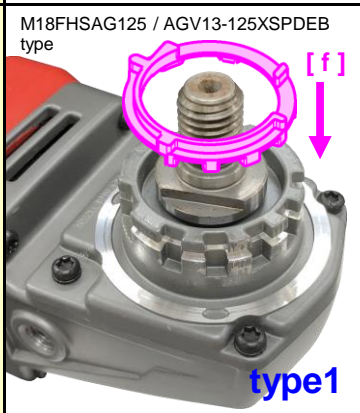



Set [h] / [i] / [k], [g] or Original Flange, and Blade into the Spindle. Then tighten the Lock Nut by Wrench.



Hold [b] and tighten the Bolt with [d] securely.

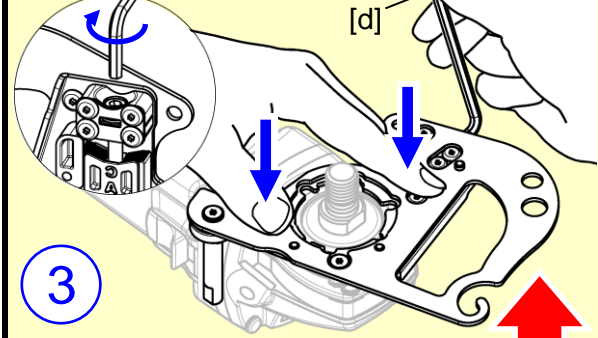

Place [b] on gearcase of the grinder.

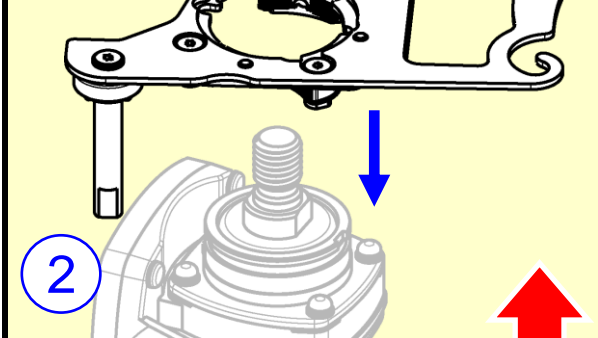

Set Upper / Lower Brackets on [b].

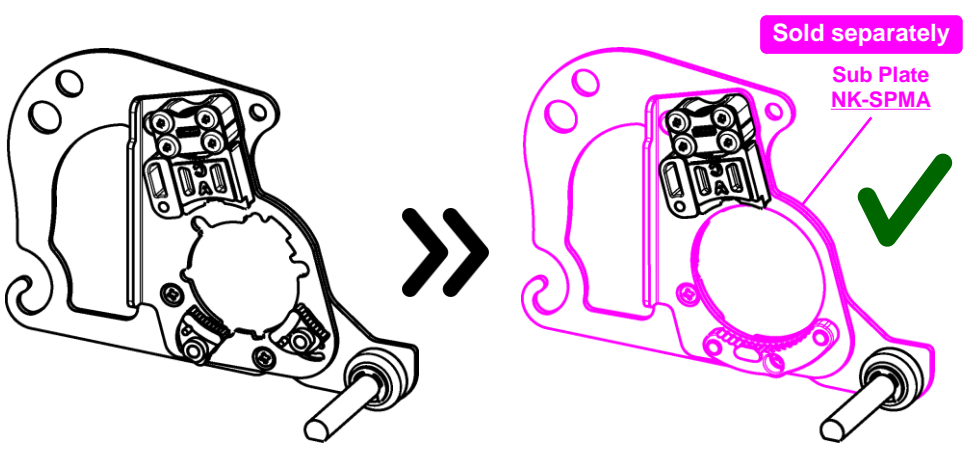
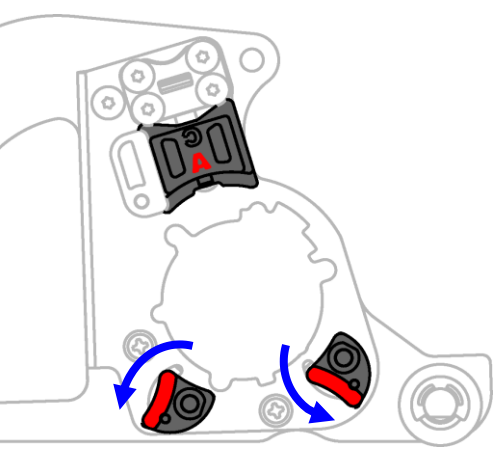
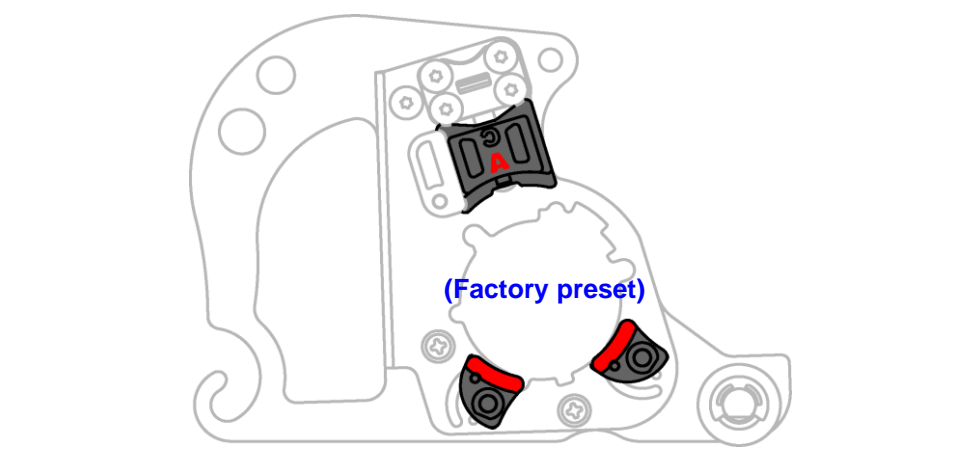
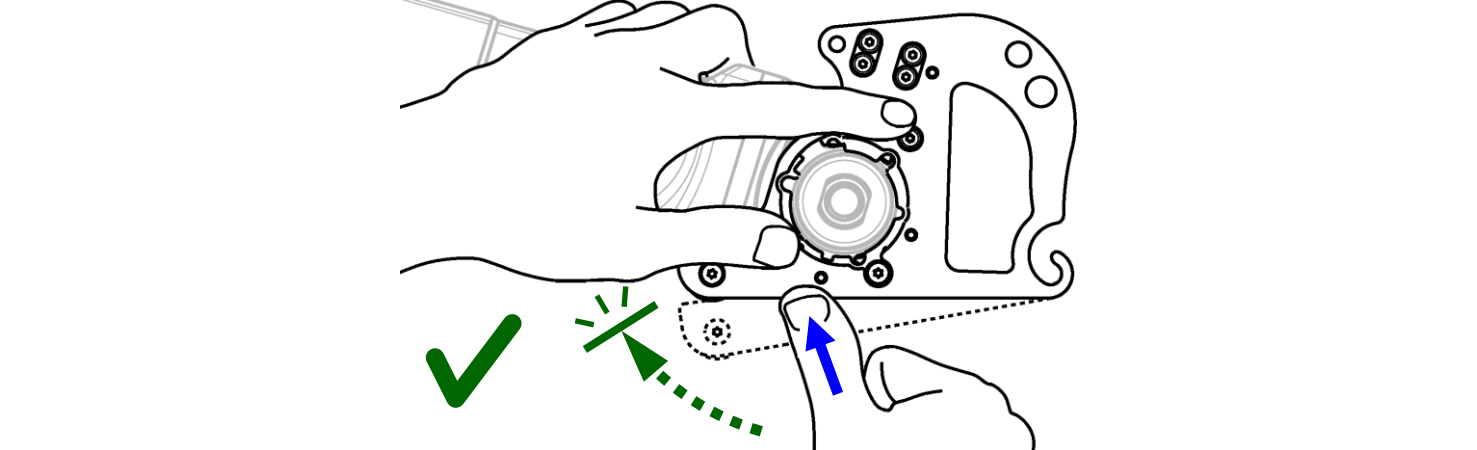
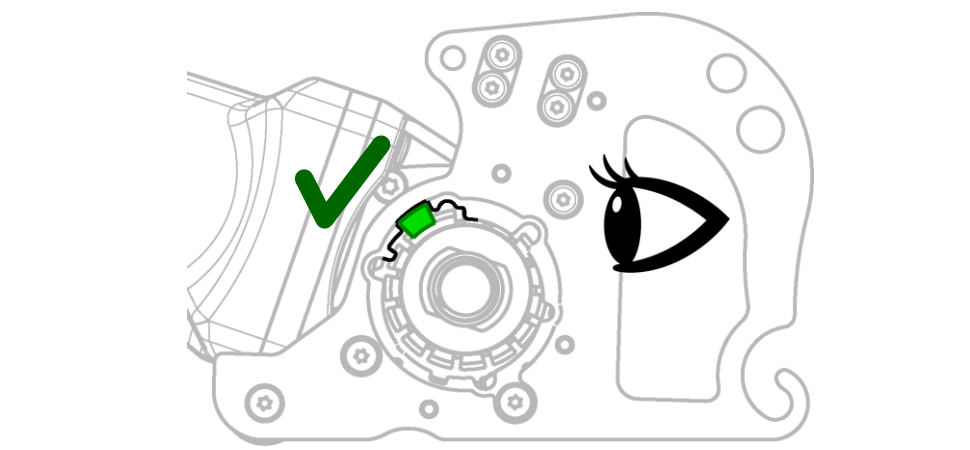
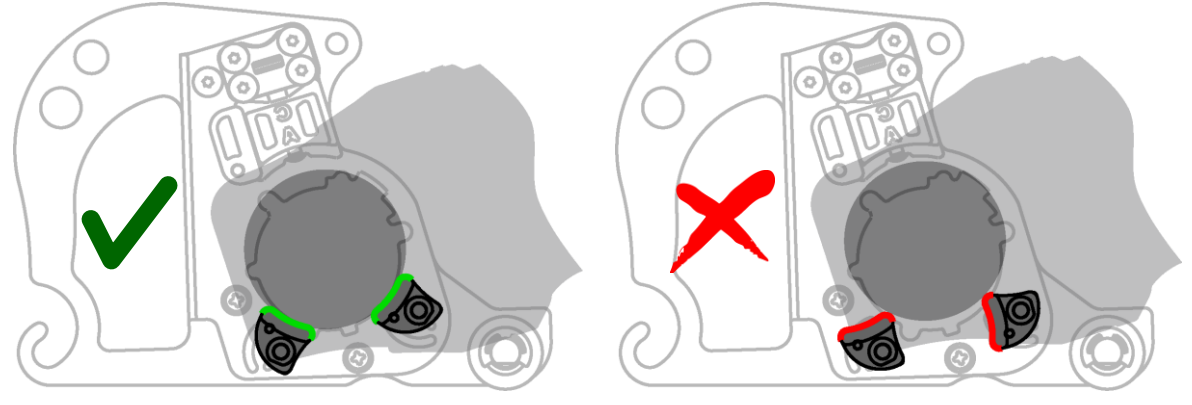
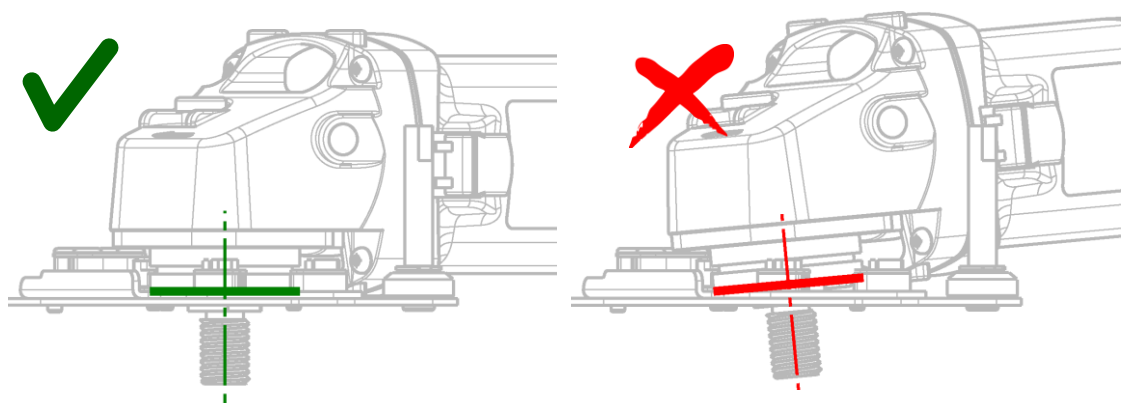
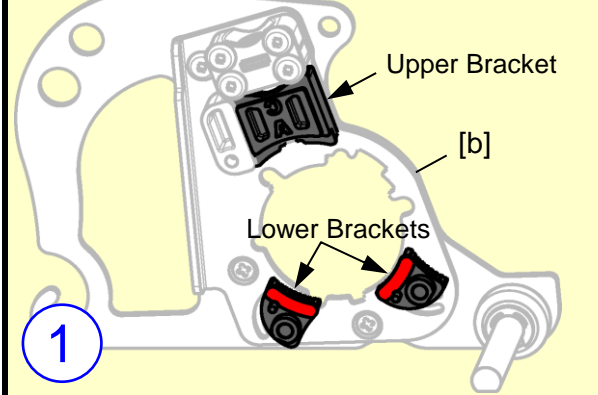

metabo

※Based on the web information as of 2022 Jan.

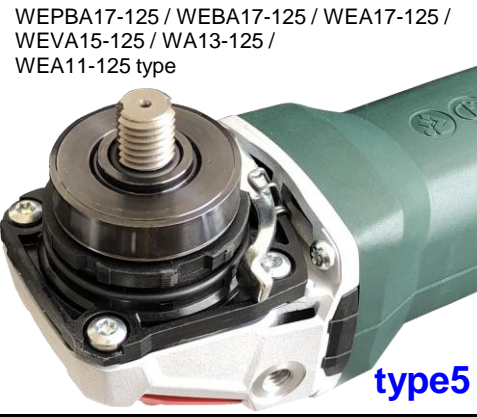
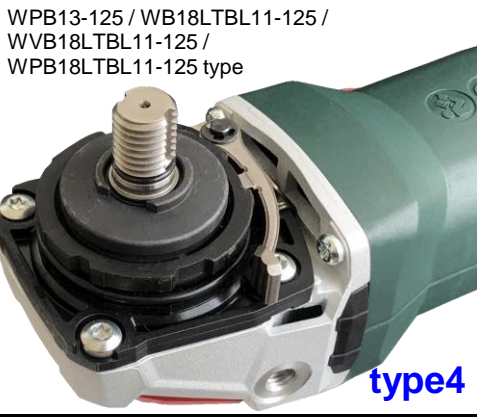
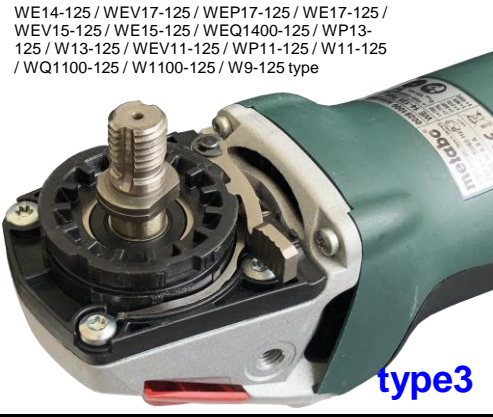
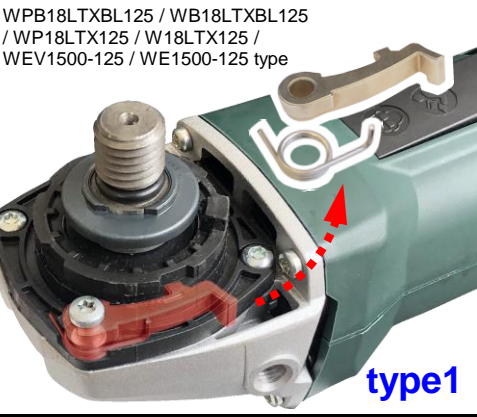

WPB18LTXBL125 / WB18LTXBL125 / WP18LTX125 / W18LTX125 / WEV1500-125 / WE1500-125 type

WEV850-125 / WP850-125 / W850-125 / W750-125 type

WE14-125 / WEV17-125 / WEP17-125 / WE17-125 / WEV15-125 / WE15-125 / WEQ1400-125 / WP13-125 / W13-125 / WEV11-125 / WP11-125 / W11-125 / WQ1100-125 / W1100-125 / W9-125 type

WPB13-125 / WB18LTBL11-125 / WVB18LTBL11-125 / WPB18LTBL11-125 type

WEPBA17-125 / WEBA17-125 / WEA17-125 / WEVA15-125 / WA13-125 / WEA11-125 type



4

Set [h] / [i] / [k], [g] or Original Flange, and Blade into the Spindle. Then tighten the Lock Nut by Wrench.

3

Hold [b] and tighten the Bolt with [d] securely.

2

Place [b] on gearcase of the grinder.

1

Set Upper / Lower Brackets on [b].

HIKOKI

※Based on the web information as of 2022 Jan.

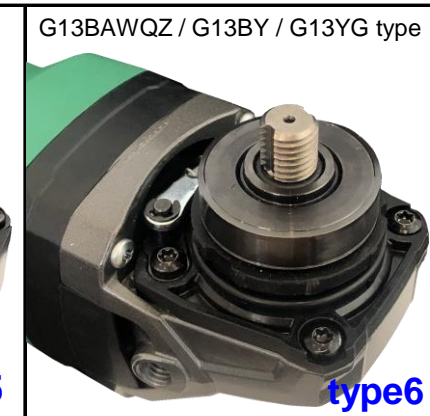
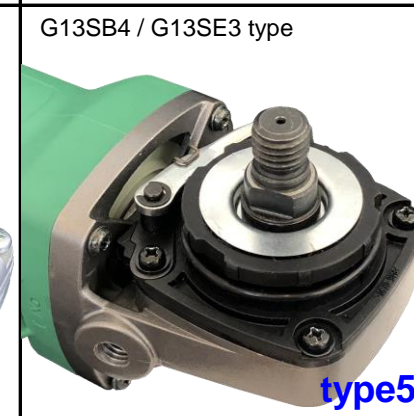
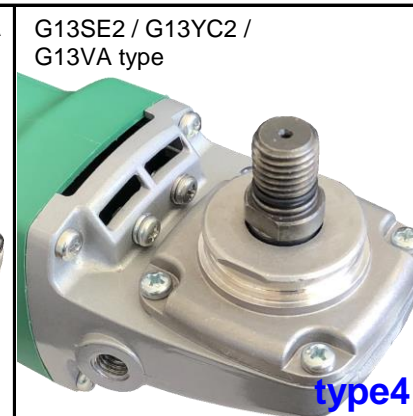
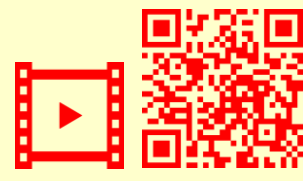

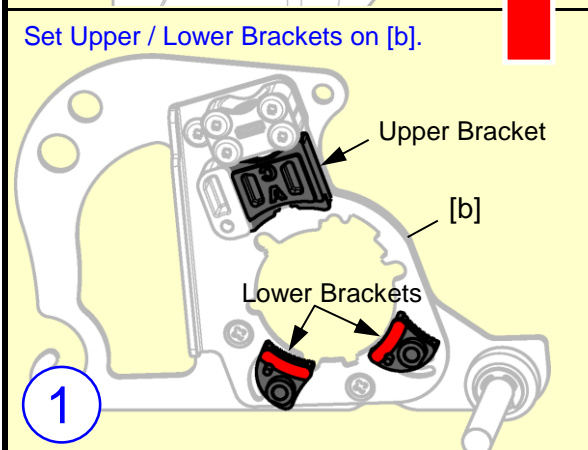
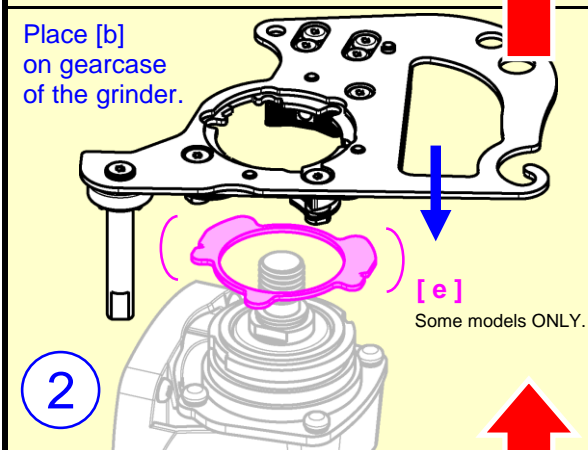
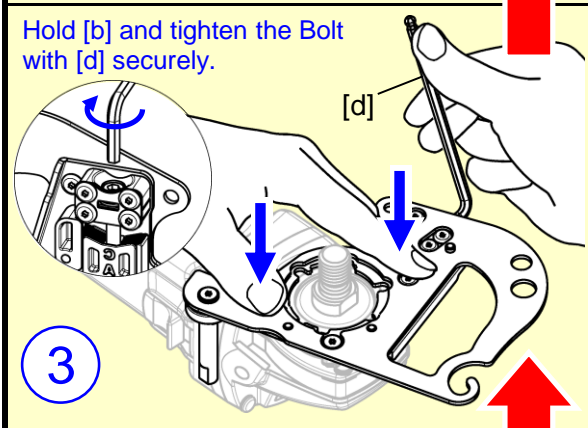
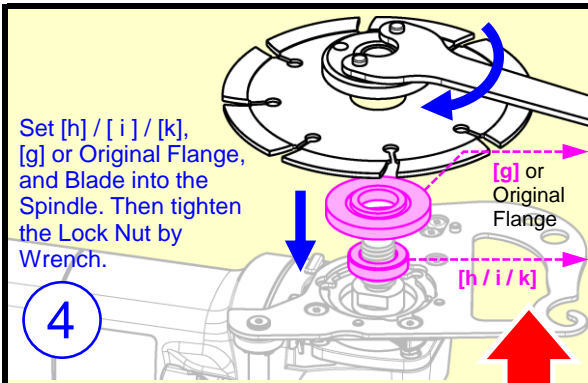

FLEX

※Based on the web information as of 2022 Jan.

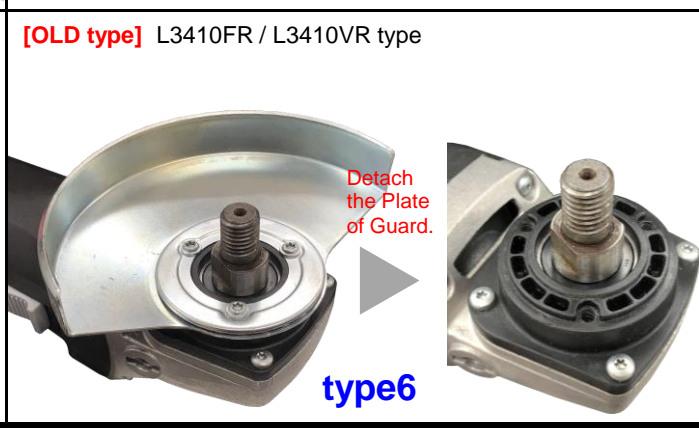
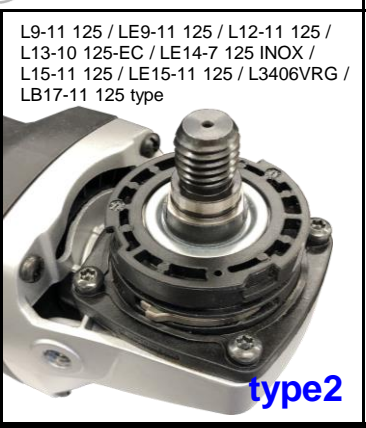
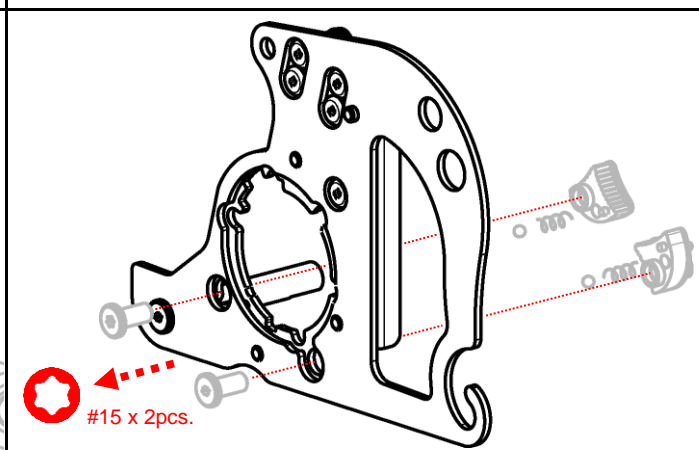
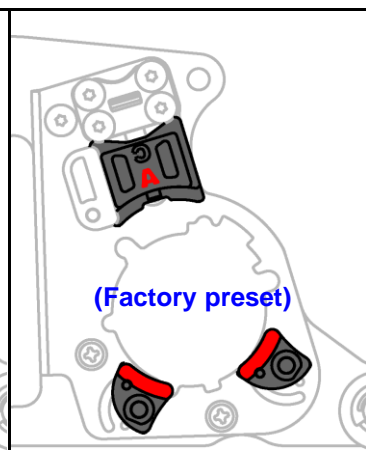
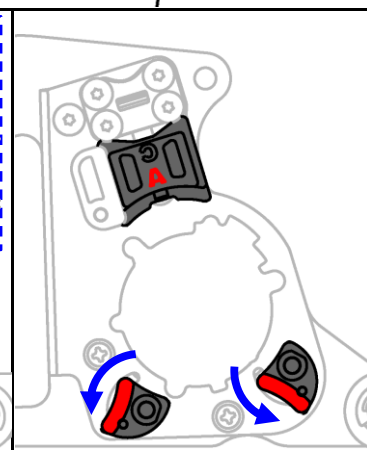
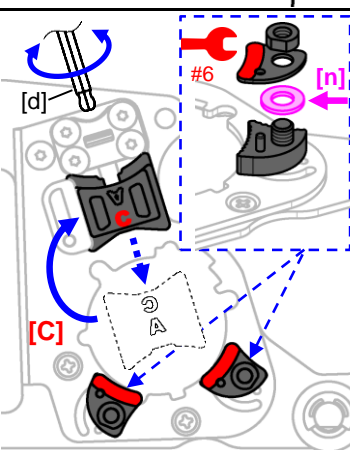
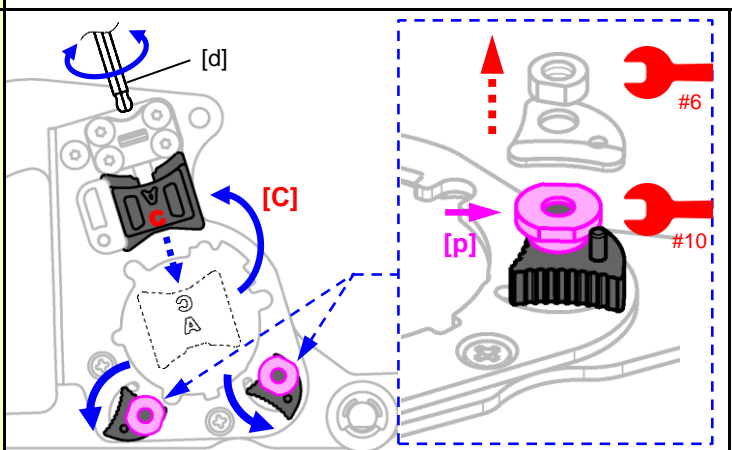
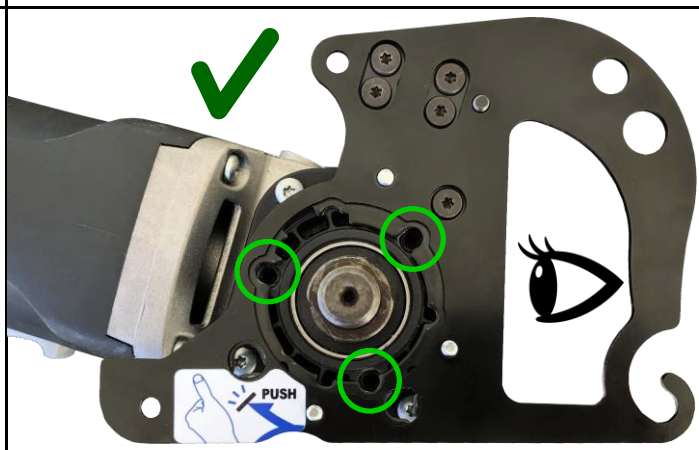
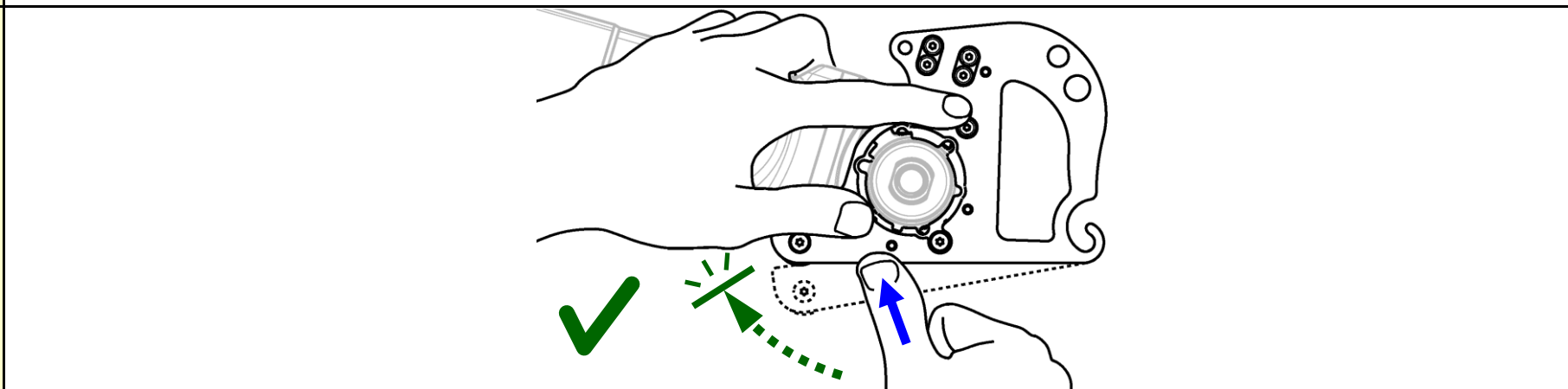
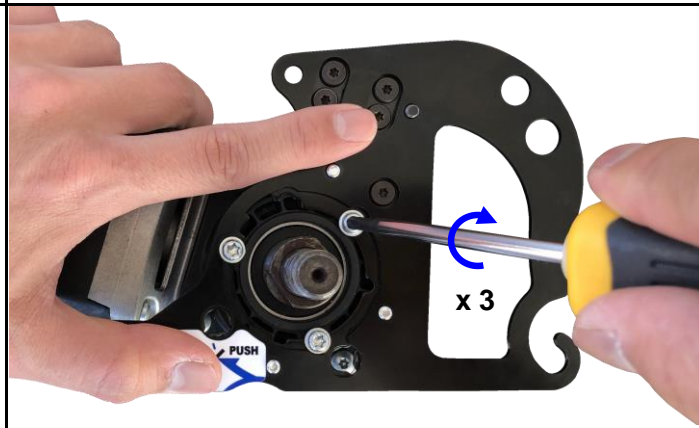
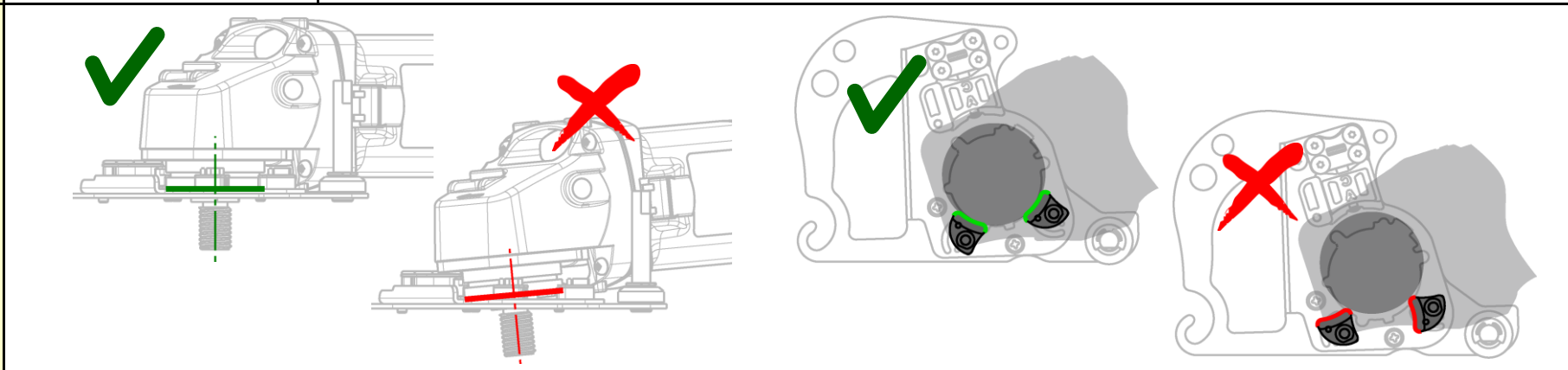
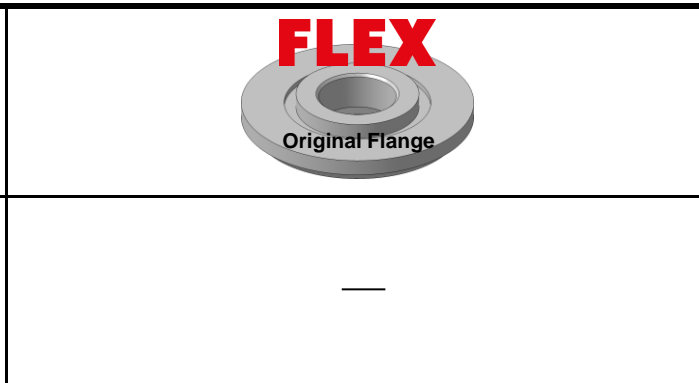
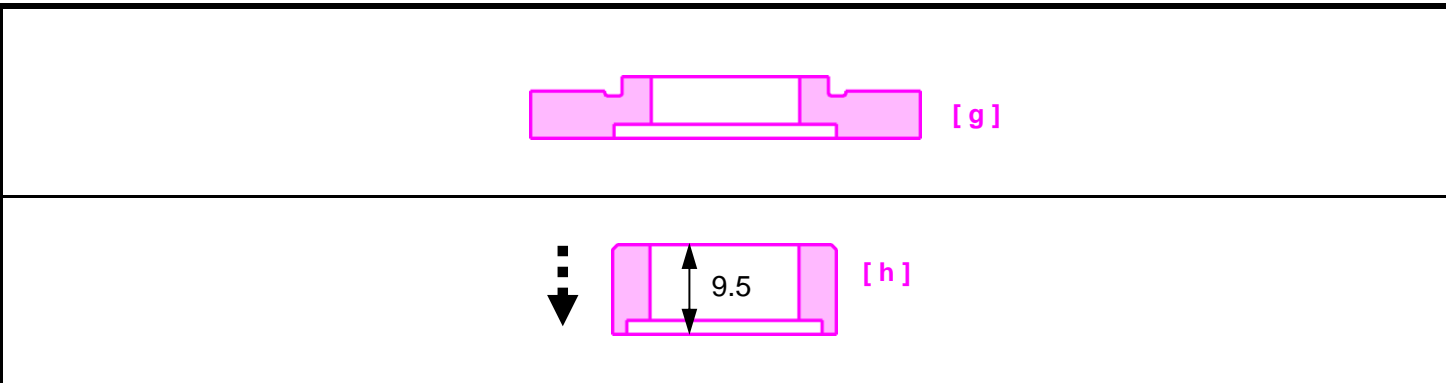
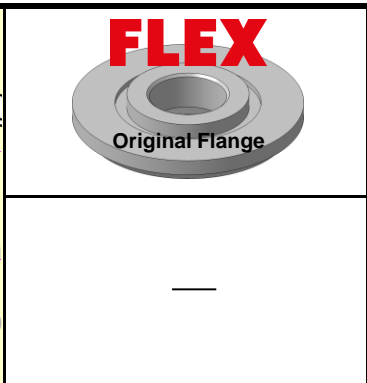

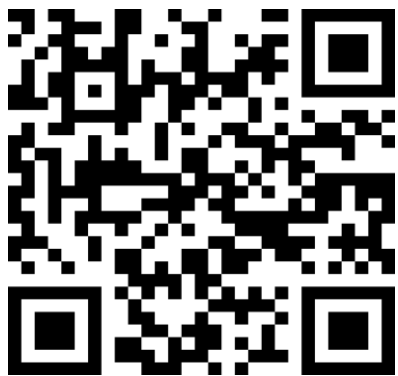

Check the
instruction
video.

