

## ⚠ WARNING

- Confirm compatibility of Grinder and Blade before use.
- Read the instruction manual for the SPARK BUSTER, the Grinder, and the Blade before use.
- Be sure to wear protective goggles, dust mask, protective footwear, earplugs and other protective equipment when working.
- Ensure the SPARK BUSTER is securely mounted onto the Grinder.
- Confirm the Blade does not rub on the inside of the SPARK BUSTER.
- Keep SPARK BUSTER away from gasoline, thinners, petroleum and paraffin.
- Do not use SPARK BUSTER when it is damaged, cracked or bent as this could lead to injury.
- Do NOT fit a Blade that exceeds the capacity of the Grinder.
- The maximum speed of the blade must be higher than that of the Grinder.

## SPECIFICATIONS

Model Code	NKS-100
Suitable Blade type	110mm Tipped Saw / 100-125mm Abrasive Cutting Wheel, Diamond Blades. (D15/20/22)
Cutting Depth (with 125mm blade)	Max. 33mm (Do NOT cut material that exceeds the capacity of the Grinder.)
Weight	780g (Main Unit)
Attachable Grinders	BOSCH : GWS5/6/7/8 100mm series MAKITA : 9553/9556/9563H/GA403 series HITACHI : G10 series, PDA-100M RYOBI : 100mm series

## OVERVIEW

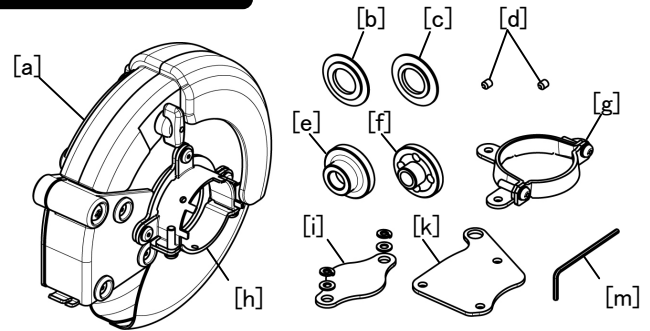

[a] Main Unit / [b] Spacer(D22) / [c] Spacer(D20) / [d] Setscrew  
[e] Flange / [f] Lock Nut / [g] H-Connector / [h] M-Connector  
[i] Side Plate A (+ Washers) / [k] Side Plate B / [m] Wrench

## INSTALLATION OF GRINDER

(1) Change the SW position of the Grinder.

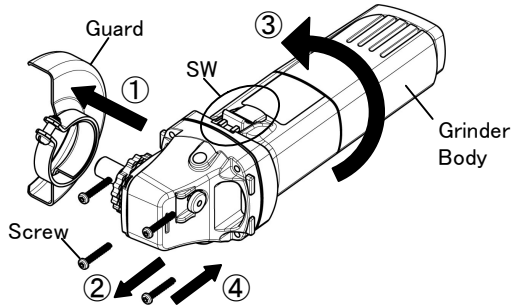

- ① Take the Guard off.
- ② Remove the Screws.
- ③ Turn the Grinder Body to locate the SW upper position.
- ④ Tighten the Screws.

## ⚠ WARNING

Be sure to turn off the grinder and remove the plug from the power supply before installation.

(2) Open the Guard of [a] Main Unit and fit the Grinder by tightening the screws of the Connector. (Hold the top surface of [a] Main Unit)

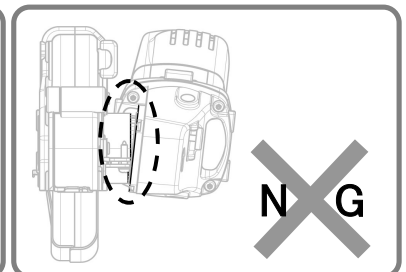
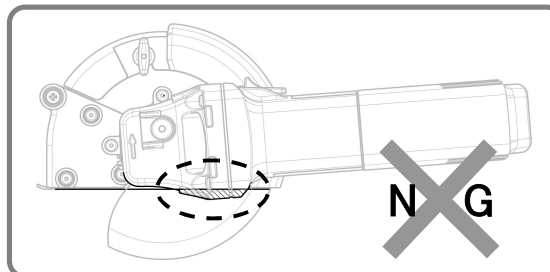
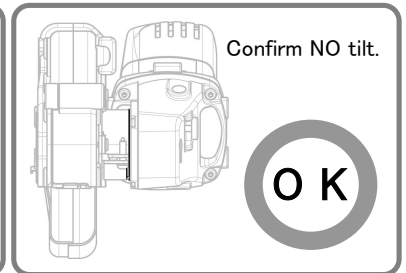
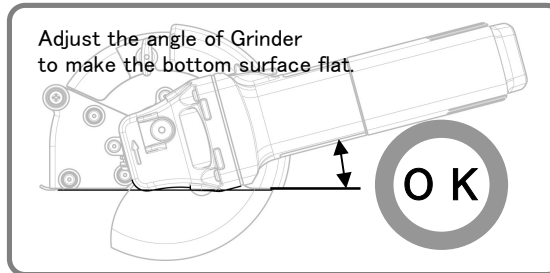
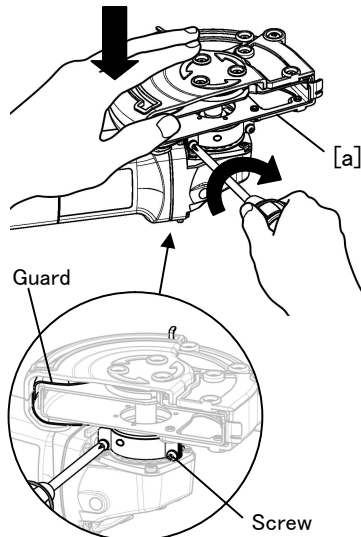

### HITACHI Grinder

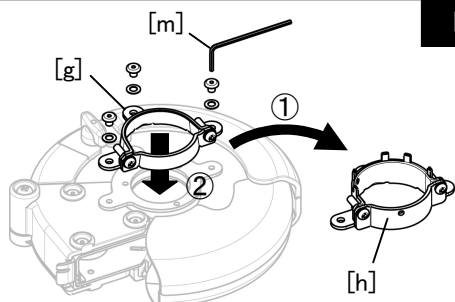

Change the Connector by [m] Wrench.

- ① Remove preset [h] M-Connector.
- ② Set [g] H-Connector.

### BOSCH Grinder

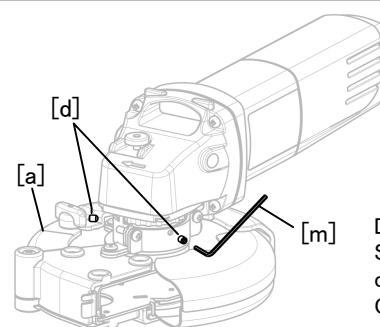

Tighten [d] Setscrew after fitting the Grinder into [a] Main Unit by [m] Wrench.

Do NOT over tighten [e] Set Screws or they could cause damage or deformation to the Grinder and Connector.

## INSTALLATION OF BLADE

(1) Loosen Knob Bolt and open [a] Main Unit by operating the lever of the Guard.

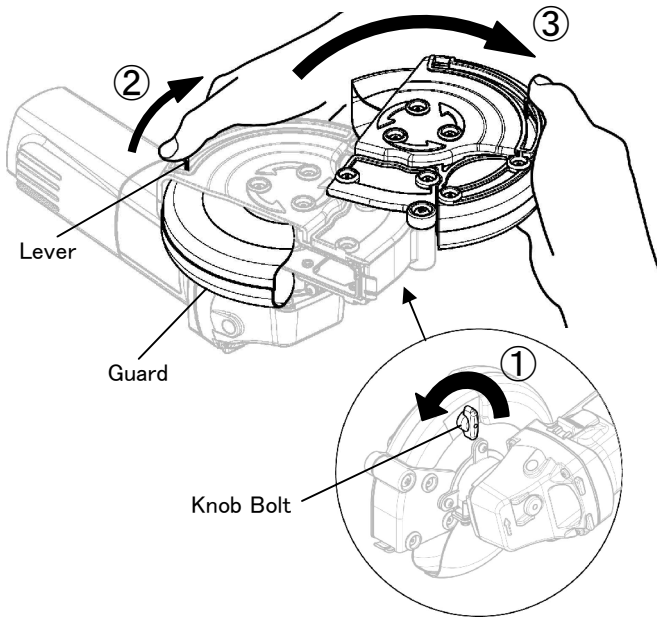

(2) Set [e] Flange (and proper Spacer [b]/[c]) on the Spindle then tighten [f] Lock Nut to fix the Blade.

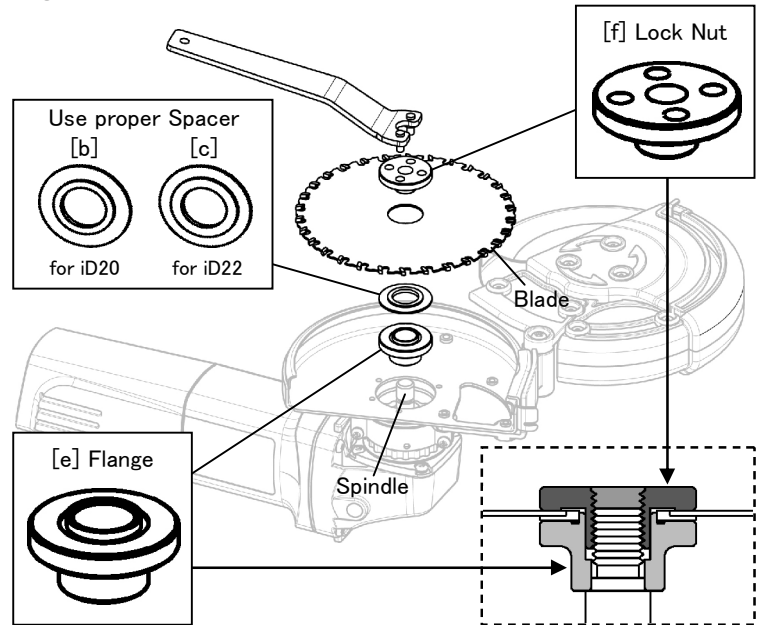

(3) Close [a] Main Unit and tighten Knob Bolt.

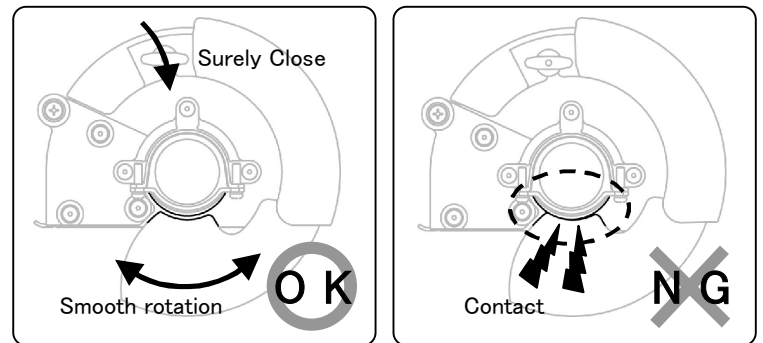
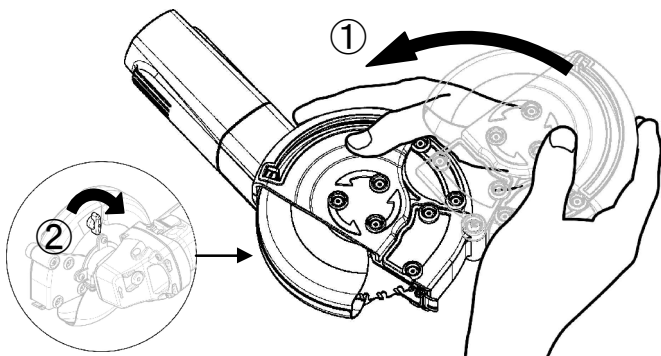

**! WARNING** Confirm the Guard moves smoothly.

## CUTTING

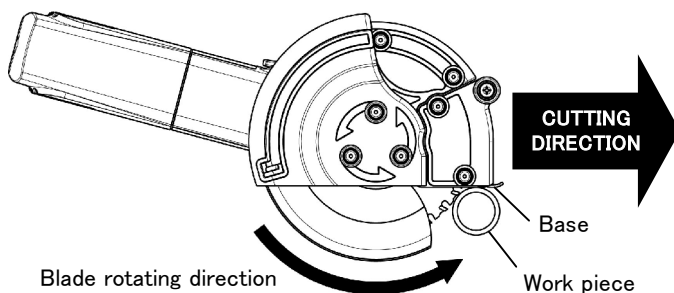

(1) Turn on the the Grinder switch (SW).  
 (2) Set the Base on work piece.  
 (3) Slowly push the Grinder forward and start cutting.

**! WARNING**

- Do NOT engage the rotating Blade with the work piece directly. (The Base must engage the work piece first)
- Confirm the direction of cutting and Blade rotation.
- Ensure the work piece is securely clamped.

## Instruction for Abrasive Cutting Wheel

Before using abrasive cutting wheel, ensure steel Side Plates [i] and [k] are installed.

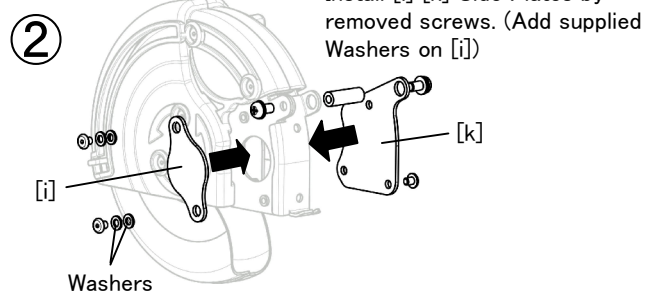
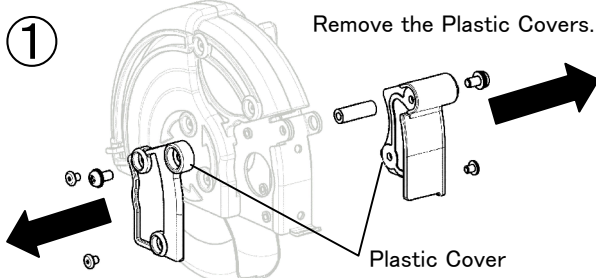

**! WARNING** Do NOT use Abrasive Cutting Wheel under a heavy load, otherwise it could lead to a breakage of SPARK BUSTER and Grinder.