

## ⚠ WARNING

- DO NOT use the HURRICANE ALPHA with non-approved angle grinders. Please check against list below.
- HURRICANE ALPHA is only for grinding concrete and block. DO NOT use for grinding steel or other materials.
- HURRICANE ALPHA must be used with a vacuum designed and approved for concrete dust.
- HURRICANE ALPHA is only for use with Diamond Grinding Cup. DO NOT use with abrasive grinding wheels.
- Always check the HURRICANE ALPHA for damage, cracks, or deformation before use.
- DO NOT use the HURRICANE ALPHA if it is cracked, damaged or bent as this could lead to injury.
- Be sure to wear protective goggles, dust mask, protective gloves and foot wear, earplugs and other protective equipment when working.
- Keep the HURRICANE ALPHA away from gasoline, solvents, and paraffin.
- Ensure the work piece is securely clamped before working.

## Explanation of the pictograms.



General Warning.



Read the operating instructions before use.



Wear eye protection.



Wear breathing protection.



Wear ear protection.



Wear protective gloves.

## SPECIFICATIONS

Model Code	NKC-180	
Suitable Tool	ø175~180mm (7 inch class) / h30-50mm Diamond Grinding Cup Wheel	
Weight	850g (Main Unit with adaptor system)	
Work Material	Concrete / Block.	
Suitable Angle Grinders	DEWALT	DWE 4517 / 4557 / 4597 / 4597N / 4519 / 4559N / 4559CN / 4599N
	Milwaukee	6088-30, 6088-31
	Makita	GA7021 / 7031Y / 7040S / 7060 / 7061 / 9031Y / 9040S / 9060
	BOSCH	1772-6, 1893-6, 1893-6D, 1974-8, 1974-8D, 1994-6
	Metabo	W2000, W24-180MVT, WEPB24-180MVT, W24-230MVT, W26-230MVT, WEPB24-230MVT
	HiKOKI	G18ST, G18SCY, G23SCY

## OVER VIEW

[a] Main Body / [b] Centering Holder / [c] Adaptor / [d] Tall Brush / [e] Flange Bolt / [f] Base Flange  
[g] Spacer T6.1 / [h] Spacer T8.0 / [i] Spacer T9.4 / [k] Spacer T12.2 / [m] Bolt (L60) / [n] Bolt (L45)  
[o] Hex Wrench / [p] Hose Connector / [q] Mount Ring

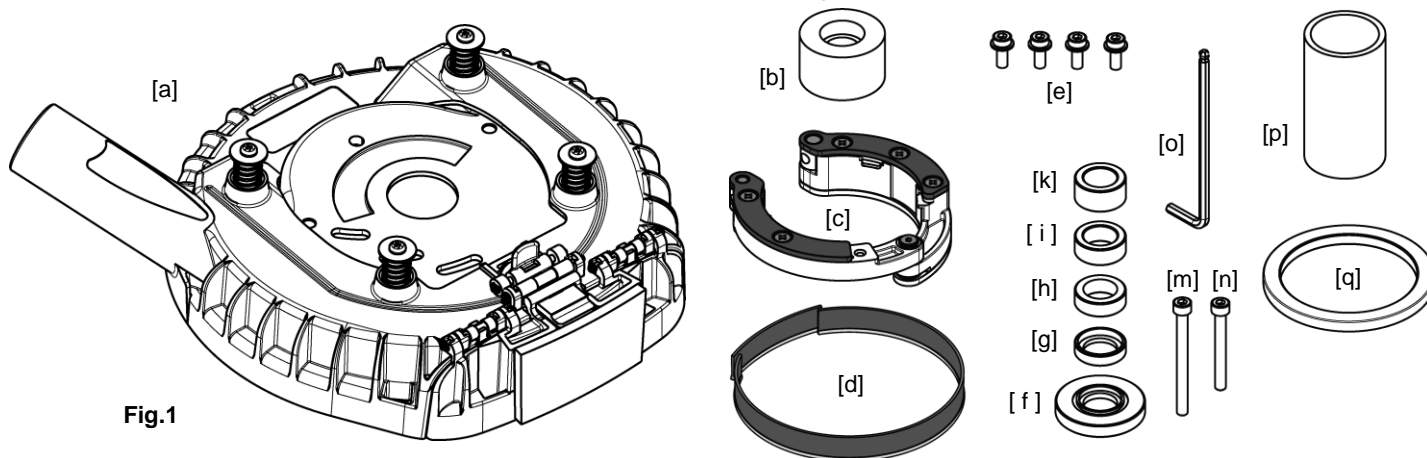

Fig.1

## PREPARATION

1. Remove the Lever unit and O-ring. (Metabo old models only)
2. Set [q] Mount Ring on the Gear Case. (Metabo and Dewalt DWE4597 type only) (Fig.2)
3. Remove the top cover from [c] Adaptor.
4. Set [c] Adaptor around the Gear Case with the Hooks securely stored into the groove at Gear Case. (Fig.3)

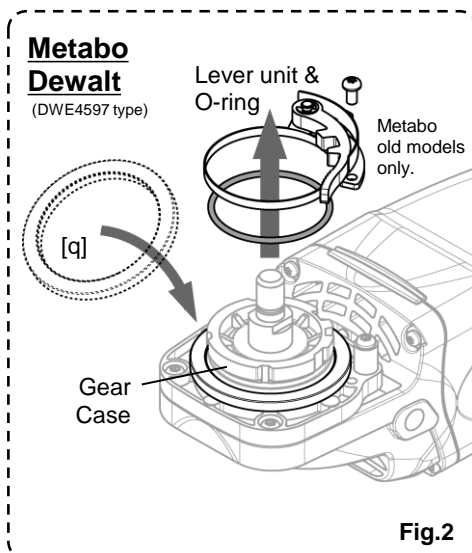

Fig.2

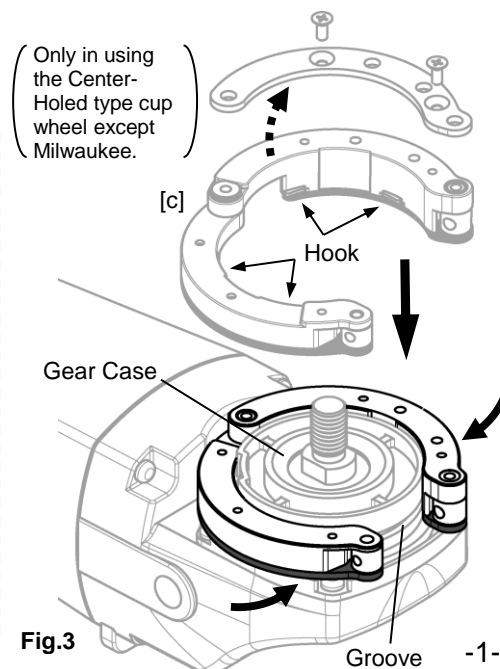
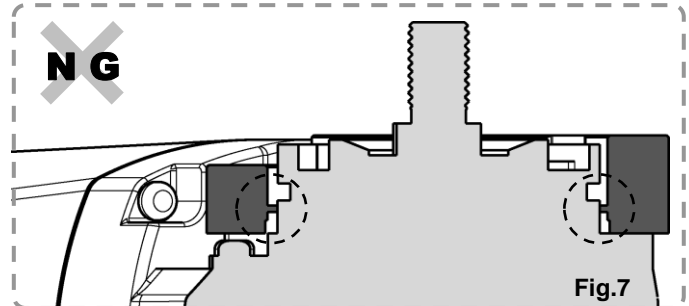
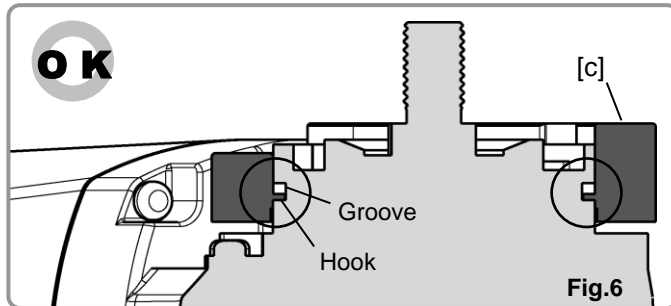
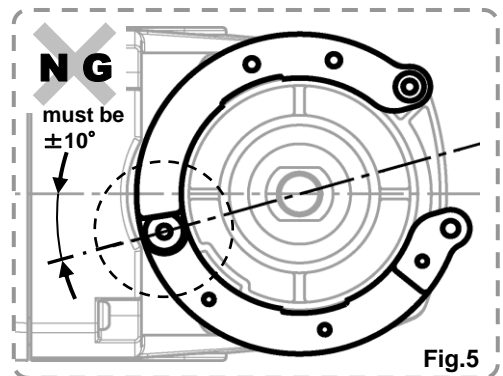
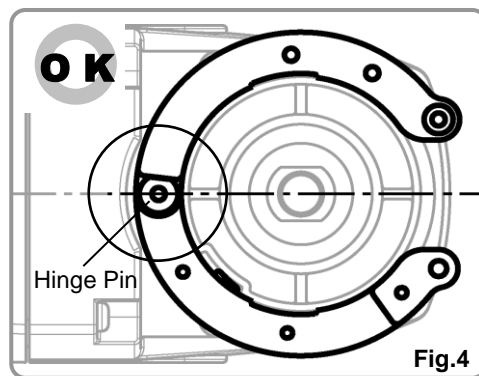

Fig.3

5. Set the position of the Hinge Pin on the center line of the angle grinder.  
(Fig.4 and 5)

6. Confirm the Hooks are securely located into the groove in the Gearbox housing  
(Fig.6 and 7)



## INSTALLATION

1. Hold [c] Adaptor with a downwards pressure.
2. Tighten [m] / [n] Bolt by [o] Hex Wrench to clamp the gearbox housing.  
[m] Bolt (L60) : for BOSCH  
[n] Bolt (L45) : for Others  
\* Make the [m] [n] Bolt head facing the Flat Surface of [c] Adaptor.  
(Fig.8)

3. Place [a] Main Body on [c] Adaptor.
4. Insert [b] Centering Holder into the spindle of the angle grinder through the center hole of [a] Main Body.
5. Align the position of the Anchor Hole at [a] Main Body and the Screw hole at Hinge Pin of [c] Adaptor.  
(Fig.9)

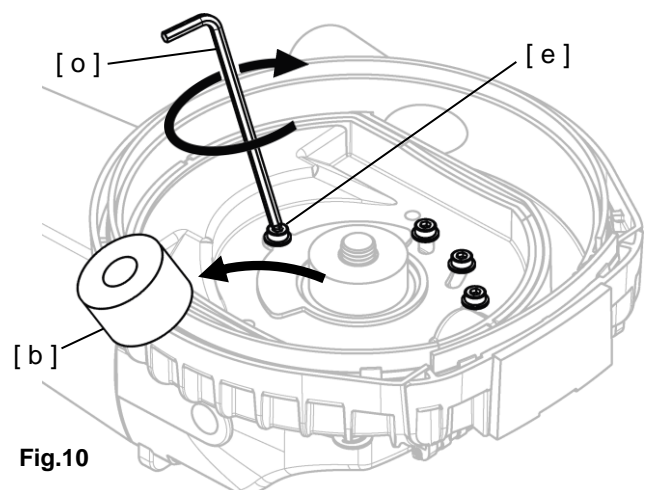
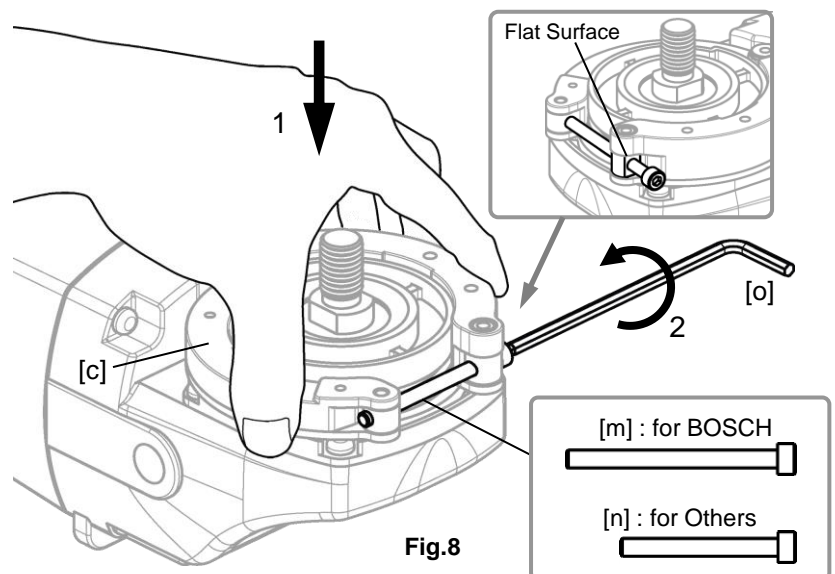
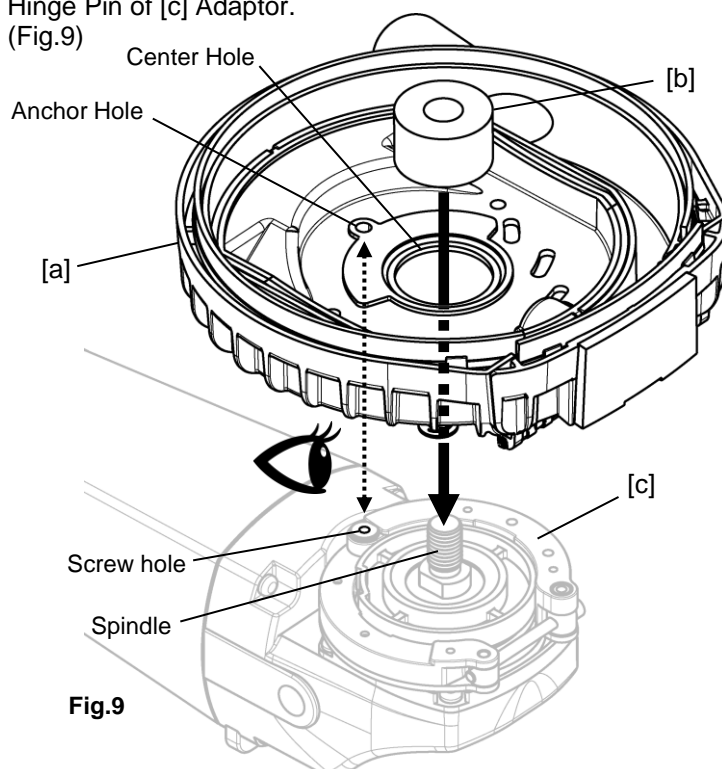

6. Tighten [e] Flange Bolt x 4pcs by [o] Hex Wrench.
7. Remove [b] Centering Holder.  
(Fig.10)

8. Set the Grinding Cup. (Fig.11 and 12)

**Fig.11 : Screw Joint type**

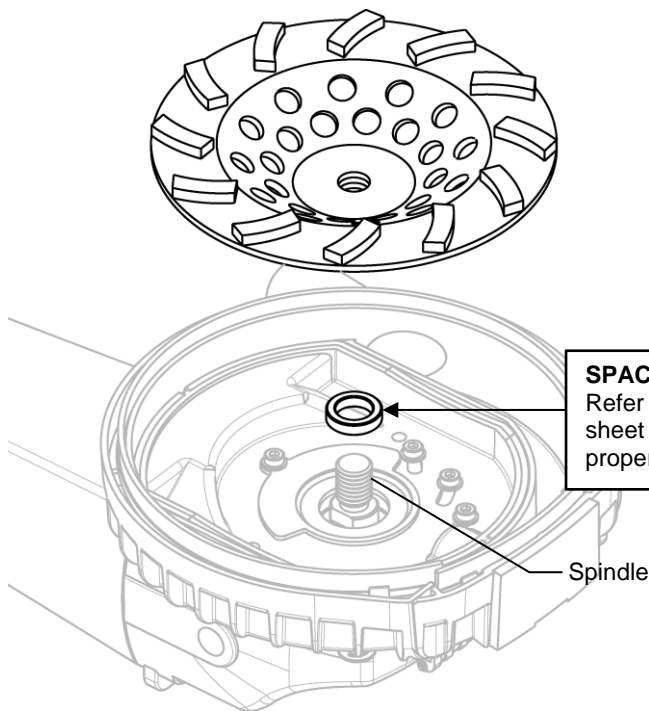

- (1) Set the proper Spacer [g] / [h] / [i] / [k] on the spindle.
- (2) Screw the Grinding Cup into the spindle.

**Fig.12 : Center Holed type**

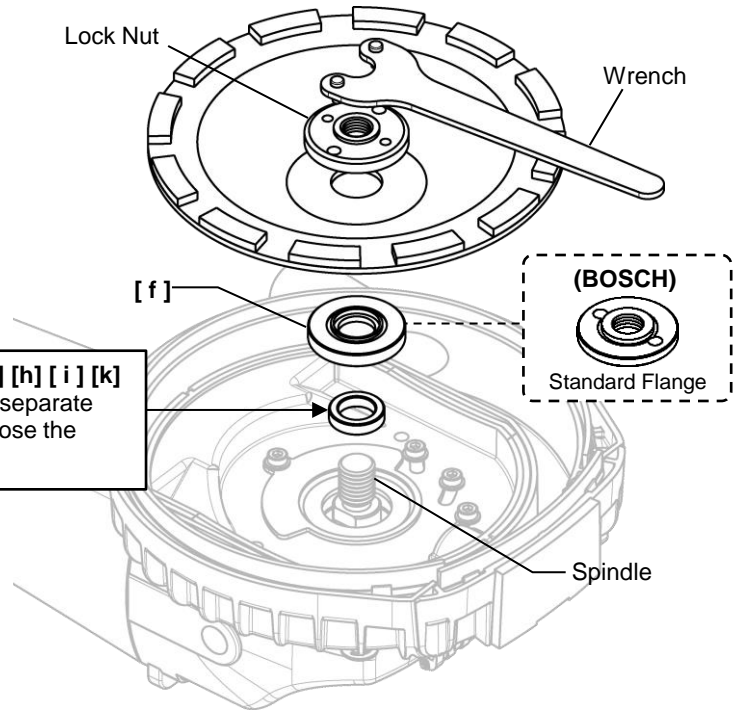

- (1) Set the proper Spacer [g] / [h] / [i] / [k] on the spindle.
- (2) Set [f] Base Flange on Spacer.  
==> BOSCH : Use its standard Flange.
- (3) Set the Grinding Cup on [f] Base Flange and tighten the Lock Nut by the Wrench.

9. Confirm the clearance (min.1mm) between the Grinding Cup and the material inside of the shroud.  
Replace the pre-set Brush into [d] Tall Brush if the height of the pre-set Brush is not enough. (Fig.13 and 14)

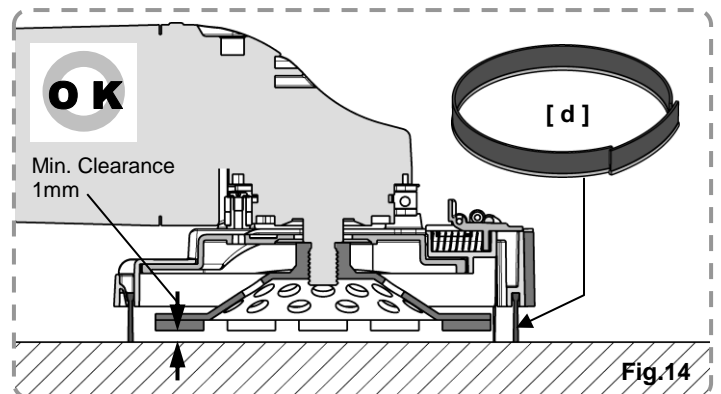
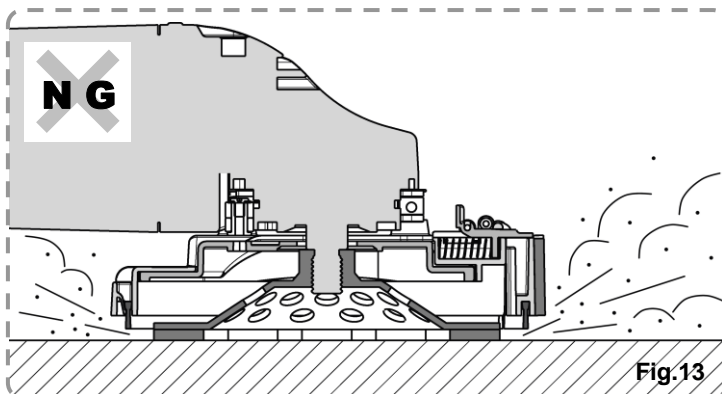

10. Fit the Handle to the angle grinder.
11. Connect the Vacuum Hose to the Duct of the [a] Main Body using [p] Hose Connector. (Fig.15)

**[CAUTION]**

Use the Vacuum with Input Power 1,500W or more for best possible performance and dust extraction.

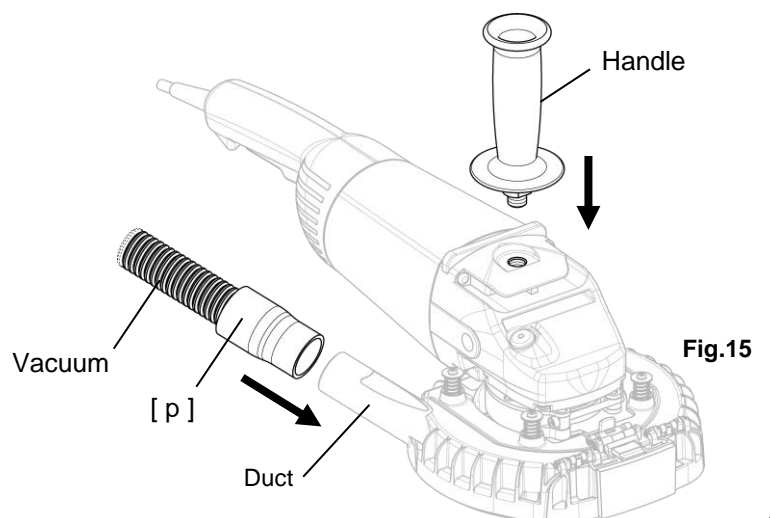



## GRINDING

1. Turn on the Vacuum.
2. Securely hold the Handle of the grinder.
3. Turn on the angle grinder.
4. Place the [a] Main Body on the material and slowly move over the surface to be ground. (Fig.16)

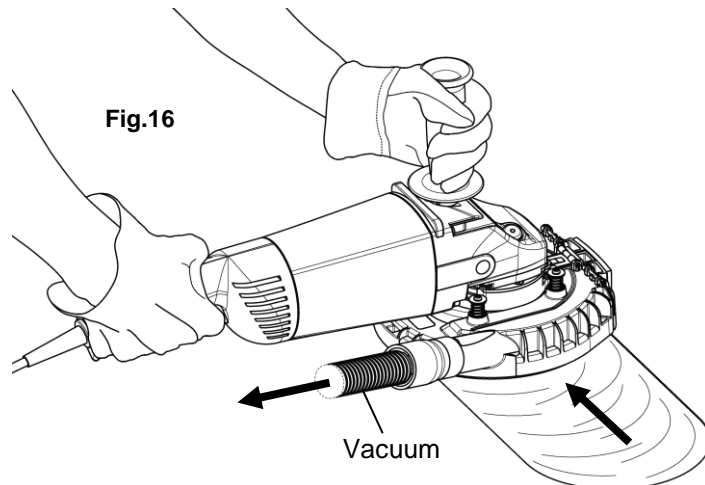
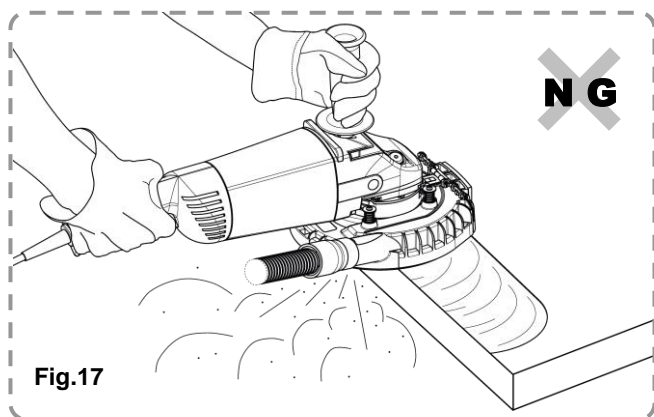

### [CAUTION]

Don't grind over the edge of the material as some dust could escape (Fig.17)

## CORNER GRINDING

1. Make sure that the angle grinder and Vacuum are turned off.
2. Lift the angle grinder away from the material.
3. Open the Front Lid by pulling the Slider. (Fig.18)

### [CAUTION]

The wheel dia. must be max.180mm to prevent the over grinding. (Fig.19)

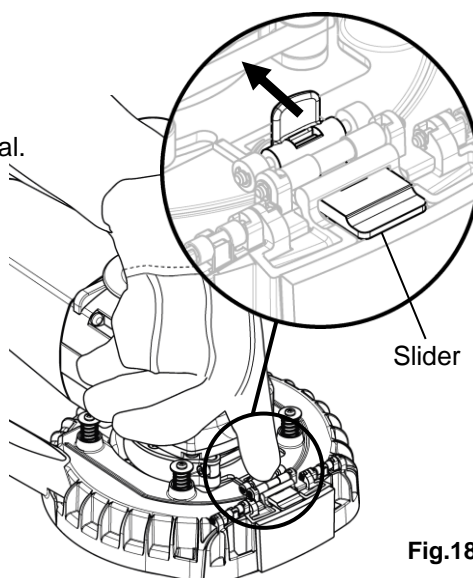
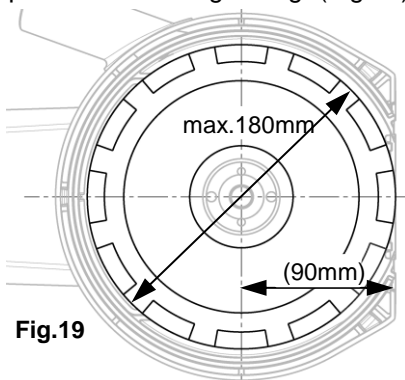

Fig.18

4. Turn on the Vacuum.
5. Turn on the angle grinder while ensuring the handle is gripped firmly.
6. Place [a] Main Body on the material and slowly move toward the grinding direction along the wall. (Fig.20)
7. Turn off the angle grinder and vacuum, then close the Front Lid. (Fig.21)

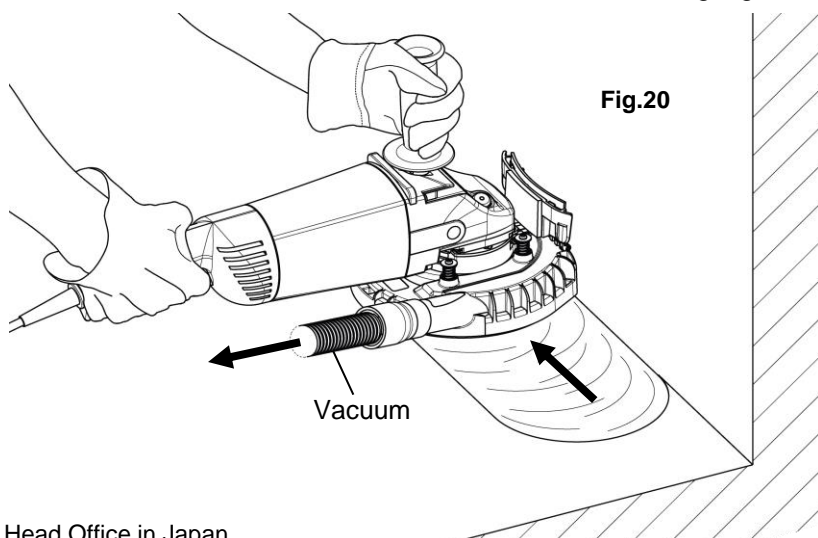

Fig.20

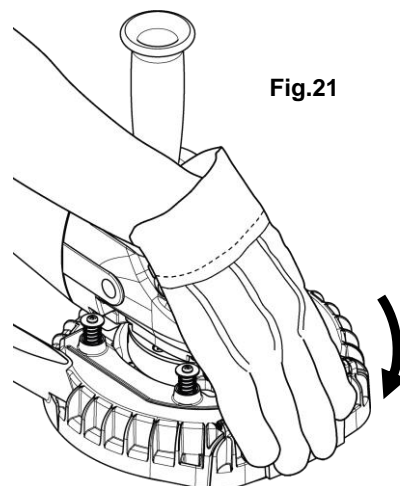

Fig.21

Head Office in Japan  
NAKAYA CO.,LTD.  
1313-92 Yanagisawa, Sanjo, Niigata, Japan



Nov-08. 2019

Eto Naoya  
Managing Director