

! WARNING

- Only use the correct connector for each angle grinder. If any connector does not fit correctly then DO NOT use the HURRICANE with this angle grinder.
- HURRICANE is only for grinding concrete, block, and tile. DO NOT use for grinding steel or other materials.
- HURRICANE is only for Diamond Cup Wheels. DO NOT use with abrasive wheels or other tools.
- Always check the HURRICANE for damage, cracks, or deformation before use. DO NOT use the HURRICANE if it is cracked, damaged or bent as this could lead to injury.
- Be sure to wear protective goggles, a dust mask, protective foot wear, earplugs and other protective equipment when working.
- Keep the HURRICANE away from gasoline, solvents, and paraffin.
- Ensure the grinding material is securely clamped before working.

SPECIFICATIONS

Model Code	NKC-125	
Suitable Tool	100mm - 125mm Diamond Cup Wheels.	
Weight	340g (Main Unit)	
Material	Concrete, Block, Tile, ...etc.	
Suitable Angle Grinders ※2014 models only.	HITACHI	G12SN, G12SQ, G12VA, G12SS, G12SA3, G12SR3, G13SN, G13SQ, G13YF, G13VA, G13SS, G13SB3, G13SR3
	MAKITA	9553NB, 9554NB, 9554NBKD, 9554NBKWX, 9555NB, 9557NB, 9557NBD, 9558NB, 9564CV, 9564H, 9564PCV, 9564PZ, 9565CV, 9565H, 9565PCV, 9565PZ, GA4530, GA4530KD, GA4534, GA5034
	BOSCH	GWS7-115, GWS7-115E, GWS8-115, GWS8-125, GWS10-125, GWS11-125CI, GWS11-125CIE, GWS14-125CI, GWS14-125CIE, GWS14-125CIT, GWS14-125Inox, GWS15-125CIH, GWS15-125CIEH, GWS15-125CITH
	DEWALT	D28113, D28113K, D28117, D28135K, DWE4050, D28065, D28134
	METABO	WEPBA14-125, WEBA14-125, WEPA14-125, WEP14-125, WEA14-125, WE14-125VS, WE14-125, WPA11-125, WP11-125, WBA11-125, WB11-125, WA11-125, W11-125, WE9-125, WP8-125, W8-125
	MILWAUKEE	AG8-115, AG8-125, AG9-125XC, AG9-125XE, AG12-125X, AGV12-125X, AGV12-125XPD, AGV15-125XC, AGV15-125XE
	FLEX	L3309/125, L3309FR, L3309FRG, L3410FR, L3410VR

OVER VIEW

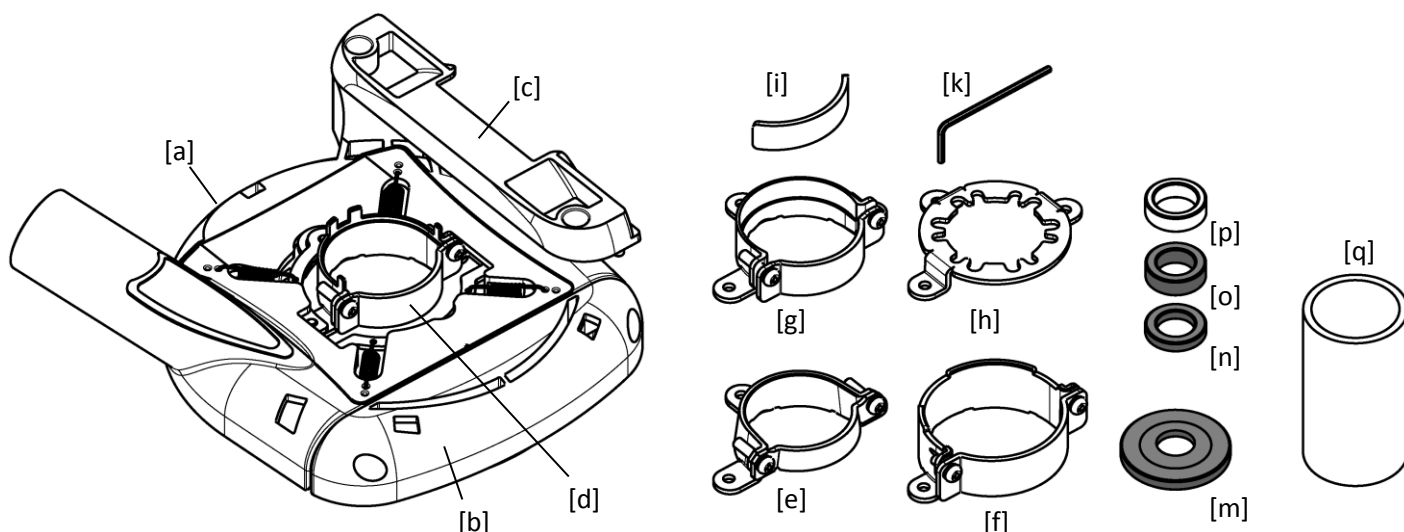

[a] Main Unit, [b] Sub Cover, [c] Half Cover, [d] M-Connector, [e] H-Connector, [f] B-Connector, [g] D-Connector, [h] F-Connector, [i] Collar, [k] Wrench, [m] Base Flange, [n] T4.5 Spacer, [o] T7.3 Spacer, [p] T7.3 x iD16 Spacer, [q] Hose Adapter.

PREPARATION

⚠ WARNING

- Be sure to turn off the angle grinder and remove the plug from the electrical outlet in advance.
- If the connector is loose and cannot be securely attached on the angle grinder, do NOT use HURRICANE in this state. otherwise it could lead to injury.

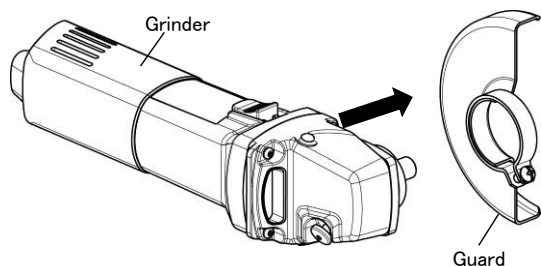



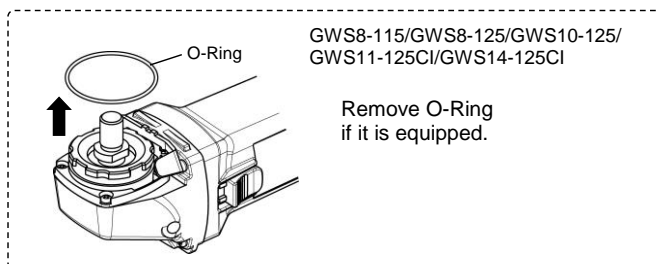





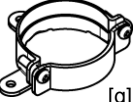

Take the Guard off from the Grinder.



INSTALLATION

1. Choose the correct components for Angle Grinder to be used, according to the following table.

Brand	HITACHI	DEWALT	FLEX	MILWAUKEE		MAKITA	BOSCH		METABO
Model	G13SR3/G13SB3 etc.	D28134 etc.	L3410FR etc.	AG8-125Q etc.	AG12-125X etc.	9558NB/9565CV/ GA4530 etc.	GWS8-125 etc.	GWS14-125CI etc.	WE14-125 Plus etc.
Connector	 [e]	 [g]	 [h]		 [d] (Factory Preset)			 [f]	
Collar	—								 [i]
Flange	 [m]				(Standard Flange)	 [m]			(Standard Flange)
Spacer *	—	 T7.3 ID16 [p]	—	 T4.5 [n]	—	—	 T4.5 [n]	 T7.3 [o]	—

* When using a diamond cup wheels with the height 21mm.

2. Change the Connector. (if needed)

- (1) Loosen the screws by [k] Wrench and remove the preset connector.

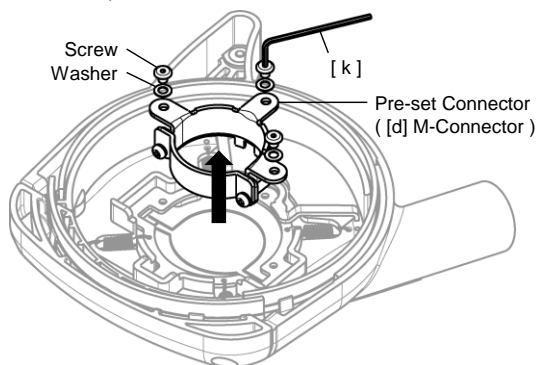

- (2) Set the correct Connector and tighten the screws. (Don't forget to fit the washers)

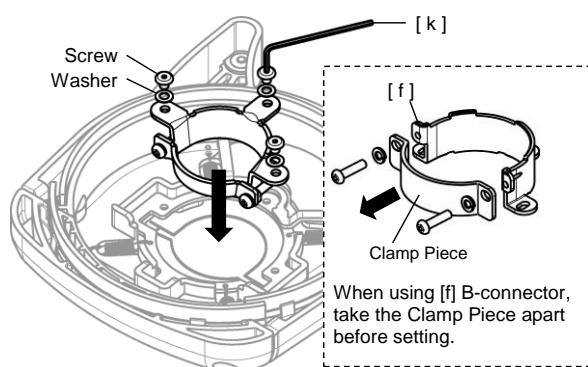

3. Fit on an Angle Grinder.

- Hold 3 points of the Connector and tighten the fitting screws. (2pls.)

⚠ WARNING

Make sure HURRICANE is securely attached, otherwise it may come loose, causing injury.

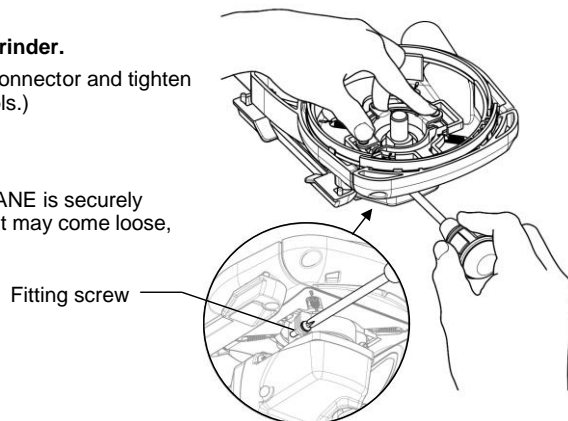

FLEX / Milwaukee (AG8/AG9 series)

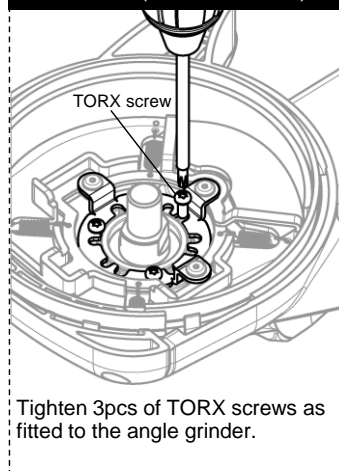

Metabo

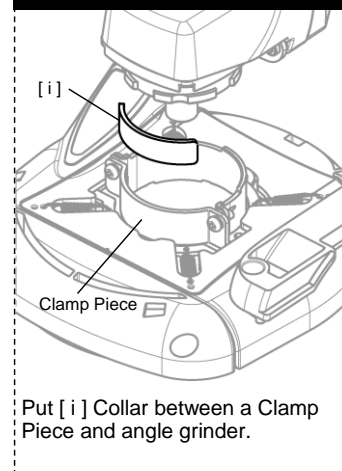

4. Set the Cup Wheel.

- (1) Fit the correct Spacer [n] [o] [p] onto the spindle.
- (2) Fit [m] Base Flange (or the standard flange from the angle grinder) onto the Spacer.
- (3) Fit the Cup Wheel onto the [m] Base Flange.
- (4) Fit the Wheel Nut onto the spindle.
- (5) Lock the spindle and securely tighten the Wheel Nut using the flange spanner supplied with the angle grinder.

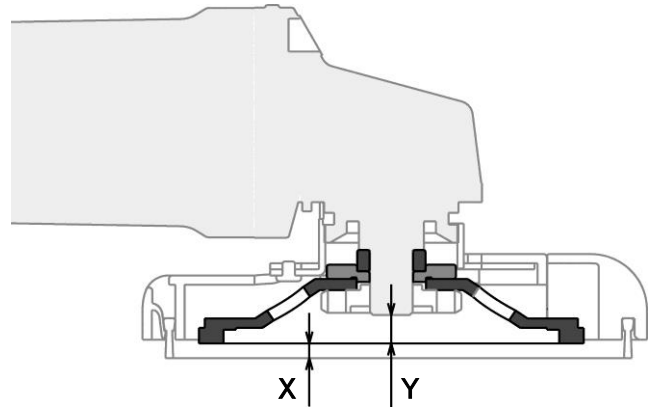
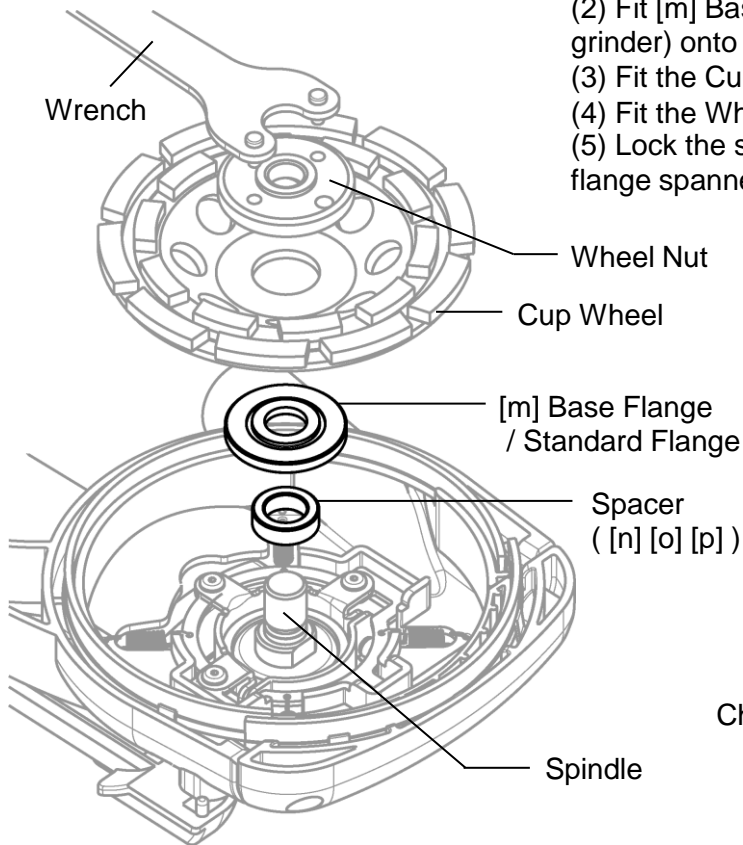

Choose correct Spacer which keep X and Y as below.

$$1 < X < 5$$

$$1 < Y$$

GRINDING

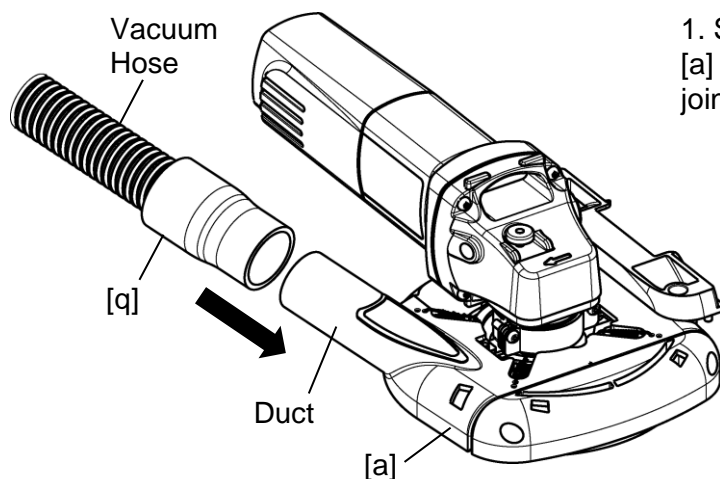

1. Securely connect the Vacuum Hose to the port of [a] Main Unit, using [q] Hose Adapter or other suitable joint between the port and Vacuum Hose.

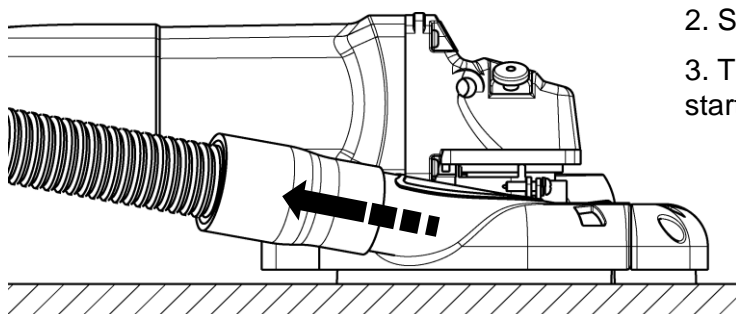

2. Securely hold the angle grinder body.
3. Turn the SW of vacuum and angle grinder on, then start the grinding work.

1. Loosen the screws of [a] Main Unit and remove [b] Sub Cover and [c] Half Cover.

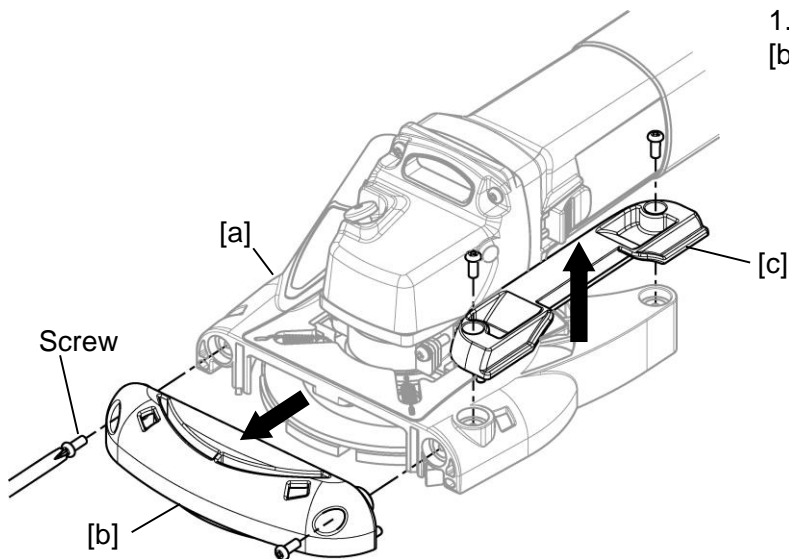

2. Switch the position of [b] Sub Cover and [c] Half Cover, then tighten screws to secure in position.

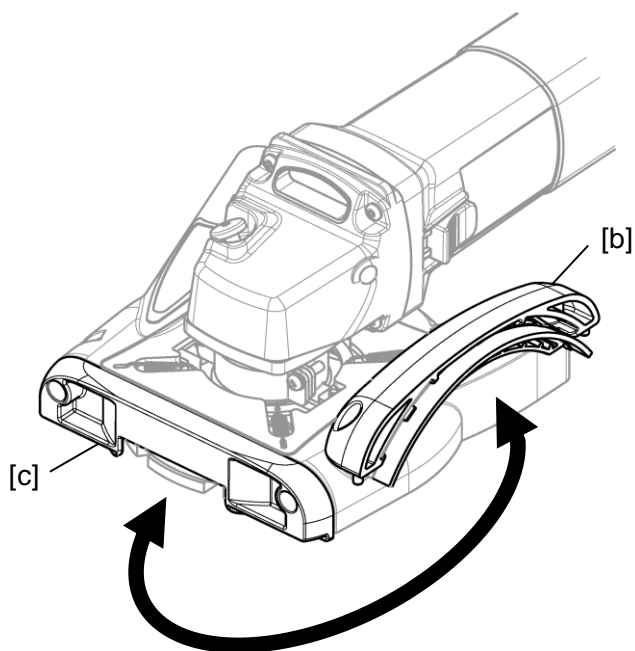

3. Start the grinding work in the same process of Page 3 "GRINDING".

* Keep the surface of [c] Half Cover in contact with the wall during work.

