

## ⚠ WARNING

- Securely use the correct connector for each angle grinder. If any connector does not fit on, DO NOT use the CYCLONE with this angle grinder.
- CYCLONE is only for cutting the concrete, block, and tile. DO NOT use for cutting the steel or other materials.
- CYCLONE is only for Diamond Cutting blades. DO NOT use with abrasive wheels or tipped saw blades.
- Always check the CYCLONE for damage, cracks, or deformations before use. DO NOT use the CYCLONE if it cracked, damaged or bent as this could lead to injury.
- Be sure to wear the protective goggles, a dust mask, protective foot wear, earplugs and other protective equipment when working.
- Keep the CYCLONE away from gasoline, solvents, and paraffin.
- Ensure the cutting material securely clamped before cutting.

## SPECIFICATIONS

Model Code	NK-125CY	
Attachable Blade	115-125mm / T1.5-2.2mm Diamond Blades.	
Cut Depth	5-33mm (125mm Blade)	
Weight	550g (Main Unit)	
Cut material	Concrete, Block, Tile, ...etc.	
Attachable Angle Grinders	HITACHI	G12SA3, G12SE2, G12SN, G12SR3, G12SS, G12VA, G13SC2, G13SN, G13SP, G13VA, G18DL
	MAKITA	9557NB, 9557PB, 9558PB, 9564CV, 9564P, 9564PC, 9565CV, 9565PC, GA4530, GA4534
	BOSCH	1380SLIM, 1375A
	DEWALT	DWE4120(N), DWE4011, D28402N, D28112, D28110, D28402, D28114(N), D28131, D28140, D28144(N), D28065(N), D28115(N)
	MILWAUKEE	6117-30, 6117-31, 6117-33, 6117-33D, 6146-30, 6146-31, 6146-33, 6147-30

## OVER VIEW

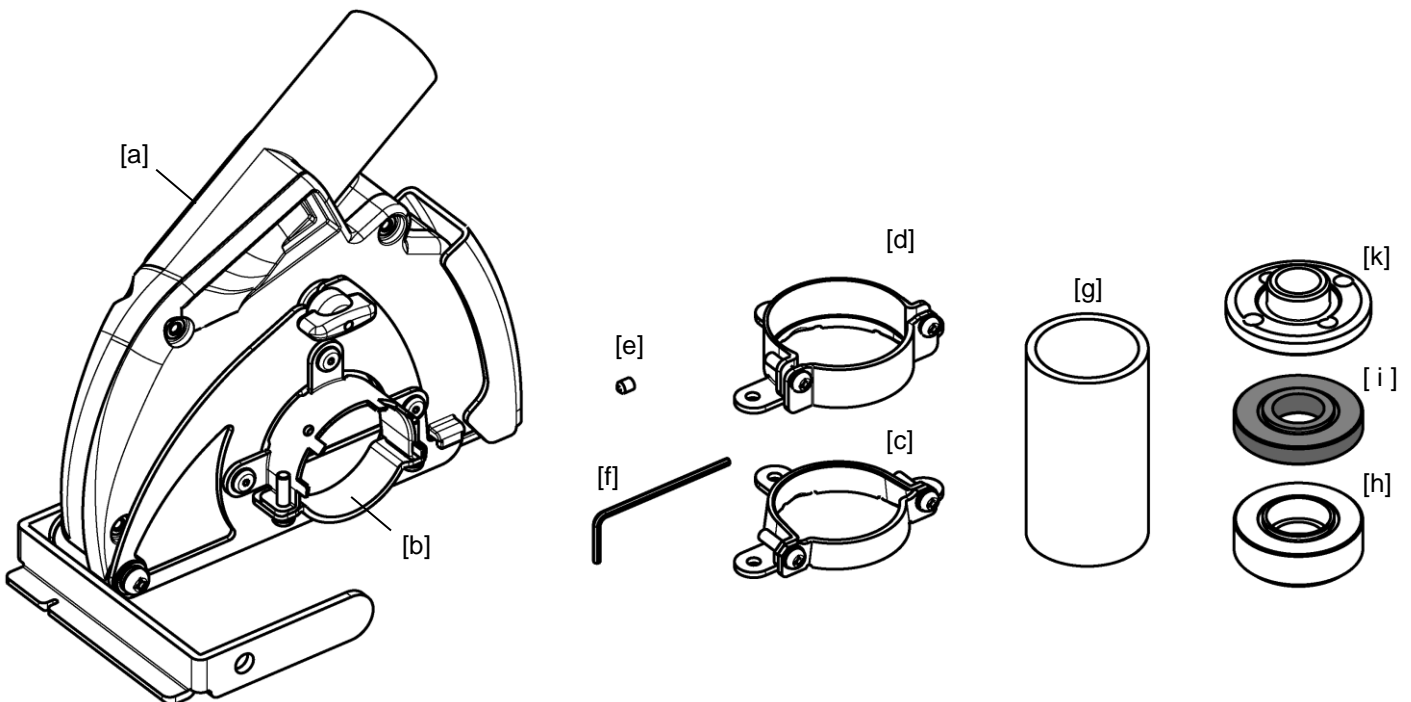

[a] Main Unit, [b] M-Connector, [c] H-Connector, [d] D-Connector, [e] Set Screw, [f] Wrench, [g] Hose Adapter  
[h] Flange (A), [i] Flange (B), [k] Lock Nut

## PREPARATION

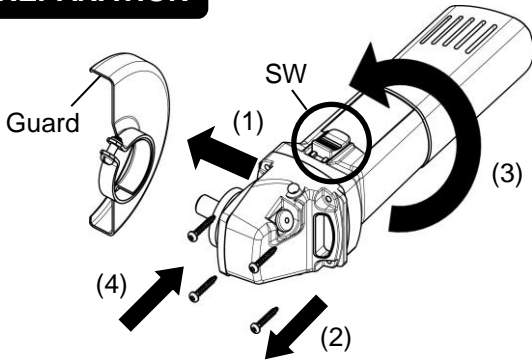

- (1) Take the Guard off.
- (2) Remove the Screws.
- (3) Turn the Grinder Body to locate the SW upper position.
- (4) Tighten the Screws again.

### ⚠ WARNING

- Be sure to turn off the angle grinder and remove the plug from the electrical outlet in advance.
- If the connector is loose and cannot be securely attached on the angle grinder, do NOT use CYCLONE in this state. Otherwise it could lead to injury.

## INSTALLATION

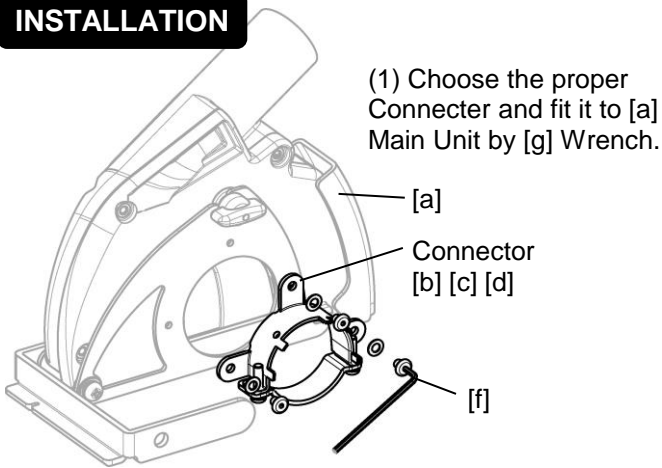

- (1) Choose the proper Connector and fit it to [a] Main Unit by [g] Wrench.

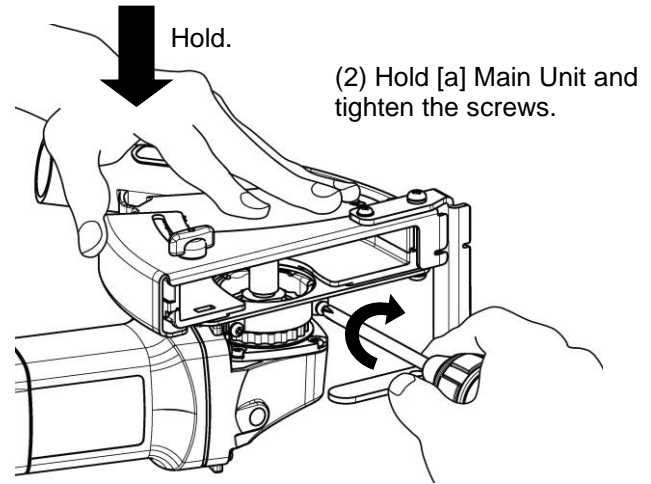

- (2) Hold [a] Main Unit and tighten the screws.

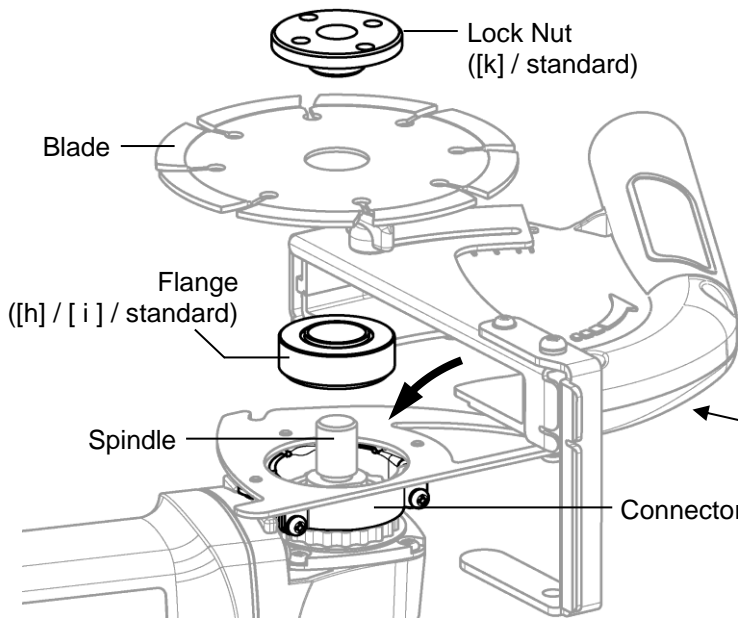

- (3) Release Thumb Screw and open [a] Main Unit.
- (4) Set the Flange ([h] / [i] / standard) on the Spindle.
- (5) Set the Blade on Flange.
- (6) Set the Lock Nut ([k] / standard) on the Blade.
- (7) Tighten the Lock Nut securely.

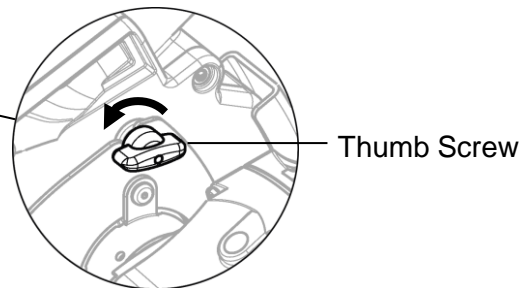

Brand	HITACHI	MAKITA	MILWAUKEE	BOSCH	DEWALT
Model	G12SA3 etc.	9557NB etc.	6146-30 etc.	1380SLIM etc.	DWE4011 etc.
Lock Nut	(Standard)			[k]	
Flange	(Standard)	[i]		[h]	
Connector	[c]	[b] (Factory Preset)		[d]	

## BOSCH GRINDERS

When using BOSCH grinders (1380SLIM / 1375A), tighten [e] Set Screw into a hole of [b] M-Connector by [f] Wrench after installation to prevent the slip of the Gearbox housing.

### ⚠ CAUTION

Do NOT over tighten [e] Set Screws or they could cause damage or deformation to the Gearbox housing and Connector.

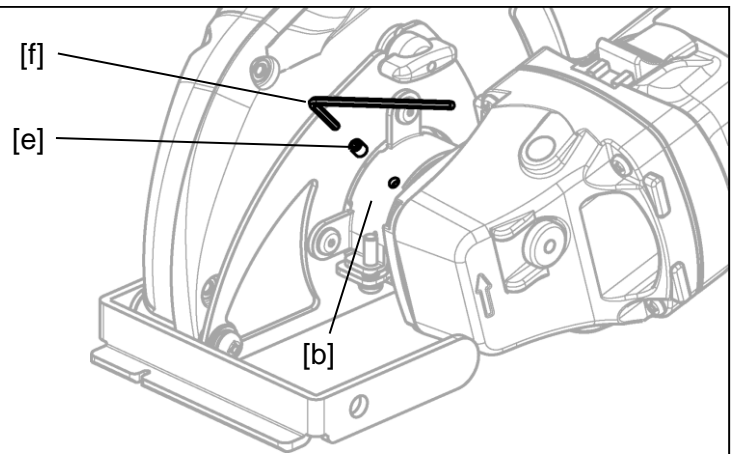

### ⚠ CAUTION

Make sure [a] Main Unit is securely attached without a tilt, otherwise it may come loose, causing injury.

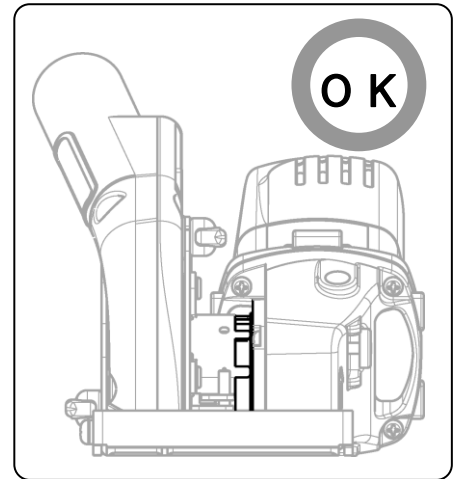
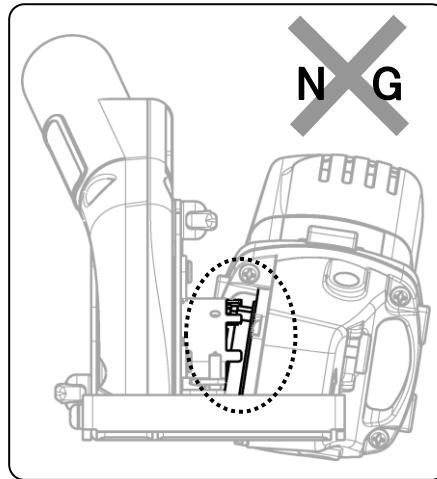

### ⚠ CAUTION

Adjust the Base position to cancel the projection of Gear Head of the Angle Grinder, if required.

→ Refer to "DEPTH ADJUSTMENT" instruction at page 4.

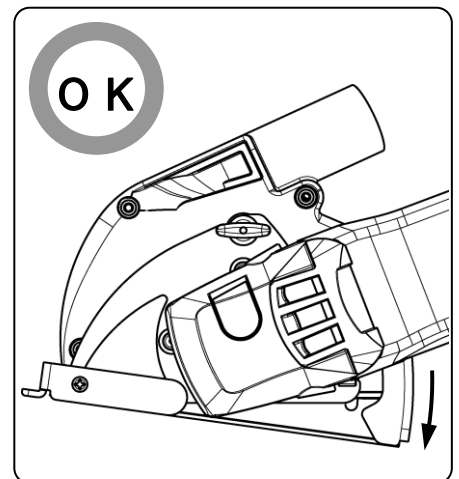
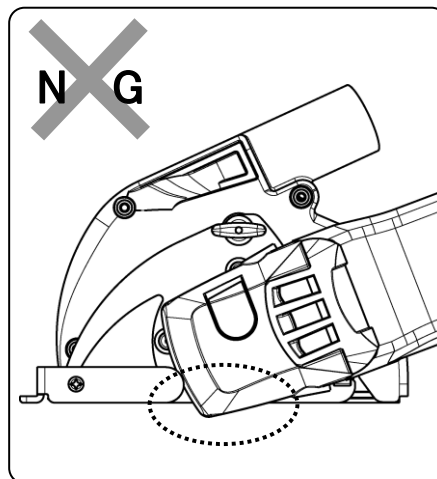

## FINALIZING

Close [a] Main Unit and tighten the Thumb Screw.

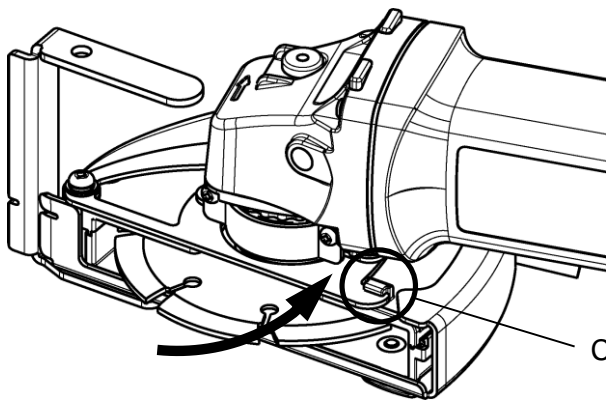

Thumb Screw

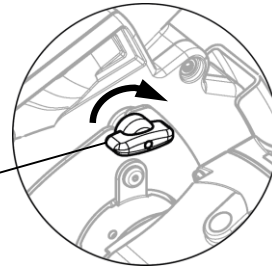

Confirm the hook securely holds the steel plate.

## CUTTING

Securely connect the Vacuum Hose to the Duct of [a] Main Unit by [g] Hose Adapter, then turn the Vacuum and Angle Grinder on and start cutting.

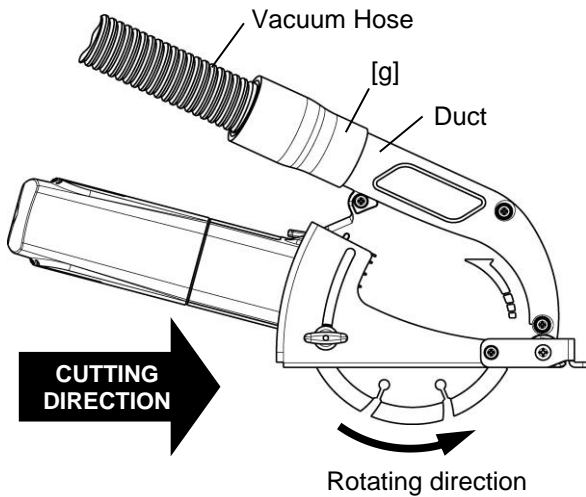

### [CAUTION]

1. Make sure the blade is rotating in the right direction.
2. Ensure no gaps between the material and bottom surface of [a] Main Unit, otherwise the dust could escape.

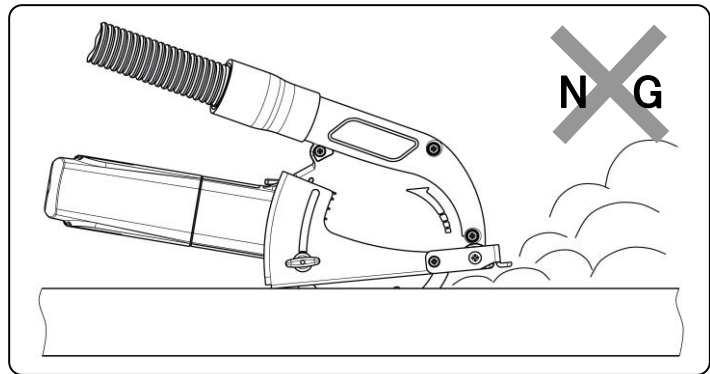

## DEPTH ADJUSTMENT

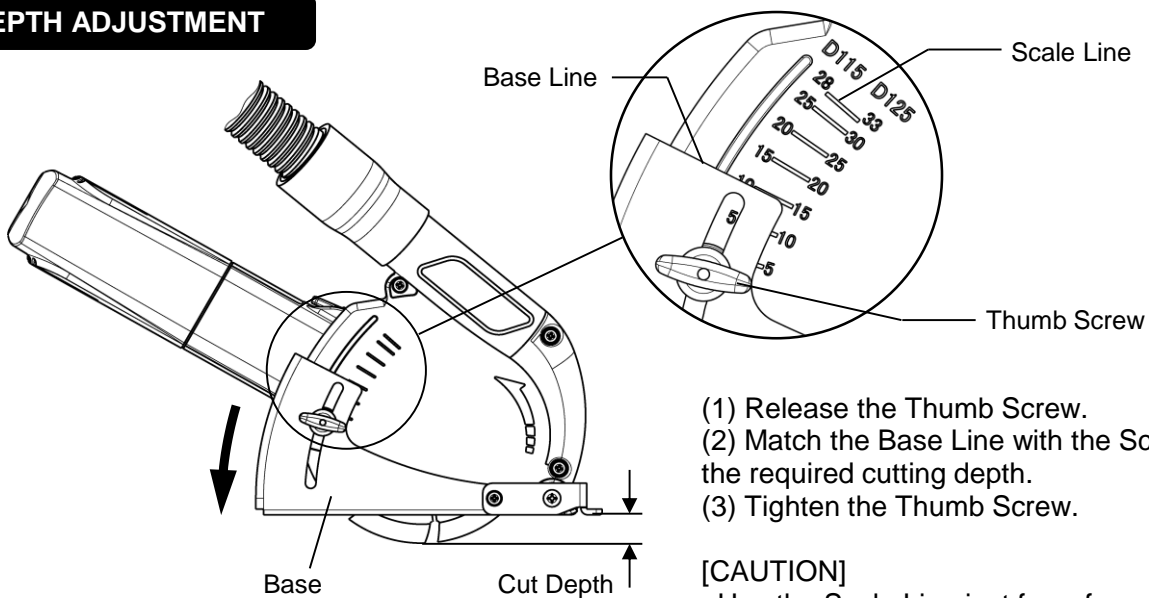

- (1) Release the Thumb Screw.
- (2) Match the Base Line with the Scale Line of the required cutting depth.
- (3) Tighten the Thumb Screw.

### [CAUTION]

Use the Scale Line just for reference.

Head Office in Japan  
NAKAYA CO.,LTD.  
1313-92 Yanagisawa, Sanjo, Niigata, Japan



July-29 2014

Eto Naoya  
Managing Director