

⚠ WARNING

- DO NOT use the NKC-150A with the angle grinder which can NOT be fitted correctly instructed by this manual.
- NKC-150A is only for grinding concrete and block. DO NOT use for grinding steel or other materials.
- NKC-150A must be used with the Vacuum suitable for the concrete dust.
- NKC-150A is only for 150mm Diamond Grinding Cup Wheels. DO NOT use with abrasive wheels.
- Always check the NKC-150A for damage, cracks, or deformation before use.
- DO NOT use the NKC-150A if it is cracked, damaged or bent as this could lead to injury.
- Be sure to wear the protective goggles, dust mask, protective foot wear, earplugs and other protective equipment when working.
- Keep NKC-150A away from gasoline, solvents, and paraffin.
- Ensure the work piece is securely clamped before working.

Explanation of the pictograms.



General Warning.



Read the operating instructions before use.



Wear eye protection.



Wear breathing protection.



Wear ear protection.



Wear protective gloves.

SPECIFICATIONS

Model Code	NKC-150A	
Suitable Tool	ø150mm (h21mm) Diamond Grinding Cup Wheel	
Weight	650g (Main Unit with adaptor system)	
Work material	Concrete, Block.	
Suitable Angle Grinders	MAKITA	GA6040C, GA035GZ, GA036GZ
	BOSCH	GWS17-150S, GWS17-150C, GWS19-150CI
※Based on the web as of 2022 Jun.	MILWAUKEE	M18FHSAG150, AGV17-150, AGV15-150
	METABO	WEPBA19-150, WEPBA17-150, WEA17-150, WEV17-150, WEP17-150, WE17-150, W13-150
	HIKOKI	G15VAWKZ, G15YC2LBZ

OVER VIEW

[a] Main Unit / [b] Lock Nut / [c] Flange / [d] Spacer T12 x id16 & 14.3 / [e] Spacer T10 x id14.3 / [f] Spacer T7 x id14.3 / [g] B-Connector / [i] M-Connector / [k] H-Connector / [m] Collar / [p] Wrench / [r] Hose Adaptor

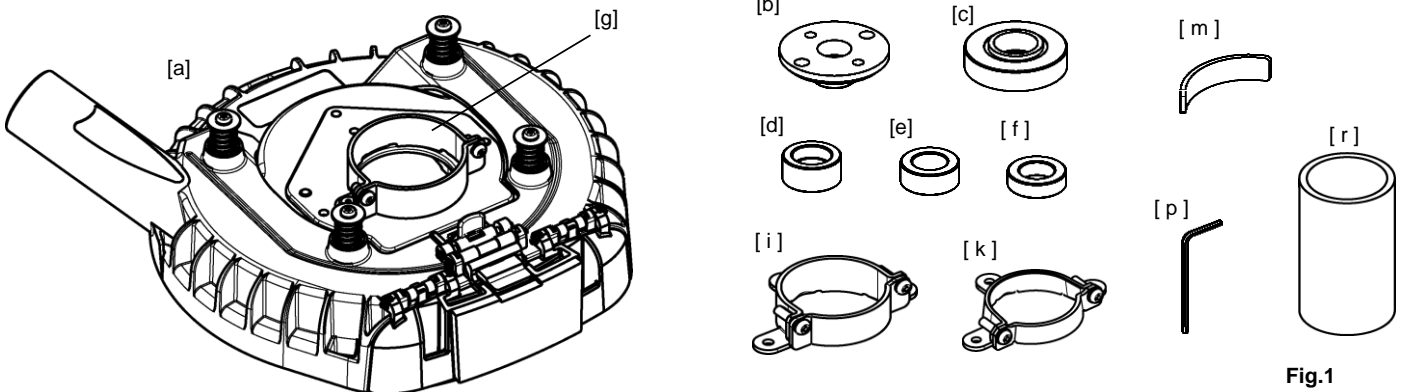

Fig.1

INSTALLATION

⚠ WARNING

- Be sure to turn off the Angle Grinder and remove the plug from the electrical outlet in advance.
- If the connector is loose and cannot be securely attached on the angle grinder, do NOT use NKC-150A in this state. otherwise it could lead to injury.

1. Detach the Guard from the Angle Grinder.(Fig.2)

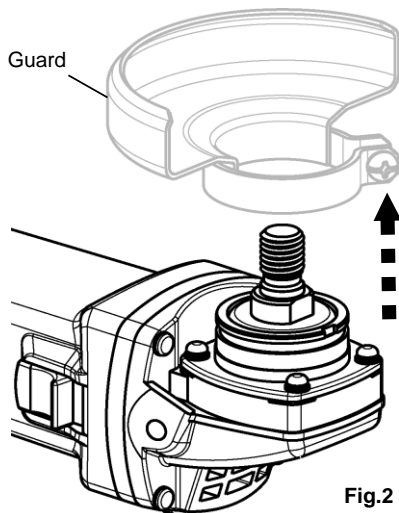

Fig.2

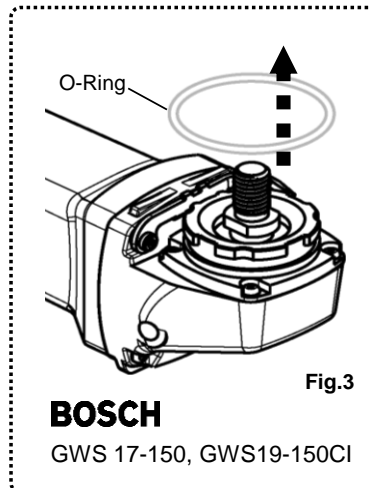

Fig.3

BOSCH

GWS 17-150, GWS19-150CI

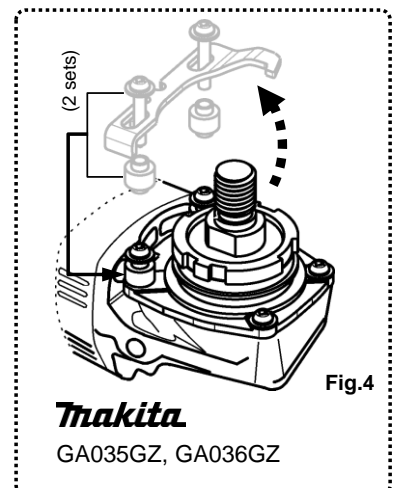



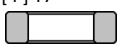

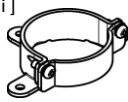



Fig.4

Makita

GA035GZ, GA036GZ

⚠ Above grinder needs its lever and related components detached.(Fig.3)(Fig.4)

2. Choose the correct components for the Angle Grinder to be used, according to the following table.

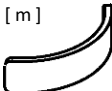
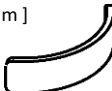
Brand	<i>Makita</i>	<i>Milwaukee</i>		<i>HiKOKI</i>	<i>metabo</i>		BOSCH
Model	GA6040C GA035GZ GA036GZ	AGV15-150 M18FHSAG150	AGV17-150	G15VAWKZ G15YC2LBZ	WEPBA17-150 WEPBA19-150 WEA17-150	WEV17-150 WEP17-150 WE17-150 W13-150	GWS17-150C GWS17-150S GWS19-150CI
Spacer	[e] T10 		[f] T7 		[e] T10 		[d] T12 
Connector	[i] 	[g] 	[k] 	[g] 			
Collar	—		[m] 	—		[m] 	—

3. Change the Connector.(if needed)

(1) Loosen the screws by [p] Wrench and remove the preset connector.(Fig.5)

(2) Set the correct Connector and tighten the screws.(Fig.6)

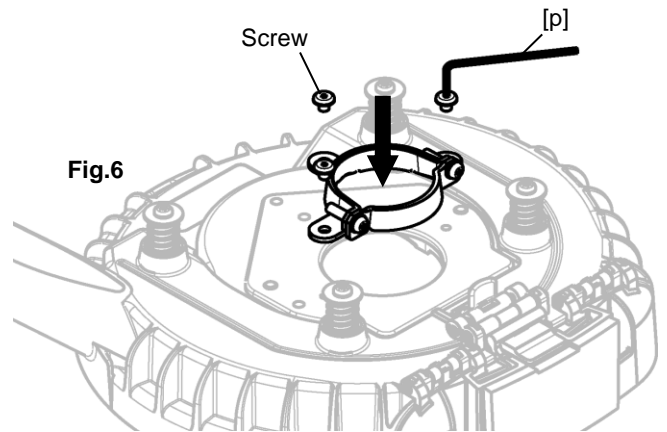
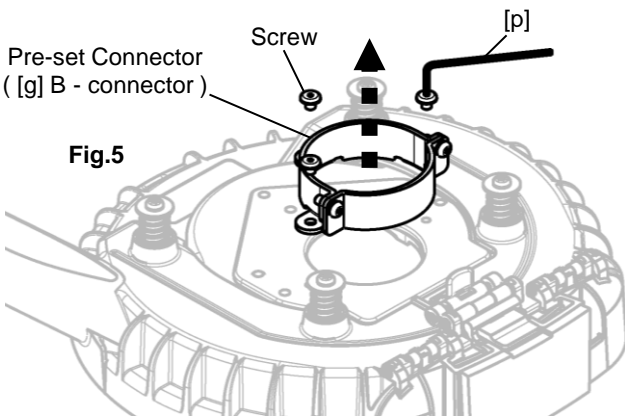

4. Fit [a] Main Unit on the Angle Grinder.

(1) Hold [a] Main Unit and tighten the Fitting Screw.(Fig.7)

! WARNING

Make sure [a] Main Unit is securely attached, otherwise it may come loose, causing injury.

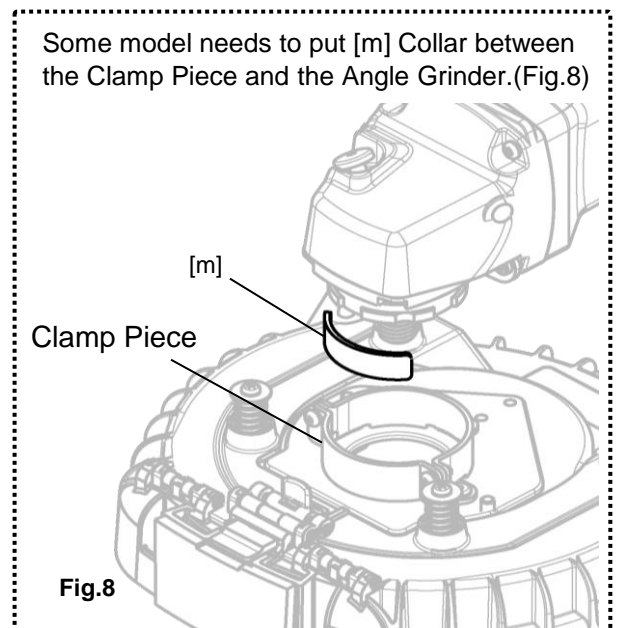
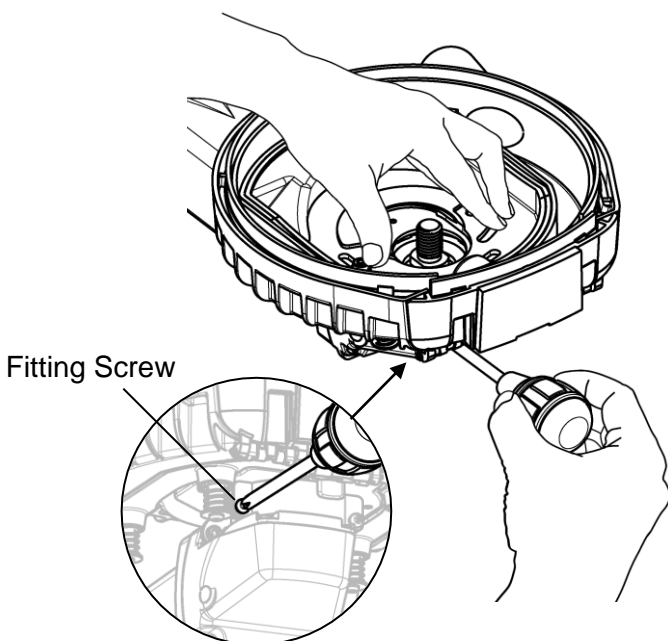

Fig.7

Fig.8

5. Match the center line of [a] Main Unit and the Angle Grinder.(Fig.9)(Fig.10)

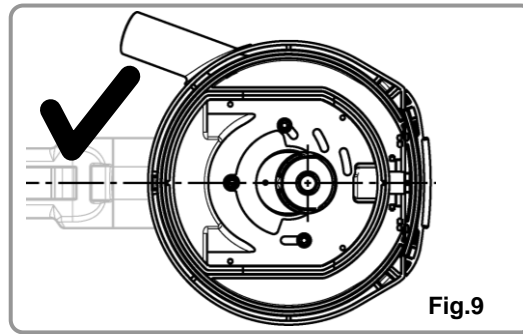

Fig.9

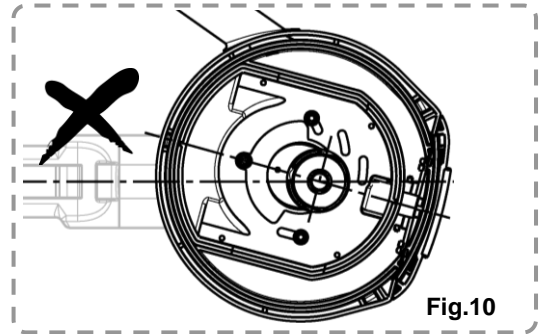

Fig.10

Make sure the [a] Main Unit is NOT tilt.(Fig.11)(Fig.12)

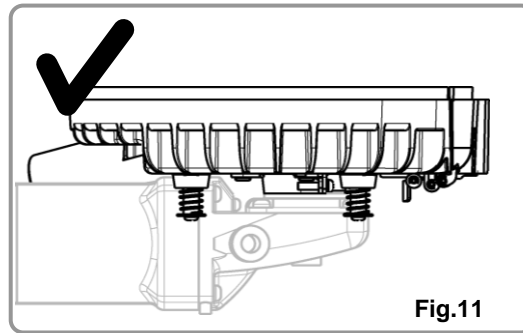

Fig.11

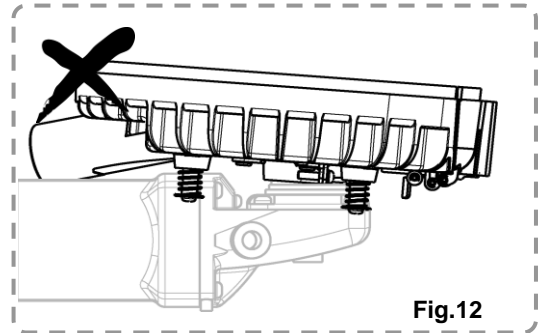

Fig.12

6. Set the Cup Wheel.(Fig.13)

- (1) Fit the correct Spacer [d] [e] [f] onto the Spindle.
- (2) Fit [c] Flange onto the Spacer.
- (3) Fit the Cup Wheel onto the [c] Flange.
- (4) Fit the [b] Lock Nut onto the spindle.
- (5) Lock the Spindle and securely tighten the [b] Lock Nut using the Wrench supplied with the Angle Grinder.

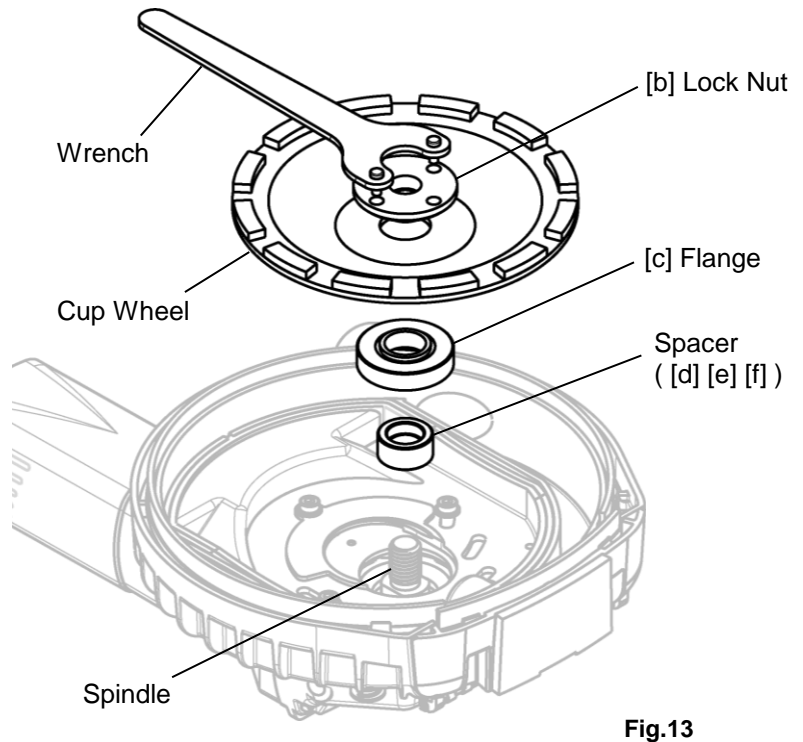

Fig.13

Make sure to keep the clearance (min. 1mm) between the Cup Wheel and the material. (Fig.14)

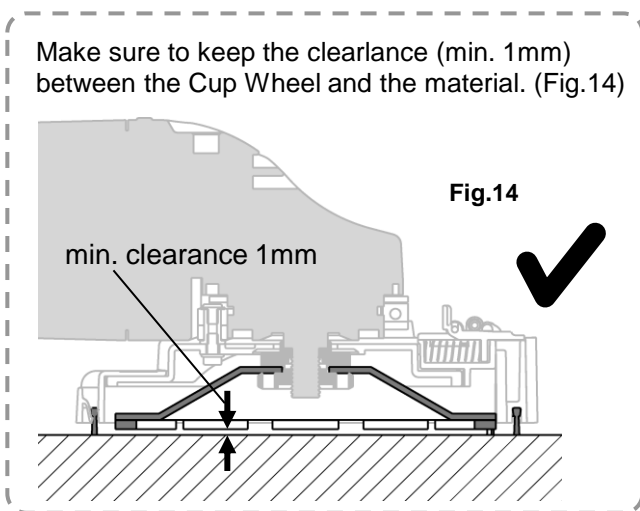

Fig.14

7. Fit the Handle to the Angle Grinder.

8. Connect the Vacuum Hose to the Duct of the [a] Main Unit using [r] Hose Adaptor.(Fig.15)

[CAUTION]

Use the Vacuum with Input Power 1,500W or more for best possible performance and dust extraction.

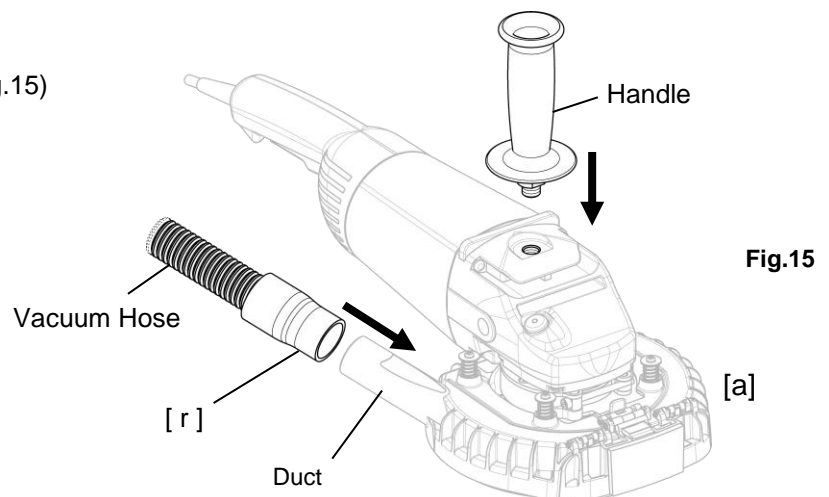

Fig.15

GRINDING

1. Turn on the switch of the Vacuum.
2. Securely hold the Handle of the Angle Grinder.
3. Turn on the switch of the Angle Grinder.
4. Place the [a] Main Unit on the material and move slowly over the surface to be ground. (Fig.16)

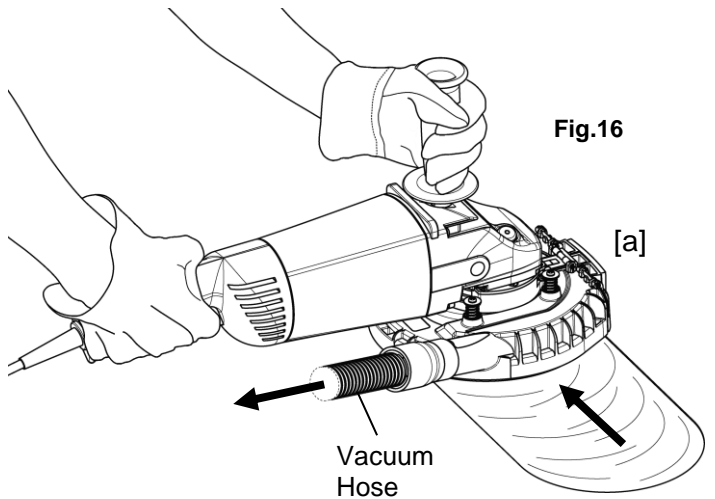

Fig.16

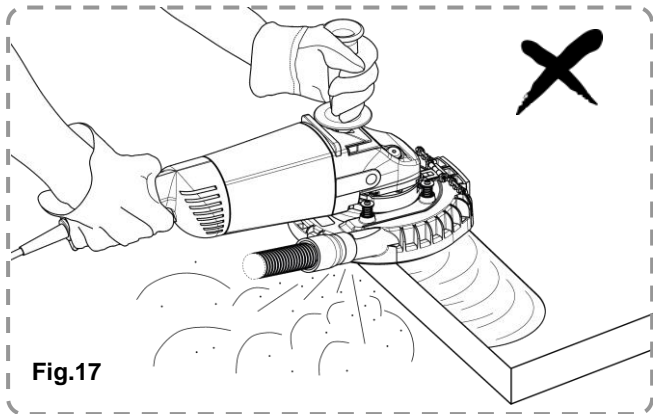

Fig.17

[CAUTION]

Don't grind over the edge of the material as some dust could escape (Fig.17)

CORNER GRINDING

1. Make sure that the angle grinder and Vacuum are turned off.
2. Lift the angle grinder away from the material.
3. Open the Front Lid by pulling the Slider. (Fig.18)
4. Turn on the Vacuum.
5. Turn on the Angle Grinder while ensuring the handle is gripped firmly .
6. Place [a] Main Unit on the material and slowly move toward the grinding direction along the wall. (Fig.19)
7. Turn off the Angle Grinder and Vacuum, then close the Front Lid. (Fig.20)

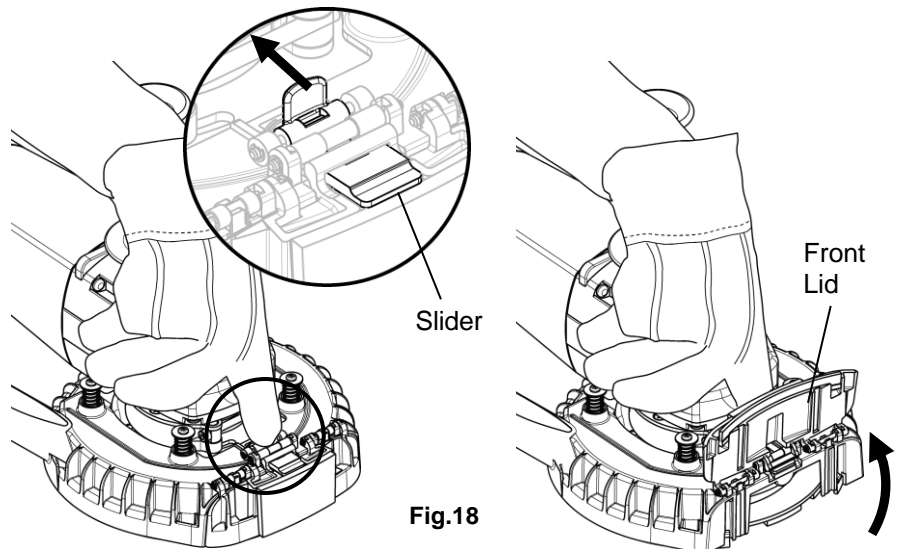

Fig.18

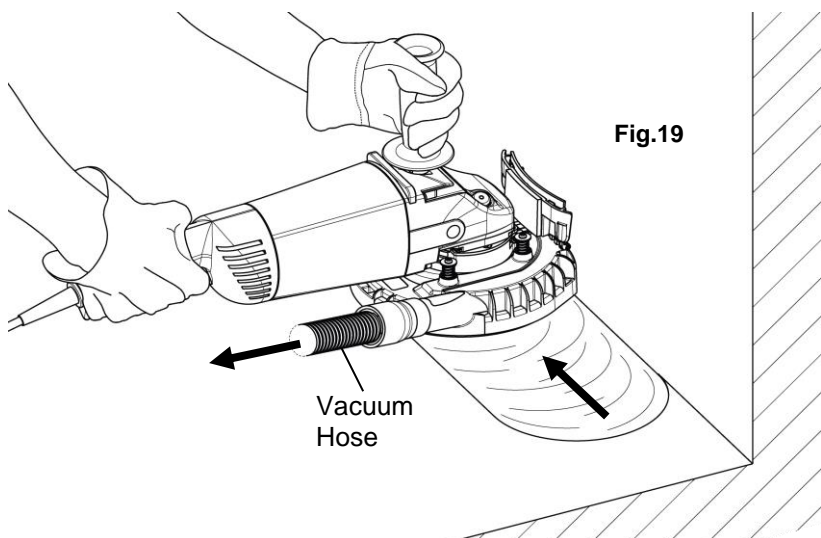

Fig.19

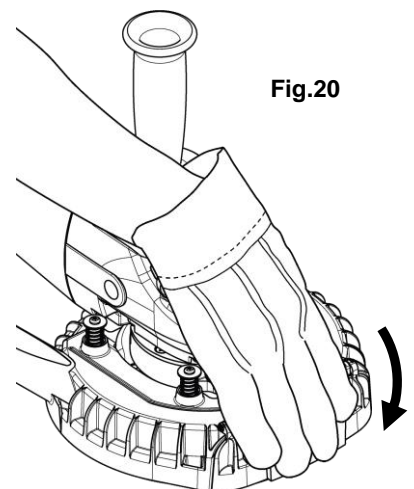

Fig.20