

### ⚠ WARNING

- DO NOT use the DUST TANK with the angle grinder which can NOT be fitted correctly instructed by this manual.
- DUST TANK is only for cutting concrete, block, and tile. DO NOT use for cutting steel or other materials.
- DUST TANK must be used with the Vacuum suitable for the concrete dust.
- DUST TANK is only for Diamond cutting blades. DO NOT use with abrasive wheels or tipped saw blades.
- Always check the DUST TANK for damage, cracks, or deformation before use.
- DO NOT use the DUST TANK if it is cracked, damaged or bent as this could lead to injury.
- Be sure to wear the protective goggles, dust mask, protective foot wear, earplugs and other protective equipment when working.
- Keep DUST TANK away from gasoline, solvents, and paraffin.
- Ensure the cutting material securely clamped before cutting.

### Explanation of the pictograms.



General Warning.



Read the operating instructions before use.



Wear eye protection.



Wear breathing protection.



Wear ear protection.



Wear protective gloves.

## SPECIFICATIONS

Model Code	NK-230	
Suitable Blade	180-230mm / T2-3mm Diamond Blades.	
Cut Depth	5-60mm (230mm Blade)	
Weight	2.2kg (Main Unit with adaptor system)	
Cut material	Concrete, Block, Tile, ...etc.	
Suitable Angle Grinders	BOSCH	GWS20-230H, GWS22-230H, GWS22-230JH, GWS22-230LV, GWS24-230H, GWS24-230JH, GWS24-230BV, GWS24-230LVI, GWS24-230JVX, GWS26-230JH, GWS26-230JBV, GWS26-230LVI
	MAKITA	GA9020 / 9030 / 9040 series.
	HiKOKI	G23MRU, G23UBY, G23SEY, G23SCY, G23SC3, G23SR, G23SRU, G23SW2, G23SWU, G23UC, G23UCY, G23UDY
	Milwaukee	AG22-230, AG22-230E
	DEWALT	DWE494, DWE490, DWE492, D-28490, D-28492, D-28498, DWE4559, DWE4579, DWE4599
	Metabo	WE24-230MVT, W22-230MVT, WE22-230MVT, W24-230MVT, W26-230MVT, WE26-230MVT, WX22-230, W24-230
	FLEX	L21-6 230, L24-6 230, L26-6 230

## OVER VIEW

[a] Main Unit / [b] Mount Ring / [c] Adaptor / [d] Centering Holder / [e] Flange Bolt / [f] Base Flange  
 [g] Spacer T3.4 / [h] Spacer T6.0 / [i] Spacer T7.5 / [k] Spacer T9.4 / [m] Spacer T10.6  
 [n] Bolt (L60) / [o] Bolt (L45) / [p] Hex Wrench / [q] Swing Duct / [r] Vacuum Joint / [s] DW plate

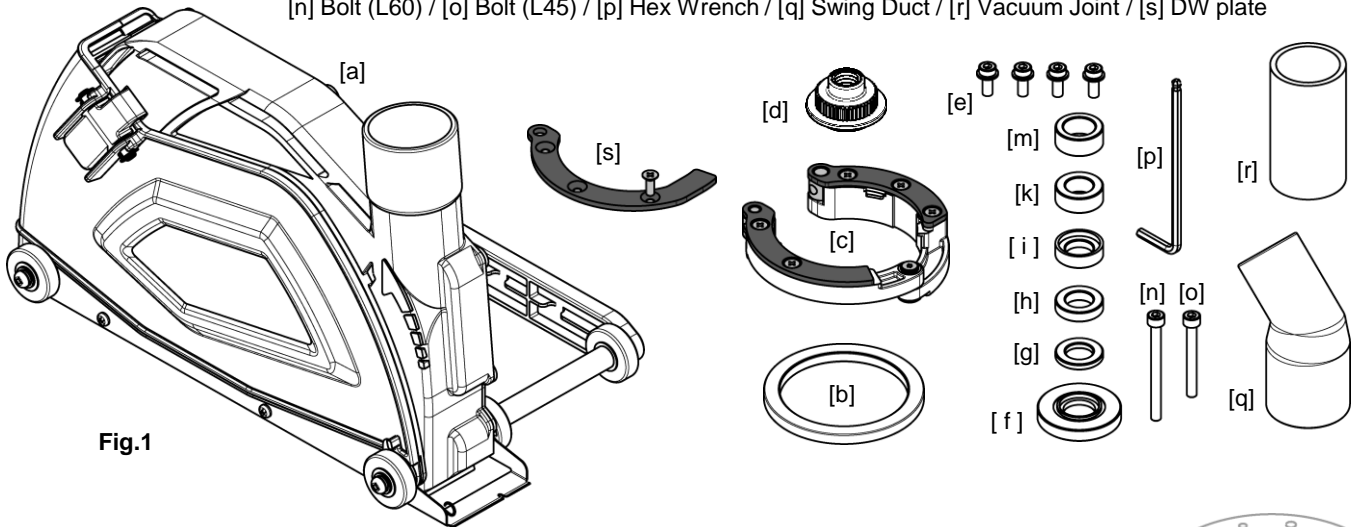

Fig.1

## PREPARATION

**1. [Metabo / Dewalt DWE4579 type]**  
 Remove the Lever unit and O-ring (WX22-230 and W24-230 only), then set [b] Mount Ring on the Gear Case. (Fig.2)

**2. Set [c] Adaptor around the Gear Case with the Hooks securely stored into the groove at Gear Case. (Fig.3)**

\* Exchange the bottom plate of [c] into [s] when using Dewalt DW4579 type.

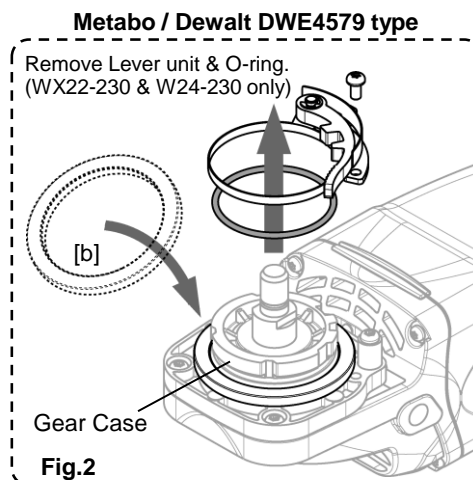

Fig.2

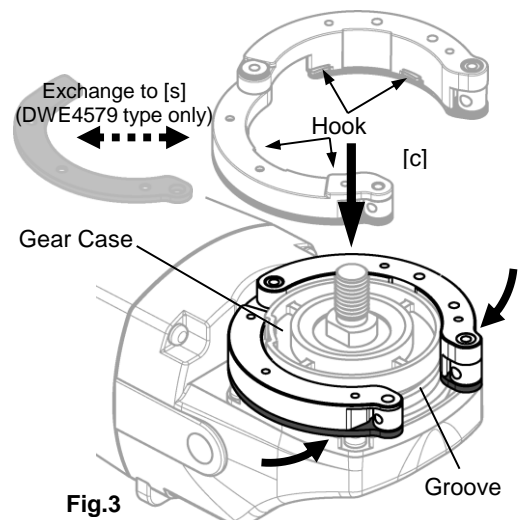
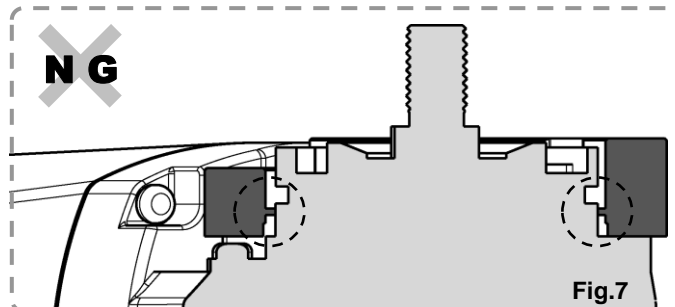
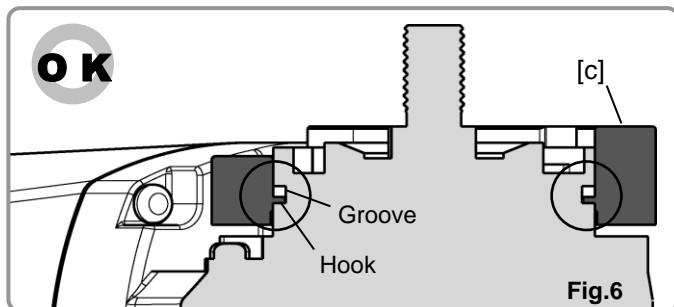
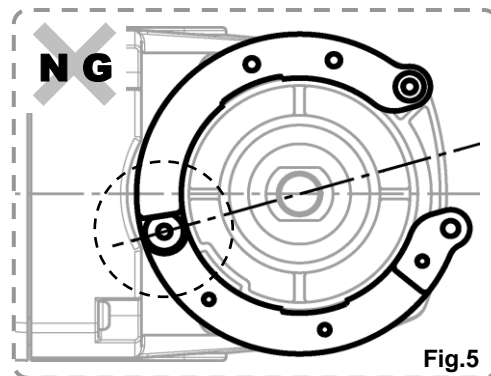
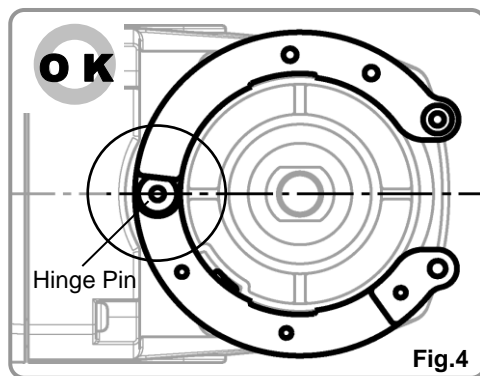

Fig.3

3. Set the position of the Hinge Pin on the center line of the angle grinder.  
(Fig.4 and 5)

4. Confirm the Hooks securely stored into the groove at the Gear Case.  
(Fig.6 and 7)



## INSTALLATION

1. Hold [c] Adaptor with the down-force.
2. Tighten [n] / [o] Bolt by [p] Hex Wrench to clamp the gear case.  
[n] Bolt (L60) : for BOSCH  
[o] Bolt (L45) : for Others

\* Make the [n] [o] Bolt head facing the Flat Surface of [c] Adaptor.

(Fig.8)

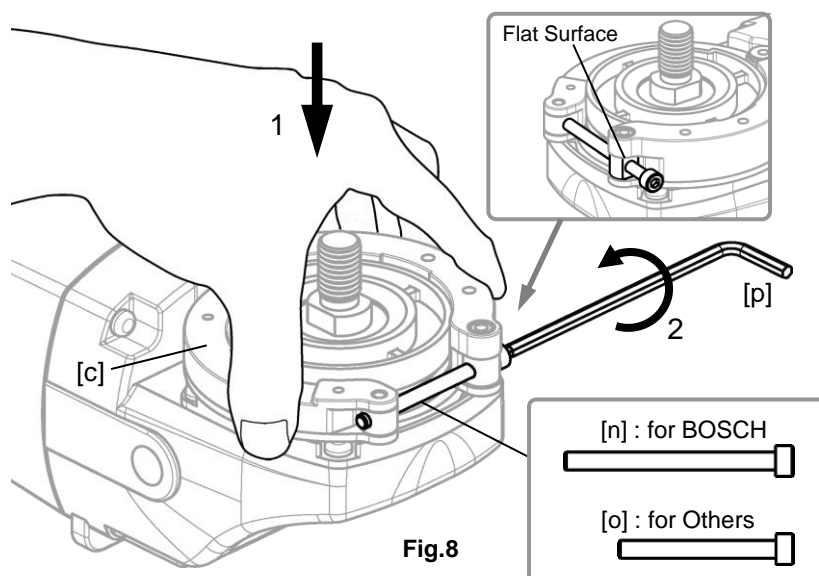

3. Push the Lever.
4. Open the Lower Base.
5. Place [a] Main Unit on [c] Adaptor.
6. Screw [d] Centering Holder into the spindle of the angle grinder to fix [a] Main Unit and [c] Adaptor temporary.
7. Match the position of the Hole at [a] Main Unit and the Screw hole at Hinge Pin of [c] Adaptor.

(Fig.9)

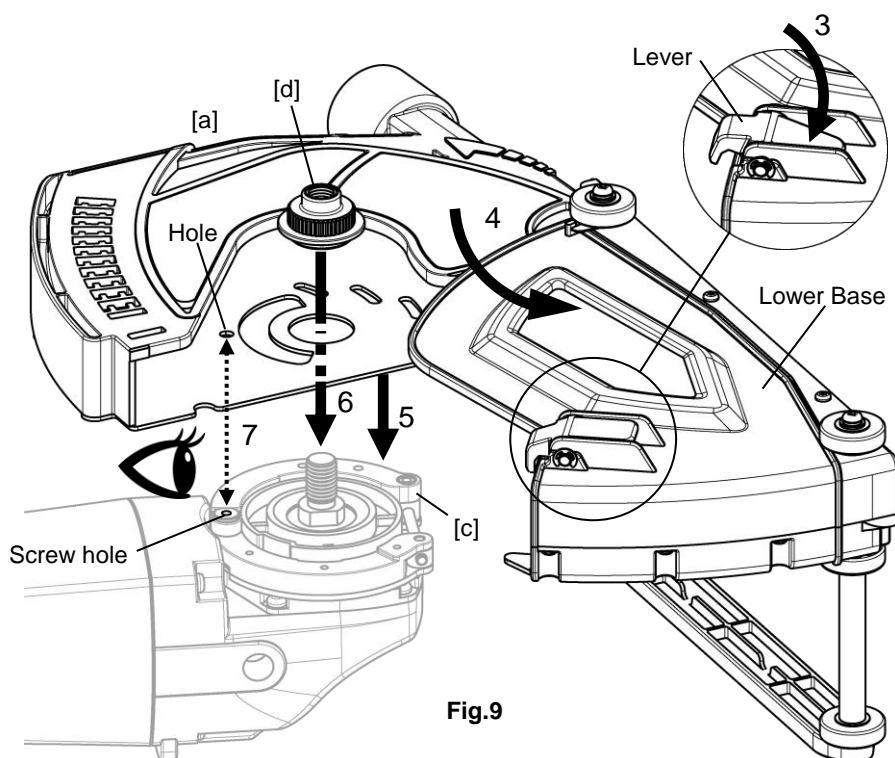

8. Tighten [e] Flange Bolt x 4pcs by [p] Hex Wrench.  
(Fig.10)

9. Remove [d] Centering Holder.

10. Set the proper Spacer [g] / [h] / [i] / [k] / [m] on the spindle of the angle grinder.

11. Set [f] Base Flange on Spacer.

12. Set the Blade on [f] Base Flange and tighten the Lock Nut by Wrench.  
==> Pay attention to the Lock Nut direction.  
(Fig. 11)

13. Push the Lever.

14. Close the Lower Base.  
(Fig.12)

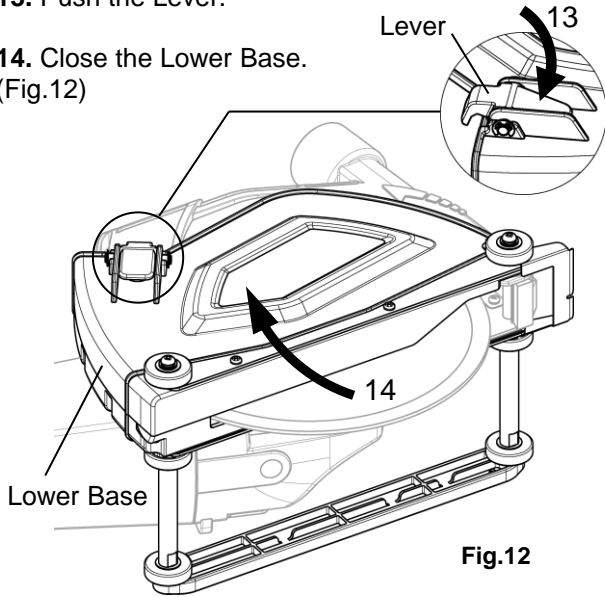

Fig.12

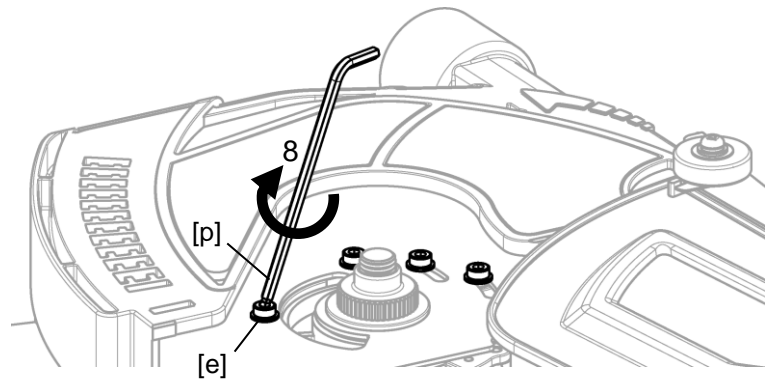

Fig.10

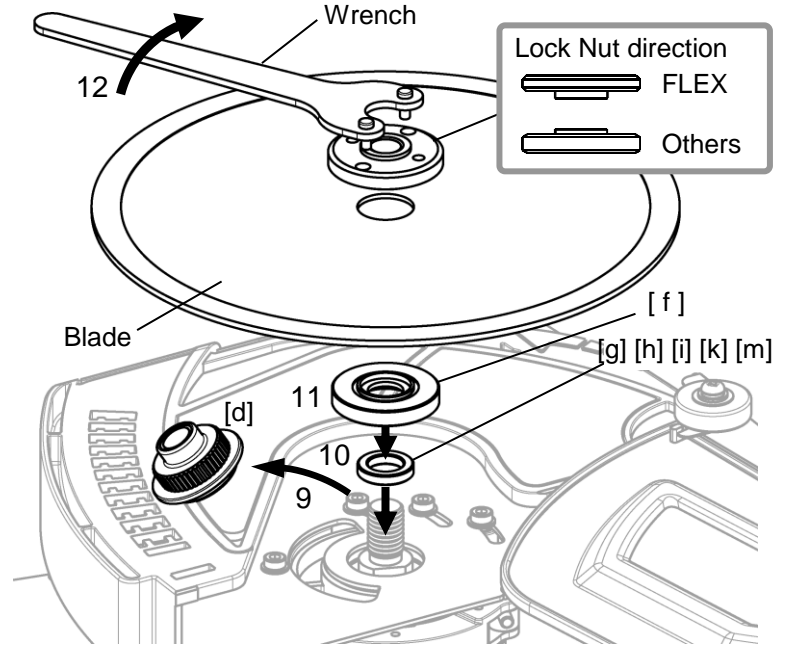

Fig.11

METABO	BOSCH	DEWALT		HIKOKI	MILWAUKEE	MAKITA	FLEX
		DWE494 type	DWE4579 type				

15. Confirm the Blade installed horizontally. (Fig.13 and 14)

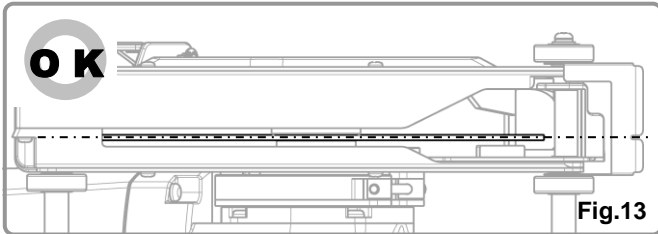

Fig.13

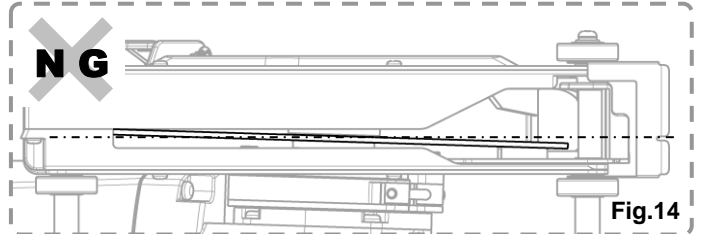

Fig.14

### DEPTH ADJUSTMENT

1. Push the Lever.

2. Slide the Lower Base and hook the Lever at the position of the proper Cutting Depth.  
(Fig.15)

### [CAUTION]

Use the Scale just for a reference as it should be affected by the status of the Blade.

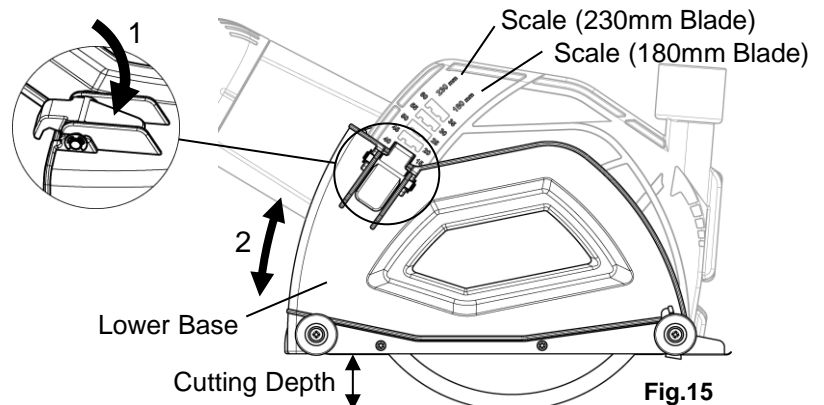

Fig.15

## FINALIZING

1. Screw the Handle to the angle grinder.
2. Insert [q] Swing Duct into the Duct.
3. Connect the Vacuum Hose with [q] Swing Duct by [r] Vacuum Joint. (Fig.16)

### [CAUTION]

Use the Vacuum with Input Power 1,500W or more for enough dust extraction performance.

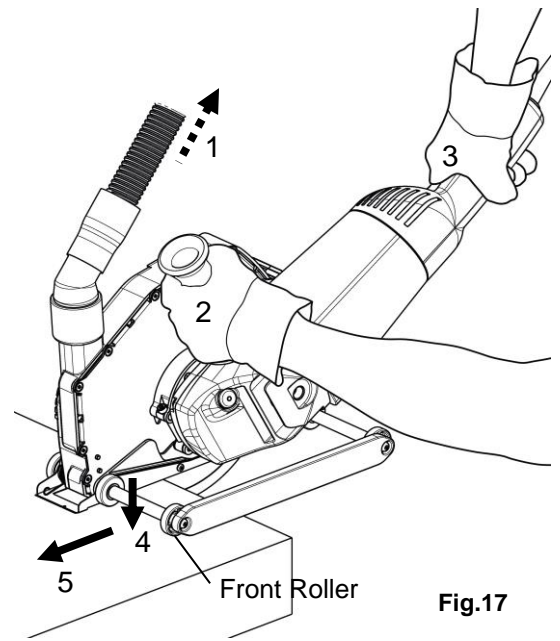
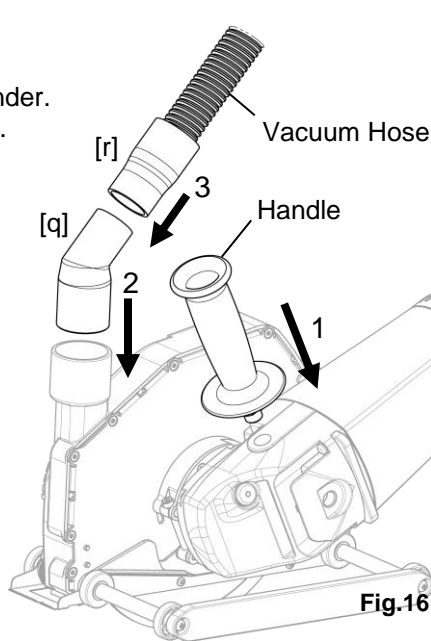

## CUTTING

1. Turn on the SW of Vacuum.
2. Securely hold the Handle.
3. Turn on the SW of angle grinder.
4. Place the Front Rollers on the cutting material.
5. Slowly forward the angle grinder. (Fig.17)

### [CAUTION]

DO NOT pull the angle grinder backward, or it leads to the scattering of the Dust. (Fig.18 and 19)

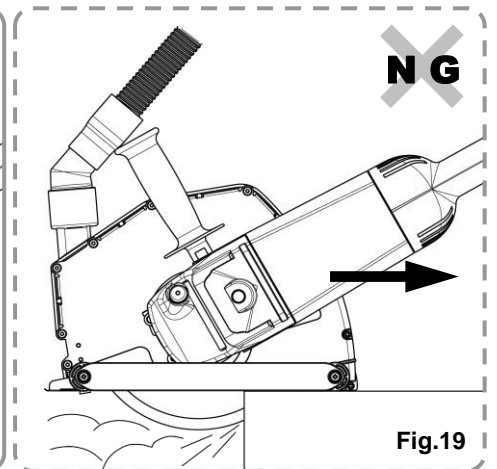
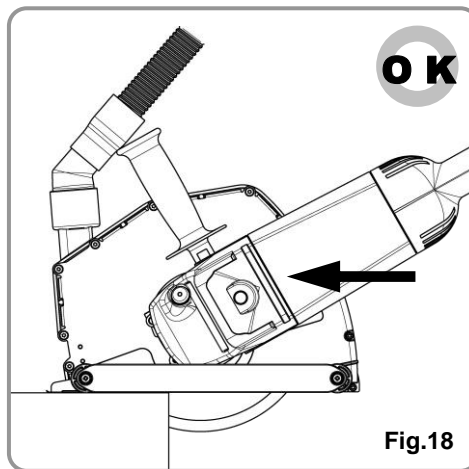

## PLUNGE CUTTING

1. Turn on the SW of Vacuum.
2. Securely hold the Handle.
3. Turn on the SW of angle grinder.
4. Place the Front Rollers on the cutting material.
5. Pivotaly lower the angle grinder slowly. (Fig.20)

### [CAUTION]

The Plunge Dust can't be well extracted with the cutting depth over 40mm.

